

27 26  
34 35

Mixed Hardwood & Pine

LAKE SUPERIOR  
AREA 20,364,800 ACRES  
MAX. DEPTH 1,302 FEET

BARK BAY

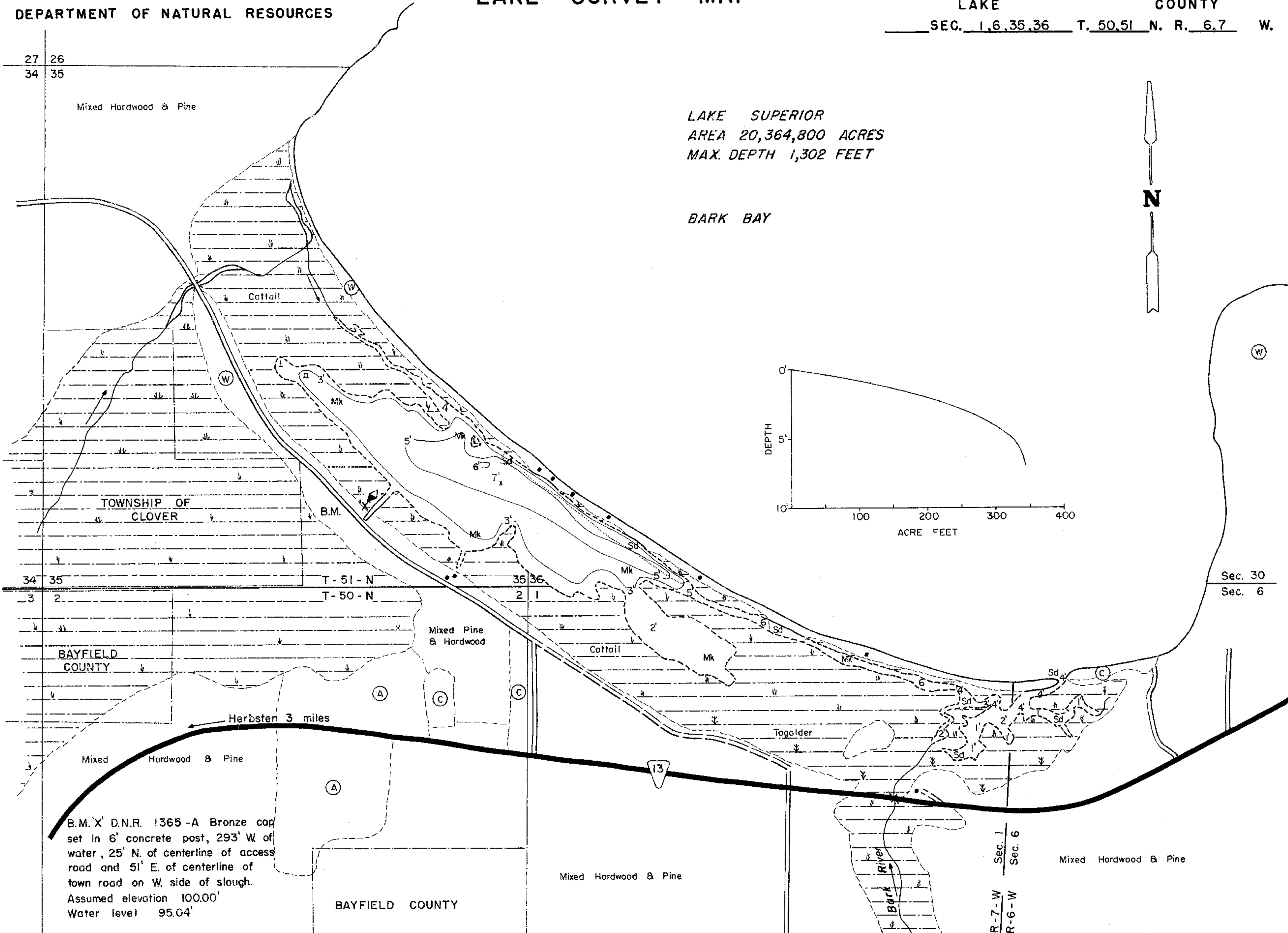
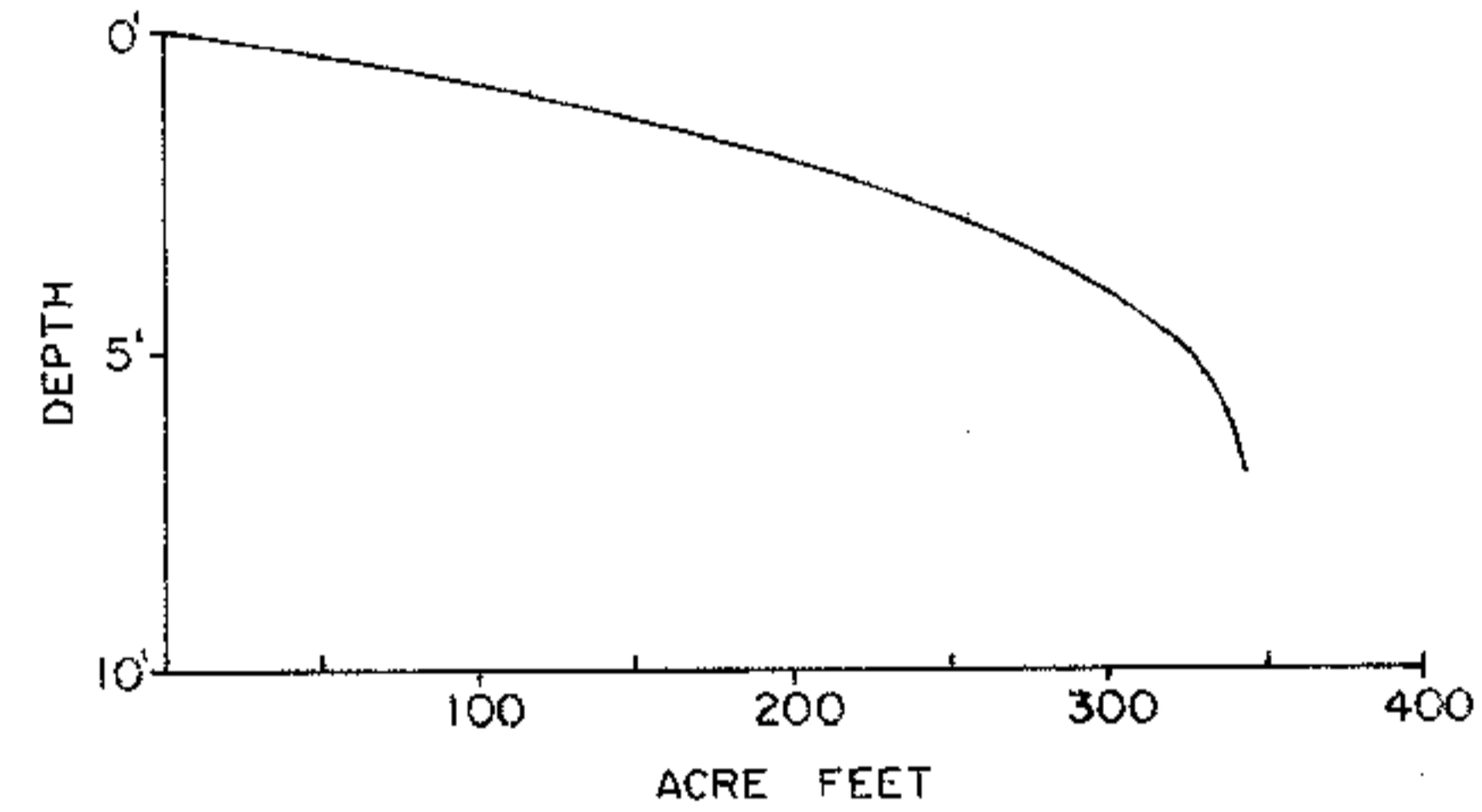

Sec. 30  
Sec. 6

B.M. 'X' D.N.R. 1365-A Bronze cap set in 6' concrete post, 293' W. of water, 25' N. of centerline of access road and 51' E. of centerline of town road on W. side of slough. Assumed elevation 100.00' Water level 95.04'

EQUIPMENT RECORDING SONAR MAPPED MAY 1972

TOPOGRAPHIC SYMBOLS		LAKE BOTTOM SYMBOLS	
(B) Brush	Steep slope	P. Peat	B Boulders
(PW) Partially wooded	- - - Indefinite shoreline	Mk. Muck	o Stumps & Snags
(W) Wooded	Marsh	C. Clay	⚡ Rock danger to navigation
(C) Cleared	o Spring	M. Marl	T Submergent vegetation
(P) Pastured	--- Intermittent stream	Sd. Sand	⌞ Emergent vegetation
(A) Agricultural	==== Permanent inlet	St. Silt	⌞ Floating vegetation
B.M. Bench Mark	==== Permanent outlet	Gr. Gravel	⊕ Brush shelters
■ Dwelling	⌞ Dam	R. Rubble	
▣ Resort	D.N.R. State owned land	Br. Bedrock	
□ Camp			



◆ Access    ◆ Access with Parking    ◆ Boat Livery

Drawn by: C. Holt  
Field work by: C. Busch, G. Lund, L. Sother

SPECIES OF FISH	Abundance		
	Abundant	Common	Present
Muskie			X
N. Pike			X
Walleye			X
L.M. Bass			
S.M. Bass			
Panfish	X		
Trout			

WATER AREA 116.0 ACRES  
UNDER 3 FT. 53 %  
OVER 20 FT. 0 %  
MAX. DEPTH 7 FEET.  
TOTAL ALK. 57 P.P.M.  
VOLUME 343 ACRE FT.  
SHORELINE 7.90 MILES

Source: Wisconsin Department of Natural Resources 608-266-2621  
Bark Bay Slough Lake – Bayfield County, Wisconsin DNR Lake Map  
Date – May 1972 - Historical Lake Map - Not for Navigation  
A Public Document - Please Identify the Source when using it.