

LAKE SURVEY MAP

PIKE LAKE BAYFIELD COUNTY
SEC. 21 T. 47 N. R. 8 W.

B.M. 'X' 2" square cut in
upstream dock of concrete
bridge over outlet
Assumed elevation 100.65'
Water level 95.35'

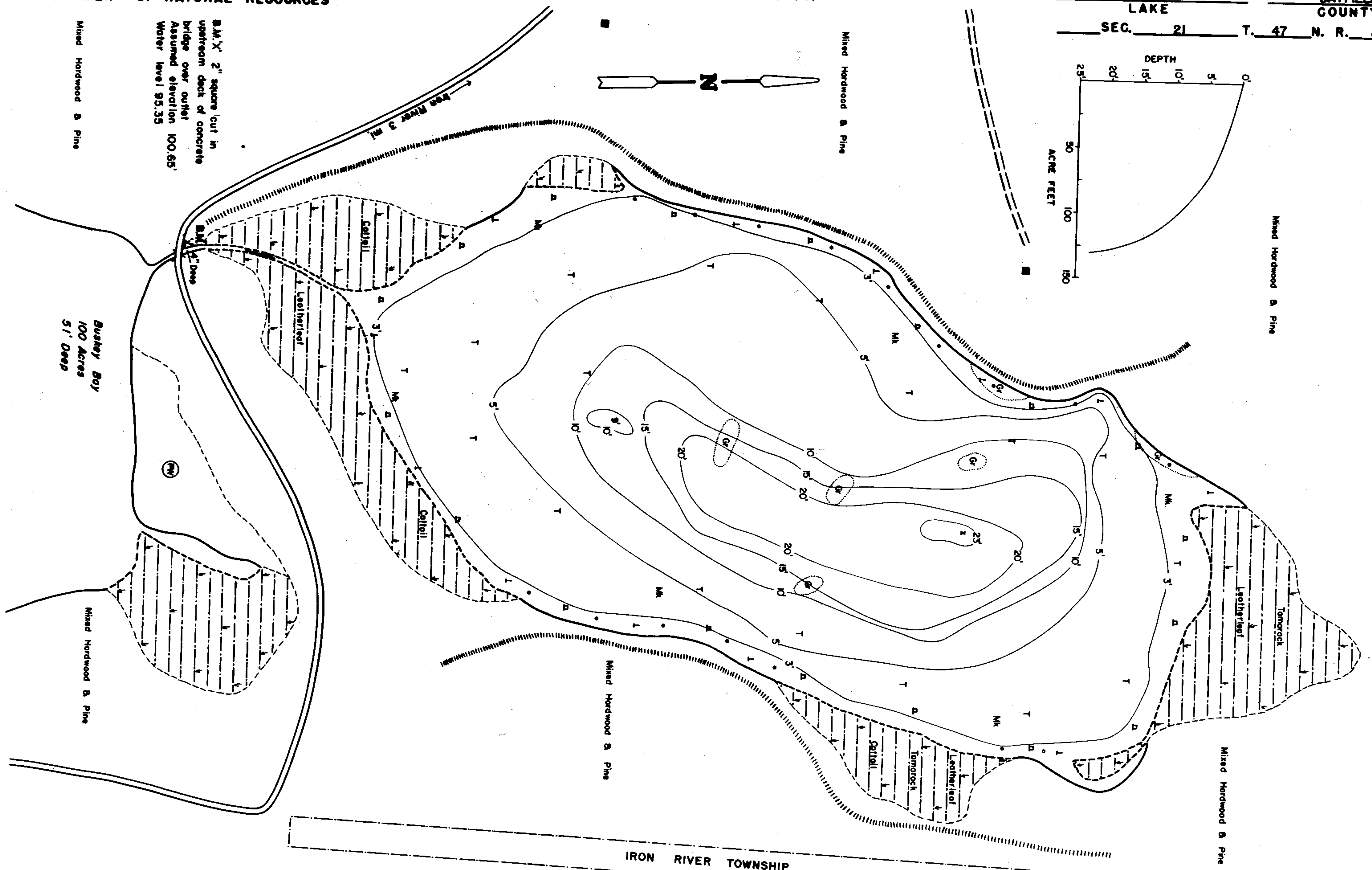
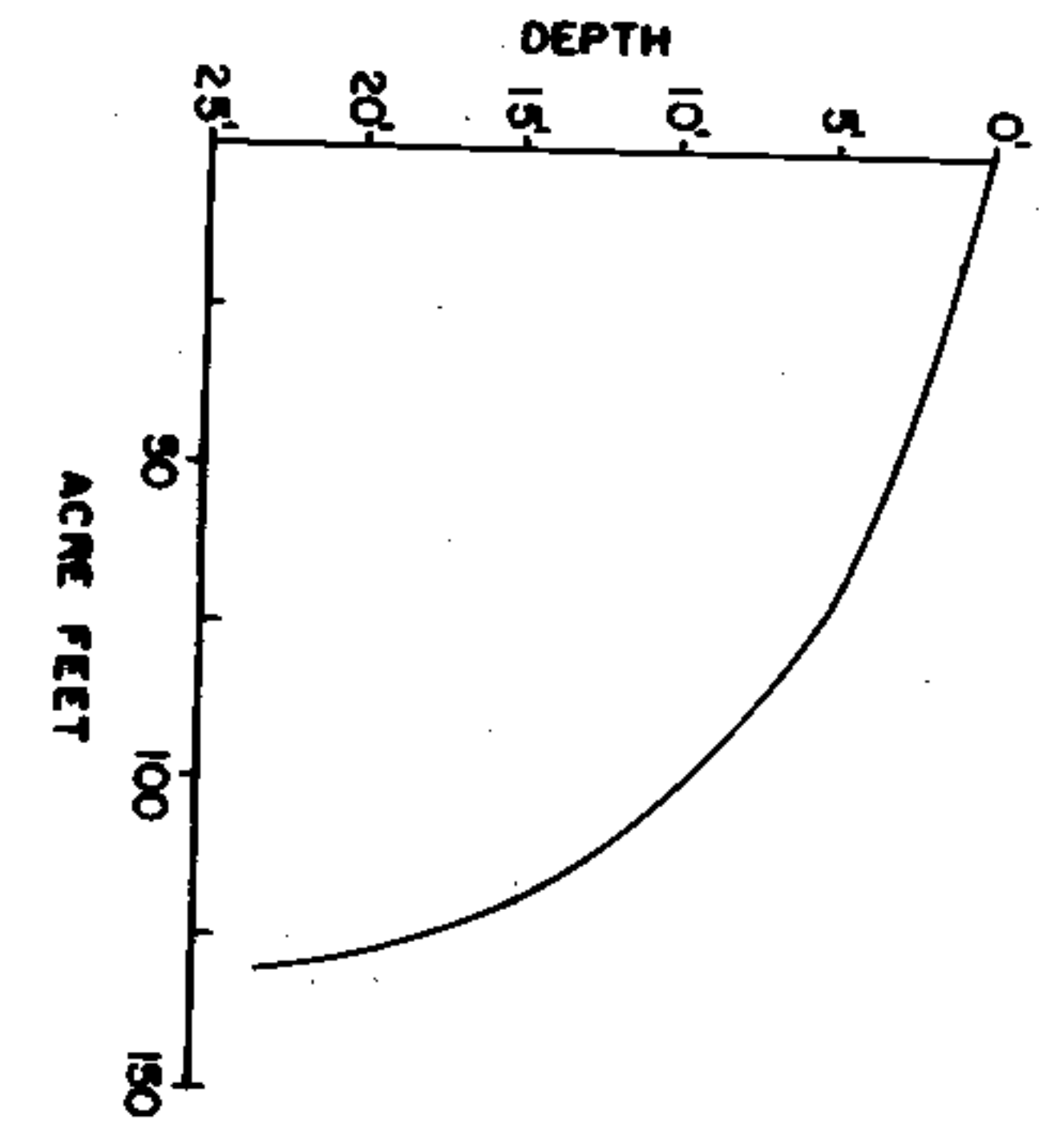

EQUIPMENT RECORDING SONAR MAPPED JULY 1972
MONTH YEAR

- | TOPOGRAPHIC SYMBOLS | | LAKE BOTTOM SYMBOLS | |
|----------------------|----------------------------|---------------------|-----------------------------|
| (B) Brush | Steep slope | P. Peat | B Boulders |
| (W) Partially wooded | ----- Indefinite shoreline | Mk. Muck | o Stumps & Snags |
| (C) Wooded | Marsh | C. Clay | ⊗ Rock danger to navigation |
| (CL) Cleared | Spring | M. Marl | T Submergent vegetation |
| (P) Pastured | ----- Intermittent stream | Sd. Sand | I Emergent vegetation |
| (A) Agricultural | ----- Permanent inlet | St. Silt | △ Floating vegetation |
| B.M. Bench Mark | ----- Permanent outlet | Gr. Gravel | ⬇ Brush shelters |
| ■ Dwelling | ⌒ Dam | R. Rubble | |
| □ Resort | ⌒ D.N.R. State owned land | Bc. Bedrock | |
| ⊠ Camp | | | |



Access Access with Parking Boat Livery

Drawn by: C. Holt
Field work by: C. Busch, G. Lund, L. Sather

SPECIES OF FISH	Abundant Common Present		
	Abundant	Common	Present
Muskie			X
N. Pike		X	X
Walleye		X	X
L.M. Bass	X	X	X
S.M. Bass	X	X	X
Panfish	X		
Trout			

WATER AREA 171 ACRES
UNDER 3 FT. 13.0 %
OVER 20 FT. 8.0 %
MAX. DEPTH 23 FEET.
TOTAL ALK. 24 P.P.M.
VOLUME 131 ACRE FT.
MAIN SHORELINE 0.70 MI.
ISLAND SHORELINE MI.

Source: Wisconsin Department of Natural Resources 608-266-2621
Pike Lake – Bayfield County, Wisconsin DNR Lake Map
Date – Jul 1972 - Historical Lake Map - Not for Navigation
A Public Document - Please Identify the Source when using it.