

LAKE E&W TWIN
SECTION 30-31
TOWNSHIP T.17.N
RANGE R.8.E
TOWN SPRINGFIELD
COUNTY MARQUETTE

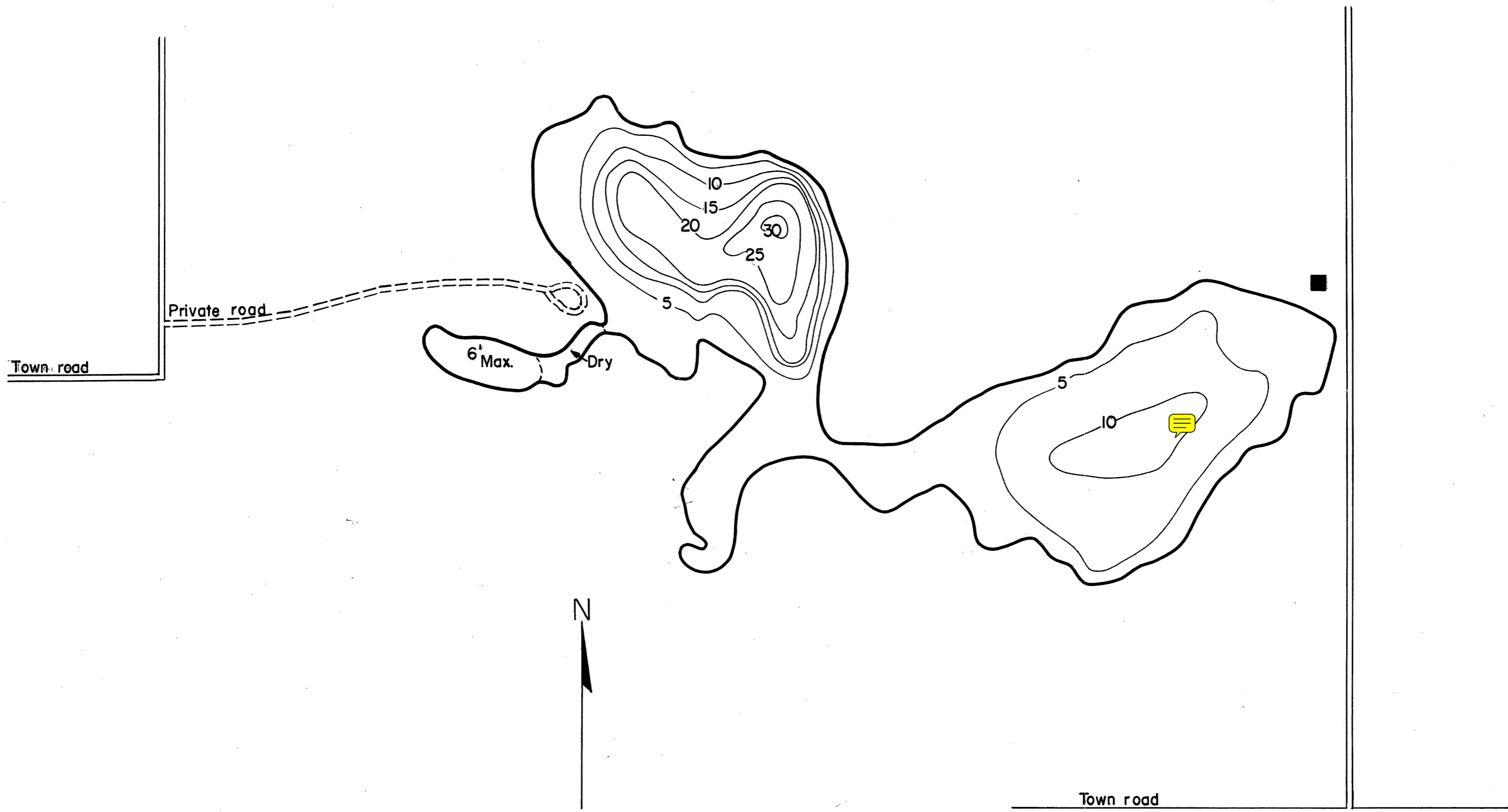

AREA 39 Acres
TOTAL SHORELINE 2 Miles
MAX. DEPTH 30 Feet
SCALE: 1/16" = 1 Mile

Source: Wisconsin Department of Natural Resources 608-266-2621
East and West Twin Lake – Marquette County, Wisconsin DNR Lake Map
Date – Unknown - Historical Lake Map - Not for Navigation
A Public Document - Please Identify the Source when using it.