

LAKE SURVEY MAP

WISCONSIN CONSERVATION DEPARTMENT
BIOLOGY DIVISION
LAKE AND STREAM IMPROVEMENT SECTION

LAKE EAST
SECTION 25-30
TOWNSHIP 21 N
RANGE 9-10 E
TOWN OF ALMOND
COUNTY PORTAGE

FORM FI

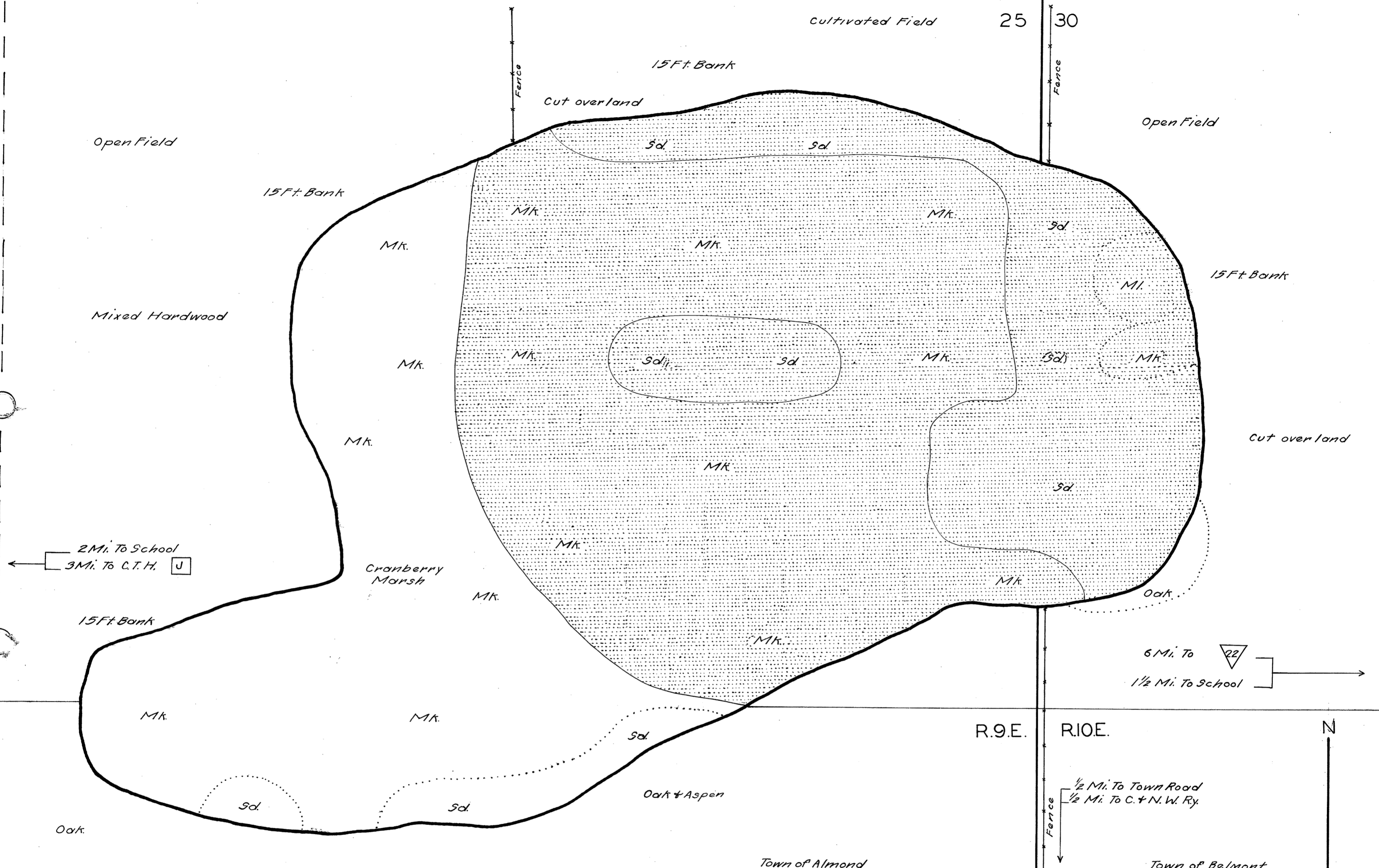

AREA ACRES 20
TOTAL SHORELINE 0.7 Mi.
MAX. DEPTH 4 Ft.

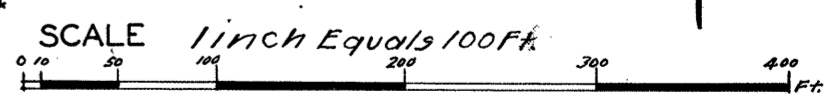

DATE July 17, 1941
COMPILED BY _____
TRACED BY W.I.Z. (W.P.A.)
SOURCE OF INFORMATION _____
W.P.A. Lake Survey Project
SOUNDINGS 100 Ft. intervals
DATES OF MAP REVISION _____
WORK AGENCY W. P. A.

LAKE IMPROVEMENT RECORD

TYPE	DATE			
◇ BRUSH REFUGES	_____	_____	_____	_____
┌ SAPLING TANGLES	_____	_____	_____	_____
▣ SPAWNING BOXES	_____	_____	_____	_____
* MINNOW SPAWNERS	_____	_____	_____	_____
TOTAL		_____	_____	_____

- LEGEND**
- WEED BEDS
 - ROCKY SHOALS
 - Sd. SAND
 - Cl. CLAY
 - Gr. GRAVEL
 - Mk. MUCK
 - DWELLING
 - ABANDONED DWELLING
 - ▣ RESORT

Checked
W.P.S.
E.M.K.
7/29/41

Source: Wisconsin Department of Natural Resources 608-266-2621
East Lake – Portage County, Wisconsin DNR Lake Map
Date – Jul 1941 - Historical Lake Map - Not for Navigation
A Public Document - Please Identify the Source when using it.