

# LAKE SURVEY MAP

FLANAGAN LAKE  
SEC. 19 & 30 T. 2 N. R. 20 E.  
KENOSHA COUNTY

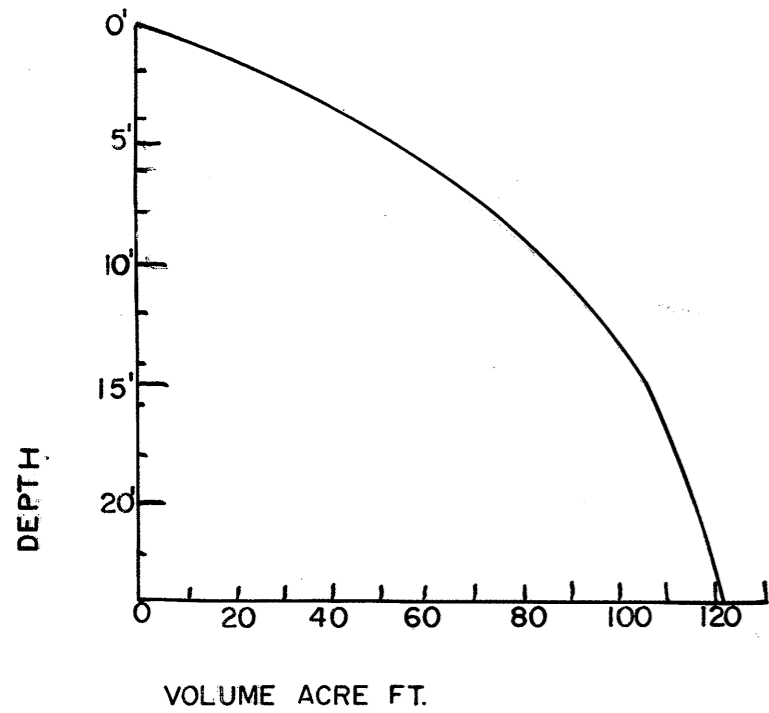

← To S.T.H. 83 ← Burlington 8 miles  
Sec. 19  
Sec. 30  
Sec. 19  
Sec. 30

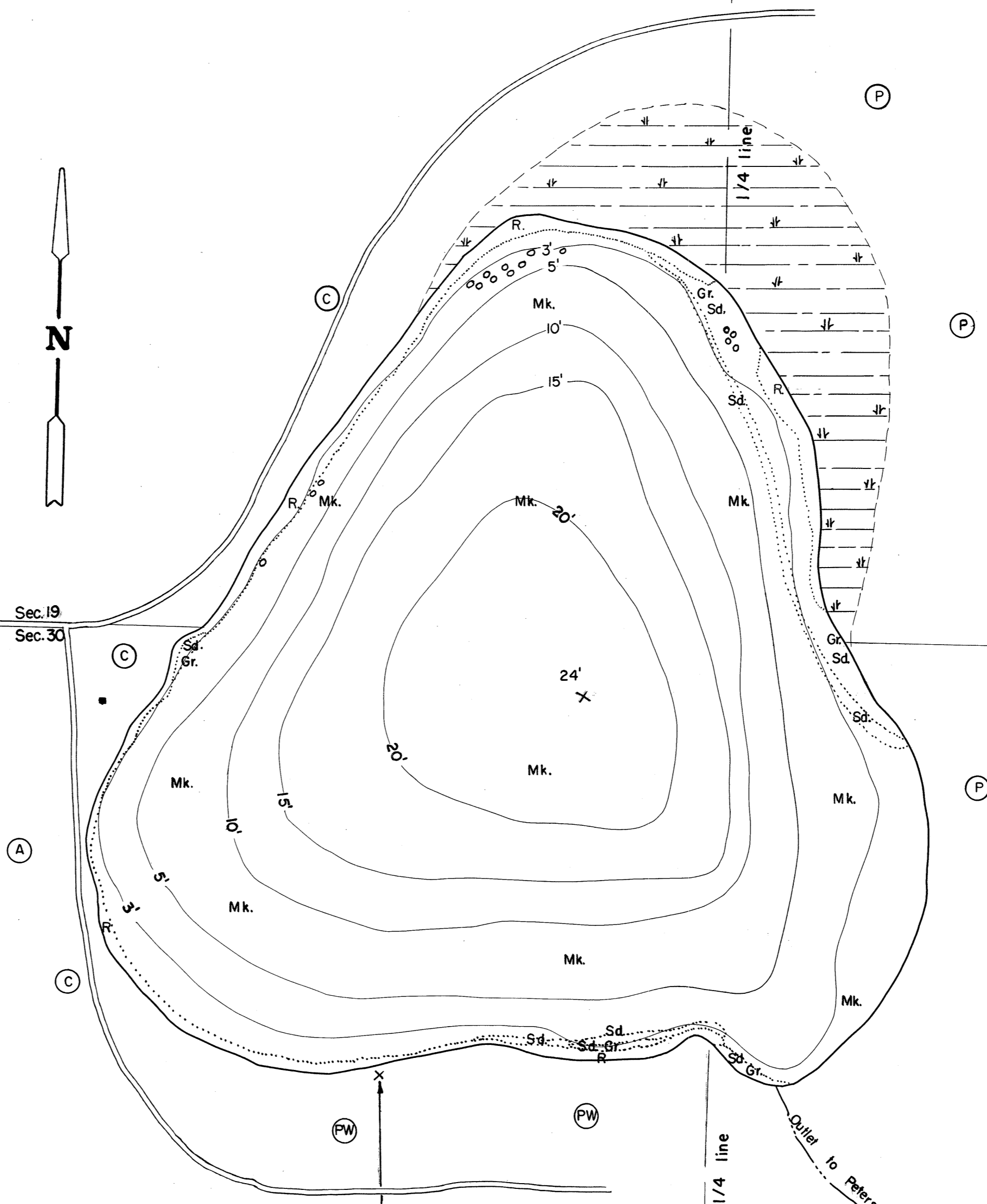

D.N.R. B.M. 1423-B Square cut in center of 4.5' x 3' granite boulder 8' from south edge of lake.  
Elevation 92.76'  
Water elevation 88.60'

UPDATED AUG. 1967  
EQUIPMENT 200' GRIDS ON ICE MAPPED FEBRUARY 1952  
MO. YR.

- WATER ELEV. 88.60'
- | TOPOGRAPHIC SYMBOLS   |                        | LAKE BOTTOM SYMBOLS |                         |
|-----------------------|------------------------|---------------------|-------------------------|
| (B) Brush             | Steep slope            | P. Peat             | Gr. Gravel              |
| (PW) Partially wooded | ~ Indefinite shoreline | Mk. Muck            | R. Rubble               |
| (W) Wooded            | Marsh                  | C. Clay             | Br. Bedrock             |
| (C) Cleared           | o Spring               | M. Marl             | T Submergent vegetation |
| (P) Pastured          | Intermittent stream    | Sd. Sand            | ↓ Emergent vegetation   |
| (A) Agricultural      | Permanent inlet        | St. Silt            | ⊕ Floating vegetation   |
| B.M. Bench Mark       | Permanent outlet       |                     |                         |
| ■ Dwelling            | Dam                    |                     |                         |
| □ Resort              |                        |                     |                         |

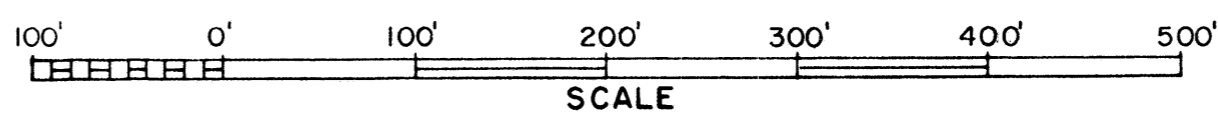

◇ Access      ◀ Access with Parking      ◆ Boat Livery  
Field work by: Schwenn & Spielman      Drawn by: D. Laiho

SPECIES OF FISH		
	Abundant	Rare
Muskie		
N. Pike		
Walleye		X
L.M. Bass		X
S.M. Bass		
Panfish	X	
Trout		
Perch		X

AREA 11.64 ACRES  
UNDER 3FT. 13.7%  
OVER 20FT. 13.7%  
VOLUME 122.15 ACRE FT.  
TOTAL ALK. 223 P.P.M.  
SHORELINE .52 MILES  
MAX. DEPTH 24' FEET

Source: Wisconsin Department of Natural Resources 608-266-2621  
Flanagan Lake – Kenosha County, Wisconsin DNR Lake Map  
Date – Aug 1967 - Historical Lake Map - Not for Navigation  
A Public Document - Please Identify the Source when using it.