

B.M. "X" SPIKE 3' ABOVE BASE OF OAK TREE LOCATED 9' WEST OF BOAT HOUSE & 23' S. OF WATERS EDGE ASSUMED ELEV. 100.0' WATER ELEV. 89.6'

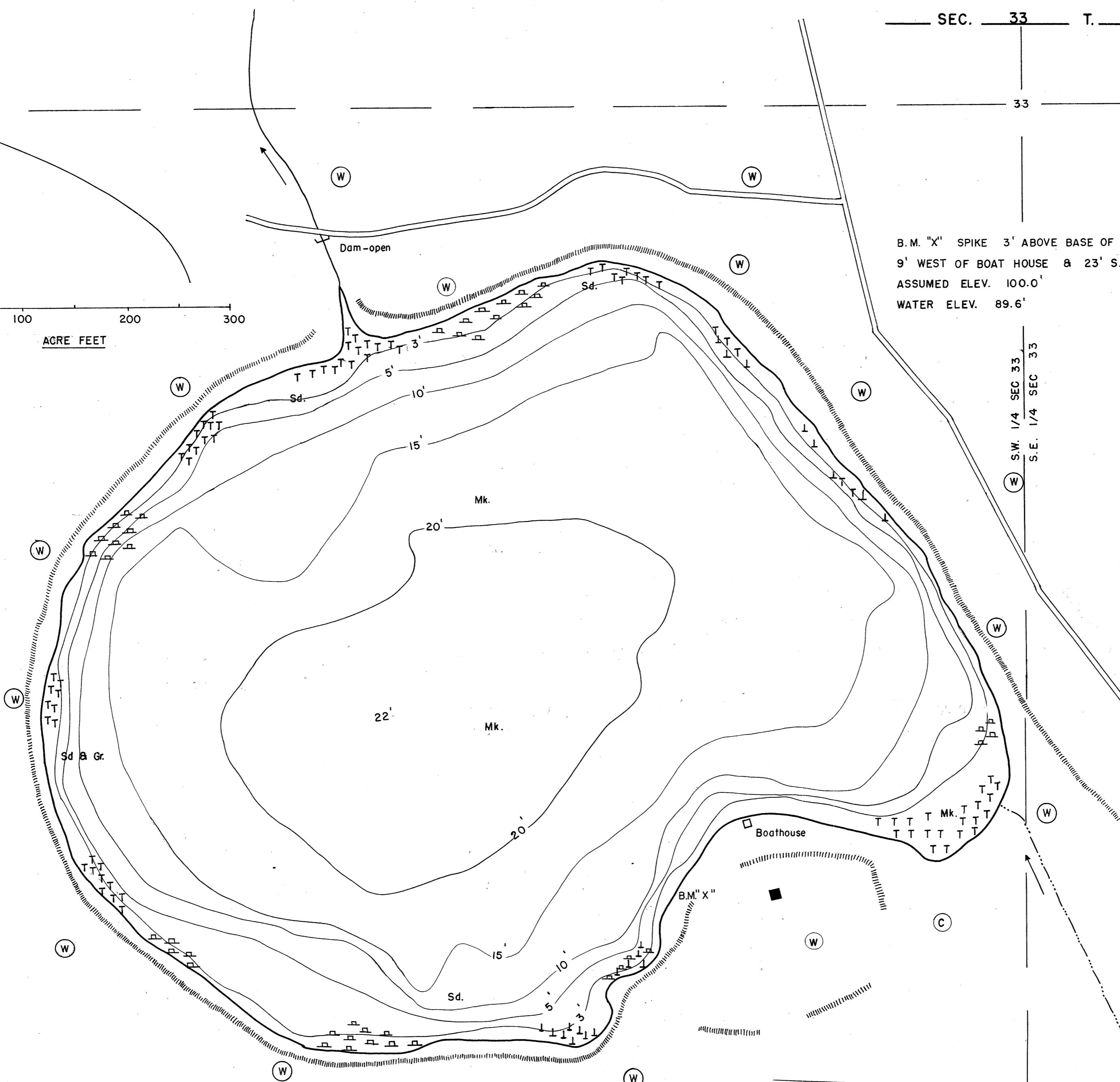

EQUIPMENT ECHO SOUNDING MAPPED JUNE 1966 MO. YR.

- TOPOGRAPHIC SYMBOLS
- (B) Brush
 - (PW) Partially wooded
 - (W) Wooded
 - (C) Cleared
 - (P) Pastured
 - (A) Agricultural
 - B.M. Bench Mark
 - Dwelling
 - Resort
 - ||||| Steep slope
 - - - Indefinite shoreline
 - Marsh
 - o Spring
 - Intermittent stream
 - Permanent inlet
 - Permanent outlet
 - Dam

WATER ELEV. 89.6

- LAKE BOTTOM SYMBOLS
- P. Peat
 - Mk. Muck
 - C. Clay
 - M. Marl
 - Sd. Sand
 - St. Silt
 - Gr. Gravel
 - R. Rubble
 - Br. Bedrock
 - T Submergent vegetation
 - ↓ Emergent vegetation
 - ⊠ Floating vegetation
 - Stumps & Snags

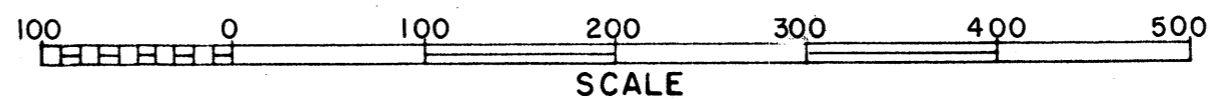

◇ Access ◀ Access with Parking ◆ Boat Livery
Field work by: H. Schwenn Drawn by: C. Holt

SPECIES OF FISH			
	Abundant	Common	Rare
Muskie			
N. Pike			X
Walleye			
L. M. Bass	X		
S. M. Bass			
Panfish	X		
Trout			

AREA 19.6 ACRES
 UNDER 3FT. 9 %
 OVER 20FT. 19.6 %
 VOLUME 270.8 ACRE FT.
 TOTAL ALK. 222 P.P.M.
 SHORELINE .7 MILES
 MAX. DEPTH 22 FEET

Mukwanago
4 Miles

Source: Wisconsin Department of Natural Resources 608-266-2621
Wood Lake – Waukesha County, Wisconsin DNR Lake Map
Date – Jun 1966 - Historical Lake Map - Not for Navigation
A Public Document - Please Identify the Source when using it.