

LAKE UPPER NEMAHBIN
 SECTION 13-24
 TOWNSHIP 7-N
 RANGE 17-E
 TOWN OCONOMOWOC
 COUNTY WAUKESHA

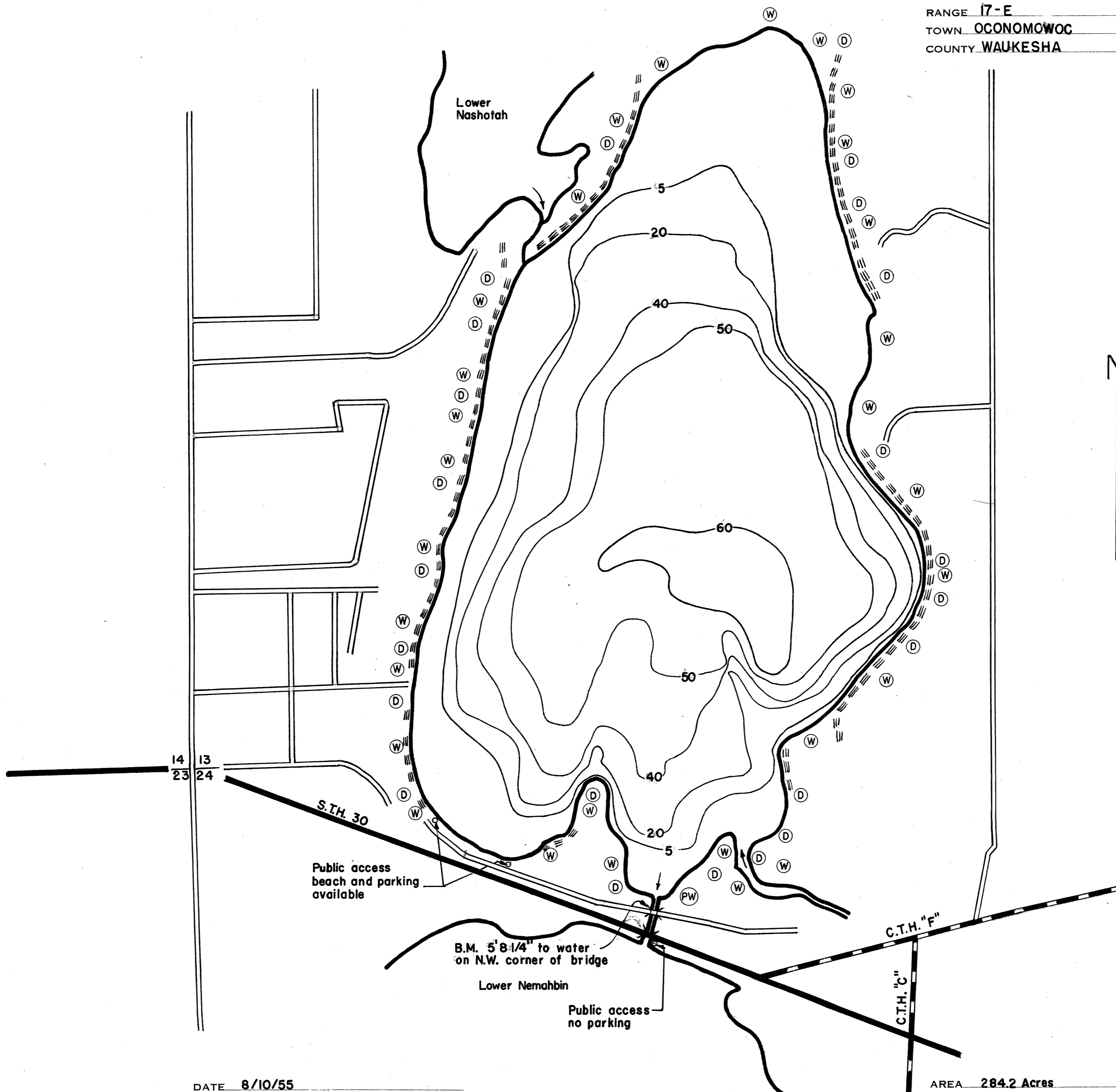

DATE 8/10/55
 SOURCE OF INFORMATION W.C.D.

 SOUNDINGS Echo Soundings

AREA 284.2 Acres
 TOTAL SHORELINE 2.9 Mi.
 MAX. DEPTH 60'

 SCALE: 1" = 500'

Source: Wisconsin Department of Natural Resources 608-266-2621
Upper Nemahbin Lake – Waukesha County, Wisconsin DNR Lake Map
Date – Aug 1955 - Historical Lake Map - Not for Navigation
A Public Document - Please Identify the Source when using it.