

LAKE SURVEY MAP

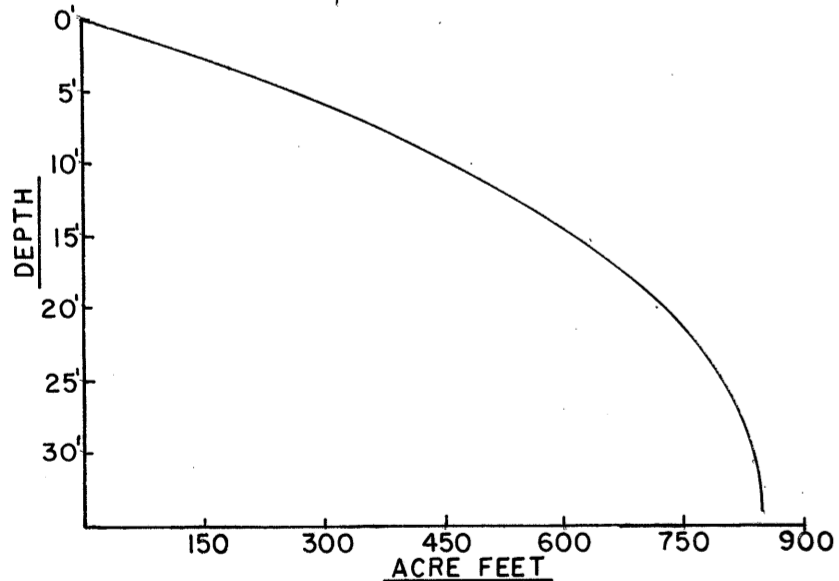
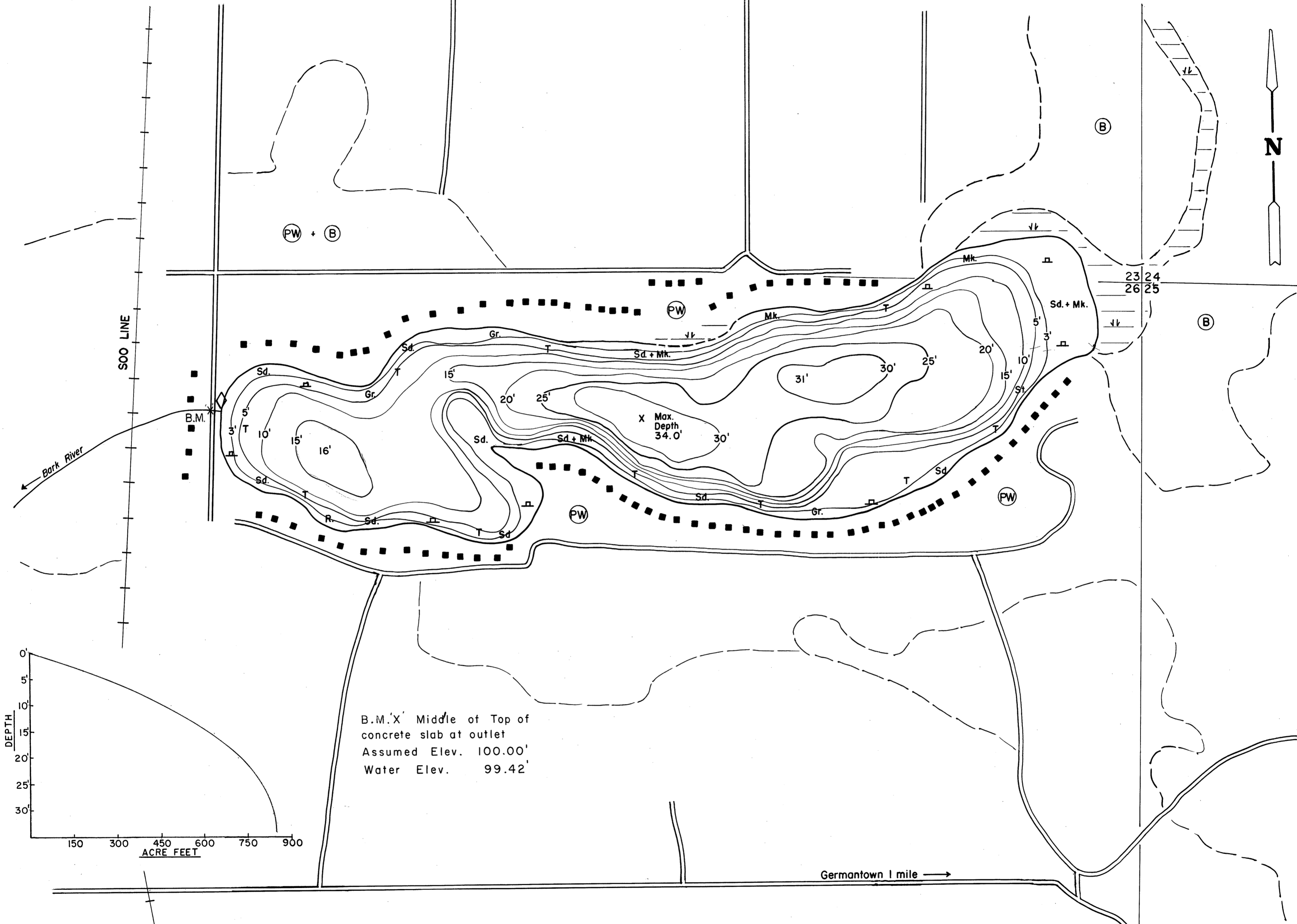

B.M. 'X' Middle of Top of concrete slab at outlet  
Assumed Elev. 100.00'  
Water Elev. 99.42'

Germantown 1 mile →

EQUIPMENT RECORDING SONAR MAPPED JUNE 1970

- TOPOGRAPHIC SYMBOLS**
- (B) Brush
  - (PW) Partially wooded
  - (W) Wooded
  - (C) Cleared
  - (P) Pastured
  - (A) Agricultural
  - B.M. Bench Mark
  - Dwelling
  - Resort
  - Camp
  - ||||| Steep slope
  - ~ Indefinite shoreline
  - Marsh
  - Spring
  - Intermittent stream
  - Permanent inlet
  - Permanent outlet
  - Dam
  - D.N.R. State owned land

- LAKE BOTTOM SYMBOLS**
- P. Peat
  - Mk. Muck
  - C. Clay
  - M. Marl
  - Sd. Sand
  - St. Silt
  - Gr. Gravel
  - R. Rubble
  - Br. Bedrock
  - B Boulders
  - Stumps & Snags
  - Rock danger to navigation
  - T Submergent vegetation
  - Emergent vegetation
  - Floating vegetation
  - Brush shelters



◆ Access    ◆ Access with Parking    ◆ Boat Livery  
Drawn by: W. Snyders  
Field work by: M. J. Goppa, J. Bakken.

SPECIES OF FISH	ABUNDANCE		
	Abundant	Common	Present
Muskie			
N. Pike			X
Walleye			
L. M. Bass		X	
S. M. Bass			
Panfish	X		
Trout			

WATER AREA 62.0 ACRES  
 UNDER 3 FT. 15.9 %  
 OVER 20 FT. 31.1 %  
 MAX. DEPTH 34.0 FEET.  
 TOTAL ALK. 224 P.P.M.  
 VOLUME 843.7 ACRE FT.  
 SHORELINE 1.82 MILES

Source: Wisconsin Department of Natural Resources 608-266-2621  
Bark Lake – Washington County, Wisconsin DNR Lake Map  
Date – Jun 1970 - Historical Lake Map - Not for Navigation  
A Public Document - Please Identify the Source when using it.