

LAKE WATERLOO POND
 SECTIONS 7, 12, 13
 TOWNSHIP 8-N
 RANGE 12-13-E
 TOWN MEDINA
 COUNTY DANE, JEFFERSON

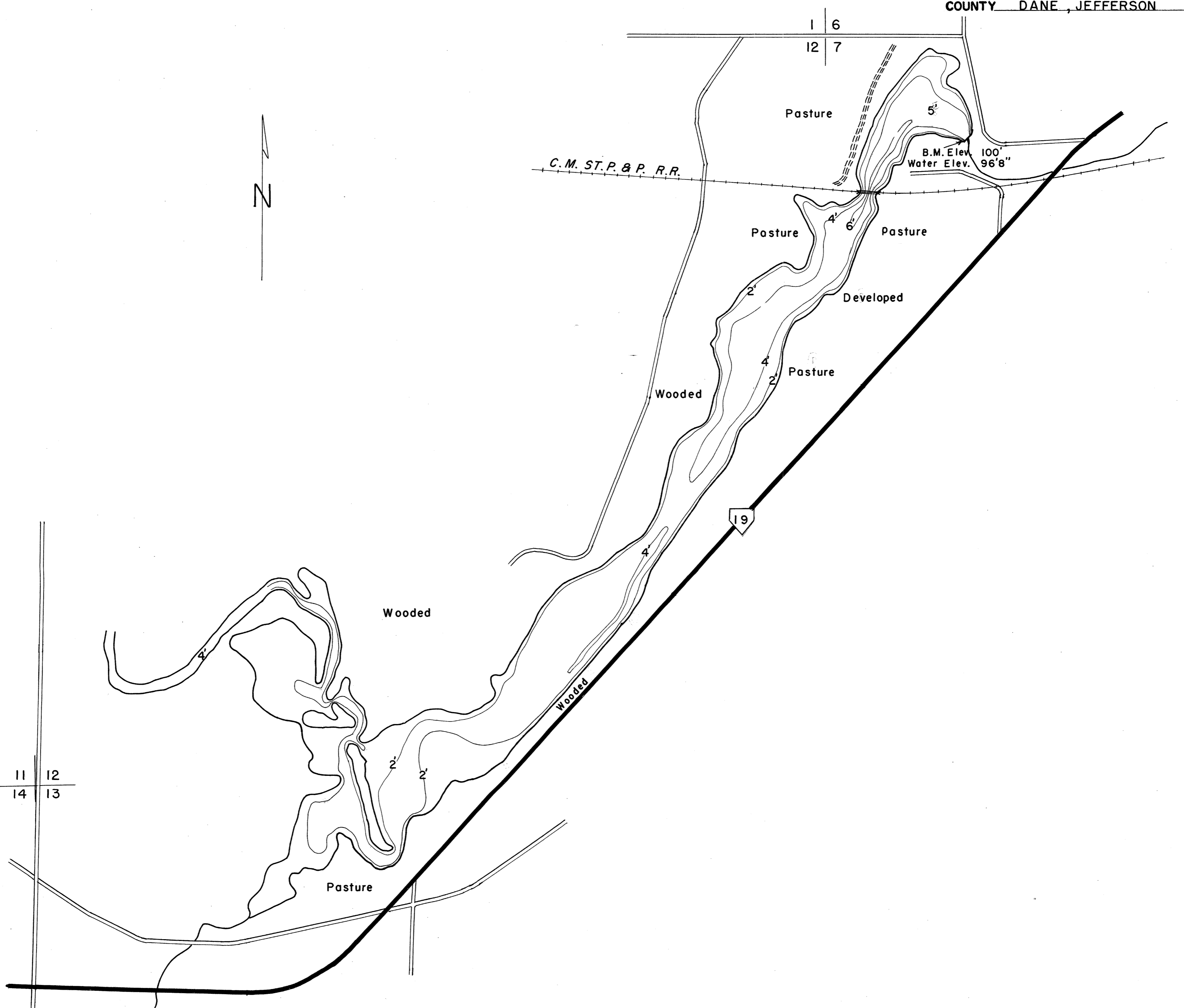

11 | 12
 14 | 13

19

LAKE MAPPED 8-4-61
 SOURCE OF INFORMATION W.C.D.
 SOUNDINGS Echo Sounder

AREA 84.32 Acres
 TOTAL SHORELINE 4.28 Miles
 MAX. DEPTH 6 Feet
 SCALE: 1" = 500'

Source: Wisconsin Department of Natural Resources 608-266-2621
Maunsha Flowage (Waterloo Pond) – Dane and Jefferson Counties, Wisconsin DNR Lake Map
Date – Aug 1961 - Historical Lake Map - Not for Navigation
A Public Document - Please Identify the Source when using it.