

# LAKE SURVEY MAP

LUDDEN LAKE IOWA COUNTY  
SEC. 25, 36 T. 5 N. R. 2 E.

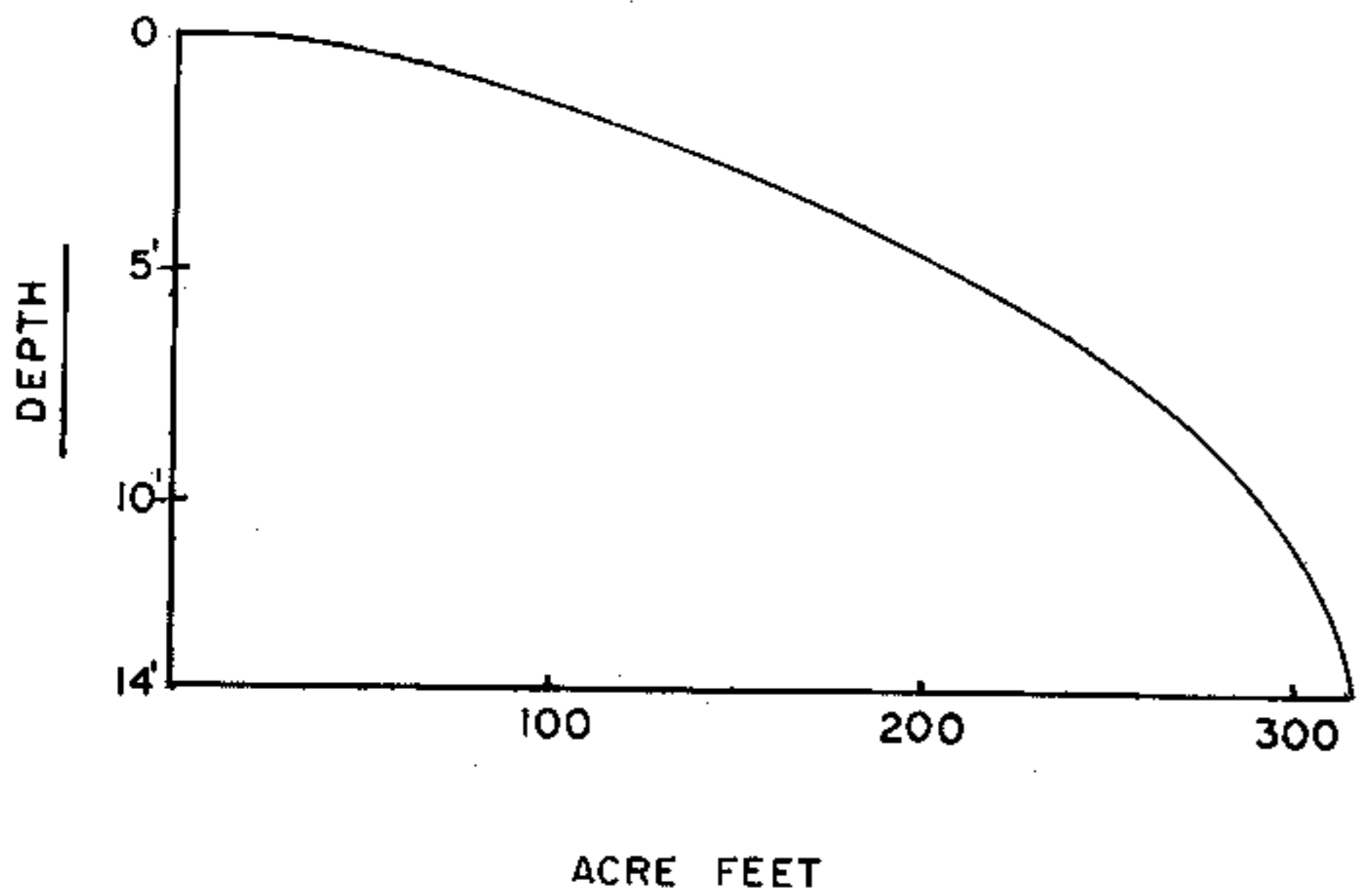

B.M.-X, No. 1126, is a square chiseled in middle of right core wall on top of Ludden Lake Dam. Taken 6/8/71  
Elevation = 941.02'  
Water level = 931.22'

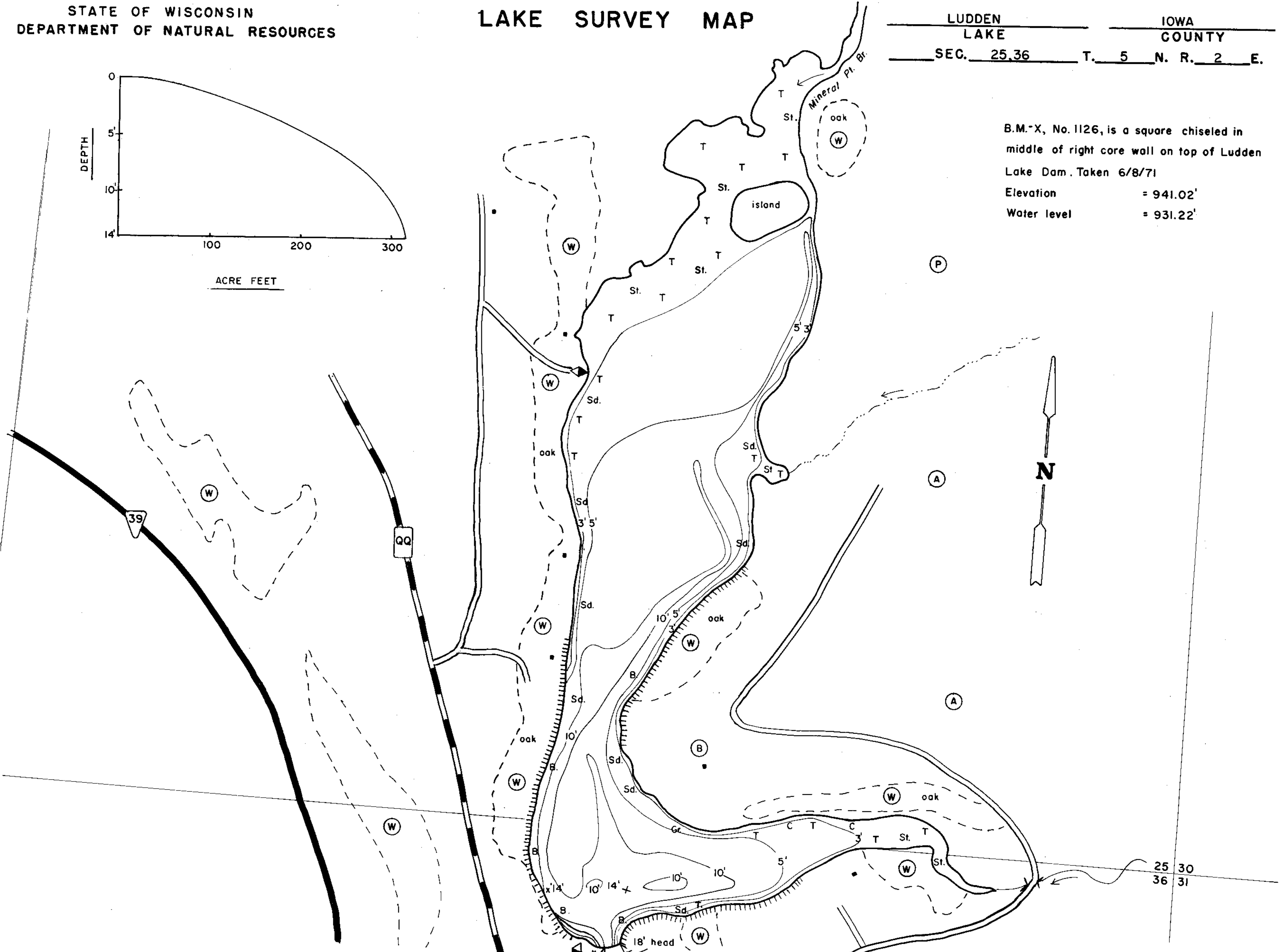

EQUIPMENT RECORDING SONAR MAPPED JUNE 1971  
MONTH YEAR

- LAKE BOTTOM SYMBOLS
- |                       |                            |             |                           |
|-----------------------|----------------------------|-------------|---------------------------|
| (B) Brush             | Steep slope                | P. Peat     | B Boulders                |
| (PW) Partially wooded | - - - Indefinite shoreline | Mk. Muck    | o Stumps & Snags          |
| (W) Wooded            | Marsh                      | C. Clay     | Rock danger to navigation |
| (C) Cleared           | Spring                     | M. Marl     | T Submergent vegetation   |
| (P) Pastured          | Intermittent stream        | Sd. Sand    | ↓ Emergent vegetation     |
| (A) Agricultural      | Permanent inlet            | St. Silt    | ⊠ Floating vegetation     |
| B.M. Bench Mark       | Permanent outlet           | Gr. Gravel  | ⊕ Brush shelters          |
| ■ Dwelling            | Dam                        | R. Rubble   |                           |
| □ Resort              | D.N.R. State owned land    | Br. Bedrock |                           |
| ⊠ Camp                |                            |             |                           |



Access Access with Parking Boat Livery  
Drawn by: T. Ginder  
Field work by: T. Smith, D. Gengler

SPECIES OF FISH	Abundant Common Present		
	Abundant	Common	Present
Muskie			
N. Pike			X
Walleye			
L.M. Bass			
S.M. Bass	X		
Panfish			X
Trout			

WATER AREA 58.42 ACRES  
UNDER 3 FT. 25 %  
OVER 20 FT. 0 %  
MAX. DEPTH 14 FEET.  
TOTAL ALK. 163 P.P.M.  
VOLUME 303.07 ACRE FT.  
SHORELINE 2.56 MILES

Source: Wisconsin Department of Natural Resources 608-266-2621  
Ludden Lake – Iowa County, Wisconsin DNR Lake Map  
Date – Jun 1971 - Historical Lake Map - Not for Navigation  
A Public Document - Please Identify the Source when using it.