

LAKE COX HOLLOW
SECTION 10-11
TOWNSHIP T. 6 N.
RANGE R. 3 E.
TOWN DODGEVILLE
COUNTY IOWA

← S.T.H. 25 - 1 Mile

Boat launching area

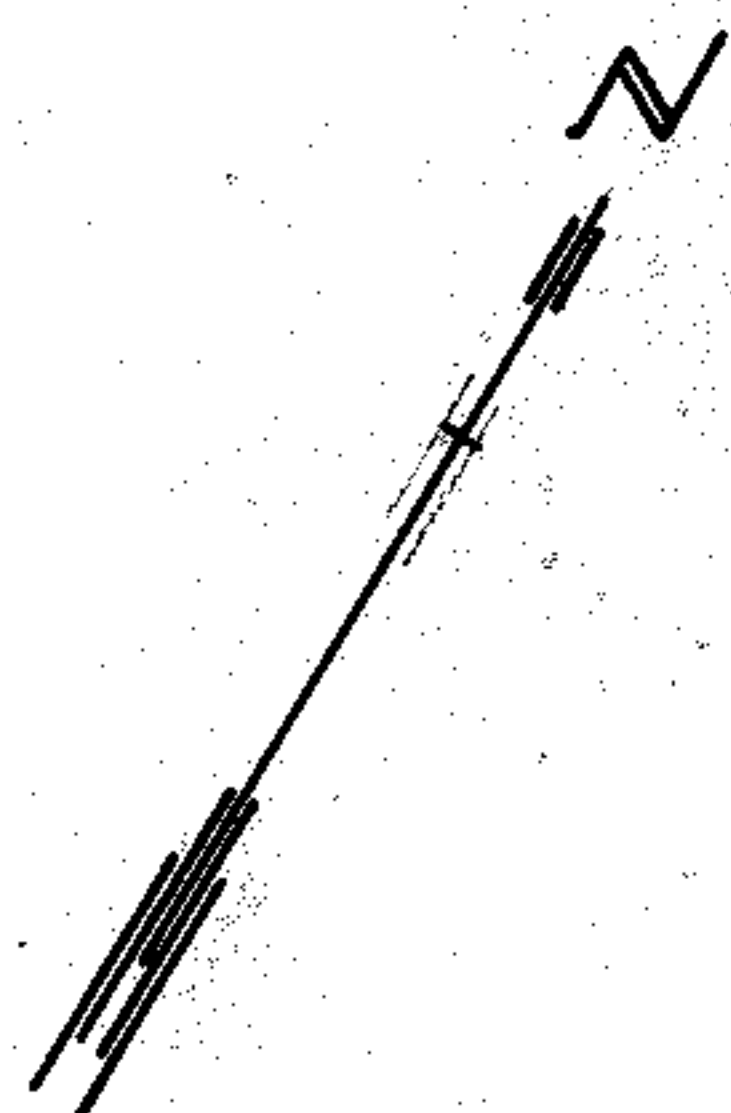

Swimming Beach

Spillway

Sluicewell

AREA 95 Acres
SHORELINE 3.3 Miles
MAX. DEPTH 28'
SCALE: 1"=200'

1958

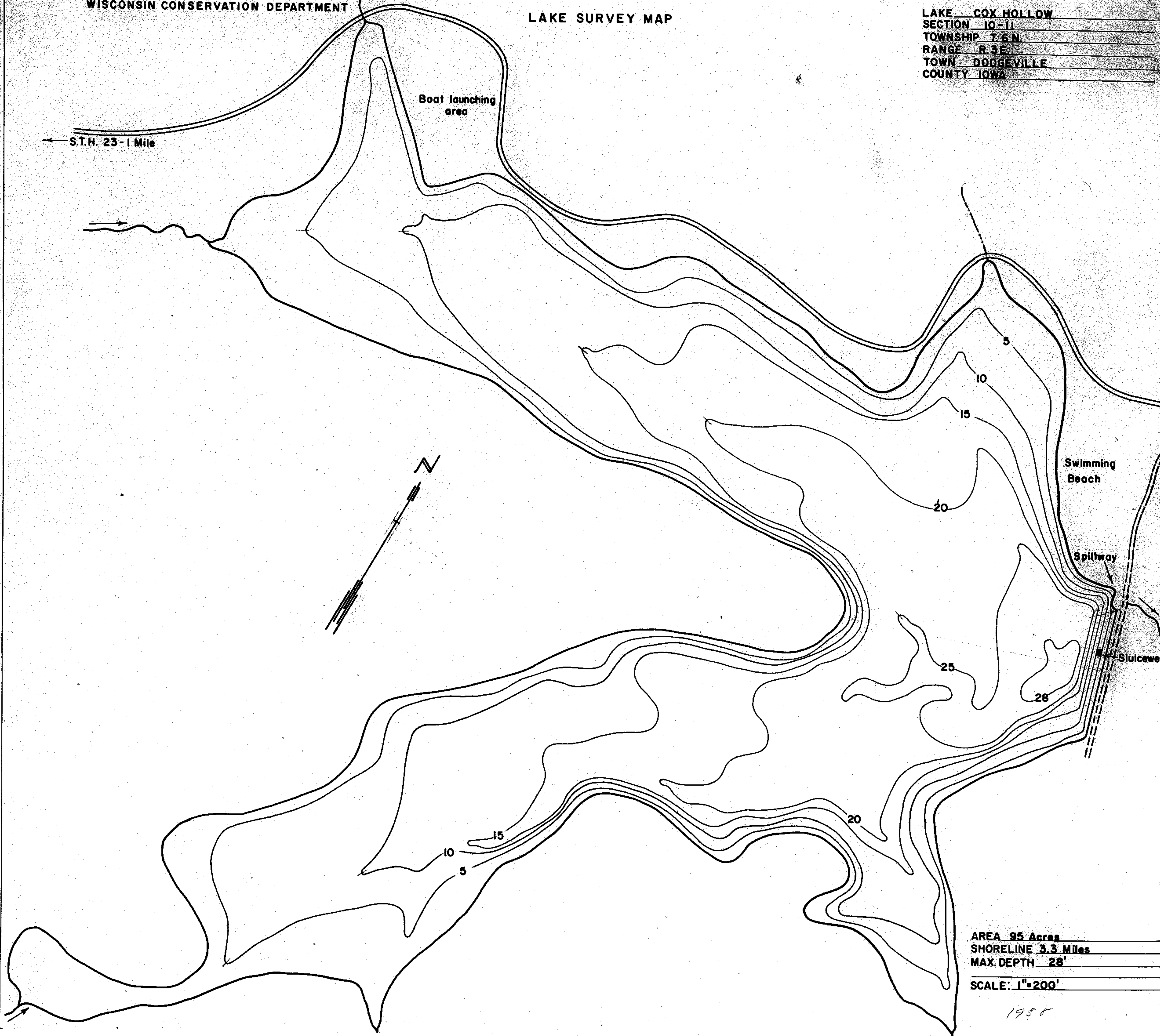

Source: Wisconsin Department of Natural Resources 608-266-2621
Cox Hollow Lake – Iowa County, Wisconsin DNR Lake Map
Date – 1958 - Historical Lake Map - Not for Navigation
A Public Document - Please Identify the Source when using it.