

# LAKE SURVEY MAP

**SPIDER LAKE CHAIN**  
LAKE  
SEC. 35, 23, 10 T. 37, 38-N. R. 10-P.W.  
(Sheet 2 of 2)

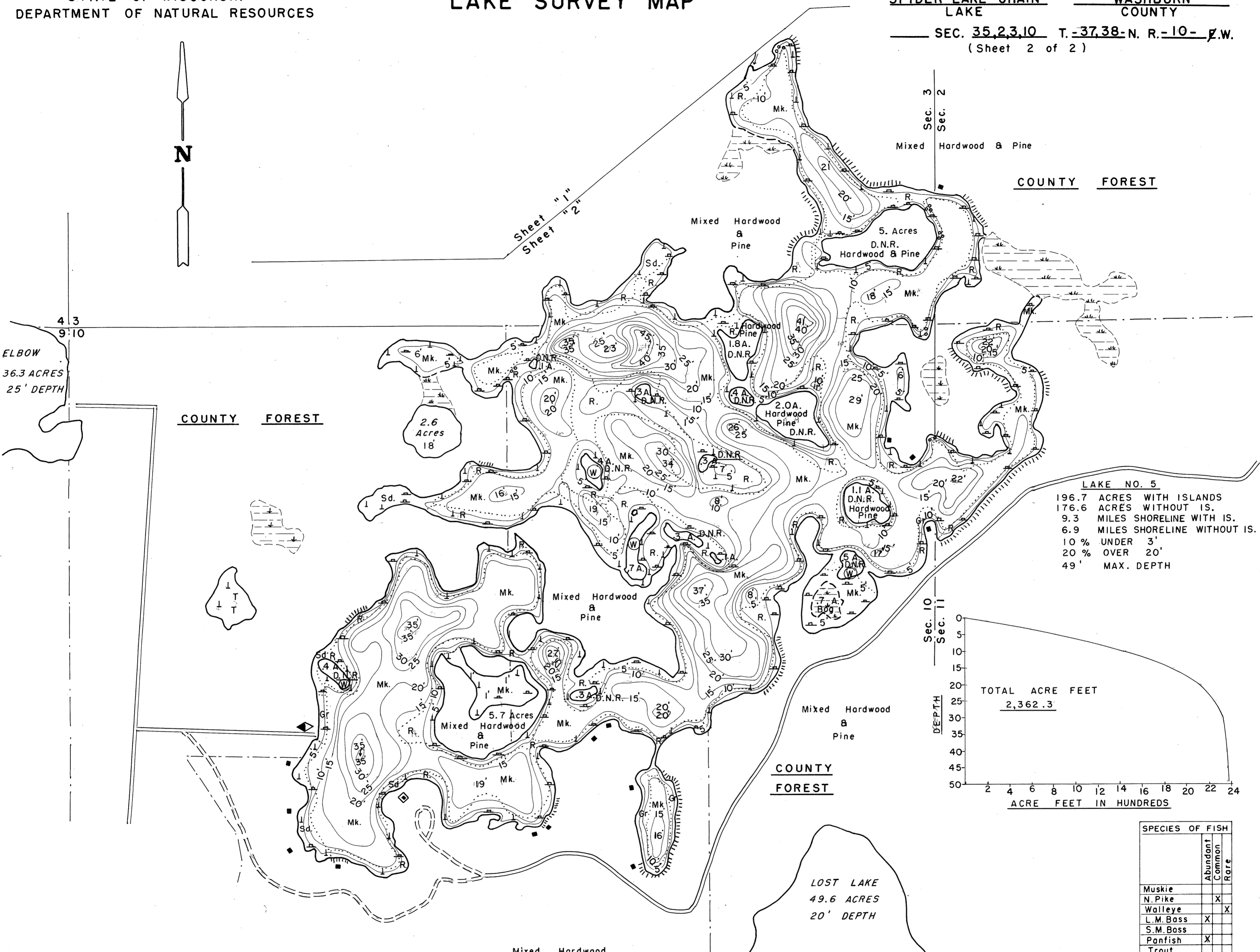

4 3  
9 10  
ELBOW  
36.3 ACRES  
25' DEPTH



**LAKE NO. 5**  
196.7 ACRES WITH ISLANDS  
176.6 ACRES WITHOUT IS.  
9.3 MILES SHORELINE WITH IS.  
6.9 MILES SHORELINE WITHOUT IS.  
10% UNDER 3'  
20% OVER 20'  
49' MAX. DEPTH

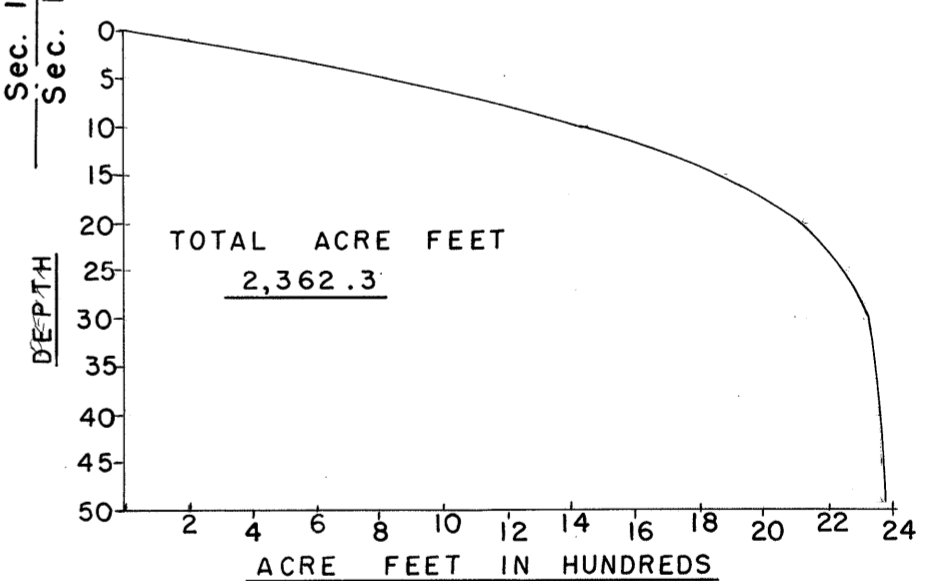

SPECIES OF FISH	Abundance	
	Abundant	Rare
Muskie		
N. Pike	X	
Walleye		X
L.M. Bass	X	
S.M. Bass		
Panfish	X	
Trout		

(TOTALS) 290.1 WITH ISLAND  
AREA 261.5 ACRES  
UNDER 3FT. 9%  
OVER 20FT. 24%  
VOLUME 3,806.7 ACRE FT.  
TOTAL ALK. 13 P.P.M.  
SHORELINE 10.6 14.2 WITH IS.  
MAX. DEPTH 62 FEET

EQUIPMENT RECORDING SONAR MAPPED AUGUST 1967  
MO. YR.

- TOPOGRAPHIC SYMBOLS**
- (B) Brush
  - (PW) Partially wooded
  - (W) Wooded
  - (C) Cleared
  - (P) Pastured
  - (A) Agricultural
  - B.M. Bench Mark
  - Dwelling
  - Resort
  - ||||| Steep slope
  - - - Indefinite shoreline
  - Marsh
  - Spring
  - Intermittent stream
  - Permanent inlet
  - Permanent outlet
  - Dam
  - D.N.R. State owned land

- LAKE BOTTOM SYMBOLS**
- P. Peat
  - Gr. Gravel
  - Stumps & Snags
  - R. Rubble
  - Br. Bedrock
  - T Submergent vegetation
  - Emergent vegetation
  - Floating vegetation
  - Mk. Muck
  - C. Clay
  - M. Marl
  - Sd. Sand
  - St. Silt

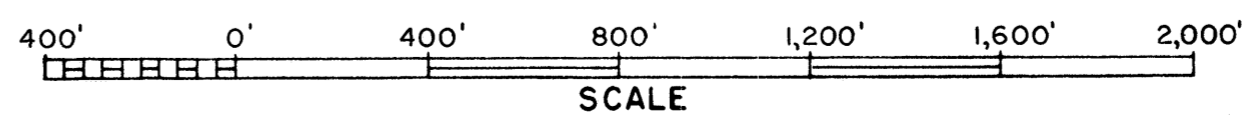

◇ Access      ◈ Access with Parking      ◆ Boat Livery  
Field work by C. Busch, N. Pokorney, L. Sather Drawn by: E. Eaton

WATER ELEV. 91.98

Mixed Hardwood

COUNTY FOREST

Mixed Hardwood & Pine

Mixed Hardwood & Pine

Mixed Hardwood & Pine

COUNTY FOREST

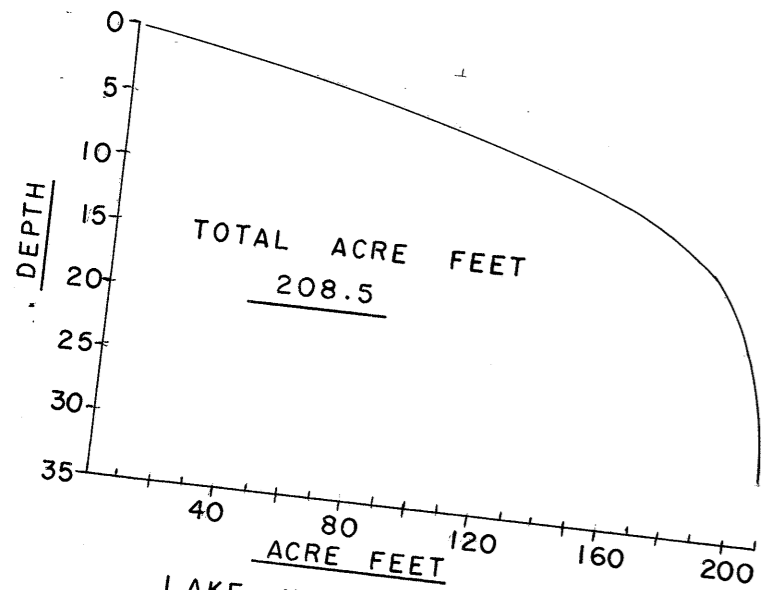
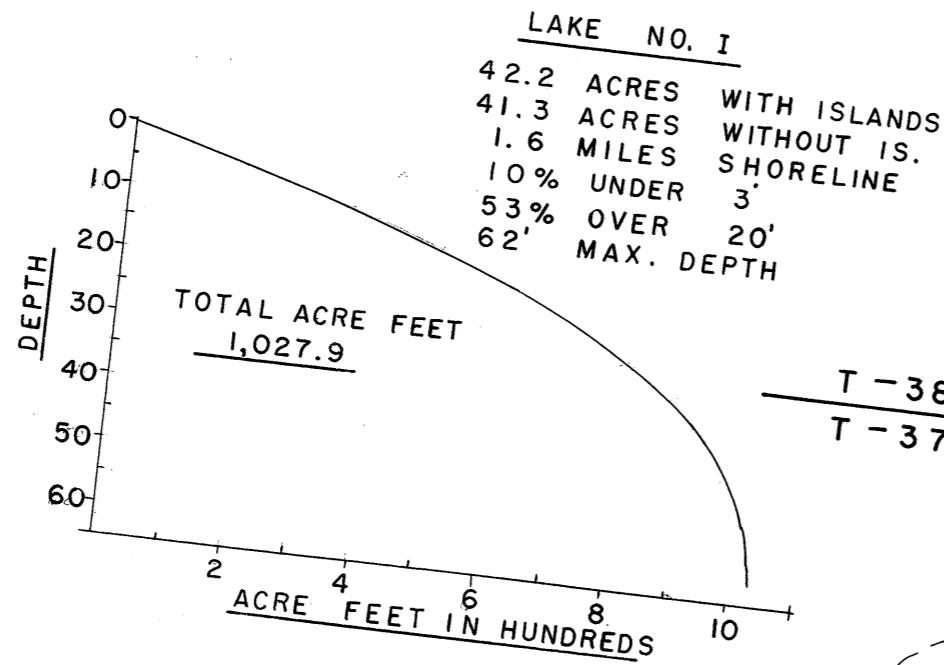

LAKE NO. 4  
24.5 ACRES WITH ISLAND  
23.6 ACRES WITHOUT IS.  
1.5 MILES SHORELINE  
9% UNDER 3'  
9% OVER 20'  
30' MAX. DEPTH

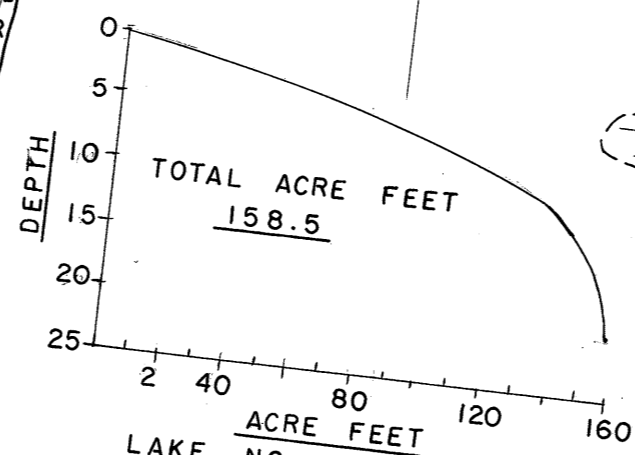

LAKE NO. 3  
20.7 ACRES WITH ISLAND  
20.0 ACRES WITHOUT IS.  
1.3 MILES SHORELINE  
15% UNDER 3'  
0% OVER 20'  
20' MAX. DEPTH

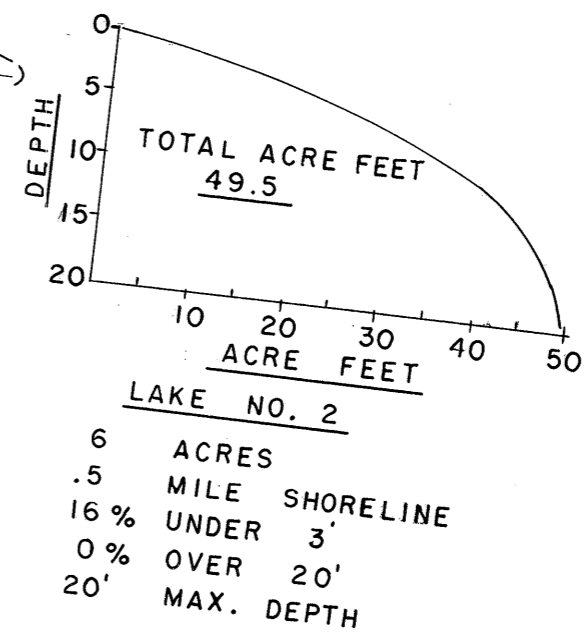

LAKE NO. 2  
6 ACRES  
.5 MILE SHORELINE  
16% UNDER 3'  
0% OVER 20'  
20' MAX. DEPTH

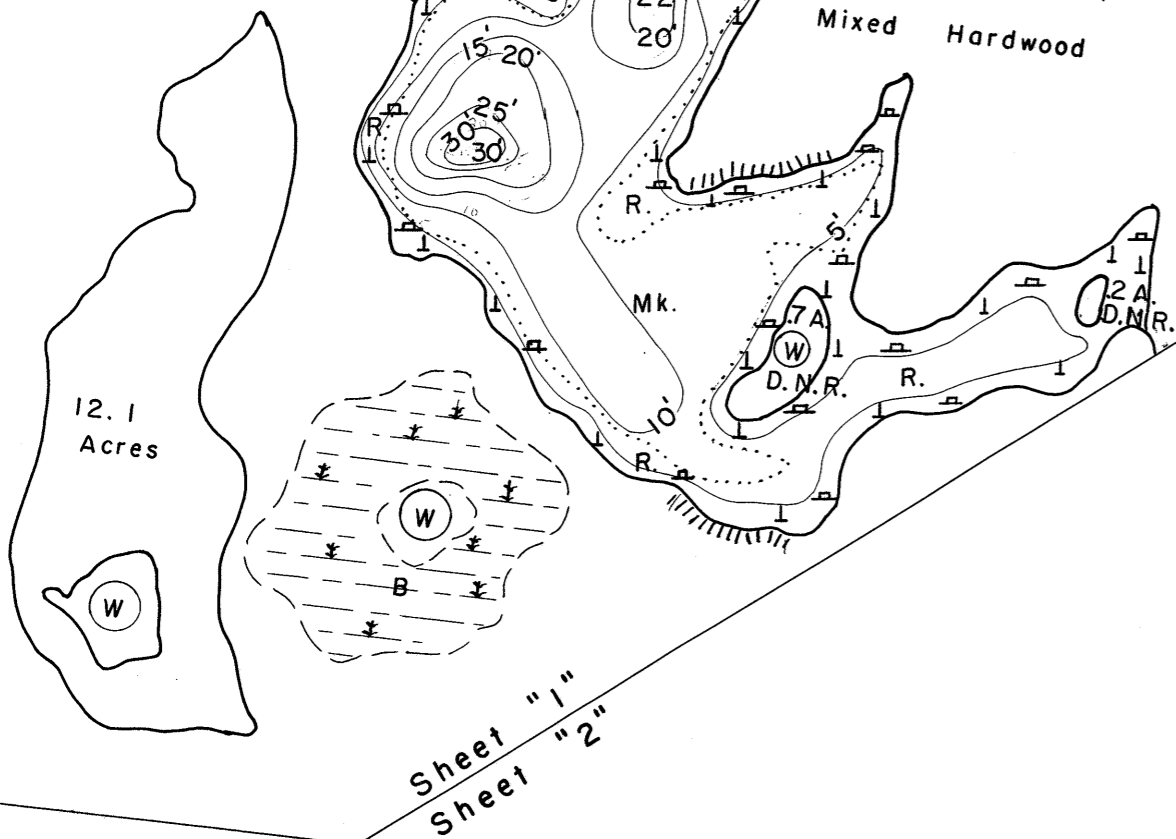

COUNTY  
FOREST

D.N.R. B.M. 'X' 1092 - A BRONZE TABLET  
SET IN TOP OF CONCRETE POST 45' FROM  
EAST SHORE OF LAKE NO. 1, SOUTH  
OF INLET.  
ASSUMED ELEV. 100.00'  
WATER ELEV. 91.98'

SPECIES OF FISH		
	Abundant	Rare
Muskie		
N. Pike	X	
Walleye		X
L.M. Bass	X	
S.M. Bass		
Panfish	X	
Trout		

EQUIPMENT RECORDING SONAR MAPPED AUGUST 1967  
MO. YR.

WATER ELEV. 91.98

- TOPOGRAPHIC SYMBOLS
- (B) Brush
  - (PW) Partially wooded
  - (W) Wooded
  - (C) Cleared
  - (P) Pastured
  - (A) Agricultural
  - B.M. Bench Mark
  - Dwelling
  - Resort
  - ||||| Steep slope
  - - - Indefinite shoreline
  - Marsh
  - Spring
  - Intermittent stream
  - Permanent inlet
  - Permanent outlet
  - Dam
  - D.N.R. State owned land
- LAKE BOTTOM SYMBOLS
- P. Peat
  - Mk. Muck
  - C. Clay
  - M. Marl
  - Sd. Sand
  - St. Silt
  - Gr. Gravel
  - R. Rubble
  - Br. Bedrock
  - T Submergent vegetation
  - Emergent vegetation
  - Floating vegetation
  - Stumps & Snags

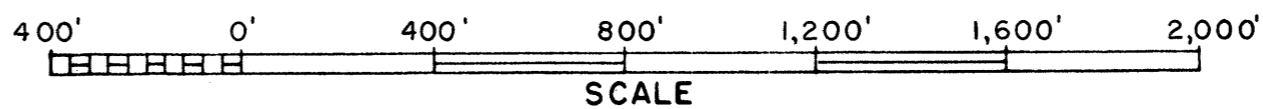

- ◇ Access
  - ◈ Access with Parking
  - ◆ Boat Livery
- Field work by C. Busch, N. Pokorney, L. Sather Drawn by: E. Eaton

(TOTALS) 290.1 WITH ISLANDS  
AREA 261.5 ACRES  
UNDER 3FT. 9%  
OVER 20FT. 24%  
VOLUME 3,806.7 ACRE FT.  
TOTAL ALK. 13 P.P.M.  
SHORELINE 10.6 14.2 MILES  
MAX. DEPTH 62 FEET

Source: Wisconsin Department of Natural Resources 608-266-2621  
Spider Lake Chain - Washburn County, Wisconsin DNR Lake Map  
Date – Aug 1967 - Historical Lake Map - Not for Navigation  
A Public Document - Please Identify the Source when using it.