

LAKE SURVEY MAP

LAKE TAITER (Sheet 1 of 4)
SECTIONS 6-36-31-30-29-21-20-16-15-14-9
TOWNSHIP T. 28-29 N.
RANGE R. 12-13 W
TOWN TAITER-RED CEDAR-SHERMAN
COUNTY DUNN

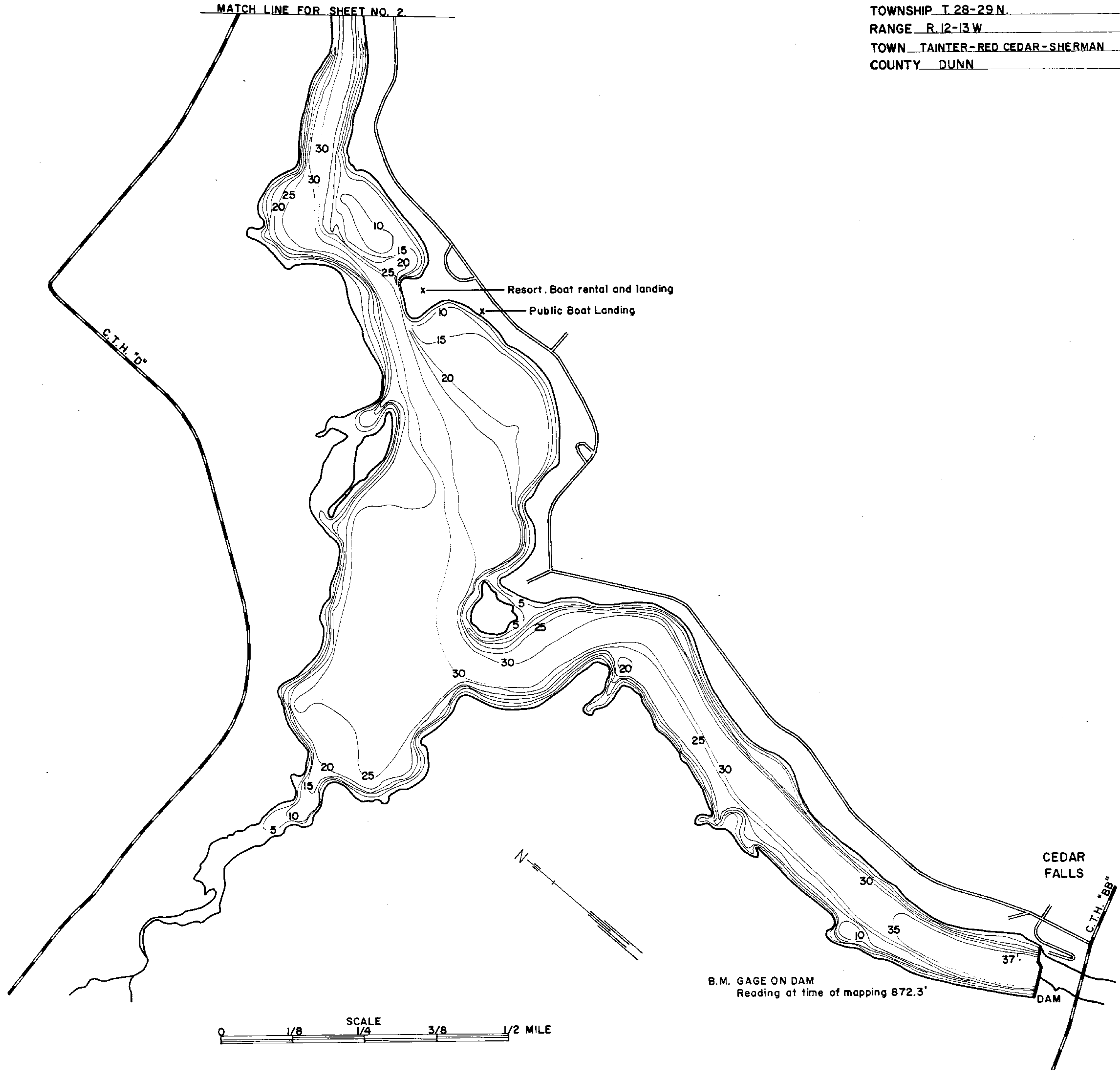

LAKE MAPPED 1960
SOURCE OF INFORMATION
SOUNDINGS Contour interval 5'

AREA 1752 Acres (Islands not included)
TOTAL SHORELINE 25.7 Miles
MAX. DEPTH 37'
SCALE: 8"=1 Mile

LAKE TAITER (Sheet 2 of 4)
SECTIONS 6-36-31-30-29-21-20-16-15-14-9
TOWNSHIP T. 28-29 N.
RANGE R. 12-13 W.
TOWN TAITER-RED CEDAR-SHERMAN
COUNTY DUNN

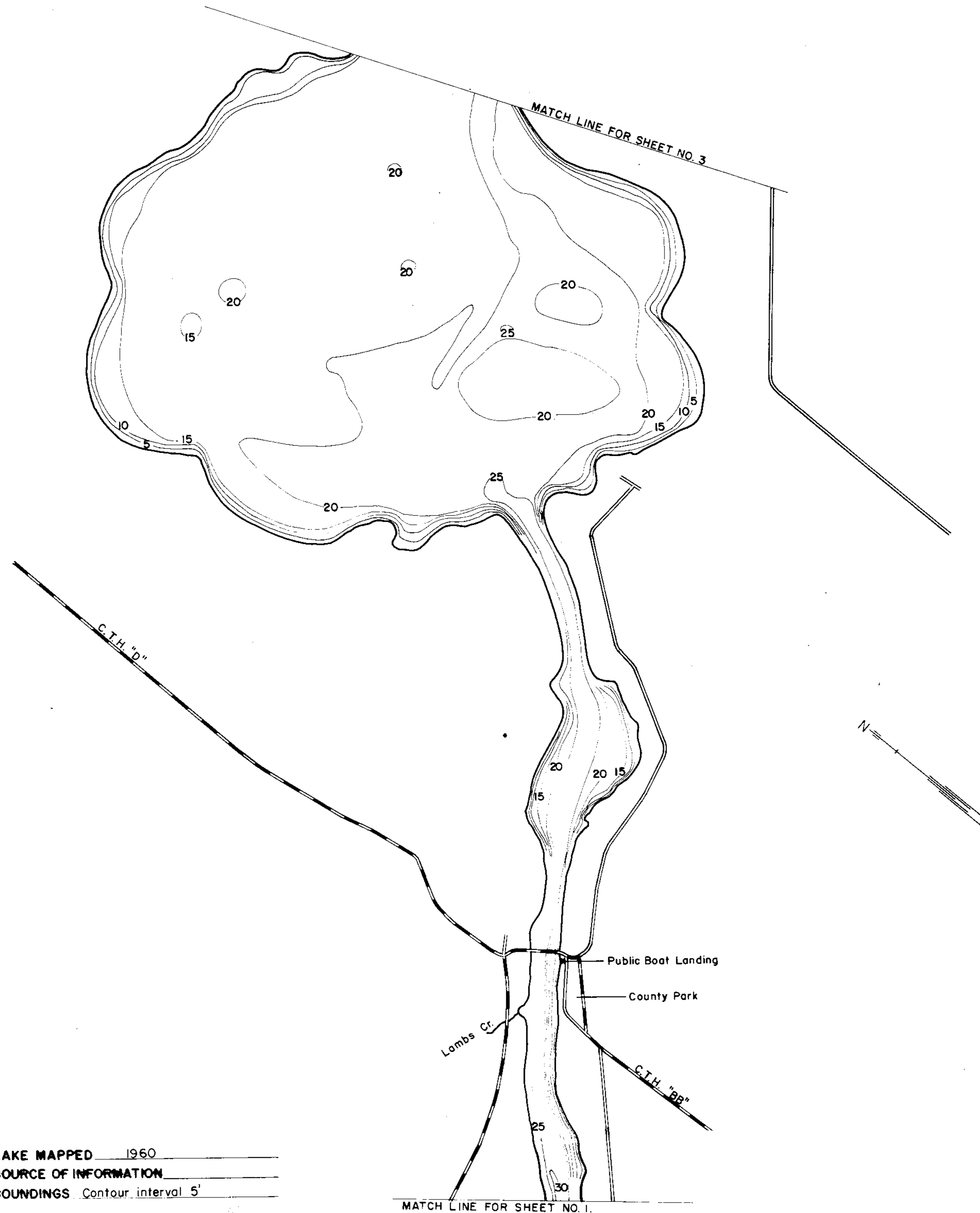

LAKE MAPPED 1960
SOURCE OF INFORMATION
SOUNDINGS Contour interval 5'

AREA 1752 Acres (Islands not included)
TOTAL SHORELINE 25.7 Miles
MAX. DEPTH 37'
SCALE: 8"=1 Mile

LAKE Tainter (Sheet 3 of 4)
SECTIONS 6-36-31-30-29-21-20-16-15-14-9
TOWNSHIP T. 28-29 N.
RANGE R. 12-13 W.
TOWN Tainter-Red Cedar-Sherman
COUNTY Dunn

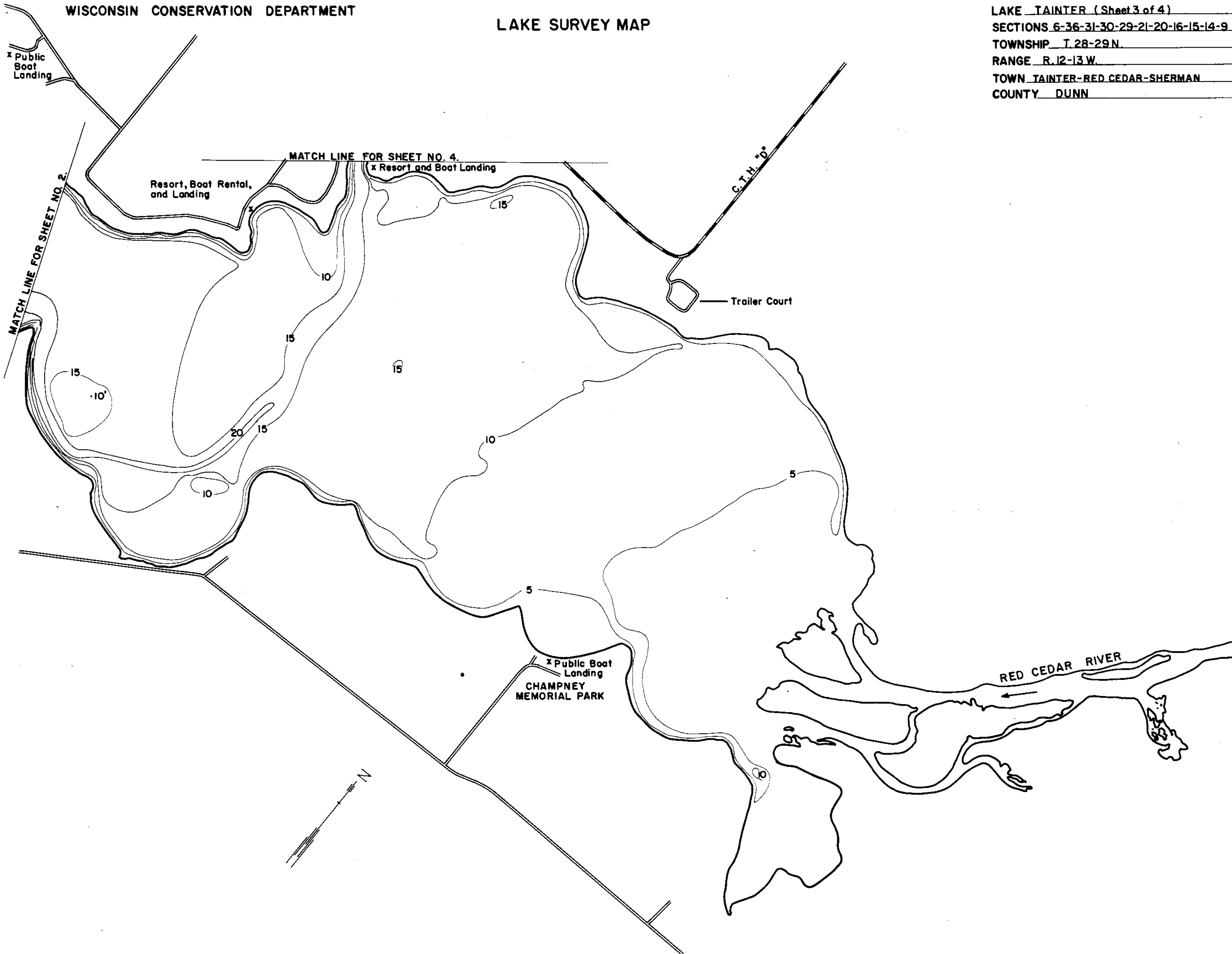

LAKE MAPPED 1960
SOURCE OF INFORMATION _____
SOUNDINGS Contour interval 5'

AREA 1752 Acres (islands not included)
TOTAL SHORELINE 25.7 Miles
MAX. DEPTH 37'
SCALE: 8" = 1 Mile

LAKE TAITER (Sheet 4 of 4)
SECTIONS 6-36-31-30-29-21-20-16-15-14-9
TOWNSHIP T. 28-29 N.
RANGE R. 12-13 W.
TOWN TAITER-RED CEDAR-SHERMAN
COUNTY DUNN

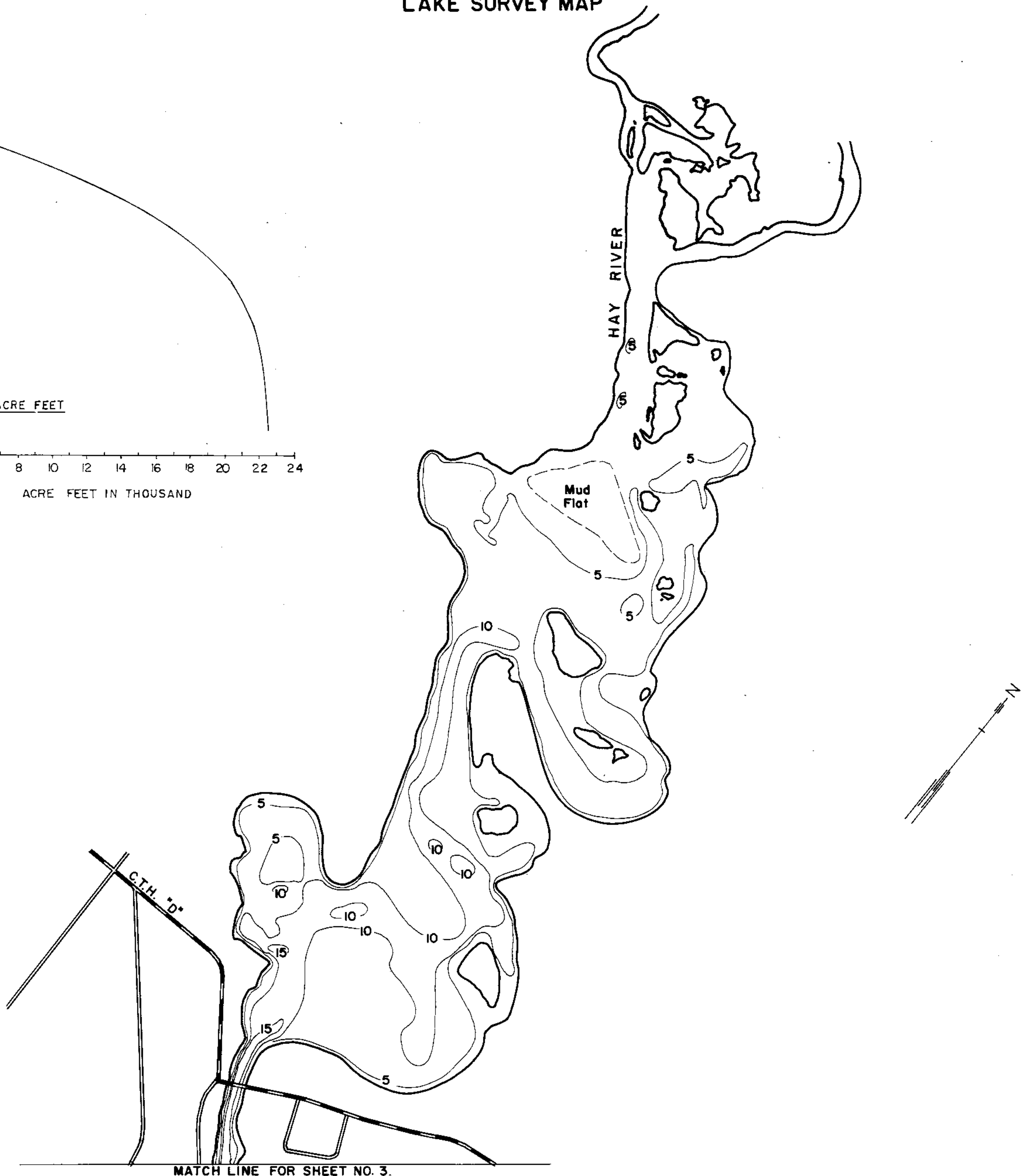
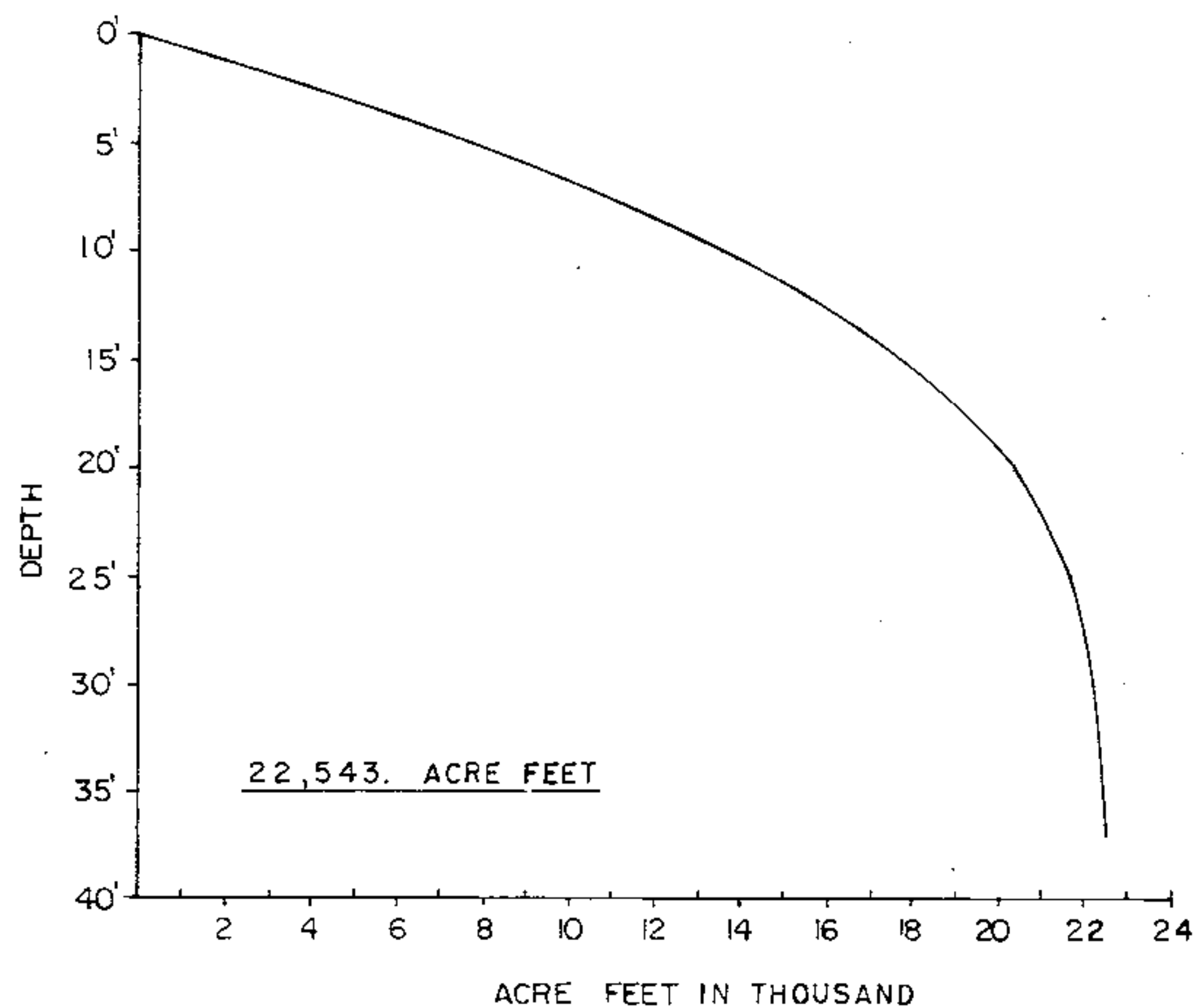

LAKE MAPPED 1960
SOURCE OF INFORMATION
SOUNDINGS Contour interval 5'

AREA 1752 Acres (Islands not included)
TOTAL SHORELINE 25.7 Miles
MAX. DEPTH 37'
SCALE: 8" = 1 Mile

Source: Wisconsin Department of Natural Resources 608-266-2621
Tainter Lake – Dunn County, Wisconsin DNR Lake Map
Date – 1960 - Historical Lake Map - Not for Navigation
A Public Document - Please Identify the Source when using it.