

# LAKE SURVEY MAP

LAKE STAR  
 SECTION 9  
 TOWNSHIP 31 N  
 RANGE 8 W  
 TOWN OF CLEVELAND  
 COUNTY CHIPPEWA

FORM FI-117

WISCONSIN CONSERVATION DEPARTMENT  
 BIOLOGY DIVISION  
 LAKE AND STREAM IMPROVEMENT SECTION

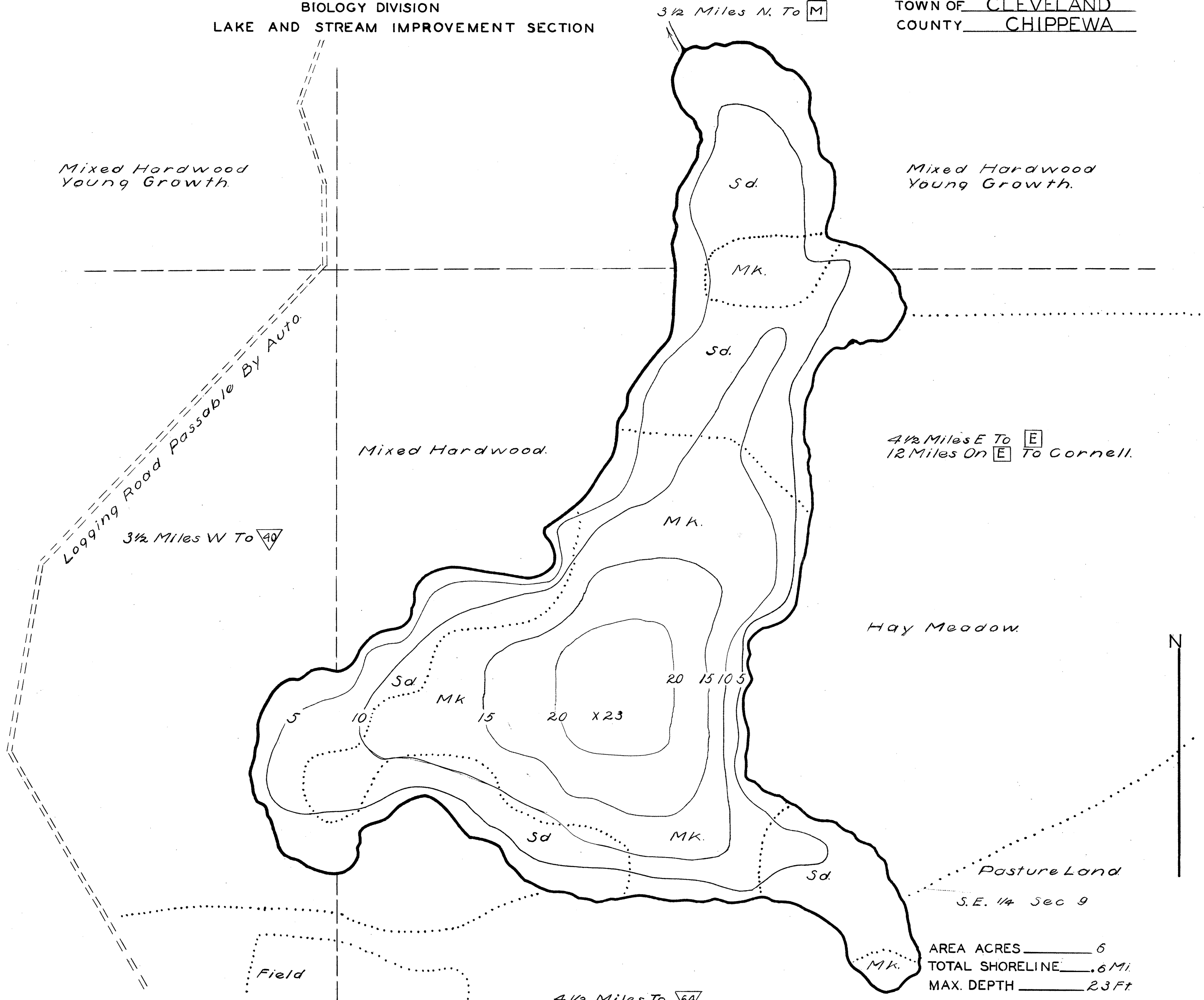

AREA ACRES 6  
 TOTAL SHORELINE .6 MI.  
 MAX. DEPTH 23 FT.

CHECKED BY  
 W.P.S. - E.M.K.  
 6-13-41

DATE April 2 1941  
 COMPILED BY \_\_\_\_\_  
 TRACED BY R.A. N.L.M. W.P.A.  
 SOURCE OF INFORMATION \_\_\_\_\_  
W.P.A. Lake Survey  
Project  
 SOUNDINGS At 66 Ft Intervals  
 DATES OF MAP REVISION \_\_\_\_\_  
 WORK AGENCY W.P.A.

LAKE IMPROVEMENT RECORD				
TYPE	DATE			
⊕ BRUSH REFUGES	_____	_____	_____	_____
~ SAPLING TANGLES	_____	_____	_____	_____
□ SPAWNING BOXES	_____	_____	_____	_____
* MINNOW SPAWNERS	_____	_____	_____	_____
TOTAL	_____	_____	_____	_____

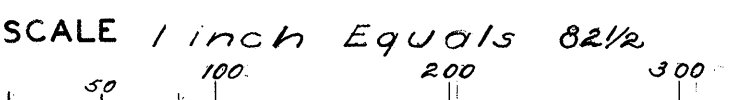

- LEGEND**
- WEED BEDS
  - ROCKY SHOALS
  - Sd.* SAND
  - Cl.* CLAY
  - Gr.* GRAVEL
  - Mk.* MUCK
  - DWELLING
  - ABANDONED DWELLING
  - RESORT

Source: Wisconsin Department of Natural Resources 608-266-2621  
Star Lake – Chippewa County, Wisconsin DNR Lake Map  
Date – Apr 1941 - Historical Lake Map - Not for Navigation  
A Public Document - Please Identify the Source when using it.