

LAKE SURVEY MAP

WISCONSIN CONSERVATION DEPARTMENT
BIOLOGY DIVISION
LAKE AND STREAM IMPROVEMENT SECTION

LAKE _____ TOWN LINE _____
SECTION 33
TOWNSHIP 32 N
RANGE 8 W
TOWN OF SAMPSON
COUNTY CHIPPEWA

FORM.FI-117

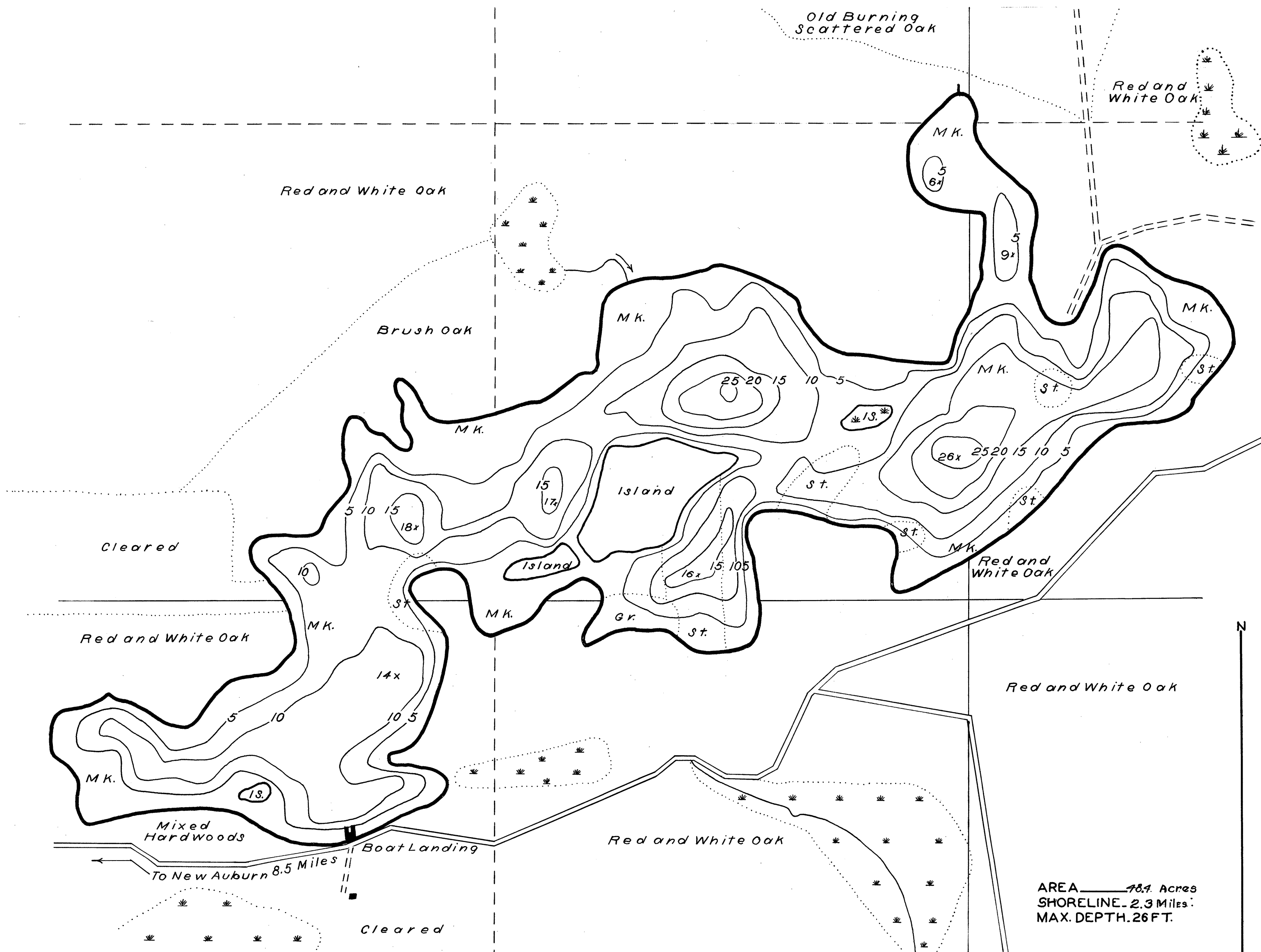

AREA 78.7 Acres
SHORELINE 2.3 Miles
MAX. DEPTH 26 FT.

DATE April 15 1940
COMPILED BY H.K.Jr.
TRACED BY R.C.(W.P.A.)
SOURCE OF INFORMATION WPA Lake Survey Project
SOUNDINGS At 6 Rod Intervals
DATES OF MAP REVISION March 1940
WORK AGENCY W.P.A.
CHECKED BY W.P.S.
3-31-41

LAKE IMPROVEMENT RECORD

TYPE	DATE				
BRUSH REFUGES	_____	_____	_____	_____	_____
SAPLING TANGLES	_____	_____	_____	_____	_____
SPAWNING BOXES	_____	_____	_____	_____	_____
MINNOW SPAWNERS	_____	_____	_____	_____	_____
TOTAL	_____	_____	_____	_____	_____

SCALE 1 inch Equal 220 Ft.
0 50 100 150 200 250 300 350 400 450 500 Feet

- LEGEND**
- WEED BEDS
 - ROCKY SHOALS
 - SAND
 - CLAY
 - GRAVEL
 - MUCK
 - DWELLING
 - ABANDONED DWELLING
 - RESORT
 - SILT

Source: Wisconsin Department of Natural Resources 608-266-2621
Town Line Lake – Chippewa County, Wisconsin DNR Lake Map
Date – Apr 1940 - Historical Lake Map - Not for Navigation
A Public Document - Please Identify the Source when using it.