

LAKE SURVEY MAP

LAKE SPENCE
SECTION 1-2
TOWNSHIP 32 N
RANGE 8 W
TOWN OF SAMPSON
COUNTY CHIPPEWA

WISCONSIN CONSERVATION DEPARTMENT
BIOLOGY DIVISION
LAKE AND STREAM IMPROVEMENT SECTION

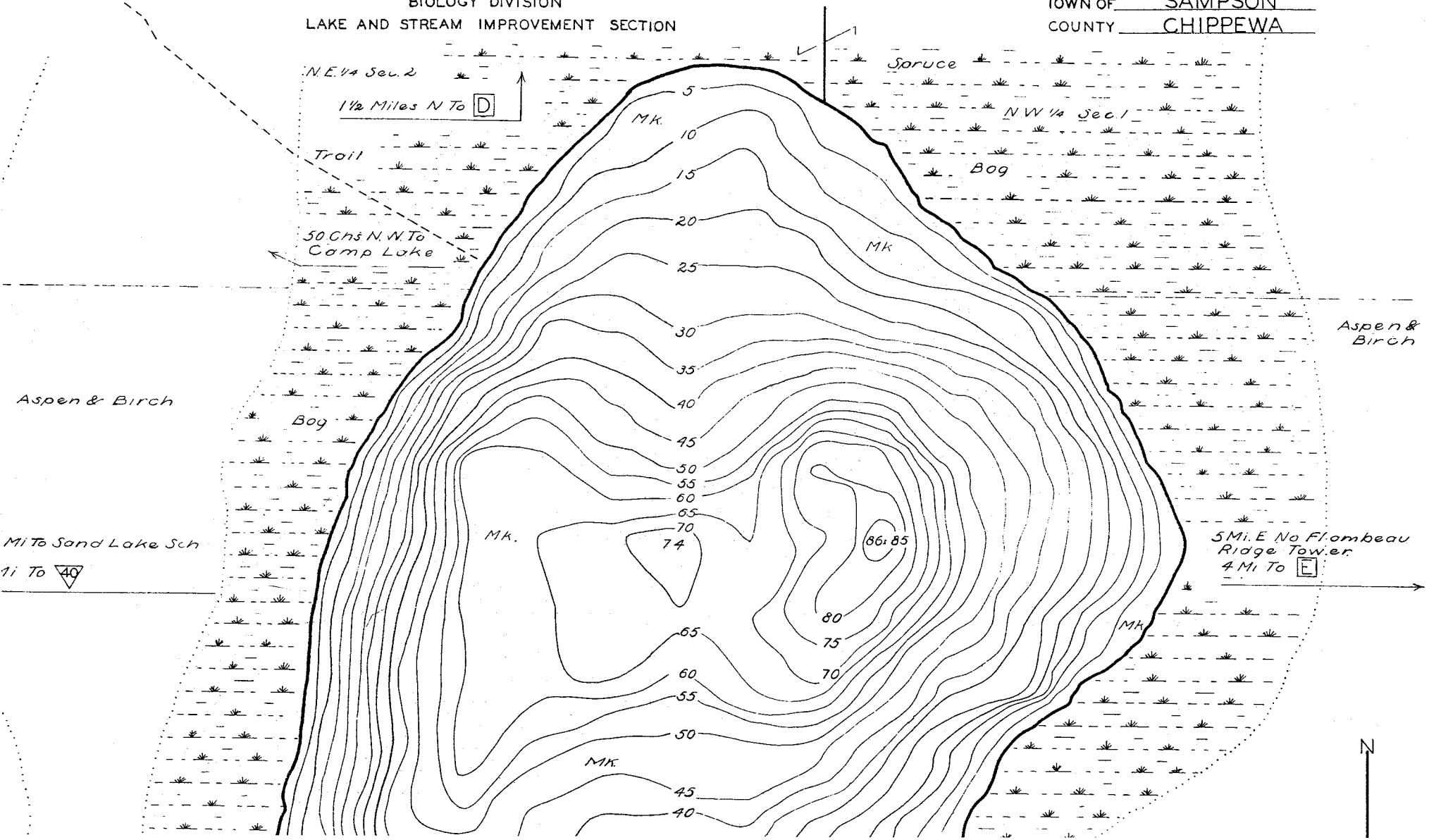

LAKE SURVEY MAP

LAKE _____
 SECTION _____
 TOWNSHIP _____
 RANGE _____
 TOWN OF SA
 COUNTY CL

WISCONSIN CONSERVATION DEPARTMENT
 BIOLOGY DIVISION
 LAKE AND STREAM IMPROVEMENT SECTION

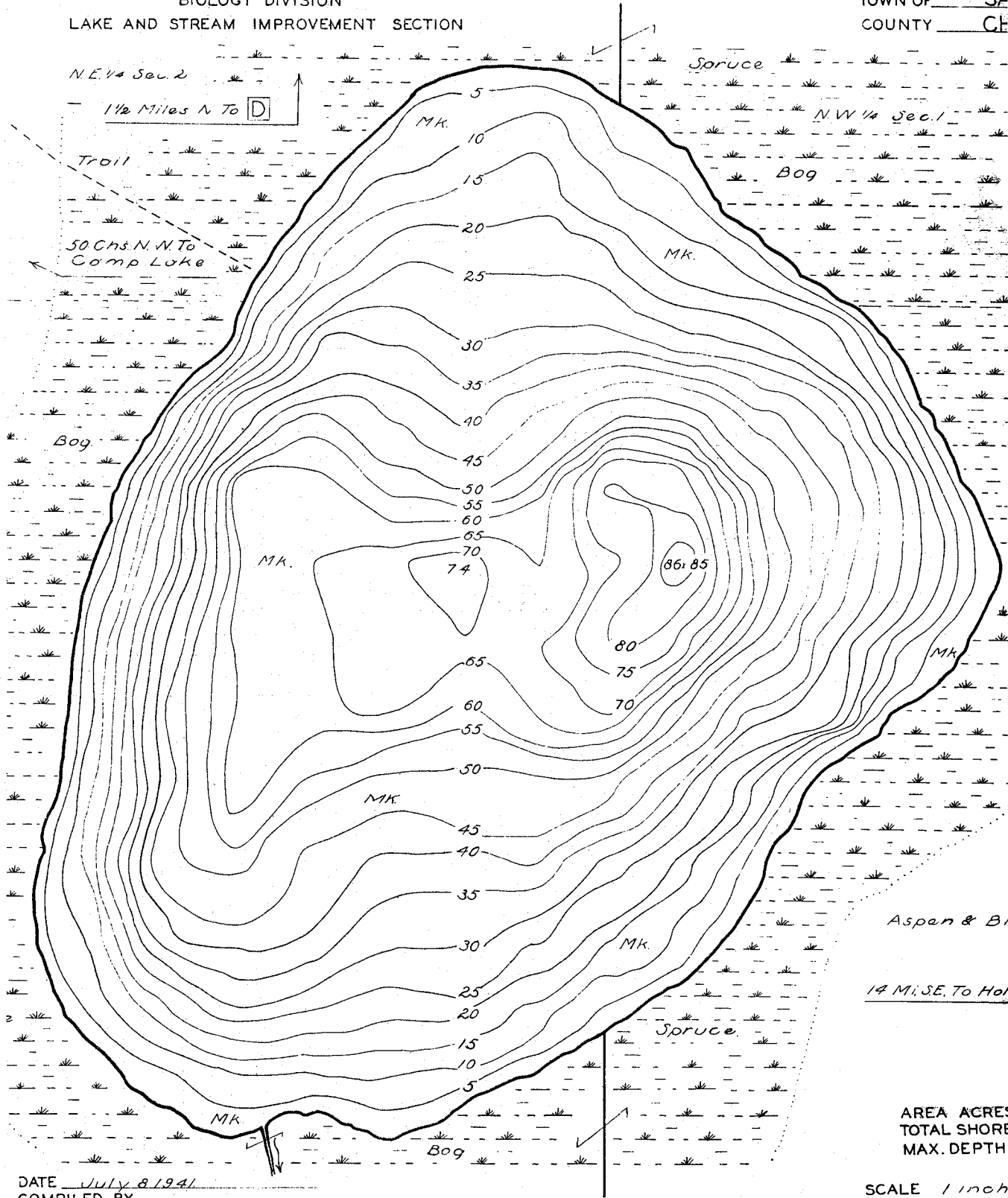

DATE July 8 1941
 COMPILED BY _____
 TRACED BY N.L.M. (W.P.A.)
 SOURCE OF INFORMATION _____
W.P.A. Lake Survey Project

 SOUNDINGS At 6.6 Ft Intervals

 DATES OF MAP REVISION _____

 WORK AGENCY W. P. A.

LAKE IMPROVEMENT RECORD	
TYPE	DATE
◇ BRUSH REFUGES	_____
~ SAPLING TANGLES	_____
□ SPAWNING BOXES	_____
* MINNOW SPAWNERS	_____
TOTAL	_____

AREA ACRES _____
 TOTAL SHORE _____
 MAX. DEPTH _____

SCALE 1 inch = 50 feet

LEGEND

- ⊙ WEED BEDS
- ⊙ ROCK SHOALS
- ⊙ SAND
- Cl CLAY
- Gr GRAVEL
- Mk MUCK
- DWELLING
- ABANDONED
- RESORT

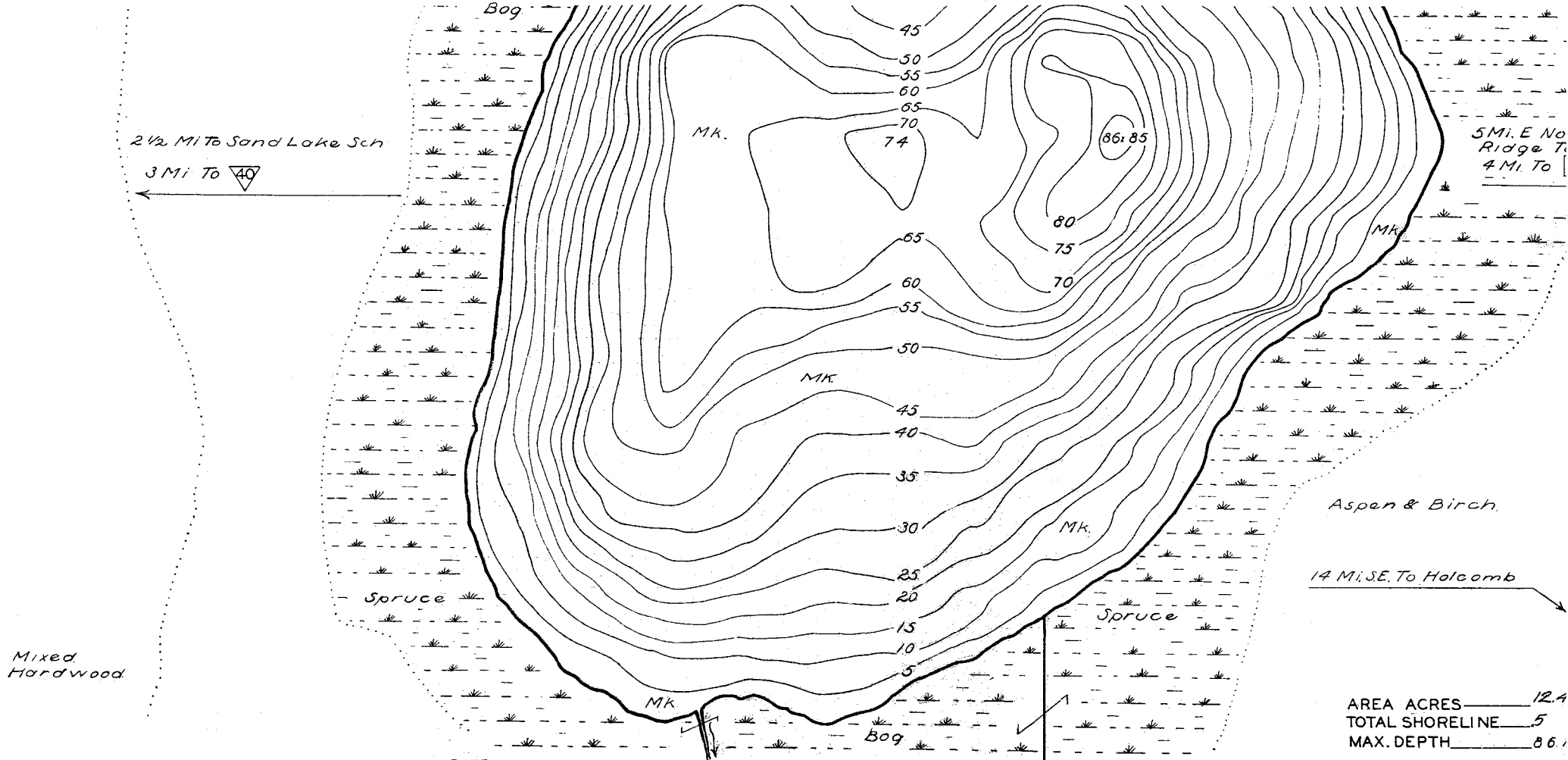

AREA ACRES 12.4
 TOTAL SHORELINE 5
 MAX. DEPTH 86.1

SCALE 1 inch Equals 80
 0 50 100 200

DATE July 8 1941
 COMPILED BY _____
 TRACED BY N.L.M. (WPA)
 SOURCE OF INFORMATION WPA Lake Survey Project
 SOUNDINGS At 66 Ft Intervals
 DATES OF MAP REVISION _____
 WORK AGENCY W. P. A.

LAKE IMPROVEMENT RECORD	
TYPE	DATE
⊕ BRUSH REFUGES	_____
~ SAPLING TANGLES	_____
□ SPAWNING BOXES	_____
* MINNOW SPAWNERS	_____
TOTAL	_____

LEGEND	
⊕	WEED BEDS
~	ROCK SHOALS
□	SAND
Cl	CLAY
Gr	GRAVEL
Mk	MUCK
■	DWELLING
□	ABANDONED DWELLING
■	RESORT

Source: Wisconsin Department of Natural Resources 608-266-2621
Spence Lake – Chippewa County, Wisconsin DNR Lake Map
Date – Jul 1941 - Historical Lake Map - Not for Navigation
A Public Document - Please Identify the Source when using it.