

# LAKE SURVEY MAP

WISCONSIN CONSERVATION DEPARTMENT  
BIOLOGY DIVISION  
LAKE AND STREAM IMPROVEMENT SECTION

LAKE No. 4  
SECTION 4  
TOWNSHIP 32 N  
RANGE 8 W  
TOWN OF SAMPSON  
COUNTY CHIPPEWA

FORM FI-117

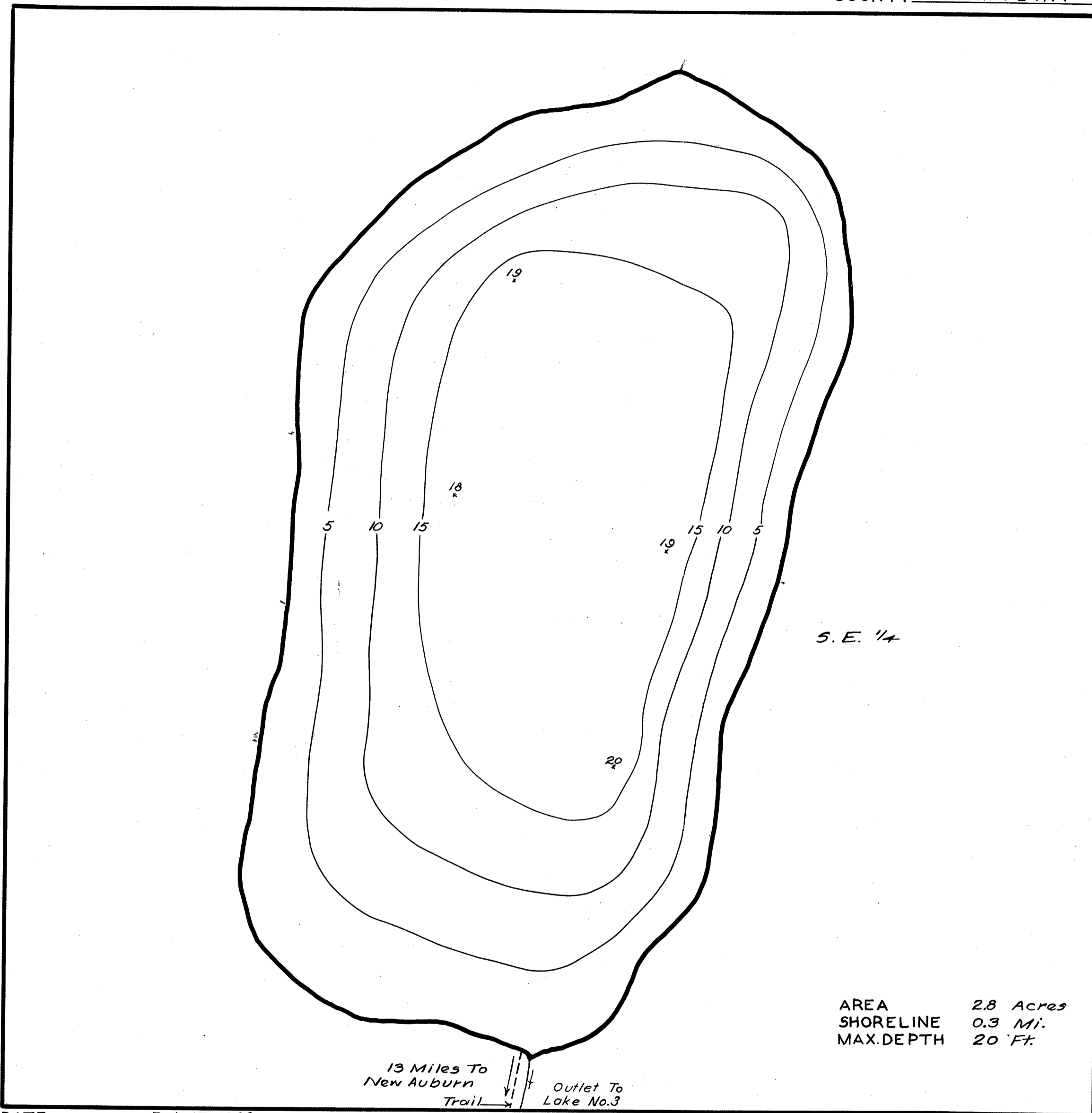

DATE Feb. 17, 1939  
COMPILED BY H.K. Jr.  
TRACED BY R.F.F.  
SOURCE OF INFORMATION  
W.P.A. Lake Survey Project  
  
SOUNDINGS At 6 Rod Intervals  
W.P.A. Lake Survey Project  
  
DATES OF MAP REVISION \_\_\_\_\_  
  
WORK AGENCY W.P.A.  
CHECKED BY W.P.S.  
3-6-41

LAKE IMPROVEMENT RECORD				
TYPE	DATE			
⊕ BRUSH REFUGES	_____	_____	_____	_____
~ SAPLING TANGLES	_____	_____	_____	_____
□ SPAWNING BOXES	_____	_____	_____	_____
* MINNOW SPAWNERS	_____	_____	_____	_____
TOTAL	_____	_____	_____	_____

SCALE 1 inch = 55 Ft.  
0 50 100 200  
Feet

- LEGEND
- ⊙ WEED BEDS
  - ⊙ ROCKY SHOALS
  - Sd SAND
  - Cl CLAY
  - Gr GRAVEL
  - M MUCK
  - DWELLING
  - ABANDONED DWELLING
  - ▣ RESORT

Source: Wisconsin Department of Natural Resources 608-266-2621  
Number Four Lake (No. 4 Lake) – Chippewa County, Wisconsin DNR Lake Map  
Date – Feb 1939 - Historical Lake Map - Not for Navigation  
A Public Document - Please Identify the Source when using it.