

LAKE SURVEY MAP

LAKE _____
 SECTION 14 23
 TOWNSHIP 43 N
 RANGE 13 W
 TOWN OF WASCOTT
 COUNTY DOUGLAS

FORM FI-117

WISCONSIN CONSERVATION DEPARTMENT
 BIOLOGY DIVISION
 LAKE AND STREAM IMPROVEMENT SECTION

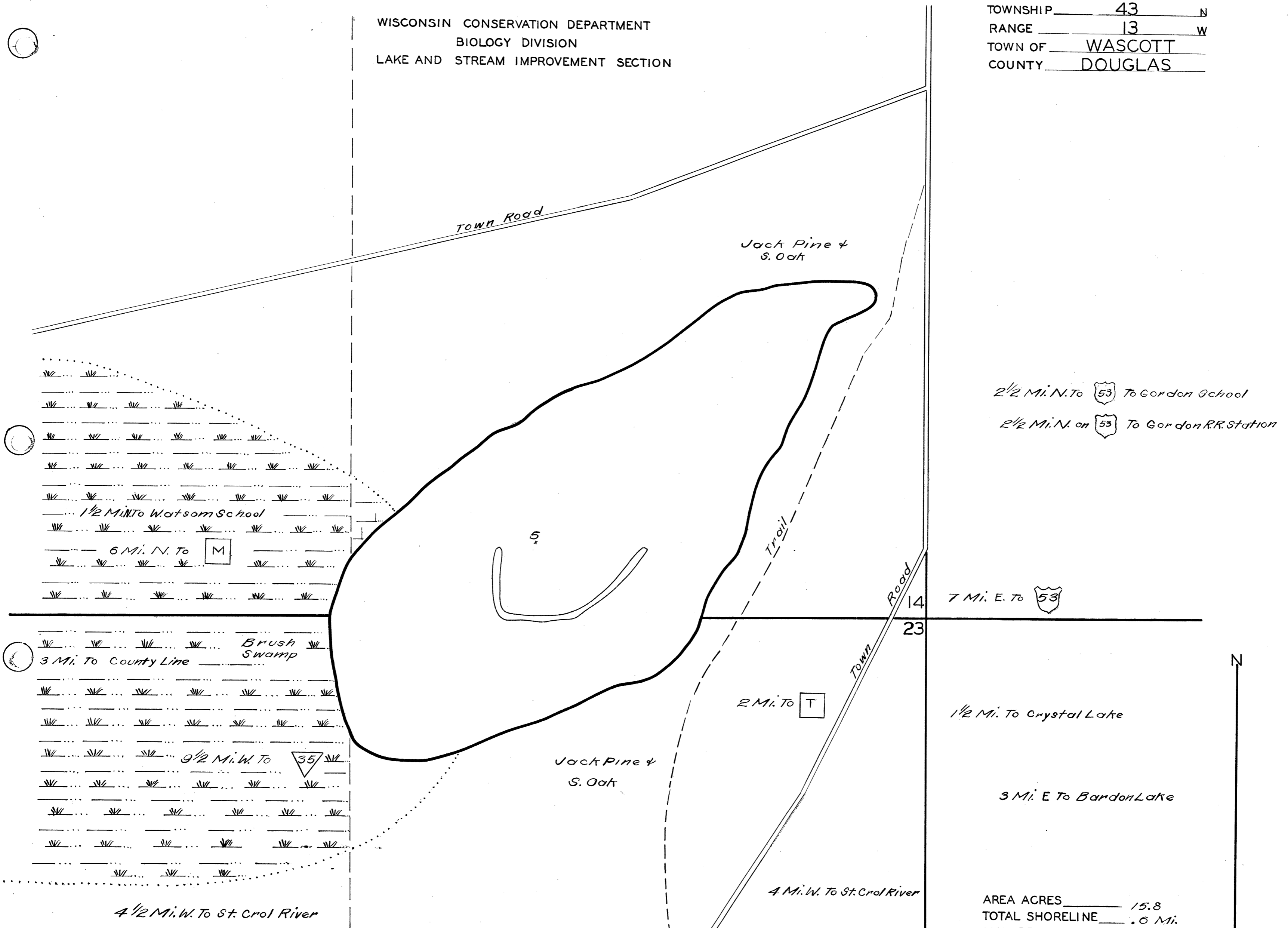

AREA ACRES _____ 15.8
 TOTAL SHORELINE _____ .6 Mi.
 MAX. DEPTH _____ 5 Ft.

SCALE 1 inch Equals 165 Ft.



DATE June 2 1941
 COMPILED BY _____
 TRACED BY W.T.Z. (W.P.A.)
 SOURCE OF INFORMATION _____
W.P.A. Lake Survey Project

 SOUNDINGS 165 Ft. intervals

 DATES OF MAP REVISION _____

 WORK AGENCY W. P. A.

LAKE IMPROVEMENT RECORD	
TYPE	DATE
○ BRUSH REFUGES	_____
⊞ SAPLING TANGLES	_____
□ SPAWNING BOXES	_____
* MINNOW SPAWNERS	_____
TOTAL	_____

LEGEND	
	WEED BEDS
	ROCKY SHOALS
	SAND
	CLAY
	GRAVEL
	MUCK
	DWELLING
	ABANDONED DWELLING
	RESORT

Handwritten notes:
 No. 187 P-4
 N. 15-10-15
 25

Source: Wisconsin Department of Natural Resources 608-266-2621
Un-Named Lake (T43 R13W S14 SE SE) – Douglas County, Wisconsin DNR Lake Map
Date – Jun 1941 - Historical Lake Map - Not for Navigation
A Public Document - Please Identify the Source when using it.