

*Big & Little*

18 17  
19 20

17 16  
20 21

16 15  
21 22

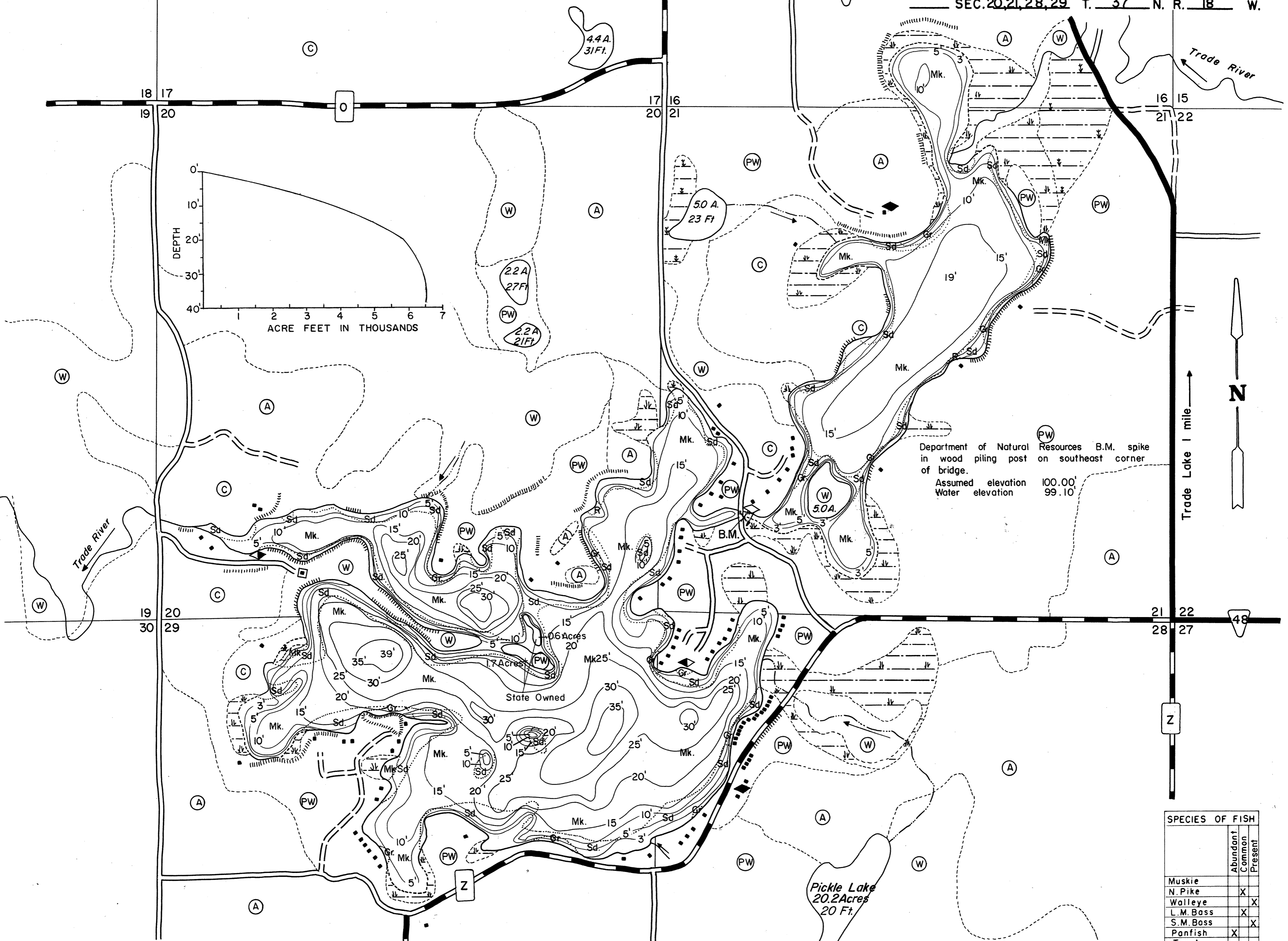
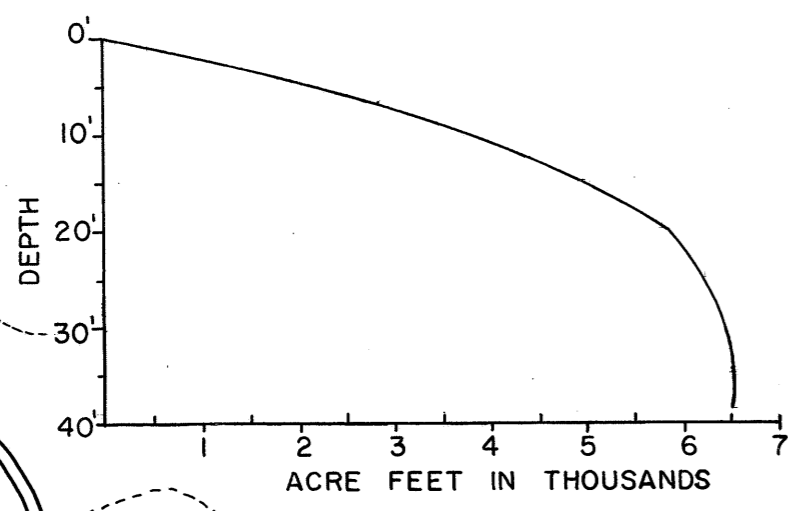

Department of Natural Resources B.M. spike  
in wood piling post on southeast corner  
of bridge.  
Assumed elevation 100.00'  
Water elevation 99.10'

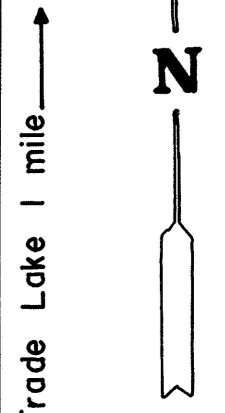

19 20  
30 29

21 22  
28 27

SPECIES OF FISH		
	Abundant	Present
Muskie		
N. Pike	X	
Walleye		X
L.M. Bass	X	
S.M. Bass		X
Panfish	X	
Trout		

EQUIPMENT RECORDING SONAR MAPPED MAY 1968  
MO. YR.

- TOPOGRAPHIC SYMBOLS
- (B) Brush
  - (PW) Partially wooded
  - (W) Wooded
  - (C) Cleared
  - (P) Pastured
  - (A) Agricultural
  - B.M. Bench Mark
  - Dwelling
  - Resort

- LAKE BOTTOM SYMBOLS
- P. Peat
  - Mk. Muck
  - C. Clay
  - M. Marl
  - Sd. Sand
  - St. Silt
  - Gr. Gravel
  - R. Rubble
  - Br. Bedrock
  - T Submergent vegetation
  - ↓ Emergent vegetation
  - ≡ Floating vegetation
  - Stumps & Snags

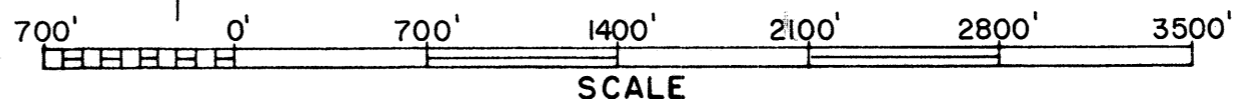

◇ Access      ◇ Access with Parking      ◆ Boat Livery  
Field work by C. Busch, C. Olson, L. Sather      Drawn by C. Holt

425.6 WITHOUT IS.  
AREA 433.7 ACRES  
UNDER 3 FT. 2.3 %  
OVER 20 FT. 46.2 %  
VOLUME 6522.3 ACRE FT.  
TOTAL ALK. 91 P.P.M.  
SHORELINE 8.4 MILES  
MAX. DEPTH 39 FEET

Source: Wisconsin Department of Natural Resources 608-266-2621  
Big and Little Trade Lake – Burnett County, Wisconsin DNR Lake Map  
Date – May 1968 - Historical Lake Map - Not for Navigation  
A Public Document - Please Identify the Source when using it.