

C.T.H. "P"

B.M. Established by the Wisconsin Railroad Comm. Located on top of bridge on the South side.

Public Access.

C.T.H. "B"

11 12  
14 13

12 7  
13 18

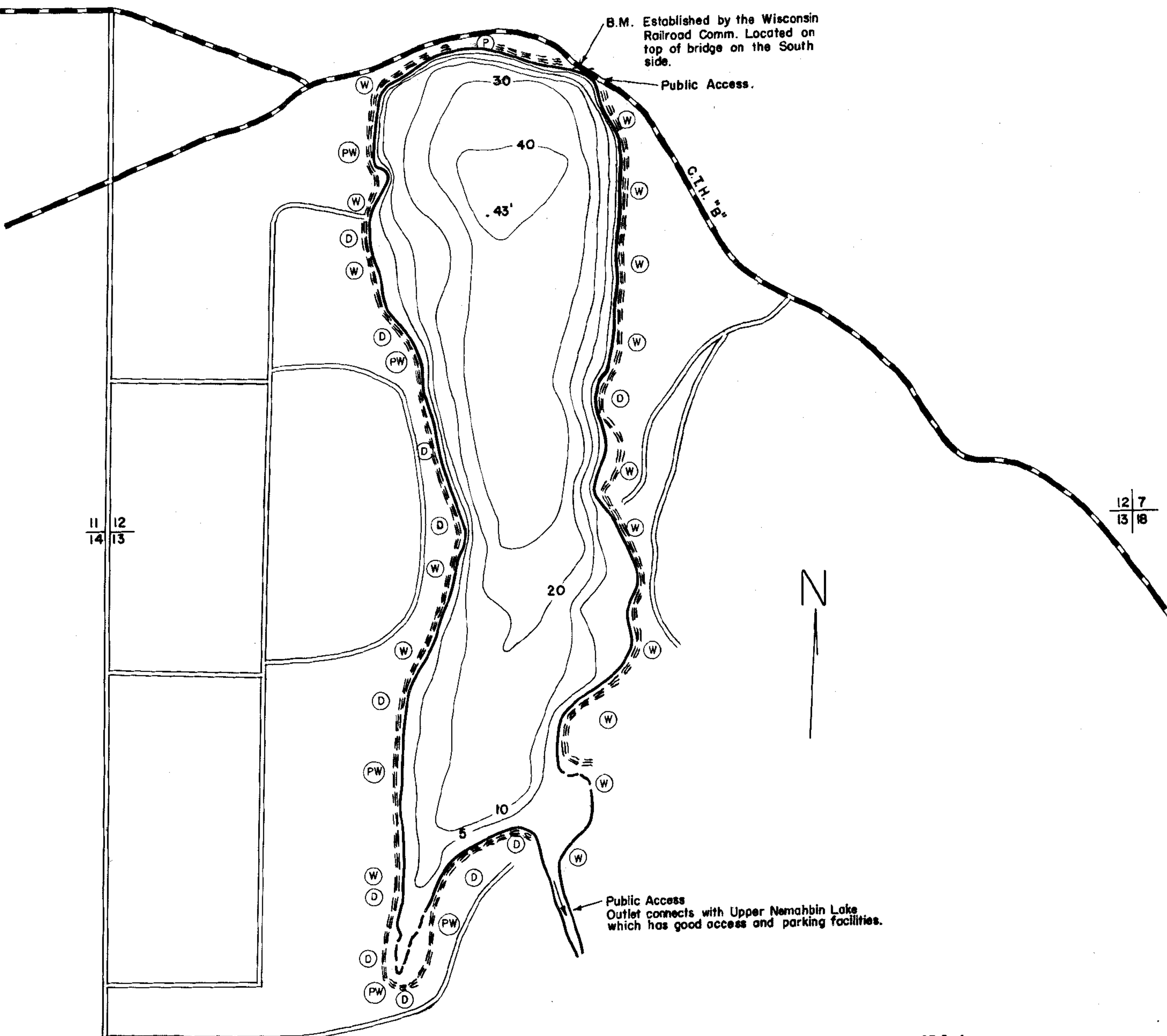

DATE 6/23/55  
SOURCE OF INFORMATION W.G.D.  
SOUNDINGS / Echo Sounder

AREA 95.2 Acres  
TOTAL SHORELINE 2.2 Miles  
MAX. DEPTH 43 Feet  
SCALE: 1" = 400'