

Fox River Milk Transfer Co-op

DePere, Brown County

The Fox River Milk Transfer discharges to Ashwaubenon Creek. The stream bed consists of rubble, gravel, and silt. The Creek receives a heavy silt load from runoff which results in high turbidity. The Creek supports carp, bullhead, and suckers but has little fishery value.

Recommendations

Ashwaubenon Creek should be classified as continuous/intermediate aquatic life.



Dan Uhl  
District Engineer

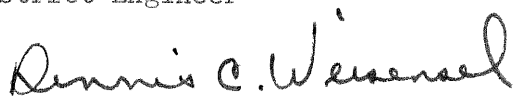

Dennis C. Weisensel  
District Biologist

DU:DCW:sh

FOX RIVER MILK TRANSFER COOP

SURVEY DATE : 8-27-75

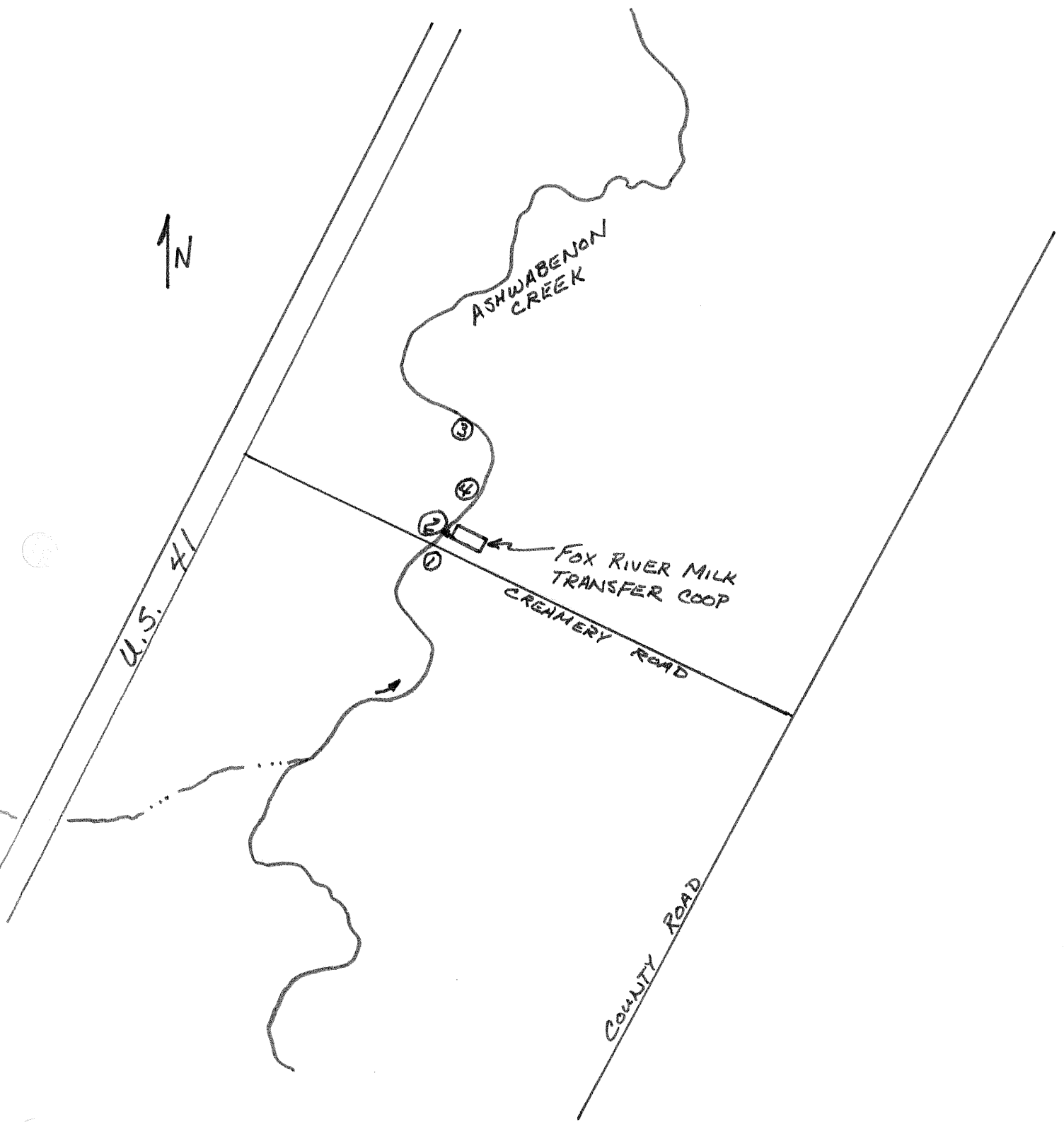

① PHOTO LOCATIONS

DU  
9-10-75

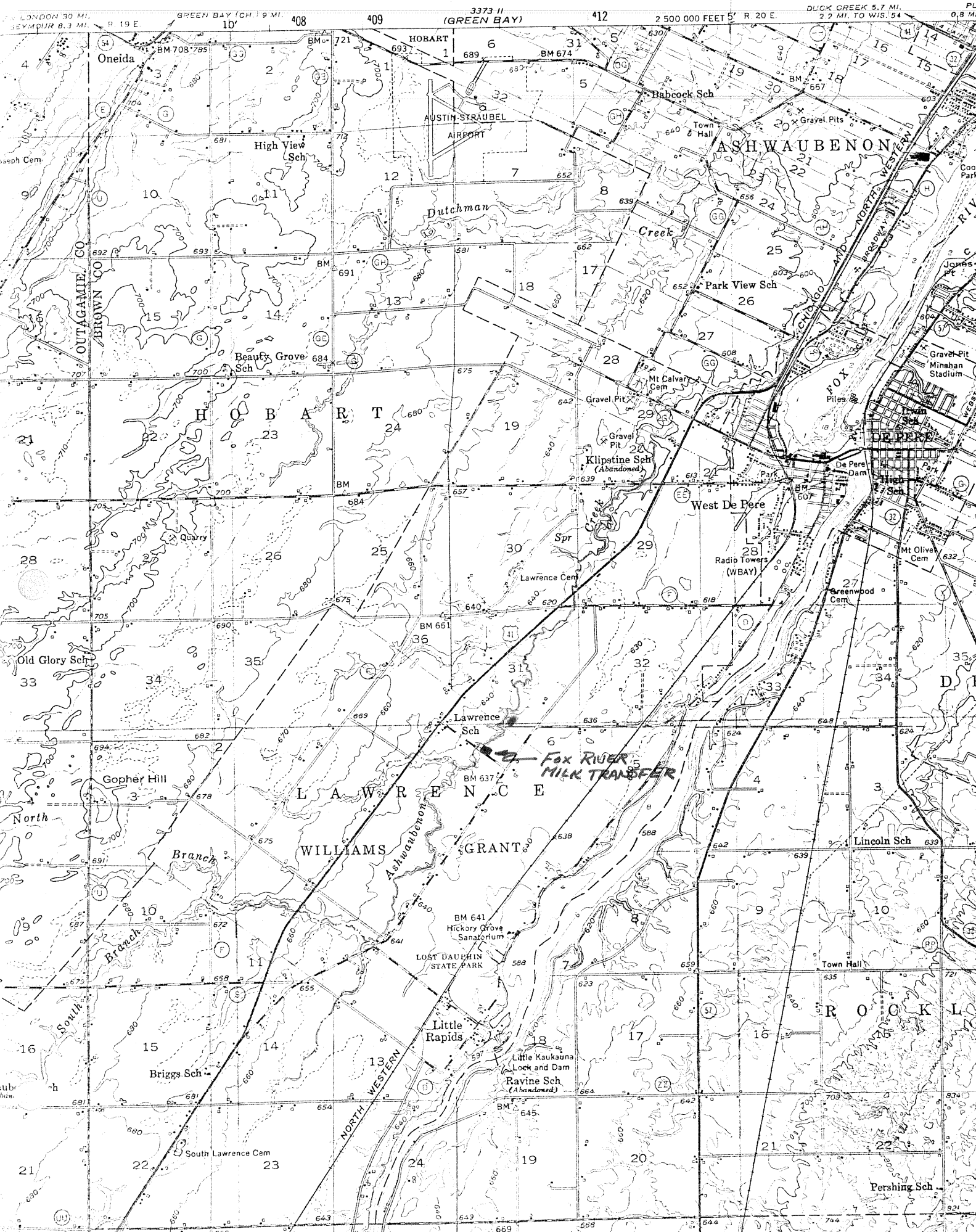

LONDON 30 MI. GREEN BAY (CH.) 9 MI. 3373 II (GREEN BAY) 408 409 412 2 500 000 FEET 5' R 20 E DUCK CREEK 5.7 MI. 2.2 MI. TO WIS. 54 0.8 MI.

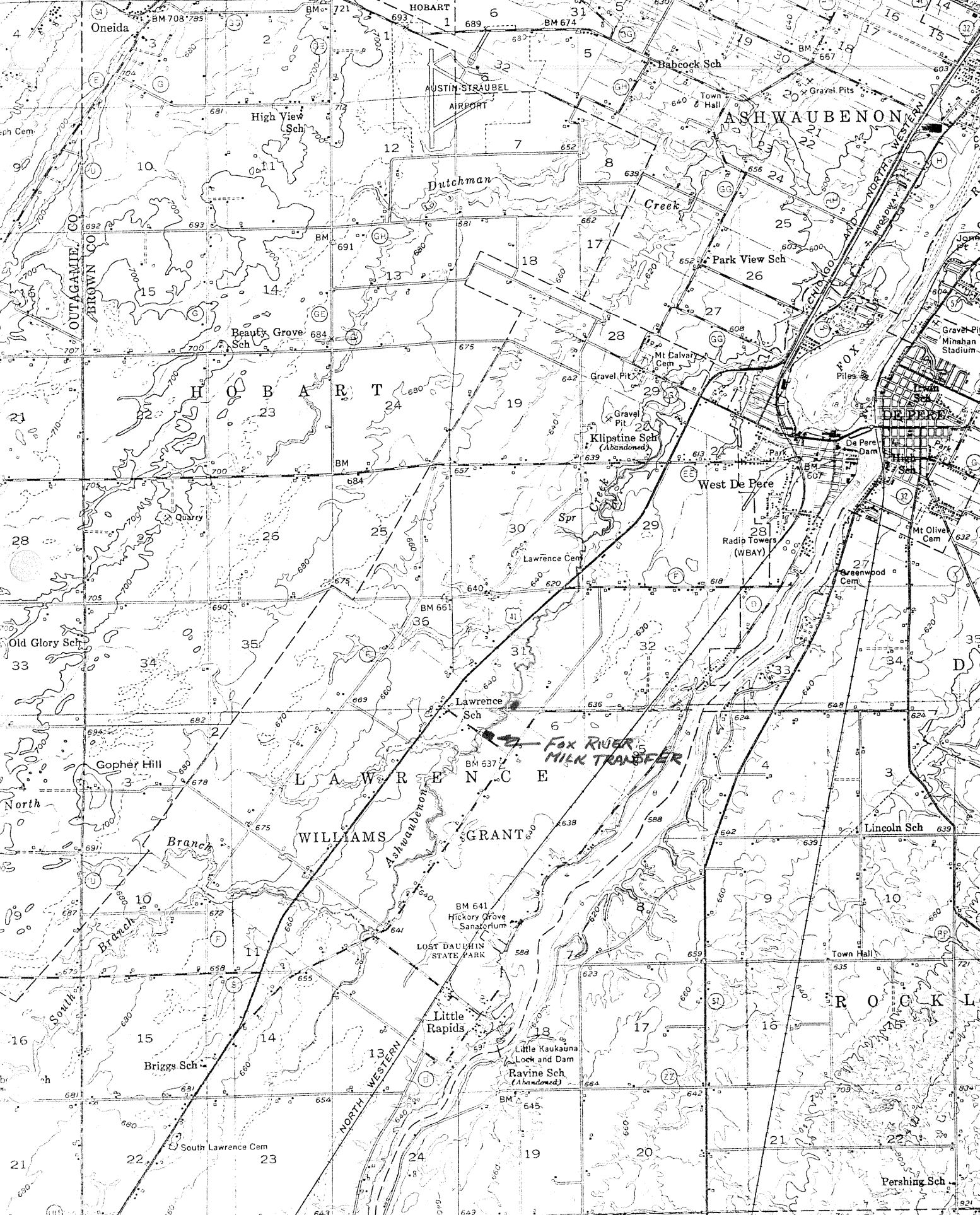

Fox River Milk Transfer

LAWRENCE

WILLIAMS

GRANT

ROCK

OUTAGAMIE CO  
BROWN CO

ASHWAUBENON  
DE PERE  
ROCK

Oneida  
High View Sch  
Beauty Grove Sch  
Old Glory Sch  
Gopher Hill  
Briggs Sch  
South Lawrence Cem

HOBART  
Dutchman Creek  
Spr Creek  
Lawrence Sch  
Little Rapids  
South Western

AUSTIN STRAUBEL AIRPORT  
Park View Sch  
Mt Calvary Cem  
Gravel Pit  
Klipstine Sch (Abandoned)  
Lawrence Cem  
Hickory Grove Sanatorium  
Little Kaukauna Lock and Dam  
Ravine Sch (Abandoned)

Babcock Sch  
Town Hall  
Gravel Pits  
Mt Olive Cem  
Greenwood Cem  
Lincoln Sch  
Town Hall  
Pershing Sch

ASHWAUBENON  
DE PERE  
De Pere Dam  
Mt Olive Cem  
Greenwood Cem  
Lincoln Sch  
Town Hall  
Pershing Sch

ASHWAUBENON  
DE PERE  
De Pere Dam  
Mt Olive Cem  
Greenwood Cem  
Lincoln Sch  
Town Hall  
Pershing Sch

ASHWAUBENON  
DE PERE  
De Pere Dam  
Mt Olive Cem  
Greenwood Cem  
Lincoln Sch  
Town Hall  
Pershing Sch

ASHWAUBENON  
DE PERE  
De Pere Dam  
Mt Olive Cem  
Greenwood Cem  
Lincoln Sch  
Town Hall  
Pershing Sch

ASHWAUBENON  
DE PERE  
De Pere Dam  
Mt Olive Cem  
Greenwood Cem  
Lincoln Sch  
Town Hall  
Pershing Sch

ASHWAUBENON  
DE PERE  
De Pere Dam  
Mt Olive Cem  
Greenwood Cem  
Lincoln Sch  
Town Hall  
Pershing Sch

ROUGH DRAFT NO. 1  
DW:jq  
736-647(P)  
7-15-75

Fox River Milk Transfer Coop., DePere, Brown County

---

The Fox River Milk Transfer Coop. discharges to Ashwaubenon Creek 7.6 miles upstream of the confluence with the Fox River in DePere. The streams bottom material consists of rubble, gravel, and silt. Ashwaubenon Creek is sluggish and turbid and has little fishery value. In the agricultural areas the stream banks and hills are bare and erosion is heavy due to cattle pasturing. In the residential areas of DePere the stream is filled with litter and debris.

The Fox River is about one mile southeast of the Coop.

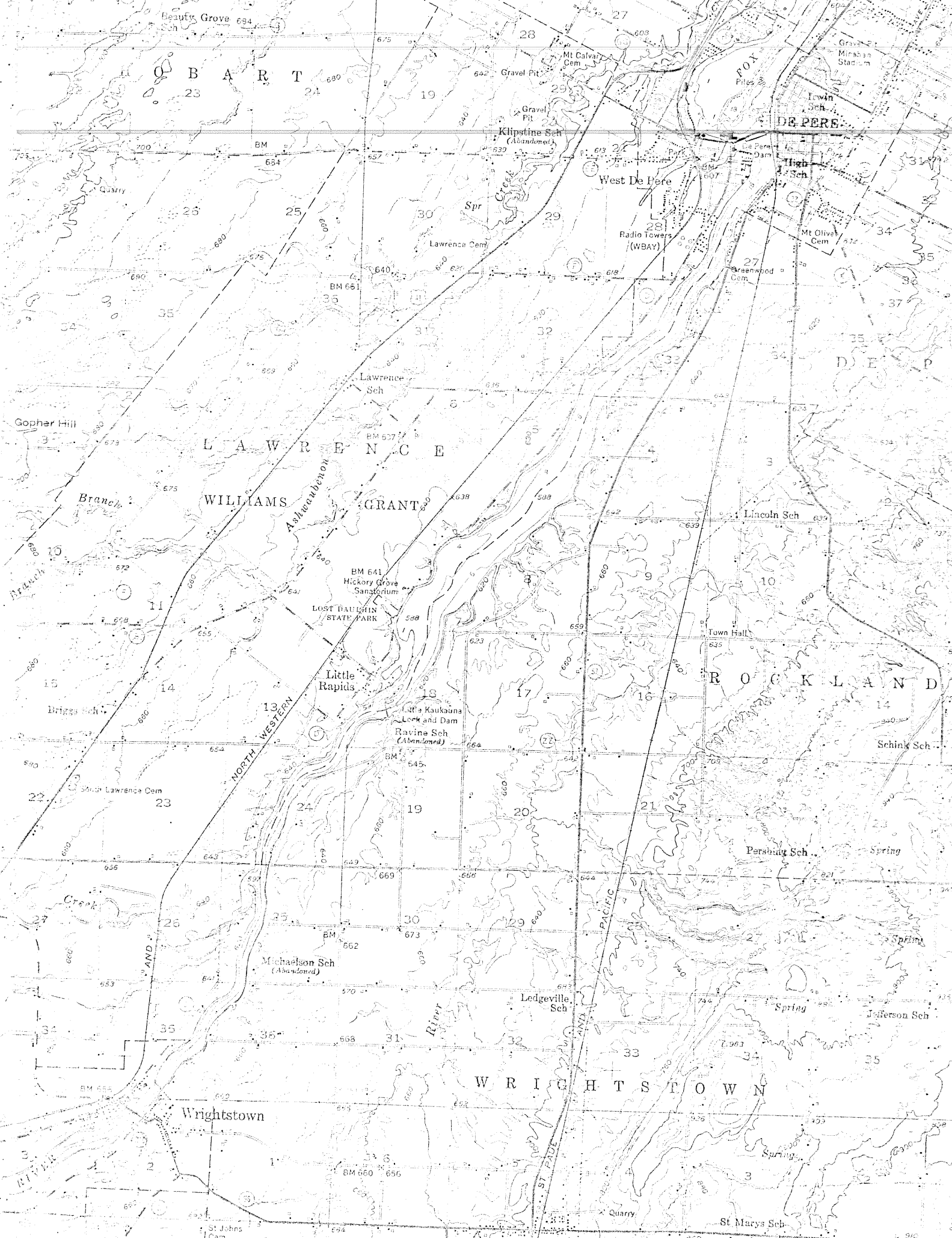

Beautiful Grove Sch 684

B A R R T

Mt Calvary Cem

DE PERE

West De Pere

High Sch

Radio Towers (WBAY)

Mt Olivet Cem

L A W R E N C E

WILLIAMS GRANT

Lawrence Sch

Hickory Grove Sanatorium

LOST BAUGHN STATE PARK

Little Rapids

Little Kaukauna Lock and Dam Ravine Sch (Abandoned)

R O C K L A N D

Lincoln Sch

Town Hall

Schling Sch

NORTH WESTERN

PACIFIC

Perabing Sch

Spring

Michaelson Sch (Abandoned)

Ledgeville Sch

Spring

Jefferson Sch

Wrightstown

W R I G H T S T O W N

St Marys Sch

