

Domtar
Nekoosa Mill
301 Point Basse Avenue
Nekoosa, WI 54457-1422
Tel (715) 886-7111



FILED
SECRETARY OF THE
2014 SEP -9 P 10:41
FEDERAL ENERGY
REGULATORY COMMISSION

ORIGINAL

Ms. Louise Clemency
U.S. Fish & Wildlife Service
Green Bay Field Office
2661 Scott Tower Drive
New Franken, WI 54229

September 4, 2014

Ms. Cheryl Laatsch, FERC Coordinator
Wisconsin Department of Natural Resources
N7725 Highway 28
Horicon, WI 53032

Dear Ms. Clemency and Ms. Laatsch:

Subject: Domtar Wisconsin Dam Corp.
FERC Projects 2255, 2291 and 2292
Centralia, Port Edwards, and Nekoosa Projects
Purple Loosestrife Monitoring Report for 2014

Attached is a report for purple loosestrife monitoring as required by Article 408 for projects 2255 and 2291, and by Article 407 for project 2292. A single report for the three projects has been prepared.

The survey was performed substantially as described in the plan submitted to the FERC Secretary on January 13, 1997, and as approved by FERC on July 16, 1997. The 2014 survey was performed during August as described in the report.

If there are any questions, please feel free to contact me at (715) 886-7711.

Sincerely,

A handwritten signature in black ink, appearing to read 'David S. Ulrich'.

David S. Ulrich, Superintendent
Environmental Services

DSU:krw

cc: Mr. John A. Zygaj, P.E. Regional Engineer, Federal Energy Regulatory Commission,
Chicago Regional Office, 230 South Dearborn Street, Chicago, IL 60604

Secretary, Federal Energy Regulatory Commission, 888 First Street, N.E.,
Mail Code DHAC, PJ-12.3, Washington, D.C. 20426

G:\FERC\Purple Loosestrife\2014loosestrifeletter.doc

**PURPLE LOOSESTRIFE MONITORING SURVEY FOR 2014
DOMTAR WISCONSIN DAM CORP.
301 Point Basse Avenue
Nekoosa, Wisconsin 54457**

**By
Dan Cummins
Cummins Enterprises, LLC**

**FERC Projects
Centralia Dam – No. 2252
Port Edwards Dam – No. 2291
Nekoosa Dam – No. 2292**

BACKGROUND

During August 2014, Cummins Enterprises, LLC, conducted the annual purple loosestrife survey of project lands. Observations were made from the shoreline along the Wisconsin River throughout Domtar's FERC permitted property.

Surveys have been conducted annually since 1997. As part of this report, purple loosestrife observed in 2014 will be compared to that observed in 2013.

DESCRIPTION OF THE PURPLE LOOSESTRIFE POPULATIONS IN 2014

Figure 1a

Survey observations made of the project area represented on this figure saw the number of purple loosestrife stay about the same. The distribution of the loosestrife throughout the area is also about the same. The west or right shoreline seen in this map has significantly more loosestrife than the other. This trend is consistent over the past several years.

Figure 1b

In the vicinity of the city parks along the west bank there are fewer purple loosestrife than during past years. At Boles Creek there are fewer loosestrife than have been observed in the recent past. Purple loosestrife continue to appear on the rocky outcrops immediately upstream of the Centralia Dam. The eastern bank had no observed purple loosestrife.

Figure 1c

The power line easement for the Centralia Dam continues to be free of purple loosestrife.

Figure 2a

The Port Edwards portion of the survey area has fewer loosestrife than in 2013. There were many up-rooted trees in this section which could lead to increased numbers of purple loosestrife in the future. The reservoir area had fewer loosestrife than at any

other time of the survey. Rock outcrops in the area of Four Mile Creek also had fewer loosestrife populations than in 2013.

Figure 3a

The purple loosestrife in this area has decreased from 2013 with 2 exceptions. First, the downstream end of the island across from the Village of Port Edwards wastewater treatment plant (across from where Harvey Creek enters the Wisconsin River) continues to maintain a healthy and large population of purple loosestrife.

Second, the large population of loosestrife adjacent to Highway 73 where the Wisconsin River turns southward has continued to flourish. This area is not immediately adjacent to the river, but is included in the FERC boundary.

Figure 3b

Purple loosestrife have remained about the same compared to 2013. Downstream of the Nekoosa Dam the numbers of plants increased in one area south of the dam and on the east bank. This area has seen the number of plants fluctuate year over year, with 2014 being a year of increased numbers. In this section of river there have also been several trees up-rooted along the bank.

CONCLUSIONS

In general, the number of purple loosestrife throughout the project areas has decreased, with the exceptions noted (e.g. east bank downstream of Nekoosa Dam, along Highway 73 north of Nekoosa, and on the downstream tip of a small island adjacent to the Port Edwards wastewater treatment plant). The large number of down trees along the bank of the Wisconsin River could lead to increased numbers of purple loosestrife in the future.

Dan Cummins
Cummins Enterprises, LLC
1451 Rounds Round
Wisconsin Rapids, Wisconsin 54494
715-423-8930

AUTOCAD
 RELEASED 10.0
 PLOT SCALE: 1"=400'
 HY. DWG. NO. 13752-CUUU-59041

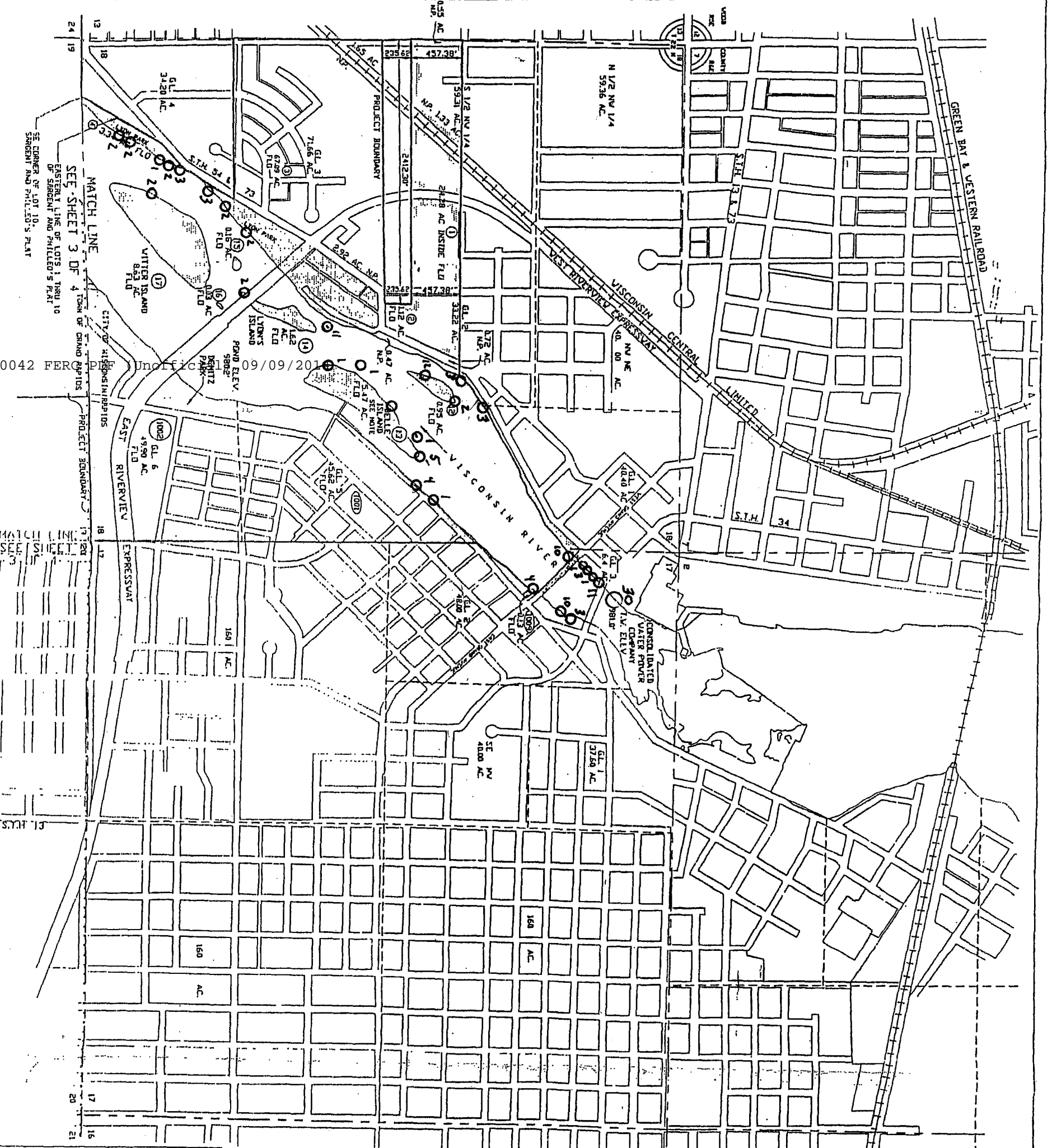

20140909-0042 FERC Unofficial 09/09/2014

VARIATION 2°46' EAST
 OCTOBER 12, 1953
 COUNTY, WISCONSIN
 STATE, WISCONSIN

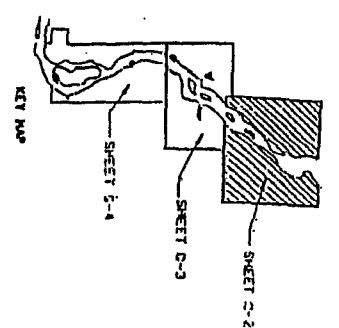

FLOODAGE RIGHTS
 PARCEL NO.

NOTE: BELLE ISLAND IS CLAIMED BY THE UNITED STATES GOVERNMENT AND IS NOT SUBJECT TO THIS SURVEY. THIS CLAIM IS DISCLOSED FOR INFORMATION.

THIS DRAWING IS A PART OF THE APPLICATION FOR LICENSE UNDER THE UNDEVELOPED LANDS ACT OF 1920. DATE OF SURVEY: 1991.

NEKOOSA PAPERS INC.
 PORT EDWARDS, WISCONSIN
 CENTRAL IA HYDROELECTRIC PROJECT
 EXHIBIT G
 PROJECT MAP
 400' 200' 0 200' 400'
 1"=400'

2014 ANNUAL PURPLE
 LOOSESTRIFE SURVEY

Figure 1a

AUTOCAD
 RELEASE 10.0
 PLOT SCALE: 1"=400'
 BY: DHC, NO. 13752-CUUU-89043

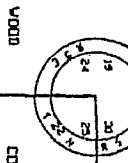

VARIATION 3°46' EAST
 OCTOBER 12, 1953

COUNTY: WOOD
 STATE: WISCONSIN

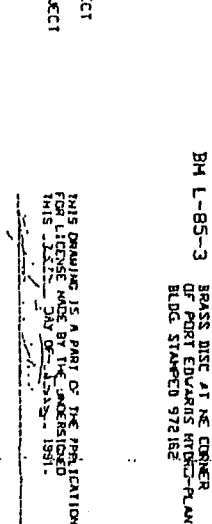
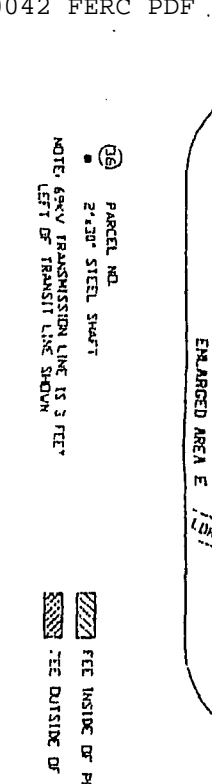
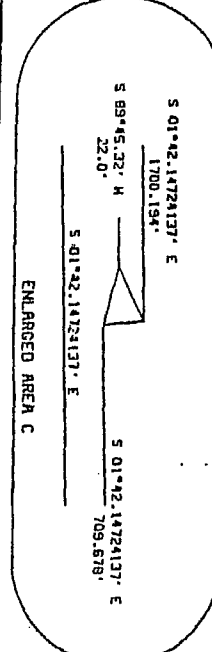
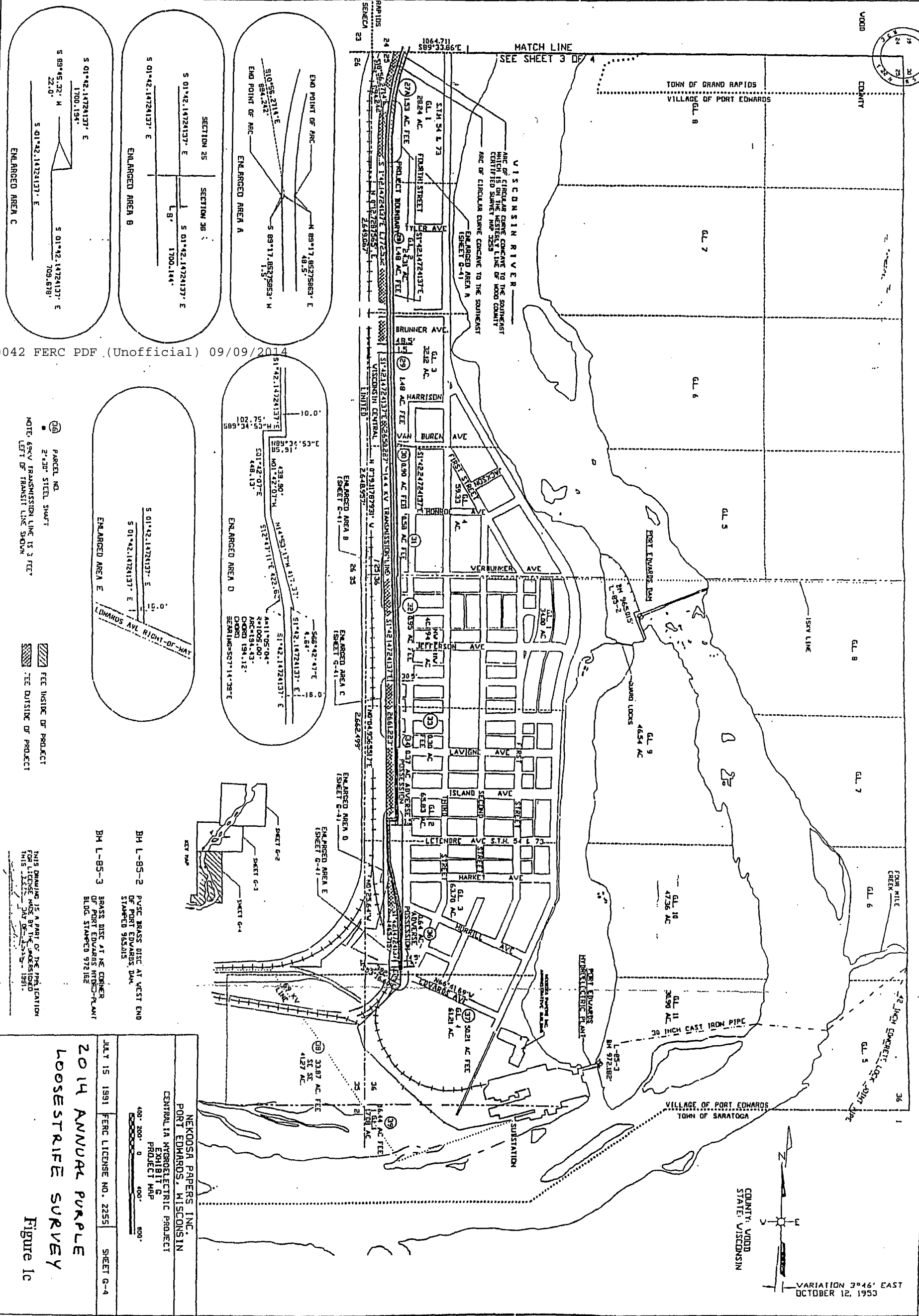

NEKODSA PAPERS INC.
 PORT EDWARDS, WISCONSIN
 CENTRAL IA HYDROELECTRIC PROJECT
 EXHIBIT G
 PROJECT MAP

400' 200' 0' 400' 800'

JULY 15 1991 FERC LICENSE NO. 2255 SHEET G-4

2014 ANNUAL PURPLE
 LOOSESTRIFE SURVEY
 Figure 1c

20140909-0042 FERC PDF (Unofficial) 09/09/2014

AUTOCAD
 RELEASE 10.0
 PLOT SCALE: 1"=400'
 DWG. NO. 13752-CUUU-59D45

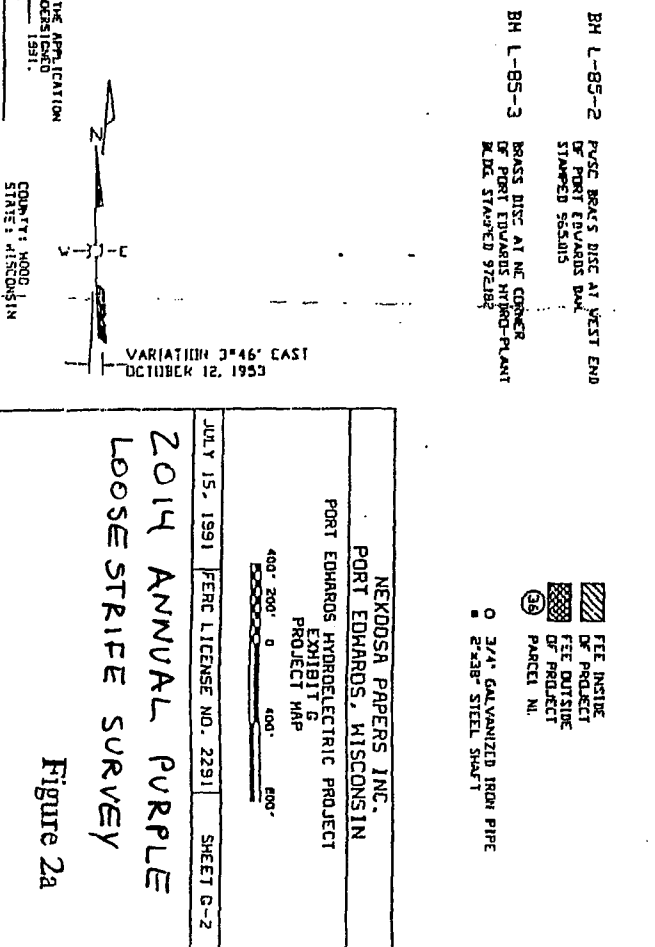
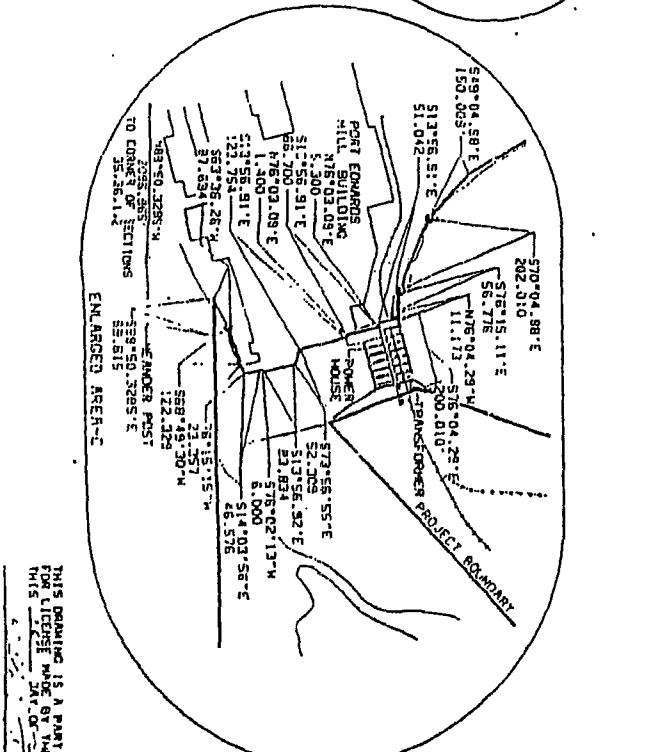
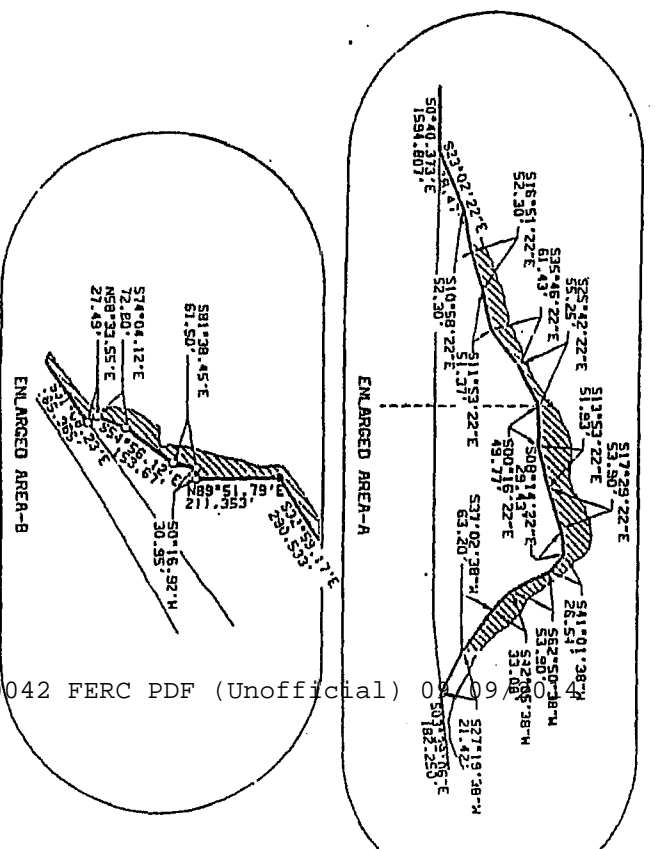
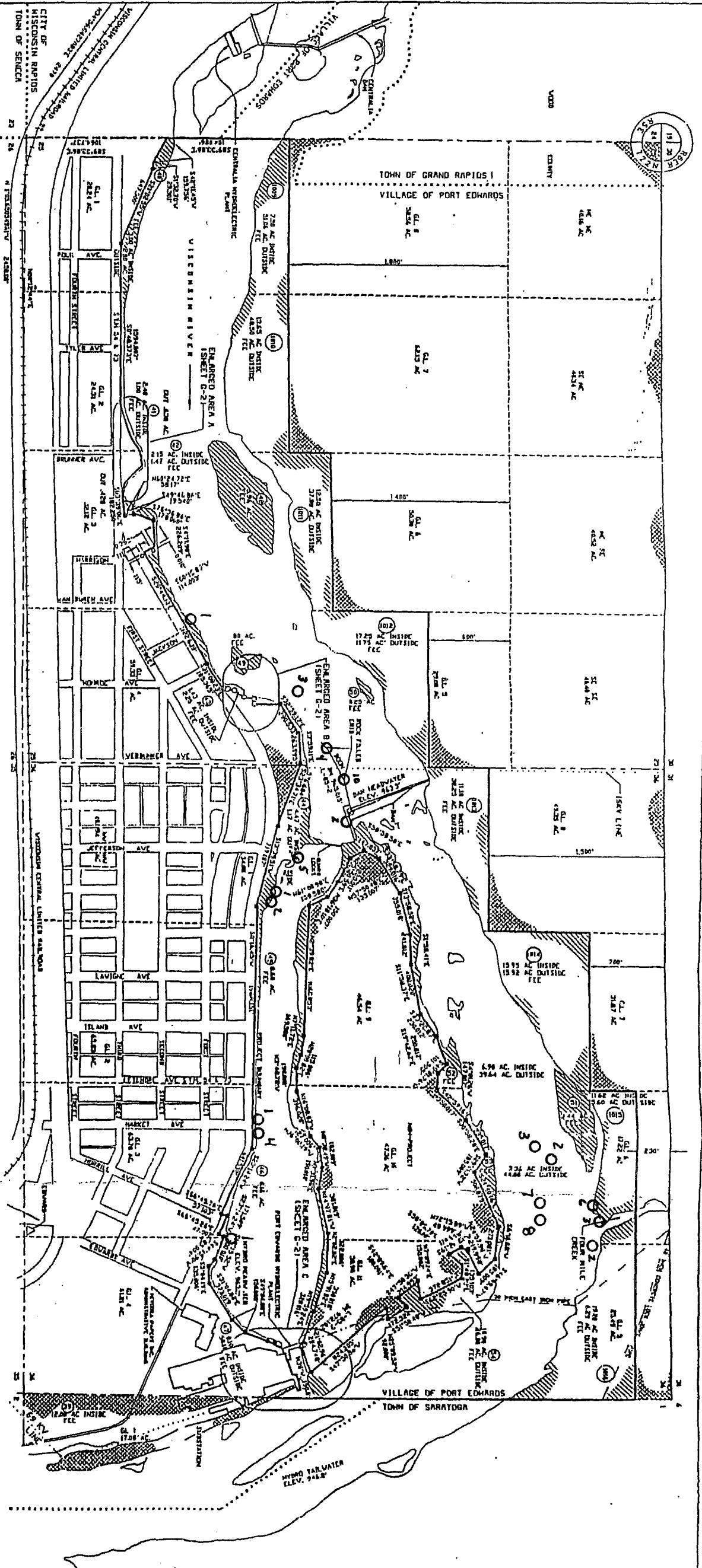

THIS DRAWING IS A PART OF THE APPLICATION FOR LICENSE MADE BY THE UNDERSIGNED ON 24th DAY OF JANUARY 1991.

COUNTY: WOOD
 STATE: WISCONSIN

VARIATION 3°46' EAST
 OCTOBER 12, 1953

BH L-85-2
 BRASS BOLTS DISC AT WEST END OF PORT EDWARDS DAM, STAMPED SECTIONS

BH L-85-3
 BRASS DISC AT NE CORNER OF PORT EDWARDS HYDRO-PLANT W. OF STAMPED 97218

FILE INSIDE OF PROJECT
 FILE OUTSIDE OF PROJECT
 PARCEL NO.

3/4" GALVANIZED IRON PIPE
 2" x 8" STEEL SHAFT

NEKODSA PAPERS INC.			
PORT EDWARDS, WISCONSIN			
PORT EDWARDS HYDROELECTRIC PROJECT			
EXHIBIT C			
PROJECT MAP			
400' 200'	0	400'	800'
JULY 15, 1991		FERC LICENSE NO. 2291	SHEET C-2
2014 ANNUAL PURPLE LOOSE STRIPE SURVEY			
Figure 2a			

20140909-0042 FERC PDF (Unofficial) 0 9 9

20140909-0042 FERC PDF (Unofficial) 09/09/2014

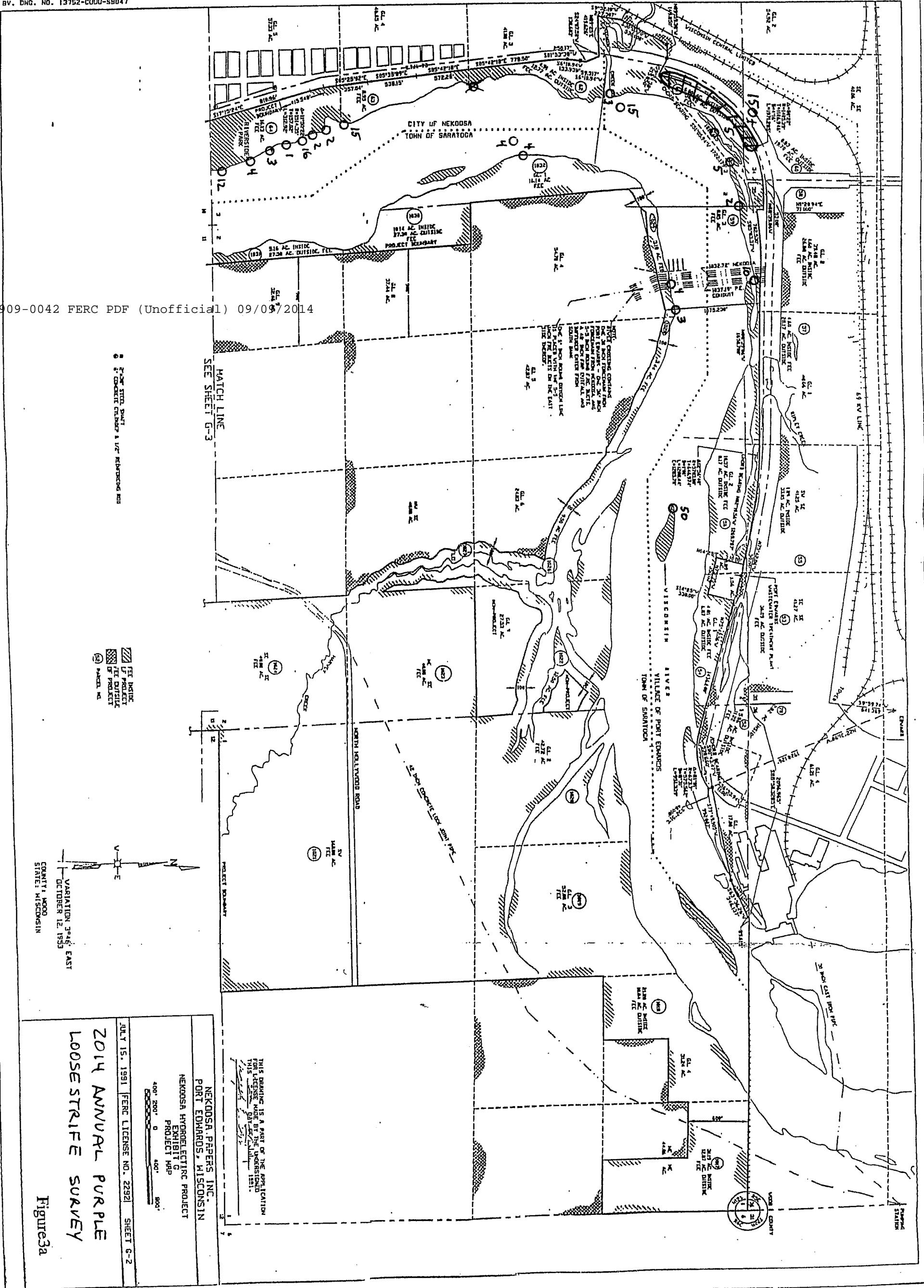

VARIATION 30'45" EAST
 OCTOBER 12, 1953
 COUNTY: MOOD
 STATE: WISCONSIN

FEE DISTING
 PROJECT BOUNDARY
 CONCRETE CURB

HATCH LINE
 SEE SHEET G-3

JULY 15, 1991 FERC LICENSE NO. 22921 SHEET G-2
 2014 ANNUAL PURPLE
 LOOSE STRIPE SURVEY
 Figure 3a

NEKODSA PAPERS, INC.
 PORT EDWARDS, WISCONSIN
 NEKODSA HYDROELECTRIC PROJECT
 EXHIBIT HRP
 PROJECT HRP

THIS DRAWING IS A PART OF THE APPLICATION
 FOR LICENSE UNDER THE LICENSE ACT OF
 WISCONSIN, 1951.

400' 200' 0 400'
 800'

AUTOCAD
 RELEASE 10.0
 PLOT SCALE: 1"=400'
 BY: DHD, NO. 13752-CUUU-59048

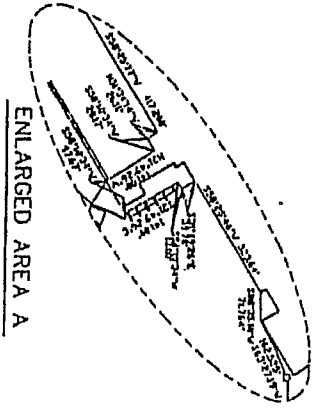

20140909-0042 FERC PDF (Unofficial) 09/09/2014

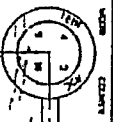
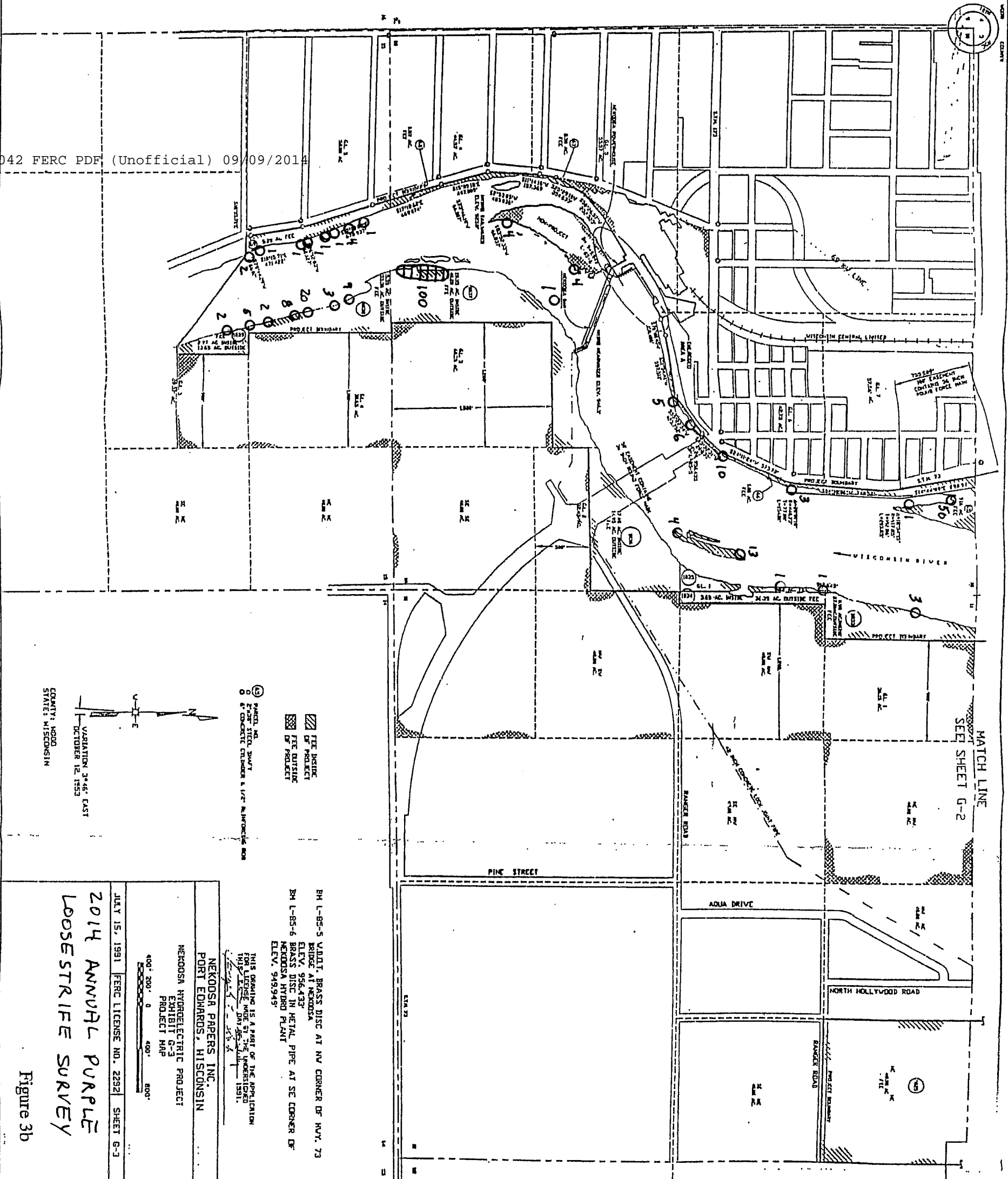

MATCH LINE
 SEE SHEET G-2

Document Content(s)

13631217.tif.....1-9