

Department of Natural Resources

INTRA-DEPARTMENT

MEMORANDUM

..... Spooner

Station

Date December 3, 1976

IN REPLY REFER TO: 3200

TO: Anthony S. Earl
FROM: L. G. Hansen
SUBJECT: Surface Water Classification (NR 104)
Pence, Iron County

The community of Pence, located four miles west of Hurley, has an Imhoff tank for the treatment of wastewaters. The effluent from this treatment system is conveyed to a small wetland on the south side of the community. A small intermittent drainageway traverses this wetland, crosses eastward through a wooded upland, and disperses in a timbered swamp approximately $\frac{1}{2}$ mile east of Pence.

Approximately $\frac{1}{2}$ mile south of this dispersion area, but contiguous to the same wooded wetland, is Mead's Creek, a small marginal trout stream flowing east to the Gile Flowage.

During wet periods the drainageway adjacent to Pence flows for approximately $\frac{1}{2}$ mile to the timbered swamp before dispersing. During dry periods there is no flow exhibited out of the small wetland adjacent to Pence. An investigation, on September 4, 1975, revealed this intermittent drainageway to be dry at the point noted on the attached map. On the same day there was very low flow in Mead's Creek at the town road indicated on the attached map.

Numerous stream samples from Mead's Creek, during 1974, failed to show any evidence of sewage contamination from the Pence discharge. In the opinion of the investigating team, the effluent from Pence is contained and assimilated in the small wetland adjacent to Pence, the intermittent drainageway to the east, or the wooded swamp located approximately $\frac{1}{2}$ mile east of Pence. No evidence of channelization has been noted exiting this second wetland.

Two maps of the area and photographs are attached.

RECOMMENDATION

The "wetland" (NR 104.02(1)(c)) receiving effluent from Pence, the "non-continuous" drainageway (NR 104.02(1)(e)), and the wooded "wetland" NR 104.02(1)(c) dispersion area shall be categorized as "marginal surface waters" (NR 104.02(3)(b)).

Mead's Creek shall meet fish and aquatic life standards (NR 102.02).



Ted R. Smith

TRS:mm

Attachments

APPROVED:

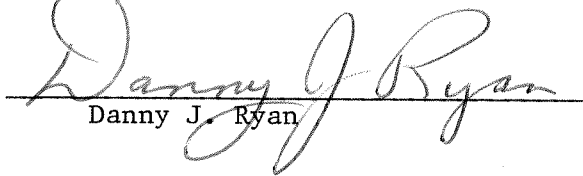

Danny J. Ryan

12/14/76
Date

NOTED:

Date

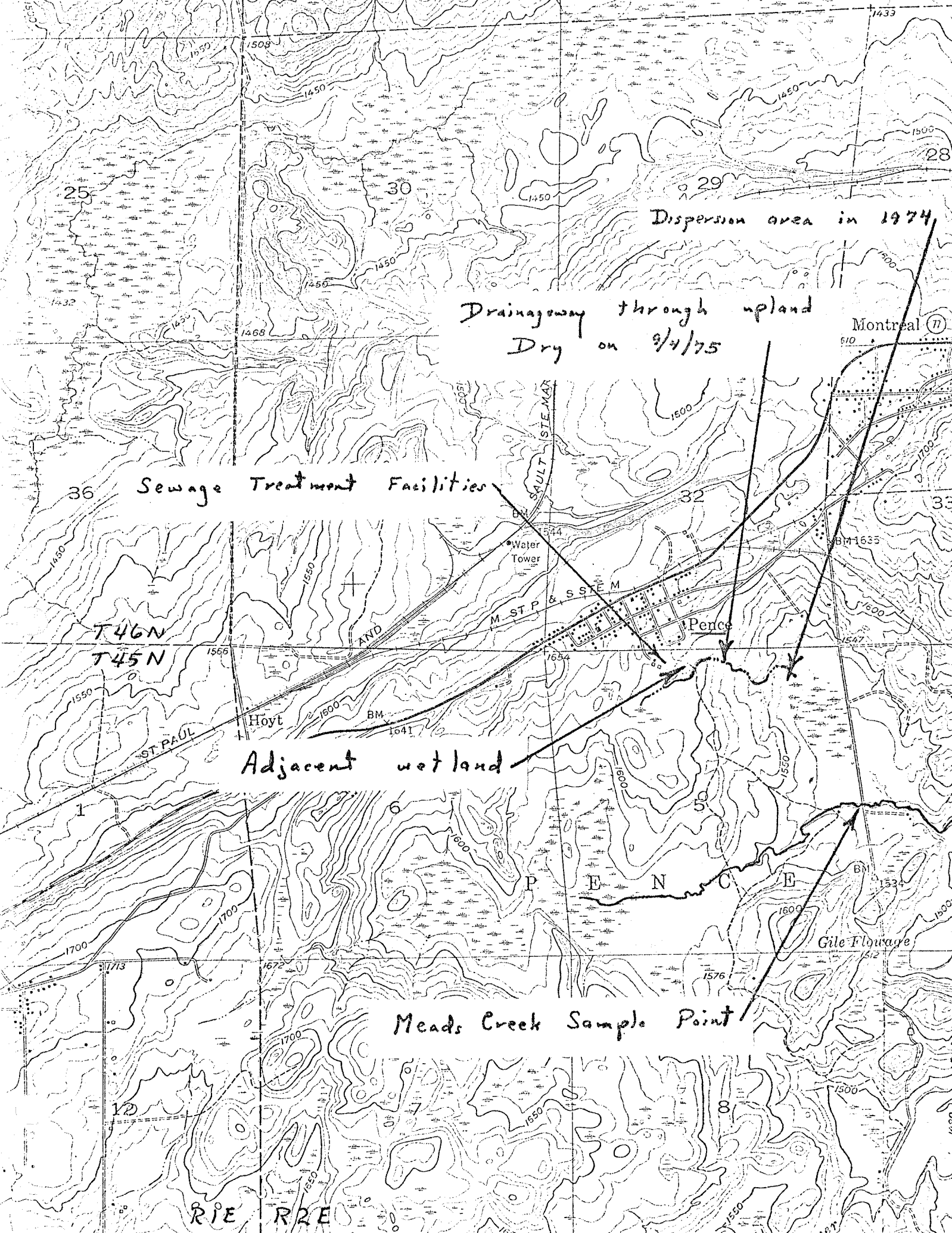

Dispersion area in 1974

Drainageway through upland
Dry on 9/7/75

Sewage Treatment Facilities

Adjacent wet land

Meads Creek Sample Point

Montreal

SAULT SIEMAR

M. ST P & S S E M

Pence

Hoyt

ST PAUL

P E N C E

Gile Flourage

R I E R R E

T46N
T45N

36

30

29

32

33

1

6

5

12

7

8

1468

1566

1041

1634

BM 1635

1547

BM 1534

1576

1500

1550

1508

1450

1450

1450

1450

1450

1500

28

25

1432

1500

610

1100

1600

1547

1550

1550

1600

1600

1550

1700

1713

1672

1600

1600

1600

1500

1700

1550

1550

1550

1500

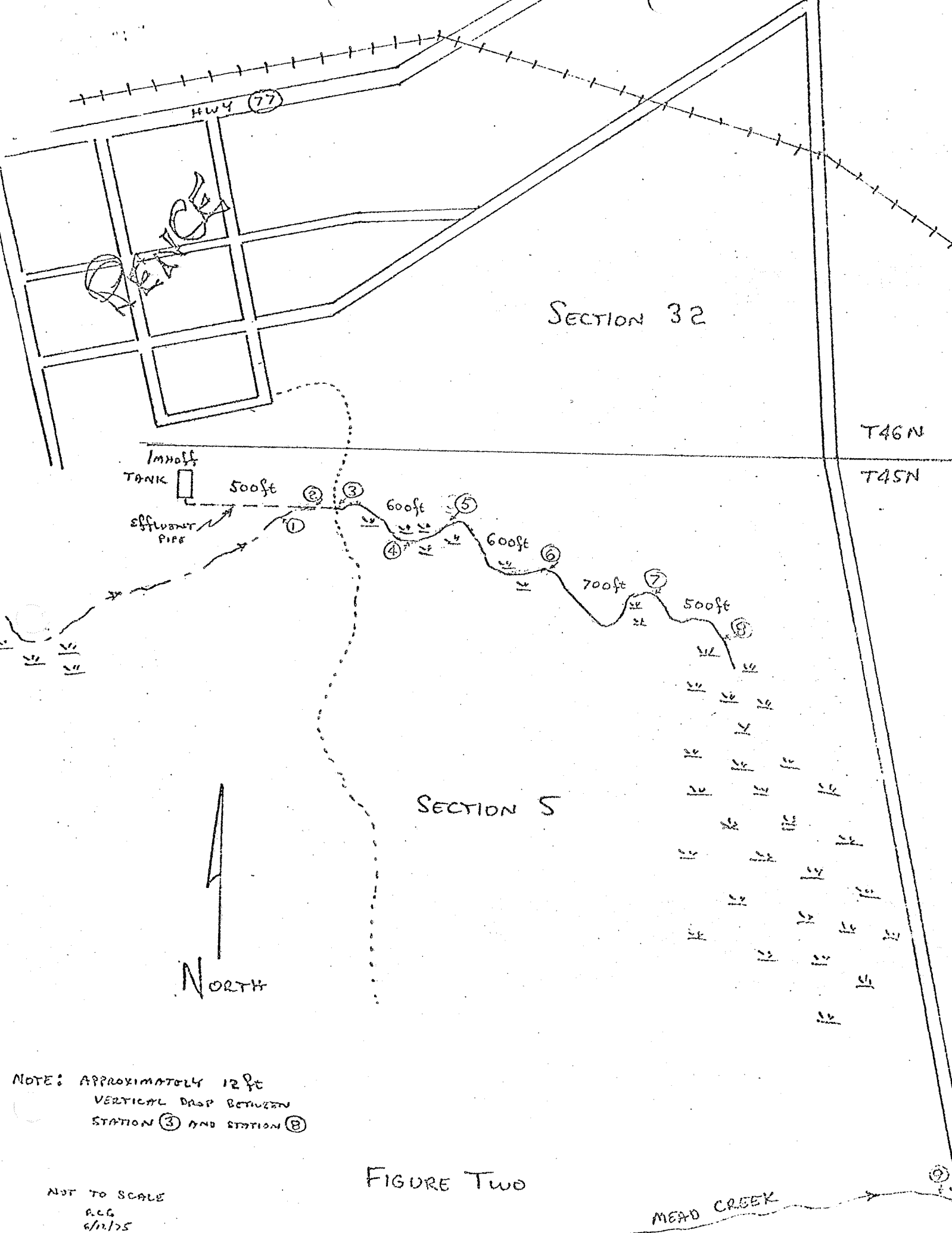

NOTE: APPROXIMATELY 12 ft
 VERTICAL DROP BETWEEN
 STATION ③ AND STATION ⑧

FIGURE TWO

NOT TO SCALE
 RCG
 6/1/75



PENCE

Drainageway containing effluent as it passes through culvert in small wetland adjacent to south edge of community.



PENCE

View looking east over small adjacent wetland. Below picture was taken just inside tree line in background



PENCE

Drainageway through upland just east of community. Channel was dry on Sept. 4, 1975