

Casco

Kewaunee County

The Casco STP discharges to Casco Creek. A low flow survey conducted in June, 1973, showed flows above 10 CFS in Casco Creek. During our survey of August 27, 1975, we noted a 20-inch Northern Pike just below the STP outfall.

Recommendations

Casco Creek should be classified as continuous/fish and aquatic life.

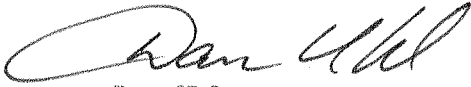

Dan Uhl
District Engineer



Dennis C. Weisensel
District Biologist

DU:DCW:sh

CASCO

SURVEY DATE: 8-27-75

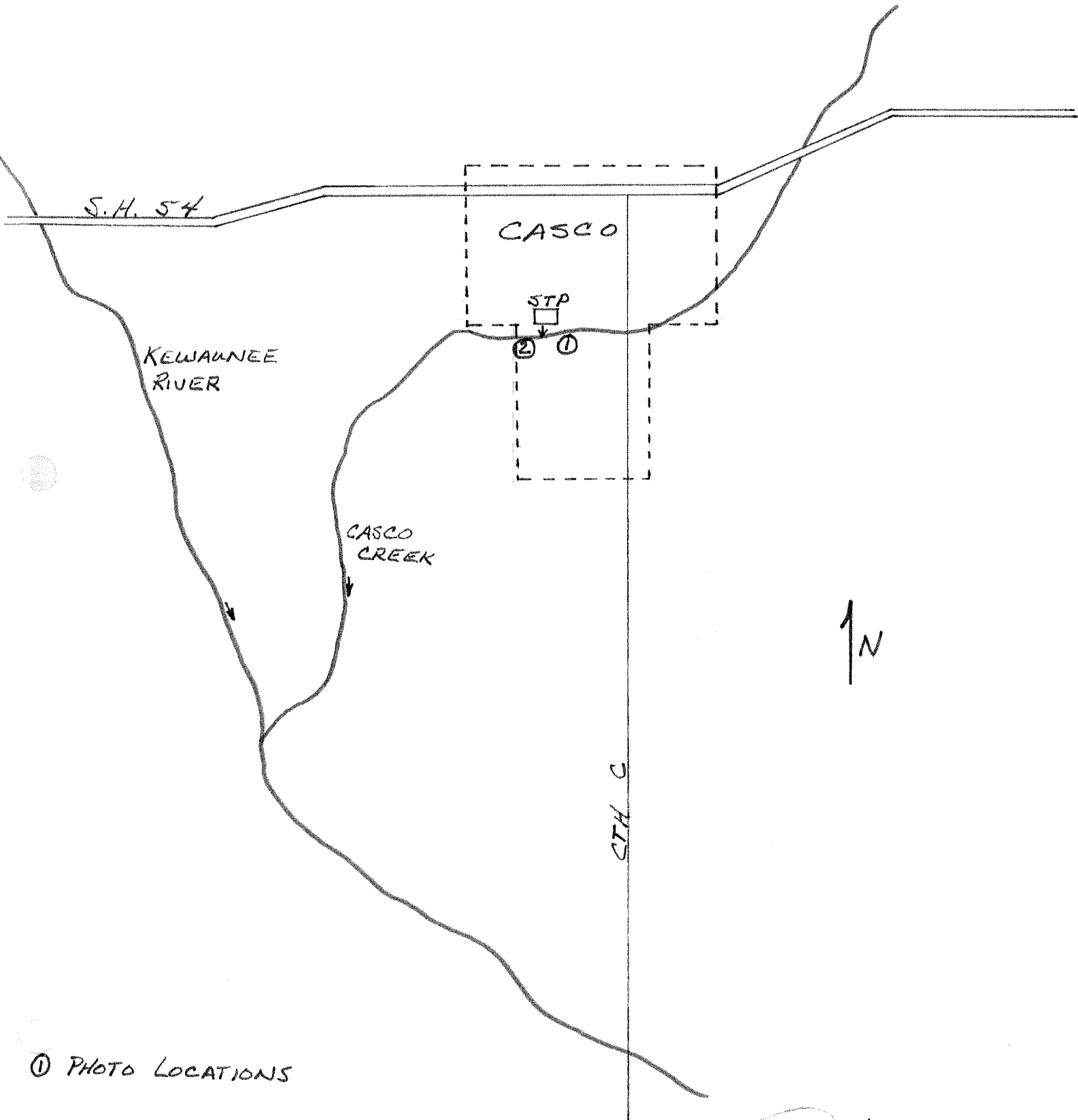

1 PHOTO LOCATIONS

Will
9-10-75

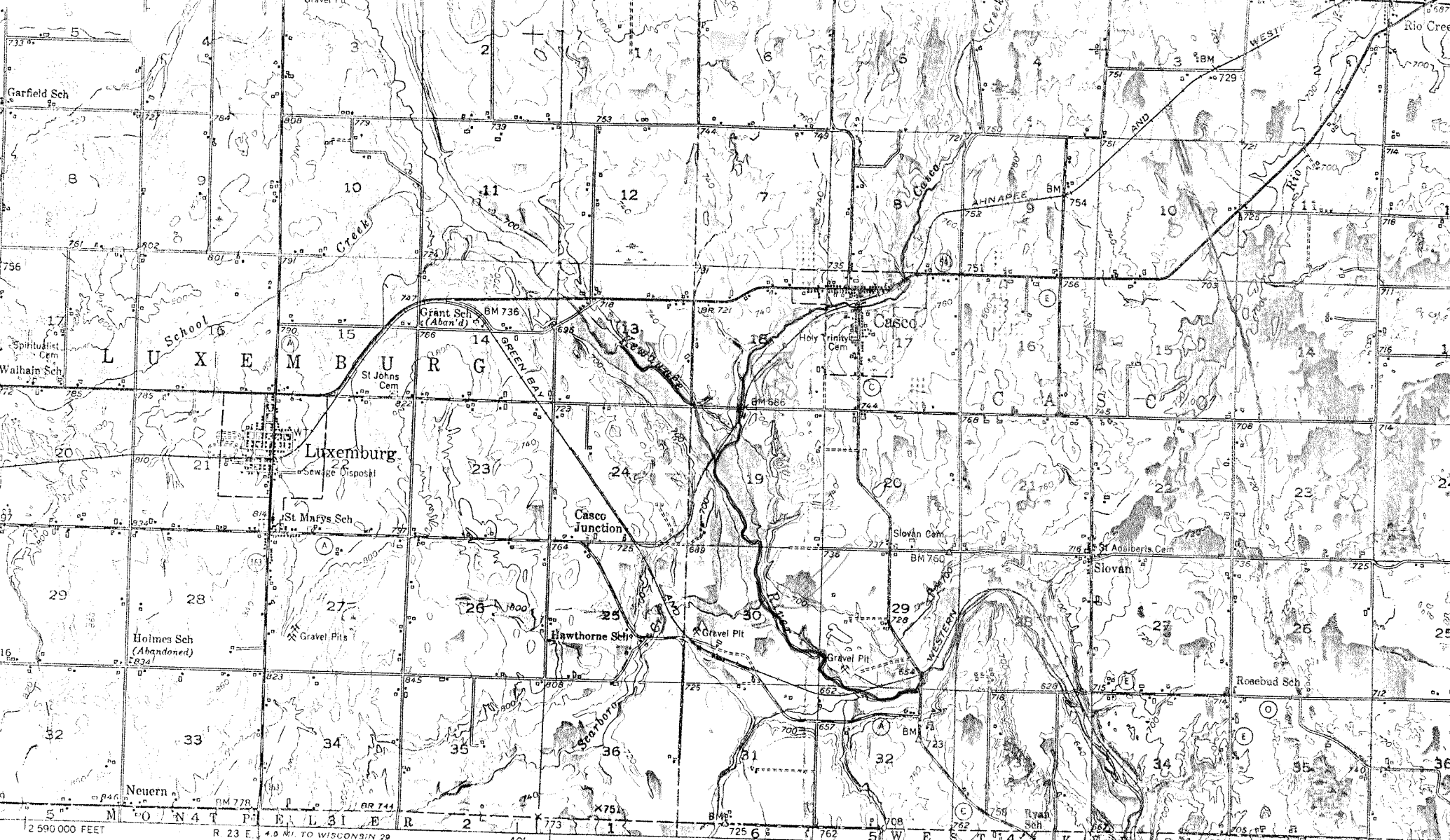

edited, and published by the Geological Survey

USGS and USC&GS

by from aerial photographs by Keish plotter
 me-table surveys 1952. Aerial photographs taken 1951
 by from US Lake Survey Chart 703 (1:80,000)

projection. 1927 North American datum
 of grid based on Wisconsin coordinate system,
 e

TRUE NORTH
 MAGNETIC NORTH

APPROXIMATE MEAN
 DECLINATION, 1952

SCALE 1:62500

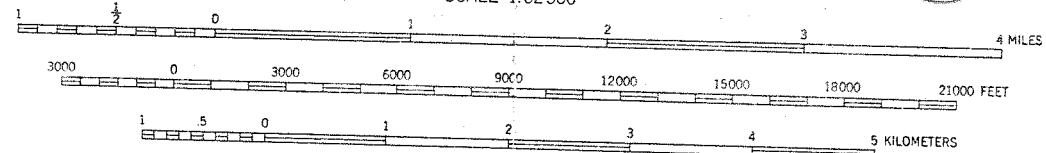

CONTOUR INTERVAL 20 FEET
 DOTTED LINES REPRESENT HALF-INTERVAL CONTOURS
 DATUM IS MEAN SEA LEVEL
 DEPTH CURVES AND SOUNDINGS IN FEET—DATUM IS 578 FEET

THIS MAP COMPLIES WITH NATIONAL MAP ACCURACY STANDARDS
 FOR SALE BY U. S. GEOLOGICAL SURVEY, WASHINGTON 25, D. C.
 AND BY THE WISCONSIN GEOLOGICAL AND NAT'L RAL HISTORY SURVEY, MADISON 6, WISCONSIN
 A FOLDER DESCRIBING TOPOGRAPHIC MAPS AND SYMBOLS IS AVAILABLE ON REQUEST



QUADRANGLE LOCATION

ROAD C
 Heavy-duty 4 L
 Medium-duty 4 L
 U. S. Route

INTERIOR—GEOLOGICAL SURV
 KEWAUNEE 4.3 MI. M R-



CASCO UPSTREAM
OF STP OUTFALL ON
CASCO CREEK

#1

CASCO DOWNSTREAM
OF STP OUTFALL
ON CASCO CREEK

#2