

Region NER County Manitowac Report Date 2/1977 Classification _____
 Water Body: Mud Creek
 Discharger: T of Rockland WWTP

If stream is classified as Limited Forage Fish (LFF) or Limited Aquatic Life (LAL), check any of the following Use Attainability Analysis factors that are identified in the classification report:

- _____ Naturally occurring pollutant concentrations prevent the attainment of use
- _____ Natural, ephemeral, intermittent or low flow conditions or water levels prevent the attainment of the use, unless these conditions may be compensated for by the discharge of sufficient volume of effluent discharges without violating State water conservation requirements to enable uses to be met
- _____ Human caused conditions or sources of pollution prevent the attainment of the use and cannot be remedied or would cause more environmental damage to correct than to leave in place
- _____ Dams, diversions or other types of hydrologic modifications preclude the attainment of the use, and it is not feasible to restore the water body to its original condition or operate such modification in a way that would result in the attainment of the use
- _____ Physical conditions related to the natural features of the water body, such as the lack of a proper substrate, cover, flow, depth, pools, riffles, and the like, unrelated to water quality, preclude attainment of aquatic life protection uses
- _____ Controls more stringent than those required by sections 301(b) and 306 of the Act would result in substantial and widespread economic and social impact

Supporting Evidence in the report (include comments on how complete/thorough data is)

- _____ Biological Data (fish/invert)
- _____ Chemical Data (temp, D.O., etc.)
- _____ Physical Data (flow, depth, etc.)
- _____ Habitat Description
- Site Description/Map
- Other: photos.

Historical Reports in file:

2/3/77 - Bob Lucas

Additional Comments/How to improve report:

- ~~effluent ditch = LAL (default) & LAL to Manitowac R.~~
 ↳ from WWTP outfall to confl. w/ Mud River.
- verify this class'n w/ region

February 3, 1977

Town of Rockland Sanitary District #1 - Manitowoc County

The Town of Rockland Sanitary District #1 is located in Collins, Wisconsin. The treatment plant was placed in operation in 1964 and consists of a two cell stabilization pond with an intermittent discharge.

Discharge is directed to an effluent ditch which flows approximately $\frac{1}{4}$ mile to Mud Creek. Downstream of the effluent ditch, Mud Creek flows approximately $\frac{1}{4}$ mile before joining the Manitowoc River.

Mud Creek originates in a marsh area in Brown County. Flowing south, the creek drains Maple Grove Swamp to the north and Collins Marsh to the south. A dam is located east of Collins near County Trunk Highway 'JJ'. At the time of the survey, the creek was dry below the dam.

Recommendation:

Effluent ditch to Mud Creek. Non-continuous, marginal uses to Manitowoc River.



Robert B. Lucas

RBL:sh

Photo Locations

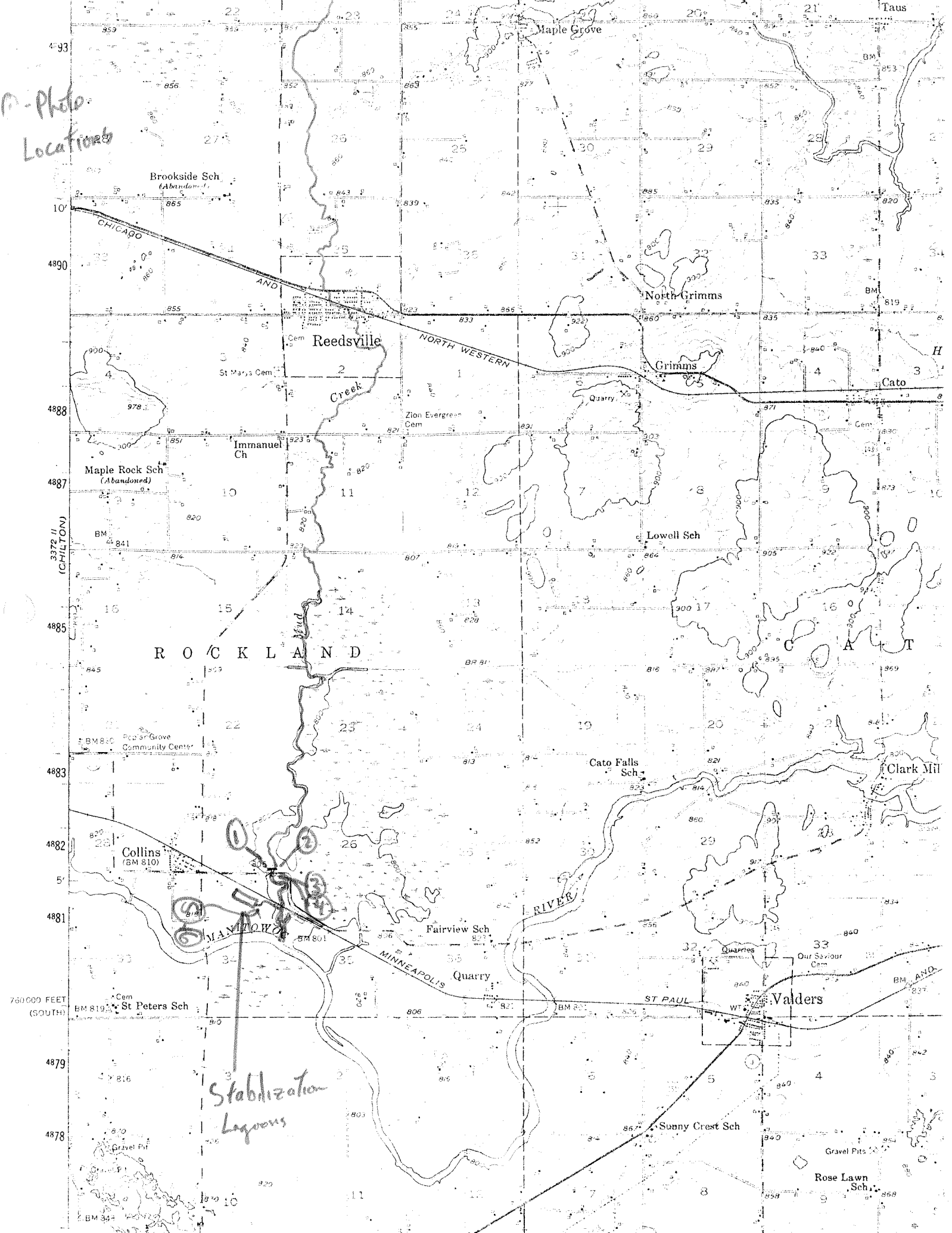

Stabilization Lagoons

Town of Rockland S.A. #1
Collins, WI



① Upstream view
from Dam of
Collins Marsh



② Additional shot
at same site.

Town of Rockland S.D. #1



③ Mud Creek
below Collins Marsh
Dam



④ Additional shot
from same location

Town of Rockland S.D. #1



(5) Effluent ditch
from stabilization
lagoon



(6) Effluent ditch flows
adjacent to railroad tracks.
Joins Mud Creek at
railroad trestle - Note
trestle also in photo (4)