

January 12, 2015

Kimberly D. Bose, Secretary
Federal Energy Regulatory Commission
888 First Street, N.E.
Washington, DC 20426

**RE: Flambeau Upper FERC Project Number 2640
Flambeau Hydro LLC
Final Report 2014 Purple Loosestrife Inventory Report**

Dear Ms. Bose:

On behalf of Flambeau Hydro LLC, "Flambeau" (Licensee), Renewable World Energies, LLC (RWE) is submitting a copy of the *Final Report 2014 Purple Loosestrife Inventory Report* for the Flambeau Upper Hydroelectric Project. The report is a requirement of Flambeau's Federal license pursuant to article 412. Monitoring was conducted on August 19, 2014. No out of the ordinary issues were encountered and no Purple Loosestrife was observed. The draft report was sent to the agencies by a letter dated December 9, 2014 as an attachment to an e-mail sent the same day for review and comment. No comments have been received from WDNR or the USFWS. The next scheduled monitoring event will be conducted in 2015. If you have any questions concerning this submittal, please contact Mr. Gary Rast at the Renewable World Energies, LLC offices @ 855-994-9376 Ext 105. He can also be reached by e-mail at grast@rwehydro.com.

Corporate Office
P.O. Box 264
100 S. State Street
Neshkoro, WI 54960
Fax: 920-293-4100

Phone: 855-99HYDRO
(855-994-9376)
www.renewableworldenergies.com

Administrative Office
1001 Stephenson Street
Norway, MI 49870
Fax: 906-563-9344



Sincerely,
Renewable World Energies, LLC
Agent for Licensee

For Jason Rast
Mr. Jason Kreischer
Vice President, Operations

Attachment: Flambeau Upper Final Purple Loosestrife Inventory Report

Cc: Ms. Cheryl Laatsch, WDNR
Mr. Nick Utrup, USFWS
RWE, Corporate

Flambeau Upper Project Purple Loosestrife Inventory

August 19, 2014

FERC Project # 2640 Article 412

Flambeau Hydro LLC

100 S. State St.

Neshkoro, WI 54960

Purple Loosestrife

On August 19, 2014, Flambeau Hydro, LLC (FHLLC) performed an inventory of purple loosestrife plants at the Flambeau Upper Project in Price County, Wisconsin. The method of inventory as approved and modified by Federal Energy Regulatory Commission (FERC) Order of June 18, 2003 was defined as follows:

While Purple Loosestrife is blooming in mid-July to early August, the inventory should be conducted using a boat to survey the impoundment above the dam within the Project Boundary and on foot or by boat below the dam within the Project Boundary. County wetland maps may be used to determine other areas where Purple Loosestrife could be found on lands owned by FHLLC within the Project Boundary. Lands owned by FHLLC within the Project Boundary will be surveyed on foot. A pair of binoculars should be used to search for the purple flowered spikes of the plant. When plants are located, the person(s) inventorying should get close enough to make a positive identification without disturbing the plants or the immediate area around the plants as this could cause them to spread. A GPS receiver will be used to establish a GPS coordinate for the location of the plants. If it is not possible to get close enough to establish an accurate location, an approximate location will be established with reference to an established GPS coordinate. The plants should be inventoried by marking and numbering the location on a Project map along with notes approximating size of plants, stand area, percent cover, stem density, plant density, and location with reference to established GPS coordinates. Photos and/or videotape will be taken of the largest occurrences.

Example:

#1 6' tall plants; 4' x 20'; 30% cover; 4-5 stems per plant; 4 plants; on shoreline N45 56.183' W90 26.748'; no photo

#2 5'-7' tall plants; 10' x 10'; 25% cover; 4-5 stems per plant; 10 plants; in marsh ~50 feet Bearing 25 degrees from N45 56.256' W90 26.710'; photo No. 1

The area to be inventoried shall be the shoreline of the impoundment to elevation 1487.4 feet NGVD and lands owned by FHLLC within the Project Boundary as indicated on the Project Maps 1 & 2, dated November 1991, included in Exhibit G of Flambeau Paper Corp. Application for a Subsequent License for the Upper Hydroelectric Project FERC Project #2640.

General Observations:

The Flambeau Upper Project Boundary was divided into three different areas; *the impoundment* (from just downstream of the last rapids before the impoundment to the dam), *the power canal/bypassed reach* (the power canal from the dam to the powerhouse, and the bypassed reach area from the dam to the single lane service bridge just upstream of the HWY 182 bridge), and *the tailrace* (from the single lane service bridge just upstream of the HWY 182 bridge to the HWY 182 bridge).

The tailrace was surveyed by boat and no purple loosestrife plants were observed.

The power canal/bypassed reach was surveyed on foot and no purple loosestrife plants were found. No occurrences of purple loosestrife have been found in this area since 2007.

The impoundment was surveyed by boat and no purple loosestrife plants were found. No occurrences of purple loosestrife have been found in this area since 2007.

All survey information has been entered into the SWIMS database for the 2014 year.

If any purple loosestrife plants had been found during the inventory, a digital camera would have been used to document these occurrences and GPS coordinates for the location of the plants would have been recorded.

Purple Loosestrife Survey

Project: Flambeau Upper #2640Datum: WGS 84Date: August 19, 2014Page: 1 of 1Crew: GGR & BR

Sighting #	GPS Point	Latitude	Longitude	Plant Height	Stand Area	Comments
1	2 FLUPPL001	N45 56.807'	W90 26.043'	N/A	N/A	No occurrences of purple loosestrife were found within the project boundary in 2014. Located 3 yards bearing 90 degrees (east) of GPS point on residence shore. First observed in 2002, approx. 15-25 plants growing close together. Plants appeared to have 3-5 stems per plant. In 2003 samples were taken of this occurrence along with a recording on video tape. Analysis revealed that the plants were winged loosestrife (<i>Lythrum Alatum</i>) and not purple loosestrife (<i>Lythrum Salicaria</i>). In 2004 the land owner removed the plants. In 2007 the plants reoccurred at this location. During the 2008, 2009, 2010, 2011, 2012, 2013 and 2014 survey the plants could not be located. This site is videotaped in 2002 and photographed in 2007.
2	246 FLUPPL002	N45 56.157'	W90 26.607'	N/A	N/A	Located on the waypoint in the cattails at the northwest corner of the electrical sub-station fence, this occurrence was first observed in 2006 and removed. No old cane or damages visible. Reoccurred and pulled again in 2007. During the 2008, 2009, 2010, 2011, 2012, 2013 and 2014 survey, no purple loosestrife plants could be located at this site. Plants at this location were photographed in 2006.

FLAMBEAU UPPER HYDROELECTRIC PROJECT FERC #2640 PURPLE LOOSESTRIFE 2014

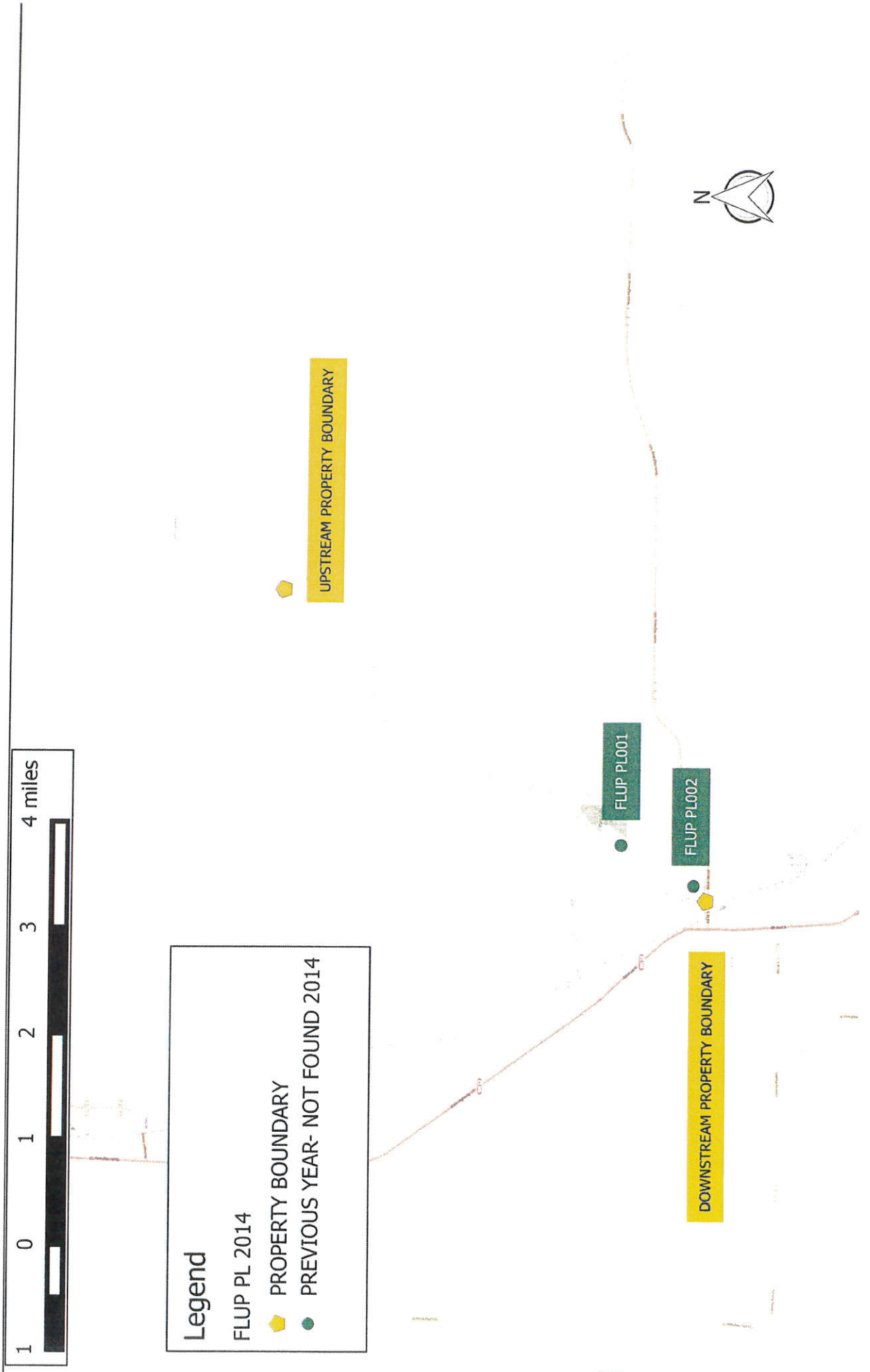

PROJECT
FLOW - 582 CFS

Year 2014 Purple Loosestrife Survey

Flambeau Upper Hydroelectric Project - FERC # 2640

Date: 8/19/14 Conducted By: GARY RAST

HWL: 1486.60 TWL: 1467.4

Time Survey Started: 9:30 AM Time Survey Ended: 10:00 AM

Weather Conditions: WINDS W @ 5 MPH, FOG + MISTING,
TEMP IN LOW 60'S, PRESSURE @ 29.69.

Location of Survey Area: Tailrace _____ Bypass Reach POWER CANAL Impoundment _____

Time of Sighting(s): N/A _____

Location of Sighting(s) (GPS Coordinates): N/A _____

(Attach Photos & Map if Applicable)

Purple Loosestrife: NONE

Other Species Observed: _____

Other Pertinent Survey Information

Gary Rast

PROJECT
Flow 582 CFS

Year 2014 Purple Loosestrife Survey

Flambeau Upper Hydroelectric Project - FERC # 2640

Date: 8/17/14 Conducted By: GARY RAST

HWL: 1486.60 TWL: 1467.4

Time Survey Started: 10:15 AM Time Survey Ended: 11:15 AM

Weather Conditions: WINDS NW @ 3 MPH, OVERCAST, TEMPS
IN LOW 60'S, + PRESSURE @ 29.70.

Location of Survey Area: Tailrace PORTAGE TRAIL Bypass Reach _____ Impoundment _____

Time of Sighting(s): N/A _____

Location of Sighting(s) (GPS Coordinates): N/A _____

(Attach Photos & Map if Applicable)

Purple Loosestrife: NONE

Other Species Observed: _____

Other Pertinent Survey Information

Gary Rast

PROJECT
FLOW - 582 CFS

Year 2014 Purple Loosestrife Survey

Flambeau Upper Hydroelectric Project - FERC # 2640

Date: 8/19/14

Conducted By: GARY RAST + BEN RICHARDS

HWL: 1486.60

TWL: 1467.4

Time Survey Started: 11:30 AM Time Survey Ended: 1:30 PM

Weather Conditions: WINDS NW @ 5 MPH, OVERCAST, TEMPS IN HIGH 60'S, + PRESSURE @ 29.71.

Location of Survey Area: Tailrace _____ Bypass Reach _____ Impoundment X

Time of Sighting(s): N/A _____

Location of Sighting(s) (GPS Coordinates): N/A _____

(Attach Photos & Map if Applicable)

Purple Loosestrife: NONE

Other Species Observed: MALLARD DUCKS, HAWK, SONG BIRDS

Other Pertinent Survey Information

Gary Rast

CORRESPONDENCE

Gary Rast

COPY

From: Aneta Rietveld
Sent: Monday, January 12, 2015 12:58 PM
To: Gary Rast
Subject: FW: FLUP,PXLY,CRLY, FLLW Purple Loosestrife inventory to agencies
Attachments: 14-12-04 GGR AKR FLLW PL Inventory Draft to Agencies.pdf; 14-12-09 GGR AKR PXLY PL Inventory Draft to Agencies.pdf; 14-12-09 GGR AKR FLUP PL Inventory Draft to Agencies.pdf; 14-12-09 GGR AKR CRLY PL Inventory Draft to Agencies.pdf

From: Aneta Rietveld
Sent: Tuesday, December 09, 2014 11:13 AM
To: cheryl.laatsch@wisconsin.gov; 'nick_utrup@fws.gov'
Subject: FW: FLUP,PXLY,CRLY, FLLW Purple Loosestrife inventory to agencies

Hi Nick and Cheryl,

Attached you will find the 2014 Purple Loosestrife inventories for Renewable World Energies, LLC's Pixley, Crowley, Flambeau Lower, and Flambeau Upper projects. All four have already been included in the SWIMS database as of the beginning of November. Please send any comments you may have to me in the next month and a half and I will file as final in the end of January. Thank you,

Aneta Rietveld
RWE Hydro
Environmental
Cell(920)293-1251

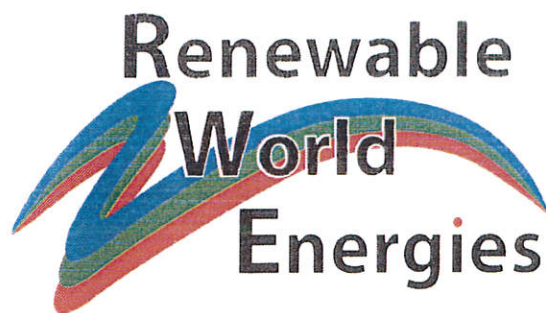

 COPY

December 9, 2014

Mr. Nick Utrup
WI/MN Ecological Services Field Office
U.S. Fish and Wildlife Service
4101 American Blvd. East
Bloomington, MN 55425

Ms. Cheryl Laatsch
Statewide FERC Coordinator
Wisconsin Department of Natural Resources
N7725 Hwy 28
Horicon, WI 53032

**Re: Flambeau Upper Project
FERC # 2640
Flambeau Hydro, LLC
Article 412, 2014 DRAFT Purple Loosestrife Inventory**

Dear Ms. Laatsch, and Mr. Utrup:

Attached you will find a copy of the Flambeau Hydro, LLC "Purple Loosestrife Inventory" for 2014. This annual report has been prepared to comply with the federal hydropower license of the project and article named above. A final copy will be filed with the Federal Energy Regulatory Commission with any comments you might add by the end of January.

If you have any questions regarding this submission, please contact Mr. Gary Rast at Renewable World Energies Neshkoro office @ (855)994-9376, ext 105 or Aneta Rietveld at Renewable World Energies Norway office @ (855)994-9376, ext 108. They can also be reached via email at grast@rwehydro.com or arietveld@rwehydro.com.

Sincerely,
Renewable World Energies, LLC
Agent for the Licensee

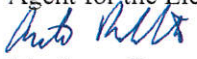
For: Mr. Jason Kreuzscher
Vice President Operations

Attached: Flambeau Upper 2014 Draft Purple Loosestrife Inventory

CC: RWE Hydro, Corporate

Corporate Office
P.O. Box 264
100 S. State Street
Neshkoro, WI 54960
Fax: 920-293-4100

Phone: 855-99HYDRO
(855-994-9376)
www.renewableworldenergies.com

Administrative Office
1001 Stephenson Street
Norway, MI 49870
Fax: 906-563-9344

Document Content(s)

15-01-12 GGR FLUP FINAL P L RPT TO FERC.PDF.....1-12