

January 12, 2015

Kimberly D. Bose, Secretary  
Federal Energy Regulatory Commission  
888 First Street, N.E.  
Washington, DC 20426

**RE: Flambeau Pixley FERC Project Number 2395  
Flambeau Hydro LLC  
Final Report 2014 Purple Loosestrife Inventory Report**

Dear Ms. Bose:

On behalf of Flambeau Hydro LLC, "Flambeau" (Licensee), Renewable World Energies, LLC (RWE) is submitting a copy of the *Final Report 2014 Purple Loosestrife Inventory Report* for the Flambeau Pixley Hydroelectric Project. The report is a requirement of Flambeau's Federal license pursuant to article 410. Monitoring was conducted on August 20, 2014. No out of the ordinary issues were encountered and no Purple Loosestrife was observed. The draft report was sent to the agencies by a letter dated December 9, 2014 as an attachment to an e-mail sent the same day for review and comment. No comments have been received from WDNR or the USFWS. The next scheduled monitoring event will be conducted in 2015.

If you have any questions concerning this submittal, please contact Mr. Gary Rast at the Renewable World Energies, LLC offices @ 855-994-9376 Ext 105. He can also be reached by e-mail at [grast@rwehydro.com](mailto:grast@rwehydro.com).

**Corporate Office**  
P.O. Box 264  
100 S. State Street  
Neshkoro, WI 54960  
Fax: 920-293-4100

Phone: 855-99HYDRO  
(855-994-9376)  
[www.renewableworldenergies.com](http://www.renewableworldenergies.com)

**Administrative Office**  
1001 Stephenson Street  
Norway, MI 49870  
Fax: 906-563-9344



Sincerely,  
Renewable World Energies, LLC  
Agent for Licensee

A handwritten signature in black ink, appearing to read "Mr. Jason Kreuscher". The signature is written in a cursive style and is positioned above the printed name and title.  
Mr. Jason Kreuscher  
Vice President, Operations

Attachment: Flambeau Pixley Final Purple Loosetrife Inventory Report

Cc: Ms. Cheryl Laatsch, WDNR  
Mr. Nick Utrup, USFWS  
RWE, Corporate

**Flambeau Pixley Project Purple Loosestrife Inventory**  
**August 20, 2014**  
**FERC Project # 2395 Article 410**

**Flambeau Hydro LLC**  
**100 S. State St.**  
**Neshkoro, WI 54960**

*Purple Loosestrife*

On August 20, 2014, Flambeau Hydro, LLC (FHLLC) performed an inventory of purple loosestrife plants at the Flambeau Pixley Project in Price County, Wisconsin. The method of inventory as approved and modified by Federal Energy Regulatory Commission (FERC) Order of June 18, 2003 was defined as follows:

While Purple Loosestrife is blooming in mid-July to early August, the inventory should be conducted using a boat to survey the impoundment above the dam within the Project Boundary and on foot or by boat below the dam within the Project Boundary. County wetland maps may be used to determine other areas where Purple Loosestrife could be found on lands owned by FHLLC within the Project Boundary. Lands owned by FHLLC within the Project Boundary will be surveyed on foot. A pair of binoculars should be used to search for the purple flowered spikes of the plant. When plants are located, the person(s) inventorying should get close enough to make a positive identification without disturbing the plants or the immediate area around the plants as this could cause them to spread. A GPS receiver will be used to establish a GPS coordinate for the location of the plants. If it is not possible to get close enough to establish an accurate location, an approximate location will be established with reference to an established GPS coordinate. The plants should be inventoried by marking and numbering the location on a Project map along with notes approximating size of plants, stand area, percent cover, stem density, plant density, and location with reference to established GPS coordinates. Photos and/or videotape will be taken of the largest occurrences.

Example:

#1) 6' tall plants; 4' x 20'; 30% cover; 4-5 stems per plant; 4 plants; on shoreline N45 56.183' W90 26.748'; no photo

#2) 5'-7' tall plants; 10' x 10'; 25% cover; 4-5 stems per plant; 10 plants; in marsh ~50 feet Bearing 25 degrees from N45 56.256' W90 26.710'; photo No. 1

The area to be inventoried shall be the shoreline of the impoundment to elevation 1450 feet NGVD and lands owned by FHLLC within the Project Boundary as indicated on the Project Maps 1, dated November 1991, included in Exhibit G of Flambeau Paper Corp. Application for a Subsequent License for the Pixley Hydroelectric Project FERC Project #2395.

General Observations:

The Flambeau Pixley Project Boundary was divided into three different areas; *the impoundment* (from HWY 13 bridge in Park Falls to the dam), *FHLLC-owned property within the project boundary* (FHLLC owned property adjacent to the dam and powerhouse), and *the tailrace* (from the dam and powerhouse to approximately 500 feet downstream of the dam).

*The tailrace* was surveyed by boat and no purple loosestrife plants were observed.

*The FHLLC-owned property within the project boundary* was surveyed on foot and no purple loosestrife plants were observed.

*The impoundment* was surveyed by boat and no purple loosestrife plants were observed.

All survey information has been entered into the SWIMS database for the 2014 year.

If any purple loosestrife plants had been found during the inventory, a digital camera would have been used to document these occurrences and GPS coordinates for the location of the plants would have been recorded.

**Purple Loosestrife Survey**

**Project:** Flambeau Pixley #2395      **Datum:** WGS 84  
**Date:** August 20, 2014      **Page:** 1 of 1  
**Crew:** GGR and AKR

Sighting #	GPS Point	Latitude	Longitude	Plant Height	Stand Area	Comments
						No occurrences of purple loosestrife were found within the project boundary in 2014.

# PIXLEY HYDROELECTRIC PROJECT FERC #2395 PURPLE LOOSETRIFE 2014



**Legend**

- ◆ PROJECT BOUNDARY

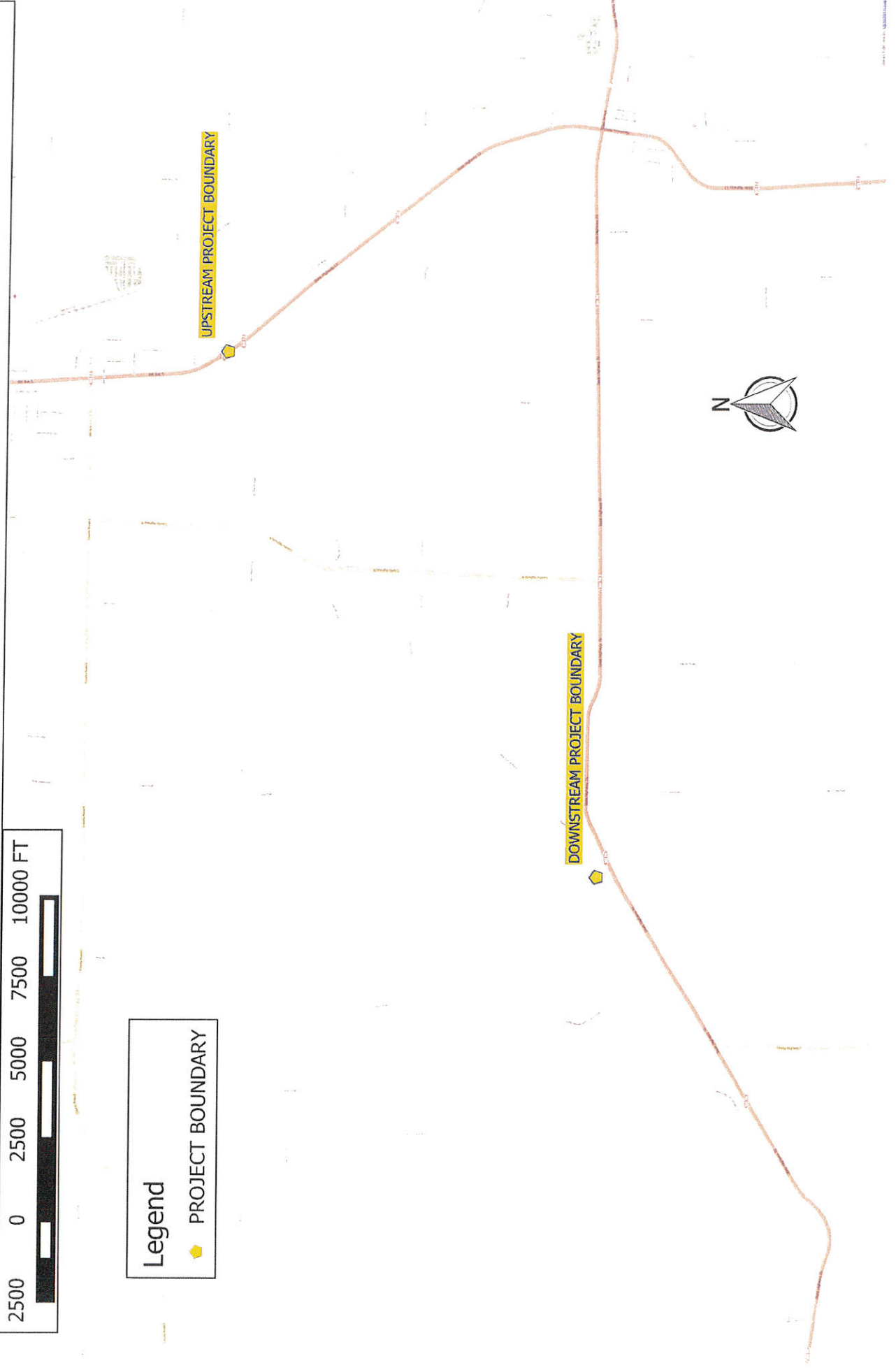

Year 2014 Purple Loosetrife Survey

Flambeau Pixley Hydroelectric Project – FERC # 2395

Date: 8-20-14 Conducted By: AKR GGR

HWL: 1448.74 TWL: 1427.50 cfs 530

Time Survey Started: 12:00 Time Survey Ended: 3:30 pm

Weather Conditions: cloudy 72° no wind

Location of Survey Area: Tailrace \_\_\_\_\_ Bypass Reach \_\_\_\_\_ Impoundment X

Time of Sighting(s): \_\_\_\_\_

Location of Sighting(s) (GPS Coordinates): \_\_\_\_\_

(Attach Photos & Map if Applicable)

Purple Loosetrife: none observed

Other Species Observed: 20+ painted turtles, Kingfishers, ducks

Other Pertinent Survey Information

AKR GGR



Year 2014 Purple Loosetrife Survey

Flambeau Pixley Hydroelectric Project – FERC # 2395

Date: 8-20-14 Conducted By: AKR

HWL: 1448.74 TWL: 1427.50 SFS 530

Time Survey Started: 5:15 Time Survey Ended: 6:00

Weather Conditions: cloudy, 65°

Location of Survey Area: Tailrace X canoe portage Bypass Reach        Impoundment       

Time of Sighting(s):       

Location of Sighting(s) (GPS Coordinates):       

(Attach Photos & Map if Applicable)

Purple Loosetrife: none seen

Other Species Observed:       

Other Pertinent Survey Information

AKR



# **CORRESPONDENCE**

**Gary Rast**

---

**From:** Aneta Rietveld  
**Sent:** Monday, January 12, 2015 12:58 PM  
**To:** Gary Rast  
**Subject:** FW: FLUP,PXLY,CRLY, FLLW Purple Loosestrife inventory to agencies  
**Attachments:** 14-12-04 GGR AKR FLLW PL Inventory Draft to Agencies.pdf; 14-12-09 GGR AKR PXLY PL Inventory Draft to Agencies.pdf; 14-12-09 GGR AKR FLUP PL Inventory Draft to Agencies.pdf; 14-12-09 GGR AKR CRLY PL Inventory Draft to Agencies.pdf



**COPY**

---

**From:** Aneta Rietveld  
**Sent:** Tuesday, December 09, 2014 11:13 AM  
**To:** [cheryl.laatsch@wisconsin.gov](mailto:cheryl.laatsch@wisconsin.gov); 'nick\_utrup@fws.gov'  
**Subject:** FW: FLUP,PXLY,CRLY, FLLW Purple Loosestrife inventory to agencies

Hi Nick and Cheryl,

Attached you will find the 2014 Purple Loosestrife inventories for Renewable World Energies, LLC's Pixley, Crowley, Flambeau Lower, and Flambeau Upper projects. All four have already been included in the SWIMS database as of the beginning of November. Please send any comments you may have to me in the next month and a half and I will file as final in the end of January. Thank you,

Aneta Rietveld  
RWE Hydro  
Environmental  
Cell(920)293-1251

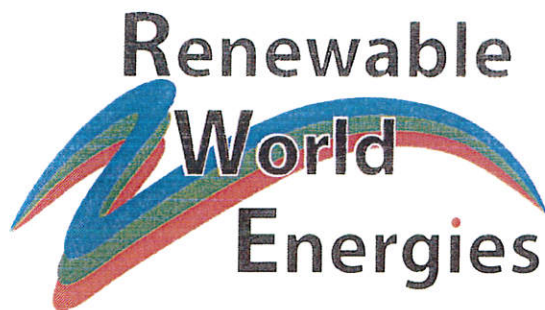

 COPY

December 9, 2014

Mr. Nick Utrup  
WI/MN Ecological Services Field Office  
U.S. Fish and Wildlife Service  
4101 American Blvd. East  
Bloomington, MN 55425

Ms. Cheryl Laatsch  
Statewide FERC Coordinator  
Wisconsin Department of Natural Resources  
N7725 Hwy 28  
Horicon, WI 53032

**Re: Flambeau Pixley Project**  
**FERC # 2395**  
**Flambeau Hydro, LLC**  
**Article 410, 2014 DRAFT Purple Loosetrife Inventory**

Dear Ms. Laatsch, and Mr. Utrup:

Attached you will find a copy of the Flambeau Hydro, LLC "Purple Loosetrife Inventory" for 2014. This annual report has been prepared to comply with the federal hydropower license of the project and article named above. A final copy will be filed with the Federal Energy Regulatory Commission with any comments you might add by the end of January.

If you have any questions regarding this submission, please contact Mr. Gary Rast at Renewable World Energies Neshkoro office @ (855)994-9376, ext 105 or Aneta Rietveld at Renewable World Energies Norway office @ (855)994-9376, ext 108. They can also be reached via email at [grast@rwehydro.com](mailto:grast@rwehydro.com) or [arietveld@rwehydro.com](mailto:arietveld@rwehydro.com).

Sincerely,  
Renewable World Energies, LLC  
Agent for the Licensee

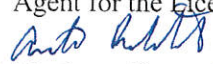
  
For: Mr. Jason Kreuzer  
Vice President Operations

Attached: Flambeau Pixley 2014 Draft Purple Loosetrife Inventory

CC: RWE Hydro, Corporate

**Corporate Office**  
P.O. Box 264  
100 S. State Street  
Neshkoro, WI 54960  
Fax: 920-293-4100

Phone: 855-99HYDRO  
(855-994-9376)  
[www.renewableworldenergies.com](http://www.renewableworldenergies.com)

**Administrative Office**  
1001 Stephenson Street  
Norway, MI 49870  
Fax: 906-563-9344

Document Content(s)

15-01-12 GGR PXLY FINAL P L RPT TO FERC.PDF.....1-11