

Cambria Sewage Treatment Plant
Columbia County

October 20, 1976

Duck Creek, North Branch - Surface Acres = 68.1, Miles = 23.4, Gradient - 7.1 feet per mile.

A meandering stream which originates above Tarrant Lake at Cambria and receives numerous ditched tributaries along its course to the Wyocena Millpond. Pollution is a continuing problem for this stream. It has reduced the fishery to one of bullheads, carp, suckers and forage species which nearly every year experiences pollution-caused mortalities. About 2,427 acres of wetland adjoin the stream.

Recommendations

From the Cambria lagoon outfall and for the remainder of the North Branch of Duck Creek, the classification should be continuous fish and aquatic life.

The above recommendations represent a concurrence of opinion of the stream classification team who are as follows:

Robert Weber - District Engineer
Jim Congdon - Area Fish Manager
Tom Bainbridge - Stream Classification Coordinator
Roger Schlessler - Natural Resources Technician

Respectfully submitted,

Thomas Bainbridge
Stream Classification Coordination

RS:lg

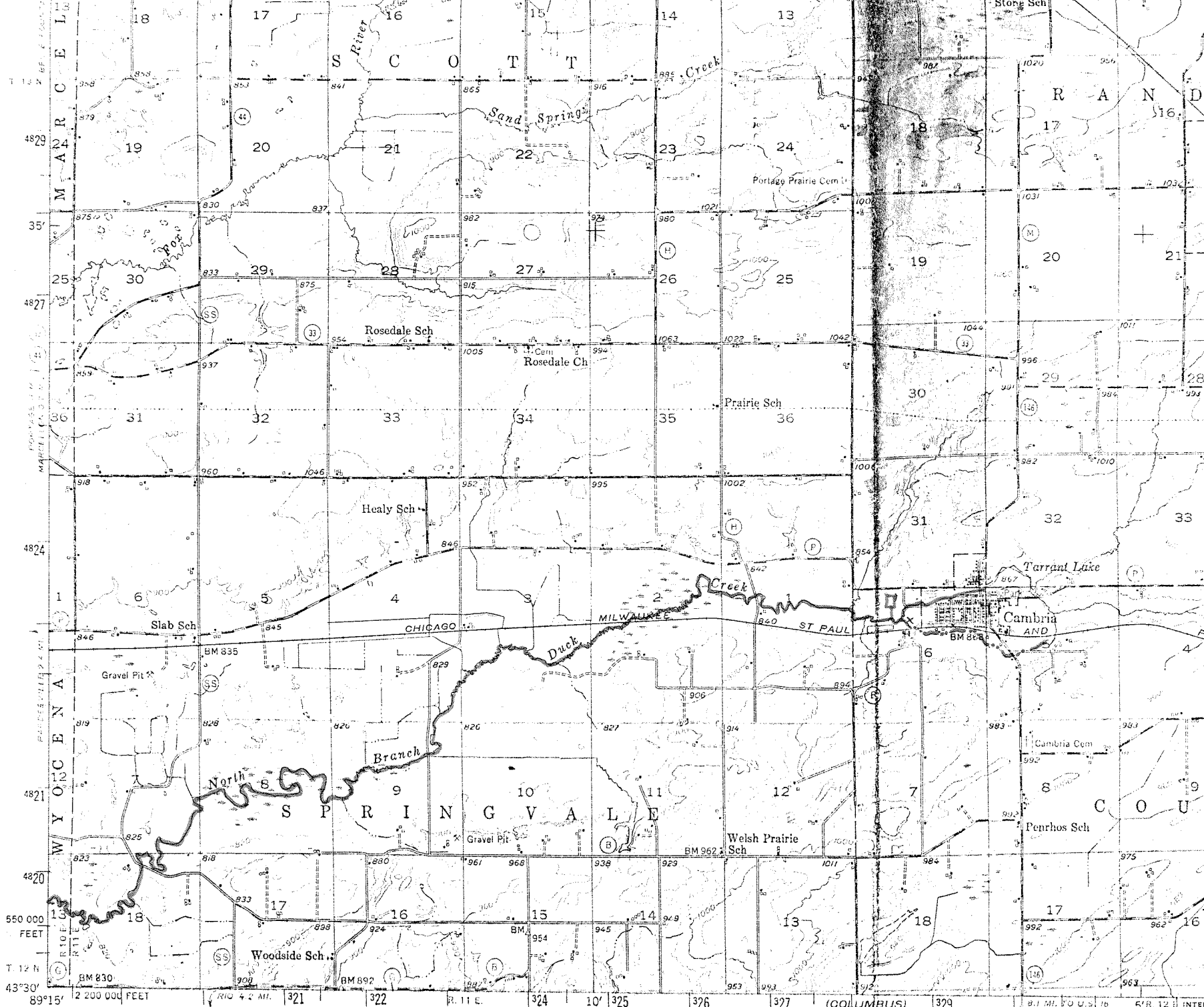

Mapped, edited, and published by the Geological Survey
 in cooperation with State of Wisconsin agencies

Control by USGS and USC&GS

BOYNETTE
 1170 IV



(COLUMBUS)
 3170
 SCALE 1:62500