

Cambridge Water and Sewer Department
Dane County

January 11, 1977

Koshkonong Creek - Surface Acres = 45.8 Miles, Miles = 31.8, Gradient = 3.8 feet per mile.

A major drainage stream in eastern Dane County, managed for panfish primarily, with abundant populations of rough fishes. Bullheads are common and contribute to the fishery. Northern pike are found throughout the stream and provide limited fishing. Over 4,300 acres of wetland adjoin the stream in small plots along its entire length. North of London, on this stream, drainage has converted a large block of marshland to muck farm. The stream is impounded at Rockdale by a dam with a ten-foot head. Muskrats are common, primarily bank rats, and puddle ducks provide some waterfowl opportunities.

Recommendations

From the Cambridge discharge and for the remainder of Koshkonong Creek the classification should be continuous fish and aquatic life.

The above recommendations represent a concurrence of opinion of the stream classification team who are as follows:

Roy Lembcke - District Engineer
Clifford Brynildson - Area Fish Manager
Tom Bainbridge - District Biologist
Roger Schlessler - Natural Resources Technician

Respectfully submitted,

Thomas Bainbridge
Stream Classification Coordinator

RS:js

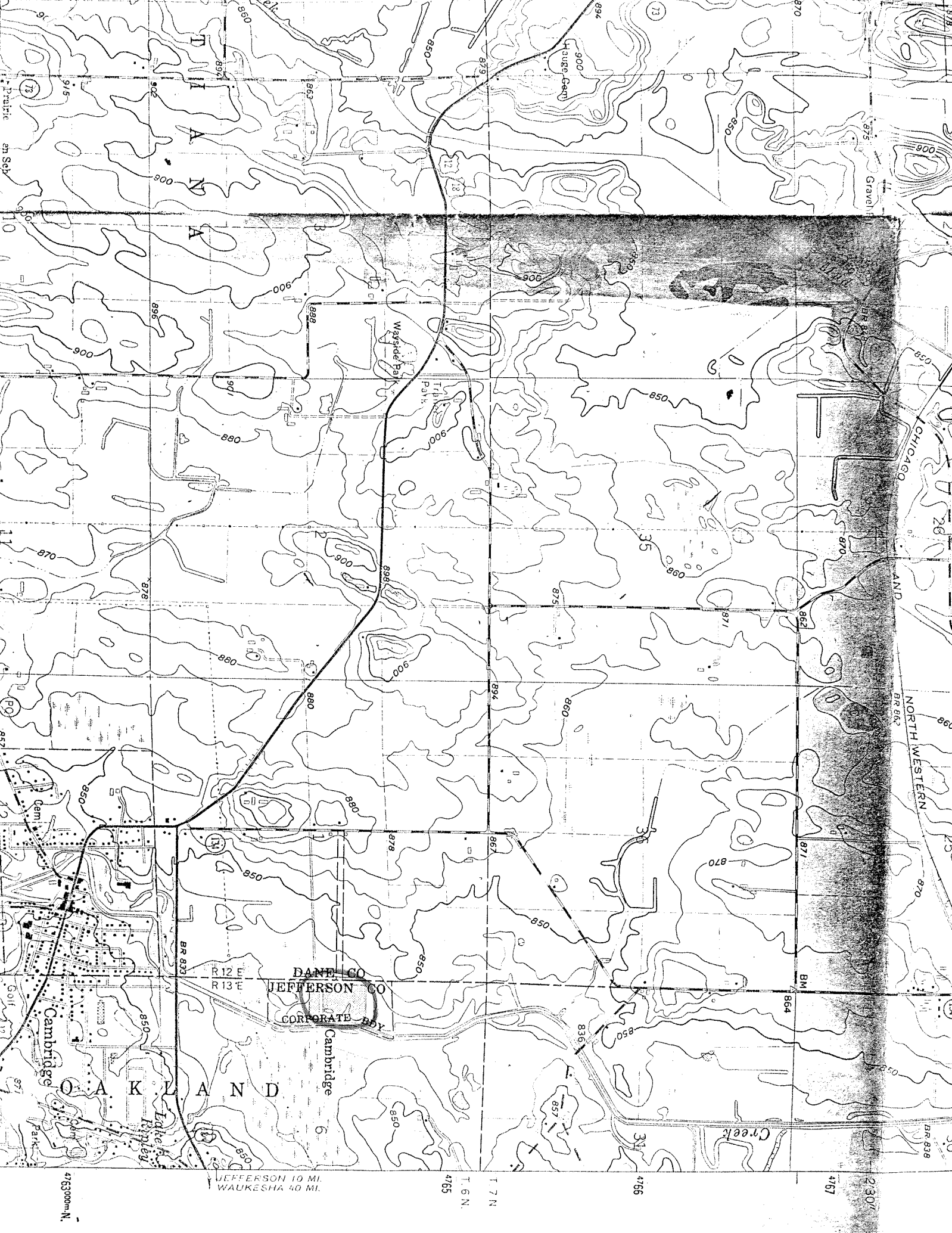

4763000m N.

JEFFERSON 10 MI.
WAUKESHA 40 MI.

4765
T. 6 N
T. 7 N

4755

4767

2 30'