

WISCONSIN DEPARTMENT OF HEALTH & SOCIAL SERVICES
OAKWOOD STATE CAMP
DANE COUNTY

October 5, 1976

Murphy Creek Tributary - The Oakwood State Camp treatment plant discharges into Murphy Creek Tributary which runs into a large marsh. Murphy Creek Tributary is an intermittent generally dry tributary. No discharge enters Murphy Creek in a direct manner due to absorption by the marshland acreage.

Recommendations

Murphy Creek Tributary in its entirety should be classified as noncontinuous marginal surface waters.

The above recommendations represent a concurrence of opinion of the stream classification team who are as follows:

Roy Lembcke	District Engineer
Clifford Brynildson	Area Fish Manager
Tom Bainbridge	Stream Classification Coordinator
Roger Schlessler	Natural Resources Technician

Thomas Bainbridge
Stream Classification Coordinator

GS:lg

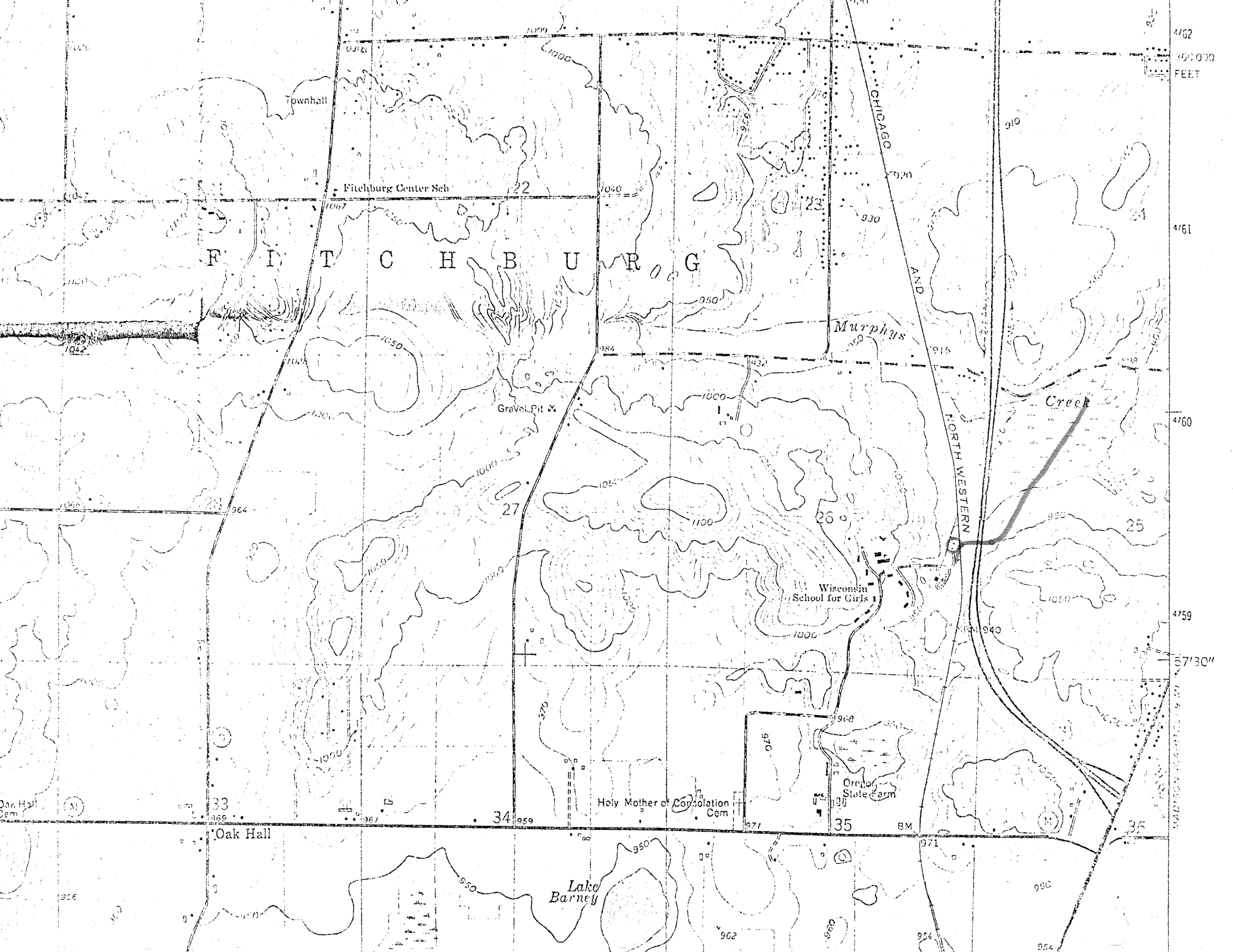

4762
4761'30"
FEET

Townhall

Fitchburg Center Sch

FITCHBURG

Murphys

NORTH WESTERN

Creek

Gravel Pit X

Wisconsin School for Girls

Holy Mother of Consolation Cem

Ordor State Farm

Oak Hall

Lake Barney

4759
57'30"

U.S. GEOLOGICAL SURVEY