

Northern Lake Terrace - Oneida County

The Northern Lake Terrace treatment system consists of a small "package plant" which discharges to a spruce bog. The discharge apparently flows underground through the bog about $\frac{1}{2}$ mile to Little Moccasin Lake.

Recommendations: The receiving area for the Northern Lake Terrace discharge should be classified wetland and, therefore, it has the marginal water quality classification.



Wetland receiving
Northern Lake Terrace
discharge.

10/10/76
Rick Garrison

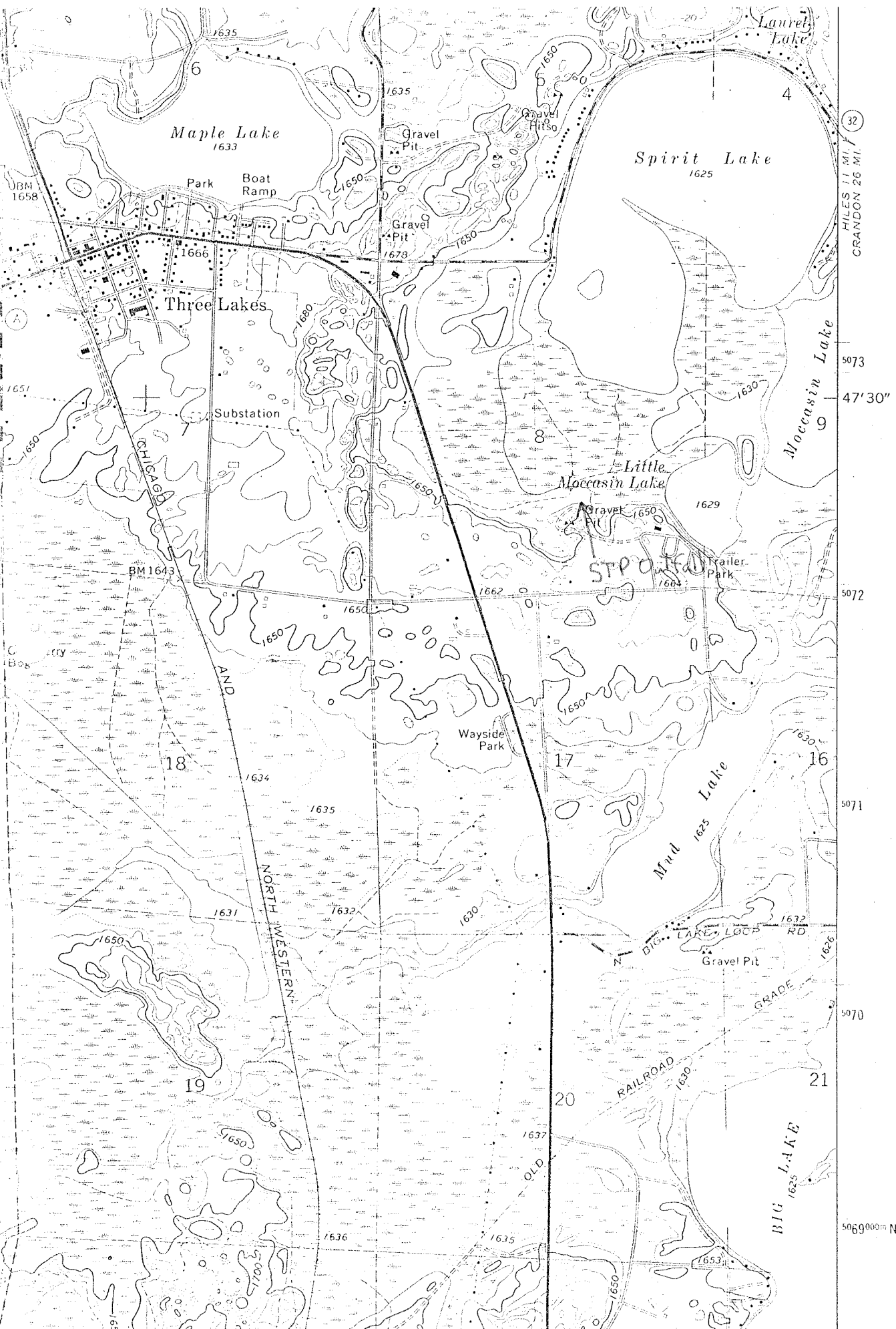

FILES 11 MI. / CRANDON 26 MI.

5073

47'30"

5072

5071

5070

5069.000m N.

Field Survey Date: 10/25/76

Survey Crew: Bill Jaeger, E. P. Biologist