

AUSTIN STRAUBEL FIELD

GREEN BAY, BROWN COUNTY

The Austin Straubel STP discharges to an unnamed tributary to Dutchman's Creek. The outfall is located about 2.5 miles above the confluence of the tributary and Dutchman's Creek.

RECOMMENDATIONS

The unnamed tributary should be classified as non-continuous/marginal above CTH GH and non-continuous/intermediate aquatic life below GH to the confluence with Dutchman's Creek. Dutchman's Creek should be classified as continuous/fish and aquatic life.

  
\_\_\_\_\_  
Dan Uhl

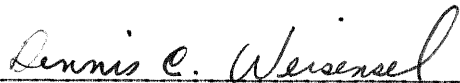
  
\_\_\_\_\_  
Dennis Weisensel

DU:jp

- ··· - Non-CONTINUOUS/MARGINAL E
- ··· - Non-CONTINUOUS/INT. F & A D
- ——— CONTINUOUS/F & A H/PK

① PHOTO LOCATIONS



AUSTIN STRAUDEL FIELD S-17-76

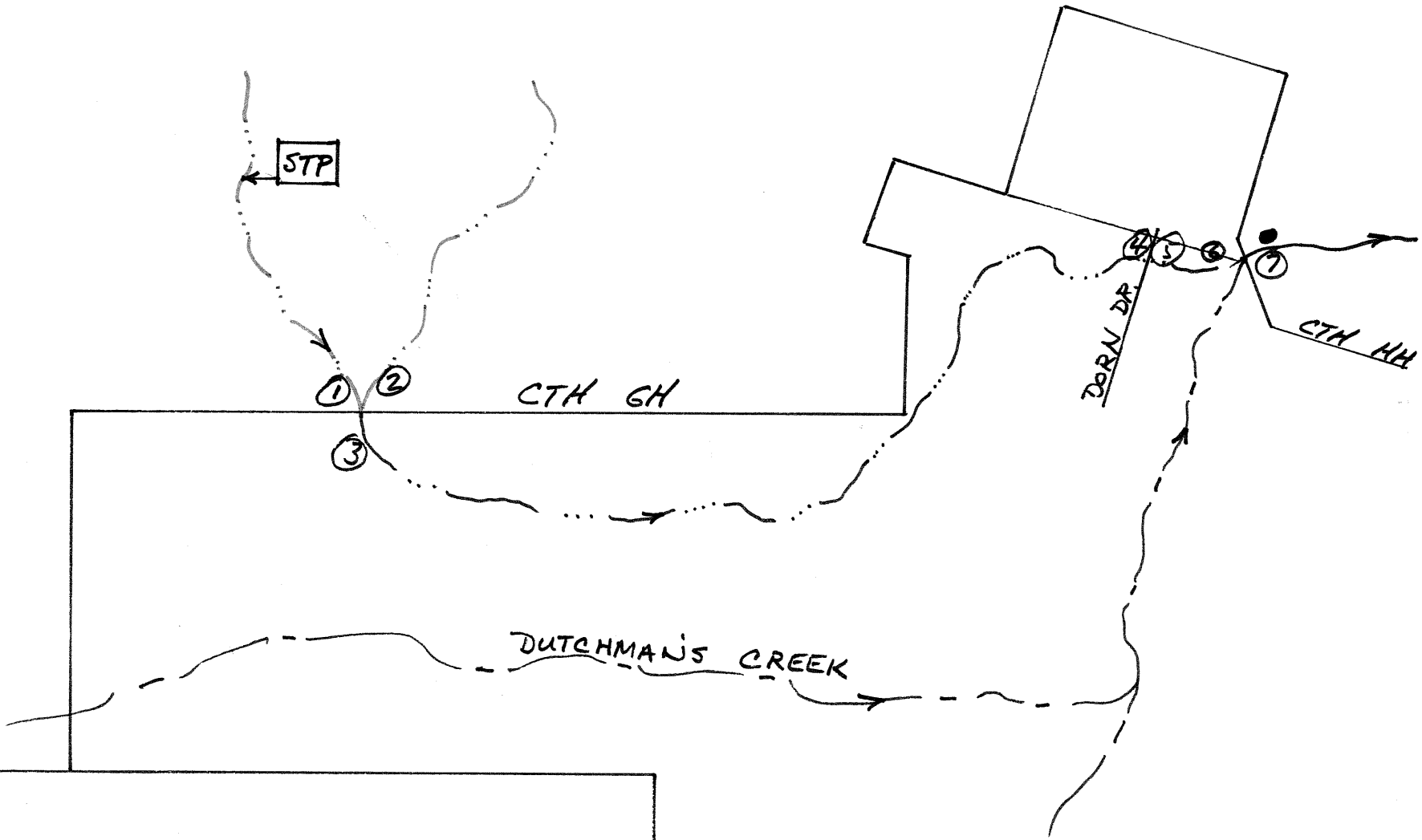

DE PERE QU, WISCONSIN

15 MINUTE SERIES (TOPOGRAPHIC)

GREEN BAY (CH.) 1 MI. 88°00' 44"30"

DUCK CREEK 5.7 MI. 2.2 MI. TO WIS. 154

2 500 000 FEET 1" R. 20 E.

3373 II (GREEN BAY)

409

408

10'

ONEIDA

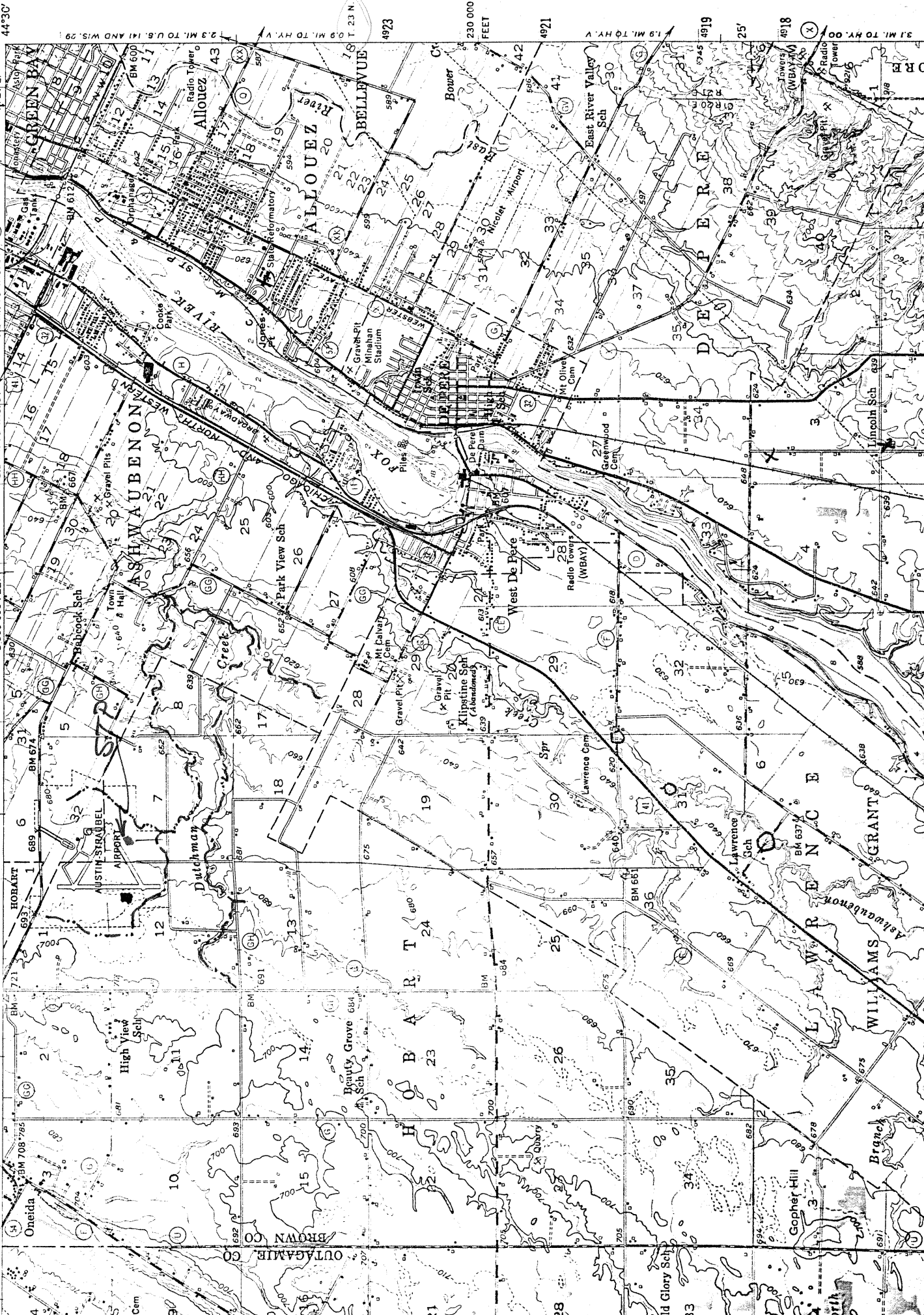

NEW 3473

GREEN BAY (CH.) 1 MI. 88°00' 44"30"

DUCK CREEK 5.7 MI. 2.2 MI. TO WIS. 154

2 500 000 FEET 1" R. 20 E.

3373 II (GREEN BAY)

409

408

10'

ONEIDA

BROWN CO

BEAUTY GROVE Sch

High View Sch

ASHWAUBENTON

ALLOUEZ

DE PERE

WISCONSIN

230 000 FEET

1.9 MI. TO HY. V.

1.8 MI. TO HY. V.

1.7 MI. TO HY. V.

1.6 MI. TO HY. V.

1.5 MI. TO HY. V.

1.4 MI. TO HY. V.

1.3 MI. TO HY. V.

1.2 MI. TO HY. V.

1.1 MI. TO HY. V.

1.0 MI. TO HY. V.

0.9 MI. TO HY. V.

0.8 MI. TO WIS. 154

0.7 MI. TO WIS. 154

0.6 MI. TO WIS. 154

0.5 MI. TO WIS. 154

0.4 MI. TO WIS. 154

0.3 MI. TO WIS. 154

0.2 MI. TO WIS. 154

0.1 MI. TO WIS. 154

0.0 MI. TO WIS. 154

0.0 MI. TO WIS. 154

0.0 MI. TO WIS. 154



#1 Upstream view at  
CTH "GH" (Below WWTP)

#2 Tributary to creek  
at CTH "GH"



#3 Downstream view at  
at CTH "GH"





#4 upstream view at junction  
of Down + Conrad Rds.



#5 Downstream view at junction of  
Down + Conrad Roads



#6 Upstream view at  
CTH "HH"



#7 Downstream view at  
CTH "HH"