

Date 2/11/2002

Facility Name Plymouth WWTP

Receiving Water Mullet River

Evaluated by Galarneau

This stream classification is not included in the revised code because (select one):

The discharger is no longer at this location.

A new classification has resulted in a full fish and aquatic life designation.
New survey date _____ Please provide copy of new classification report.

This receiving water should be added to the database and to the code. Specify information, as it should be included in code.

Other (please explain)

Was classified as Full Fish and Aquatic Life
and still is. Please see the write-up for the Mullet
River (and Northern Moraine WWTP section).

Plymouth
Sheboygan County

Survey Date: 8-26-75

The Plymouth STP discharges its effluent through an outfall pipe extending south 1,000 feet to the Mullet River. The Mullet River is Class II trout waters above the STP. Previous low flow studies have indicated severe stream degradation below the outfall.

Recommendations

Continuous, fish and aquatic life.



Robert B. Lucas
Environmental Engineer



Dennis C. Weisensel
District Biologist

RBL:DCW:sh

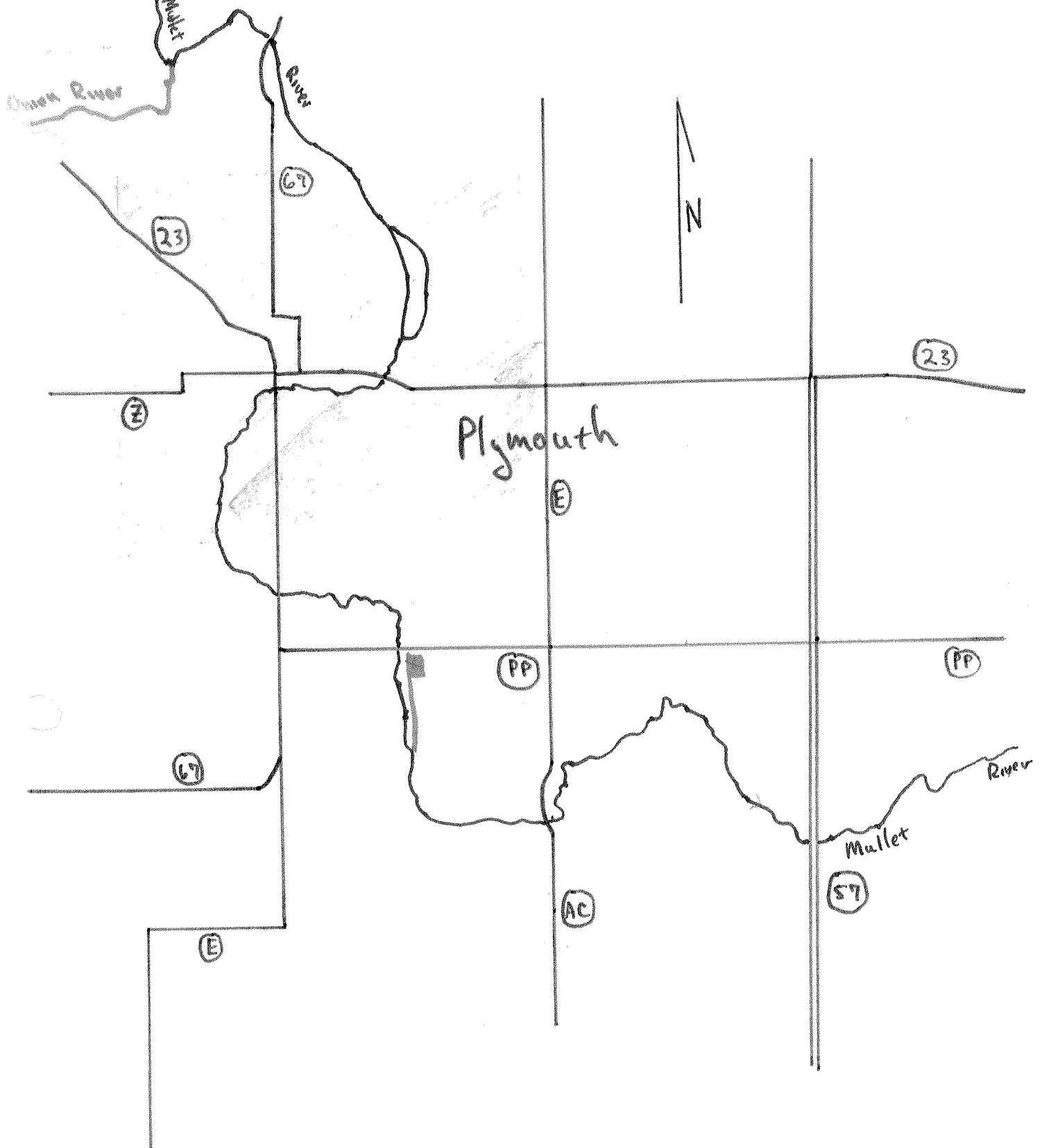

■ = STP and outfall