

Date 6/26/2000

Facility Name STURTEVANT POTW

Receiving Water UNNAMED TRIBUTARY TO PIKE RIVER

Evaluated by WW Wawrzyn

This stream classification is not included in the revised code because (select one):

The discharger is no longer at this location.

A new classification has resulted in a full fish and aquatic life designation.  
New survey date \_\_\_\_\_ Please provide copy of new classification report.

This receiving water should be added to the database and to the code. Specify information, as it should be included in code.

---

---

---

---

---

---

---

Other (please explain)

THIS FACILITY HAS BEEN ABANDONED AND NO  
LONGER DISCHARGES TO THIS STREAM

---

---

---

Sturtevant, Racine County

The effluent from the Sturtevant Wastewater Treatment Plant is discharged to a ditch which has a  $7Q_{10}$  of 0 cfs. The ditch originates west of the treatment plant and flows east for approximately 2.5 miles before entering the Pike River. Both the ditch and the Pike River have had alterations to their channels and flow through open, cultivated land with relatively little stream bank protection.

The treatment plant outfall is approximately one mile upstream of the confluence with the Pike River. St. Bonaventure School discharges their effluent to a ditch which enters the main ditch just upstream of the treatment plant outfall. S. C. Johnson and Sons, Inc. discharges cooling water at a point approximately 0.75 miles upstream of the confluence with the Pike River. The major portion of the flow is from S. C. Johnson and Sons, Inc.

An electrofishing survey conducted by Department of Natural Resources personnel in September, 1975 near the Chicago and Northwestern Railroad bridge, collected the following fish: brown bullheads, fathead minnows, green sunfish, and creek chubs. The Pike River is managed for forage species of fish only.

Hoods Creek is another small stream in the area, located about one mile north of Sturtevant.

Recommendations

The section of the ditch upstream of the Sturtevant Wastewater Treatment Plant outfall shall be classified as a non-continuous, agricultural ditch. The section of the ditch from the treatment plant outfall to the Chicago and Northwestern Railroad bridge shall be classified as an effluent ditch. The section of the ditch from the railroad bridge to the confluence with the Pike River shall be classified as a continuous intermediate aquatic life stream. The Pike River shall be classified as a continuous fish and aquatic life stream.

drop  
a lake

TRIBUTARY PIKE RIVER - STURTEVANT, RACINE CO.  
SOUTHEAST DISTRICT

(7)

Surface Water (Facility Affected)	Reach Description	Hydrologic Classification	Applicable Criteria (1)	Effluent Limitations (2)
	Upstream of STURTEVANT WWTP DISCHARGE (STURTEVANT TRIB.)	(Q, 10) NON-CONT	Aq. II	
	From STUR. Discharge to 1st RR x-ing adjacent to S.C. Johnson	EFFLUENT DITCH.	EFF. Ditch. II	N/A
STURTEVANT TRIB to N. Br. Pike River STURTEVANT WWTP & S.C. Johnson - RACINE	1st RR. x-ing + CONFLUENCE with S.C. Johnson Cooling H <sub>2</sub> O's to confluence with NORTH BRANCH PIKE RIVER	CONTINUOUS	Aquatic life INT. <del>II</del> I	(A)
	PIKE RIVER FROM CONFLUENCE with STUR. TRIB ON DOWN.	CONTINUOUS	FISH & Aq.	



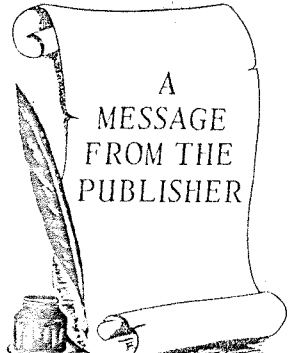
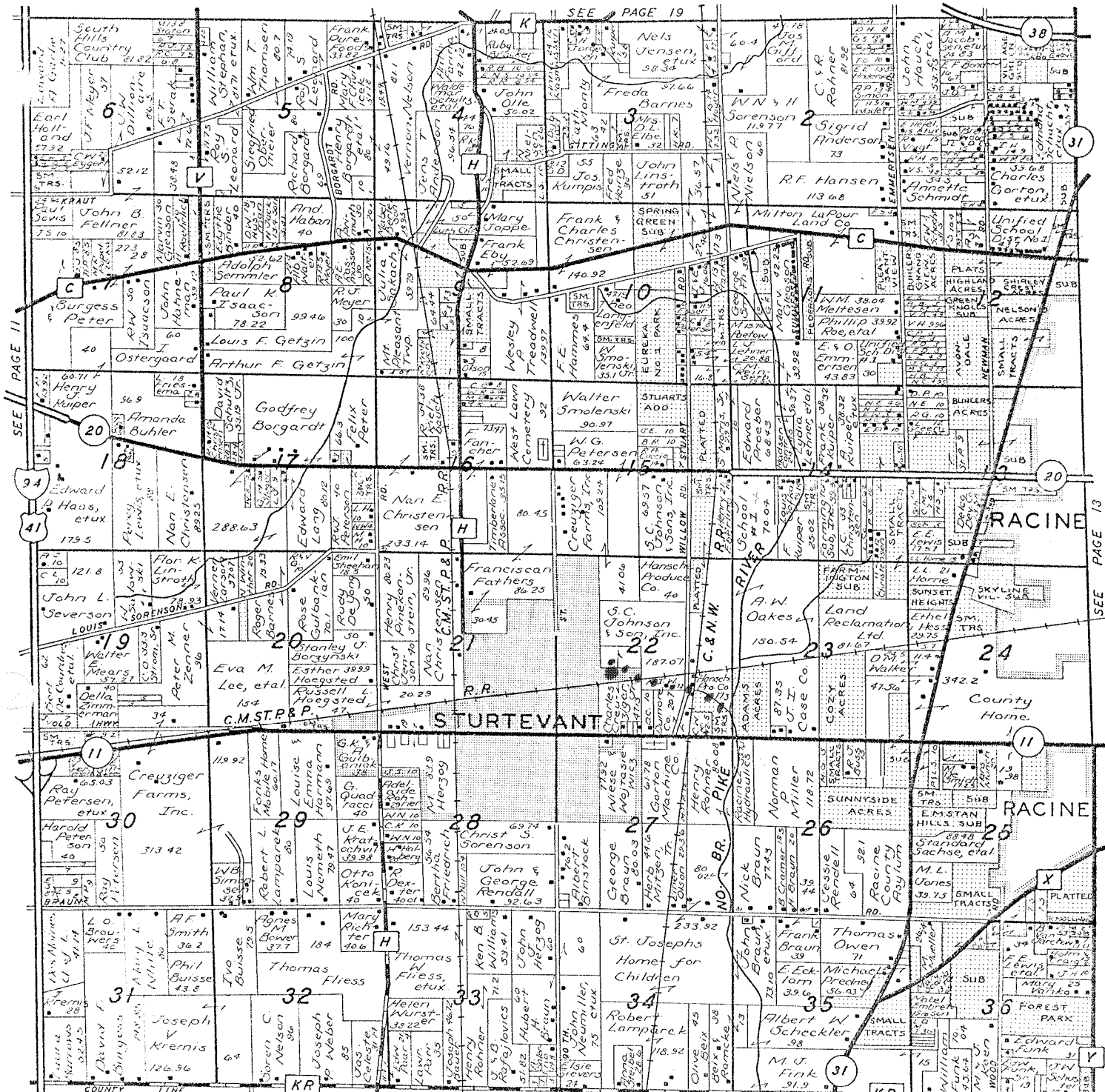

A  
MESSAGE  
FROM THE  
PUBLISHER

**WARNING! DON'T BE MISLED**

Be sure when you are contacted to renew your advertisement that you are dealing with a bona-fide representative of Rockford Map Publishers, Inc. or the sponsoring organization distributing the books for you.

ASK FOR IDENTIFICATION