

From well established → 1st 1st water

Lake Name <i>Nebraska</i>	County <i>DeWitt</i>	WBIC <i>579300</i>	Date(s) <i>7/7/14</i>	AIS sign? <input checked="" type="radio"/> Y <input type="radio"/> N	Secchi (ft or m) <i>6</i>	Conductivity (ZM tow if ≥ 99 umhos/cm) <i>410</i>
Data collectors <i>Ryan M. Amador S.</i>	Lead Monitor phone and email <i>(920) 360-6314 ryan.m.amador@wisconsin.gov</i>	Start time (~ 15 min) <i>9:15</i>	End time (~ 15 min) <i>11:30</i>	Total collector time (hrs x # collectors) <i>2.50 paid / 2.25 volunteers = 4.75</i>		

Look for the following species: Purple loosestrife, Phragmites, flowering rush, Japanese knotweed, Yellow iris, Eurasian water-milfoil, curly-leaf pondweed, Hydrilla, Brazilian waterweed, yellow floating heart, European frog-bit, yellow floating heart, water chestnut, Brazilian waterweed, fanwort, parrot feather, water hyacinth, water lettuce, zebra mussel, quagga mussel, water flea, Chinese mystery snail, banded mystery snail, faucet snail, New Zealand mud snail, Asian clam, red swamp crayfish, rusty crayfish, didymo, and any other AIS found.

STEP 1: Record locations of sampling sites (in decimal degrees). Sampling sites include all public boat landings (BL), 5 target sites (TS) and the meander survey sites (MS). List AIS found at each site or record none. Collect a sample of any new AIS found. Collect five new invasive plant specimens, 20 Dreissenids, and 3 of each snail species and include internal and external labels with WBIC, lake name, county, sample date, sample type (snails, spiny water flea or zebra mussel) and collector. Legibility is appreciated. If needed, preserve with adequate ethanol.

Site	Latitude	Longitude	Snorkel (Y or N*)	If N snorkel, indicate why†	Species, density 1-5‡
BL1	45.05138	88.11993	N	fanatic water	EUM-1
MS1	45.05094	88.12001	N	—	EUM-2
MS2	45.05082	88.12065	N	—	EUM-3
TS1	45.04606	88.11914	N	tried. Fanatic water	EUM-3 ? snails - 1 - very tiny
TS2	45.04547	88.11658	N	—	EUM-5
TS3	45.04711	88.11220	N	—	EUM-5
TS4	45.05039	88.11171	N	—	EUM-5
TS5	45.05063	88.11499	N	—	EUM-4

\*For lakes/sites not snorkeled, substitute:

Boat landing site - 15 rake throws and 15 D-net samples OR 30 minutes, whichever comes first  
 Targeted site - 5 rake throws and 5 D-net samples OR 10 minutes, whichever comes first  
 50 meander sites - 10 rake throws and 10 D-net samples during meander survey between sampling sites for a total of 50 meander survey sites

†If lake/site was not snorkeled, indicate why: stained water, turbid water, blue-green bloom, chemical treatment, other (please describe).

‡ Density Ratings

- 1 - A few plants or invertebrates
- 2 - One or a few plant beds or colonies of invertebrates
- 3 - Many small beds or scattered plants or colonies of invertebrates
- 4 - Dense plant, snail or mussel growth in a whole bay or portion of the lake
- 5 - Dense plant, snail or mussel growth covering most shallow areas

Step 2: Collect Waterflea Tows from the deep hole (DH). Decant s water and preserve the sample. Submit sample and datasheet to Science Services.

Site	Net ring depth	Method (hor, obliq, vert)	Net diameter (30 or 50 cm)	Ethanol added (Y or N)	Samples combined (Y or N)	Sample sent to, date
1	7m			Y	Y	

Step 3: Collect Veliger Tows from 3 sites; the deep hole (DH), water depth of about 4 meters (if possible). Submit sample and Mussel Veliger Tow Monitoring Report form to Science Service.

Site	Net ring depth	Net diameter (30 or 50 cm)	Ethanol added (Y or N)	Samples combined (Y or N)	Sample sent to, date
1	7m		Y	Y	

Step 4: Were plant voucher specimens submitted? Yes No (circle) If yes, where? (circle) Freckmann Herbarium, Other \_\_\_\_\_

Step 5: Were snail voucher specimens submitted (separate into Chinese, banded, all others)? Yes No (circle) If yes, where? (circle) UW La Crosse, or Other \_\_\_\_\_

Step 6: Data was entered into SWIMS on 7/29/14 by Tason Colter

Step 7: Data was proofed on 8/28/14 by Ryan Moffitt

Notes:

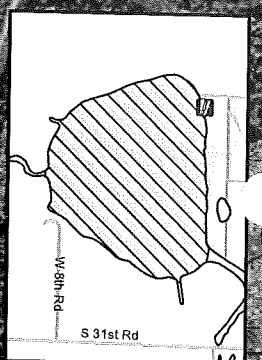

**Map Symbols**

- Landings (Public & Private)
- Hydro Flow Direction Arrows
- Wetlands
- DNR Managed Lands

**LAKE BOTTOM SYMBOLS**

P.	Peat	Gc.	Gravel
Mk.	Muck	R.	Rubble
C.	Clay	Bc.	Bedrock
M.	Marl	Sd.	Sand
T	Submerged vegetation		
L	Emergent vegetation		
	Floating vegetation		

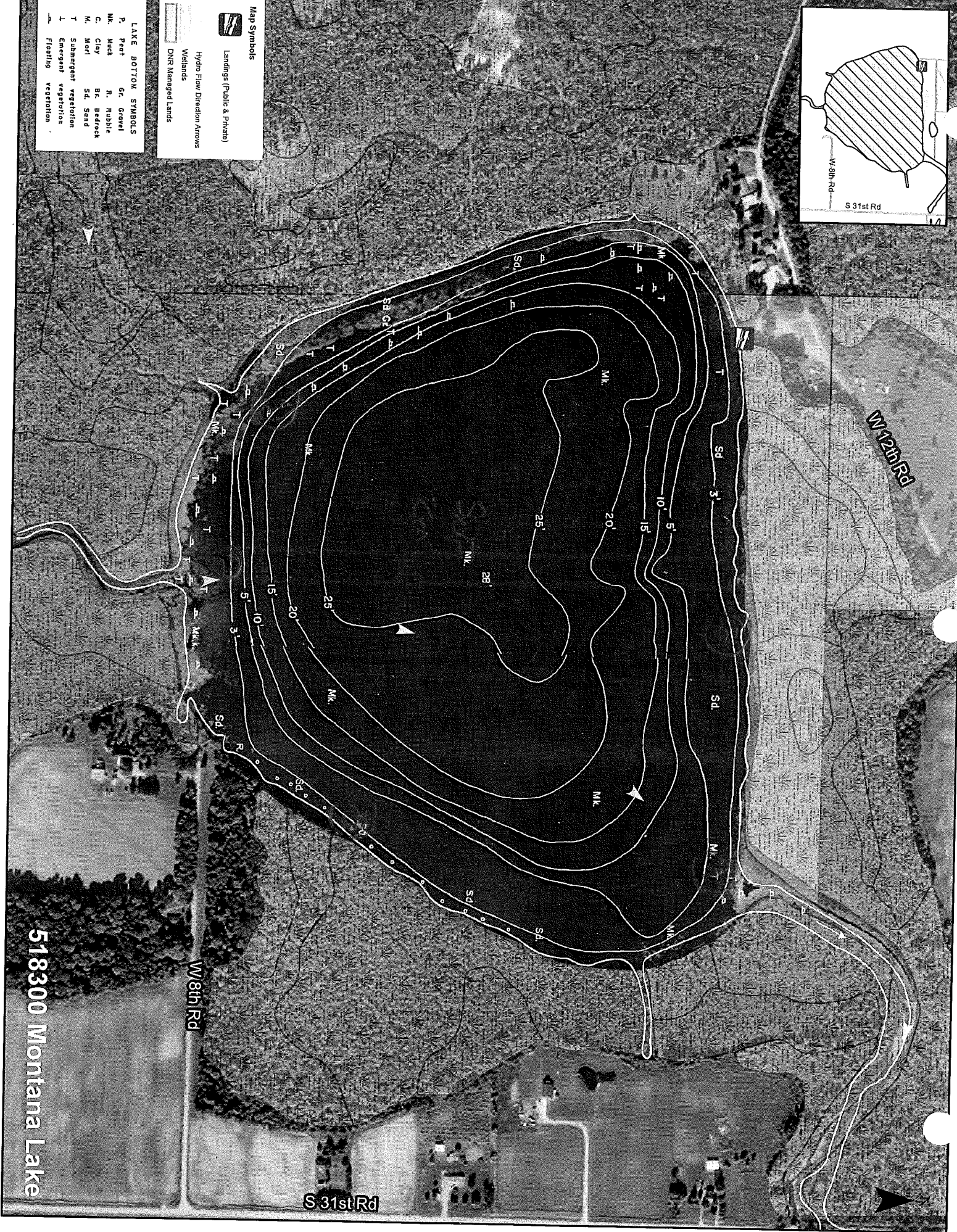

518300 Montana Lake

S 31st Rd

W 8th Rd

W 12th Rd