

Data Collectors <u>Scott Van Egeren / Chris Hamerla</u>		Date <u>8-25-11</u>	
Lake Name <u>Long Lake (Harrison Hills)</u>		County <u>Lincoln</u>	WBIC <u>1001000</u>
Start Time <u>9:15 am</u>	End Time <u>1:30 pm</u>	Secchi Depth <u>21.5</u> <u>feet</u> or meters (circle one) <u>26.5</u>	Conductivity

Look for the following species: Purple loosestrife, Phragmites, flowering rush, Hydrilla, Brazilian waterweed, Eurasian water-milfoil, curly-leaf pondweed, yellow floating heart, zebra mussel, quagga mussel, Chinese mystery snail, banded mystery snail, faucet snail, New Zealand mud snail. List any other AIS found.

STEP 1: Record locations of sites (in decimal degrees) using a GPS unit (datum WGS84). List AIS found at each site or record none. Collect a sample of any suspected AIS found.

Boat Landing# <u>1</u>	Species <u>CMS</u>	Latitude <u>45.42933°</u>	Longitude <u>089.46947°</u>	Density (1-5) <u>2</u>
Boat Landing# <u> </u>	Species <u> </u>	Latitude <u> </u>	Longitude <u> </u>	Density (1-5) <u> </u>
Boat Landing# <u> </u>	Species <u> </u>	Latitude <u> </u>	Longitude <u> </u>	Density (1-5) <u> </u>
Search Site# <u>1</u>	Species <u>entrance to Bass Lk. CMS</u>	Latitude <u>45.43134</u>	Longitude <u>089.48537</u>	Density (1-5) <u>1</u>
Search Site# <u>2</u>	Species <u>CMS</u>	Latitude <u>45.42456°</u>	Longitude <u>089.47984°</u>	Density (1-5) <u>1</u>
Search Site# <u>3</u>	Species <u>None</u>	Latitude <u>45.43279°</u>	Longitude <u>089.47404°</u>	Density (1-5) <u> </u>
Search Site# <u>4</u>	Species <u>None</u>	Latitude <u>45.43279°</u>	Longitude <u>089.47179</u>	Density (1-5) <u> </u>
Search Site# <u>5</u>	Species <u>CMS</u>	Latitude <u>45.43007°</u>	Longitude <u>089.46822</u>	Density (1-5) <u> </u>
Search Site# <u> </u>	Species <u> </u>	Latitude <u> </u>	Longitude <u> </u>	Density (1-5) <u> </u>
Meander Survey# <u> </u>	Species <u> </u>	Latitude <u> </u>	Longitude <u> </u>	Density (1-5) <u> </u>
Meander Survey# <u> </u>	Species <u> </u>	Latitude <u> </u>	Longitude <u> </u>	Density (1-5) <u> </u>
Meander Survey# <u> </u>	Species <u> </u>	Latitude <u> </u>	Longitude <u> </u>	Density (1-5) <u> </u>
Meander Survey# <u> </u>	Species <u> </u>	Latitude <u> </u>	Longitude <u> </u>	Density (1-5) <u> </u>
Meander Survey# <u> </u>	Species <u> </u>	Latitude <u> </u>	Longitude <u> </u>	Density (1-5) <u> </u>

Bra Sch. / Iso
 Nymphae / water w. ent.
 Pot. Pus. / floating burreed
 Scn / Pot. ed. drus
 Najas gracilima
 FW sponge
 pipewort
 Myr Far Myr Het Myr Ten
 Needle spike rush
 Lar. P. bladderwort

Step 2: Label each specimen collected with species, collector, date, lake name, WBIC and Location # Send your specimens to an expert for verification. Instructions on how to voucher specimens and a list of statewide taxonomy experts can be found at: <http://dnr.wi.gov/invasives/aquatic/whattodo/staff/>

Step 3: Data was entered into SWIMS on _____ by _____
Date Name

Notes:

Density Ratings

- 1 – A few plants or invertebrates
- 2 – One or a few plant beds or colonies of invertebrates
- 3 – Many small beds or scattered plants or colonies of invertebrates
- 4 – Dense plant, snail or mussel growth in a whole bay or portion of the lake
- 5 – Dense plant, snail or mussel growth covering most shallow areas

General guidance on areas to search for the 10 minute quick snorkel search sites:

- Check rocks for zebra/quagga mussels, faucet snails and New Zealand mudsnails.
- Check around small backyard boat launches.
- Check near creek inlets (especially if AIS are found upstream).
- Check the stems of emergent vegetation for climbing faucet snails.
- Check areas downwind of large boat landings.

LAKE SURVEY MAP

WISCONSIN CONSERVATION DEPARTMENT
BIOLOGY DIVISION
LAKE AND STREAM IMPROVEMENT SECTION

LAKE Lone
SECTION 15-22
TOWNSHIP 34 N
RANGE 8 E
TOWN OF HARRISON
COUNTY LINCOLN

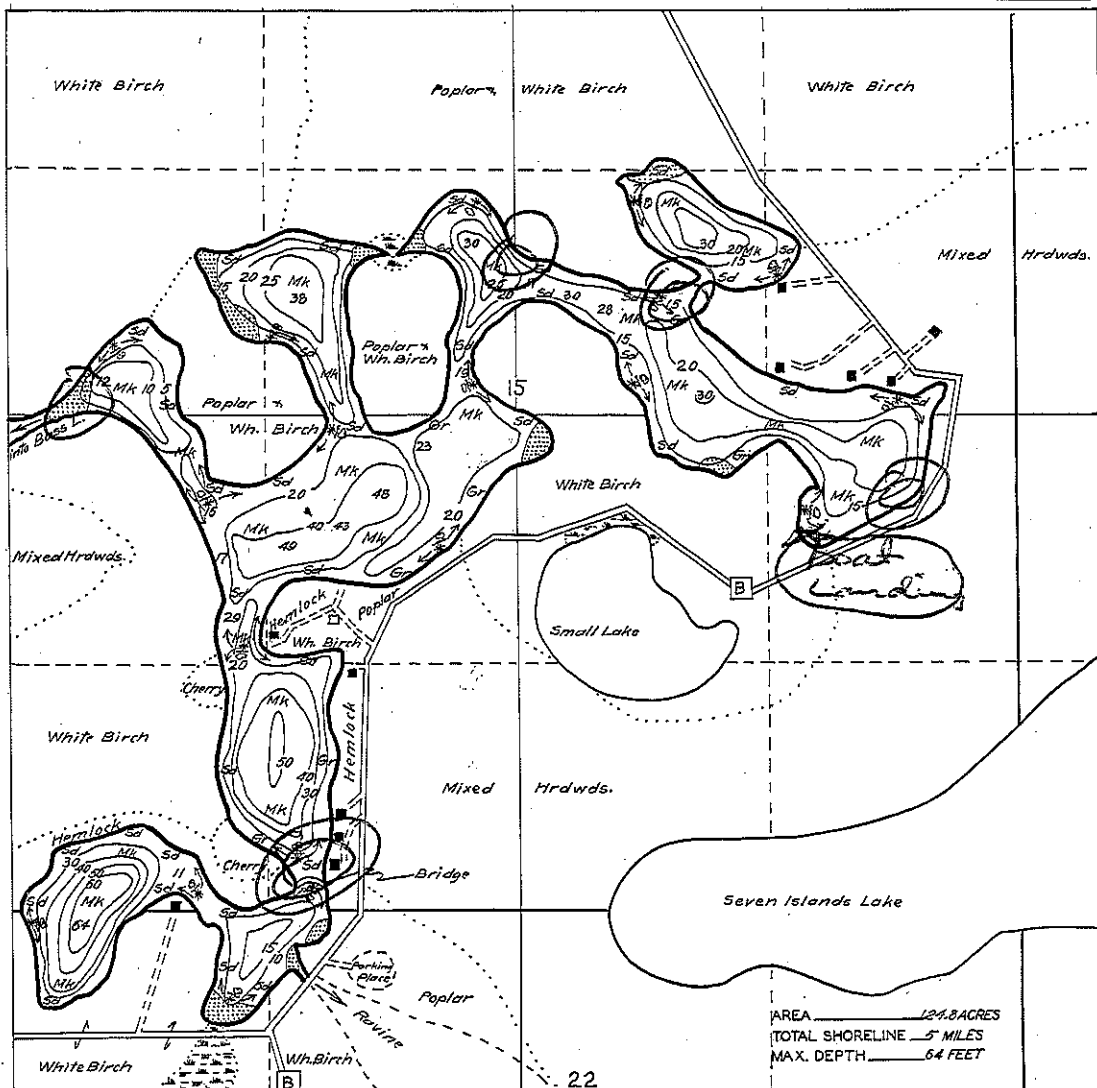

DATE June 9-1938
COMPILED BY Max. W. Albrecht
TRACED BY H. G. O.
SOURCE OF INFORMATION
W.P.A. Lake Improvement
Project
SOUNDINGS _____
DATES OF MAP REVISION _____

WORK AGENCY W.P.A.
CHECKED BY
W.P.S. # 25-41

LAKE IMPROVEMENT RECORD

TYPE	DATE	1937	1938	1939	1940	TOTAL
BRUSH REFUGES		89				89
SAPLING TANGLES		375				375
MINNOW SPAWNERS		150				150
						634

SCALE 1" INCH = 480 FEET

- LEGEND
- WEED BEDS
 - ROCKY SHOALS
 - SAND
 - CLAY
 - GRAVEL
 - MUCK
 - DWELLING
 - ABANDONED DWELLING
 - RESORT

Improvement structures from arrow to arrow

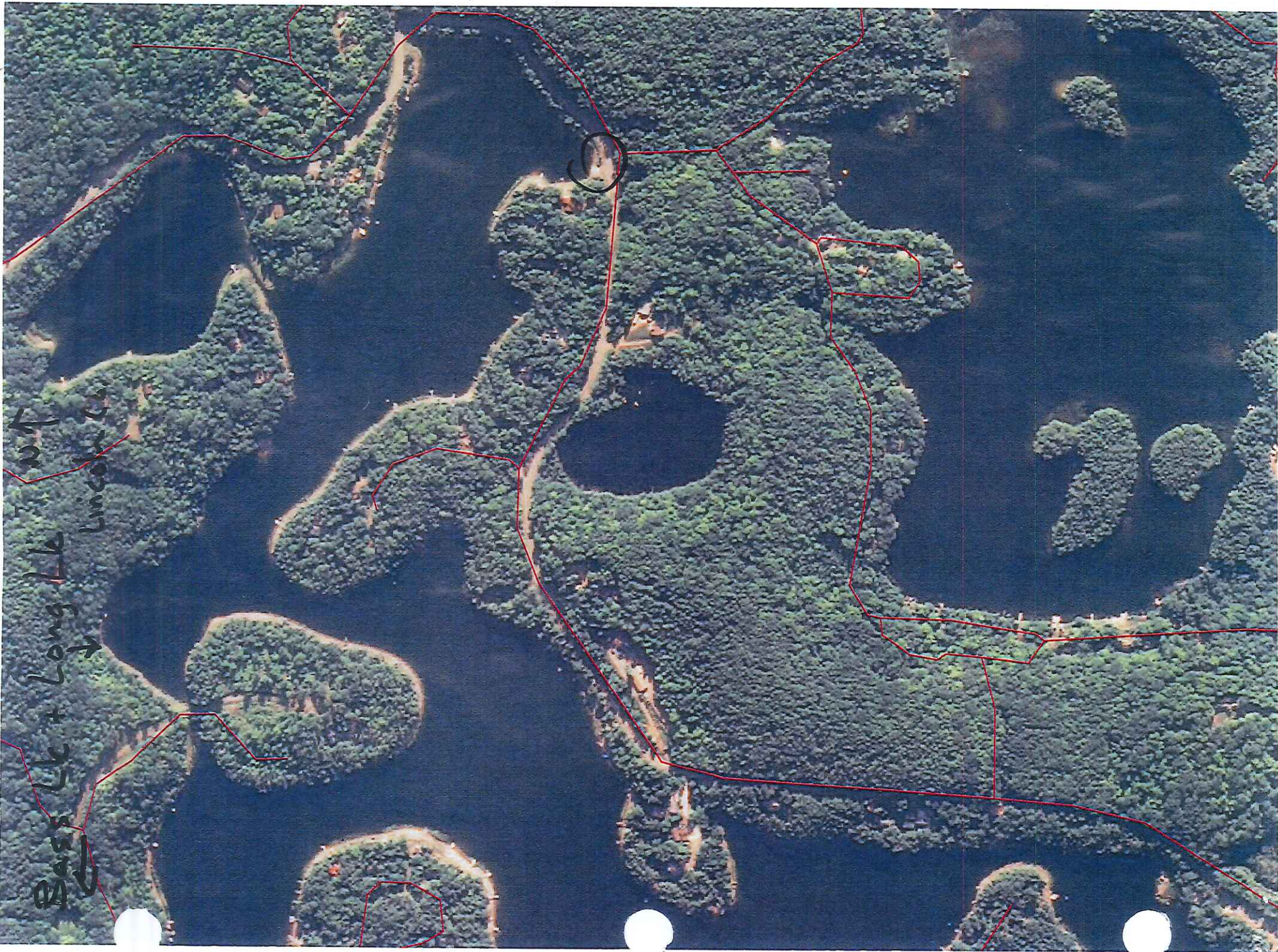

Bass Lk + Long Lk
Lincoln Co
WVT
↓

