

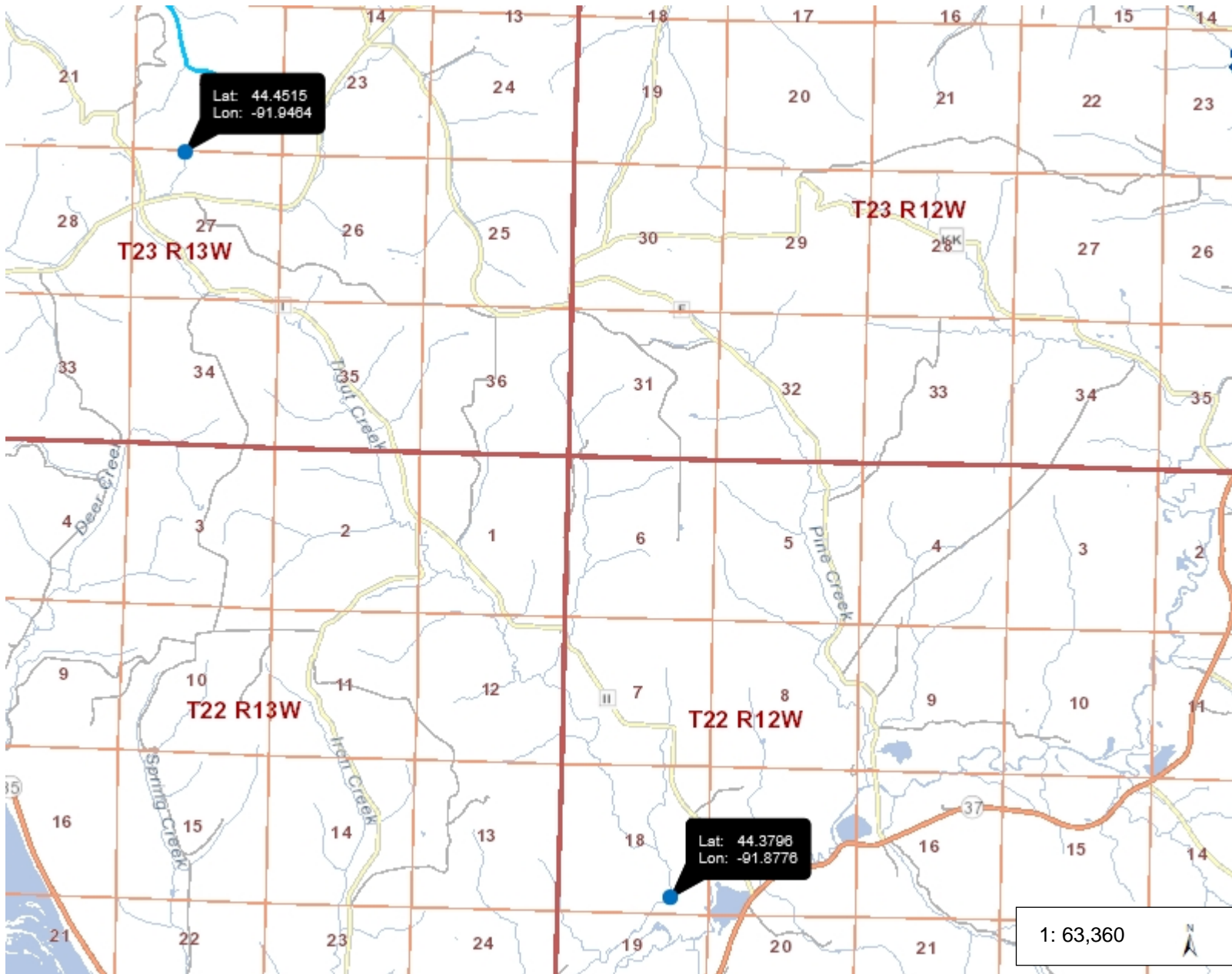

# Exhibit A. Trout Creek (WBIC 1815000), Buffalo County, Proposed Trout Classification Boundaries



### Legend

- Trout Stream Lines
  - Class 1
  - Class 2
  - Class 3
- Trout Spring Ponds
- Township
- Section
- Major Roads
  - Interstates
  - US Highways
  - State Highways
- Rivers and Streams
- Open Water
- Airports

1: 63,360



NAD\_1983\_HARN\_Wisconsin\_TM  
© Latitude Geographics Group Ltd.

DISCLAIMER: The information shown on these maps has been obtained from various sources, and are of varying age, reliability and resolution. These maps are not intended to be used for navigation, nor are these maps an authoritative source of information about legal land ownership or public access. No warranty, expressed or implied, is made regarding accuracy, applicability for a particular use, completeness, or legality of the information depicted on this map. For more information, see the DNR Legal Notices web page: <http://dnr.wi.gov/org/legal/>

### Notes

Blue Dots = Proposed Class II Boundary (8.0 miles). Stream is not currently classified trout water.