

JUN 13 1980

N. C. Dist. Hdqtrs.
RHINECLANDER, WIS.

ORDINANCE NO. 80-3
AN ORDINANCE GOVERNING WATERSKIING AND
SETTING "NO-WAKE" AREAS ON PLUM LAKE

The Board of Supervisors of the Town of Plum Lake
does hereby ordain as follows:

SECTION 1. PURPOSE

The purpose of this ordinance is to establish areas of Plum Lake in which there shall be no waterskiing, and in which boats shall be limited to "No-Wake" speed after 6:00 o'clock p.m., so as to provide safe and enjoyable aquatic recreation consistent with public rights and interests on Plum Lake.

SECTION 2. APPLICABILITY AND ENFORCEMENT

This section shall apply only to Plum Lake and shall be enforced by the town constable.

SECTION 3. STATE WATERSKIING RESTRICTIONS ADOPTED

The statutory restrictions set forth in Section 30.69(3), Wis. Stats., are hereby adopted and by reference made a part of this section.

SECTION 4. AREAS DESIGNATED

That part of Plum Lake lying west of the narrows of Aurora Creek, from point to point, shall be designated and referred to herein as Unit 1; that part of Plum Lake lying north of the narrows and from point to point between Camp Highlands and Hook's Point shall be designated and referred to herein as Unit 2; that part of Plum Lake lying east of a line extending from Hook's Point southerly to the west side of White's Island and continuing southerly along the straight line to the south shore of Plum Lake shall be designated and referred to herein as Unit 3.

SECTION 5. WATERSKIING RESTRICTED

No person shall be permitted to waterski in Units 1, 2 and 3 as designated and defined herein, between the hours of 6:00 o'clock p.m., and 8:00 o'clock a.m.

SECTION 6. SPEED LIMIT

No boat shall be operated in excess of a "Slow-No-Wake" speed in the areas known and designated herein as Units 1, 2 and 3 between the hours of 6:00 o'clock p.m., and 8:00 o'clock a.m.

SECTION 7. MARKER BUOYS

All "Slow-No-Wake" areas shall be designated by buoys which meet the standards set forth in Section N.R. 5.09 Wis. Admin. Code.

SECTION 8. SEVERABILITY

If any portion of this ordinance shall be deemed to be illegal or unconstitutional, that part so deemed shall be considered stricken from this ordinance and the balance of this ordinance shall remain as if the stricken portion had not be enacted.

SECTION 9. PENALTY

Any person violating the provisions of this ordinance, shall upon conviction, be subject to a penalty which shall be as follows:

A. First Offense-Penalty

Any person who shall violate any provision of this ordinance shall, upon conviction thereof, forfeit not less than \$10.00 nor more than \$25.00, together with the costs of prosecution and in default of payment of such forfeiture and costs of prosecution, shall be imprisoned in the County Jail until such forfeiture and costs are paid but not exceeding ninety (90) days.

B. Second Offense-Penalty

Any person found guilty of violating any provision of this ordinance who shall previously have been convicted of a violation of this ordinance within one (1) year, shall upon conviction thereof, forfeit not less than \$25.00 nor more than \$200.00 for each such offense, together with the costs of prosecution and in default of payment of such forfeiture and costs of prosecution, shall be imprisoned in the County Jail until such forfeiture and costs are paid, but not exceeding six (6) months.

SECTION 10. PUBLICATION AND POSTING

Copies of this ordinance, and copies of a map designating Units 1, 2 and 3 shall be prominently posted at all public access points to Plum Lake.

SECTION 11.

A copy of this ordinance shall be filed with the Wisconsin Department of Natural Resources; this ordinance shall take effect upon the passage and publication provided by law, and upon approval by the Wisconsin Department of Natural Resources.

Town Chairman

Supervisor

Supervisor

DATE PUBLISHED: _____

DATE POSTED: _____

DATE APPROVED
BY DEPT. OF
NATURAL RESOURCES: _____

L.I.V.E. SURVEY MAP

PLUM LAKE
 VILLAS COUNTY
 SEC. 21, 27, 28, 29, 30 T-41 - N. R. - 7, 8 - E. 34
 31, 32, 25, 26 (Sheet 1 of 2)

- EQUIPMENT RECORDING SONAR MAPPED AUGUST MONTH 1974 YEAR
- TOPOGRAPHIC SYMBOLS
- ① Brush
 - ② Partly wooded
 - ③ Wooded
 - ④ Clear
 - ⑤ Agricultural
 - ⑥ Blk. bench mark
 - ⑦ Dwelling
 - ⑧ Resort
 - ⑨ Camp
- LAND BOTTOM SYMBOLS
- ① Peat
 - ② Mud
 - ③ Clay
 - ④ M. Soil
 - ⑤ S. Sand
 - ⑥ Silt
 - ⑦ Gravel
 - ⑧ Rubble
 - ⑨ Bedrock
- LAKE BOTTOM SYMBOLS
- ① Boulder
 - ② Stumps & Snags
 - ③ Rock deeper to navigation
 - ④ Submerged vegetation
 - ⑤ Emerging vegetation
 - ⑥ Flooding vegetation
 - ⑦ Grub shelters
- STATE FOREST

- TOPOGRAPHIC SYMBOLS
- ① Hill
 - ② Interim terrace
 - ③ Spring
 - ④ Interim stream
 - ⑤ Permanent inlet
 - ⑥ Permanent outlet
 - ⑦ Dam
 - ⑧ D.M.R. State owned land

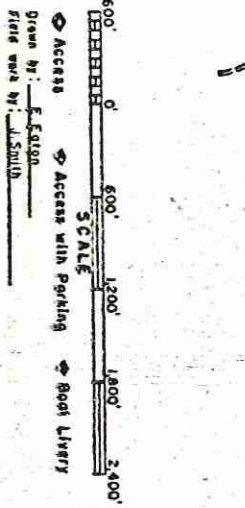

SPECIES OF FISH

Abundant	X
Common	X
Occasional	X
Rare	X
Not Present	X
Not Collected	X
Not Identified	X
Not Specimens	X
Not Collected	X
Not Identified	X
Not Specimens	X
Not Collected	X
Not Identified	X
Not Specimens	X
Not Collected	X
Not Identified	X
Not Specimens	X

WATER AREA 1102.74 ACRES

UNDER 5 FT. 10

OVER 20 FT. 48

MAX. DEPTH 57 FEET

TOTAL ALW. 50 PPI

VOLUME 22,549 ACRES FT

MAIN SHORELINE 1.79 MI

ISLAND SHORELINE .69 MI

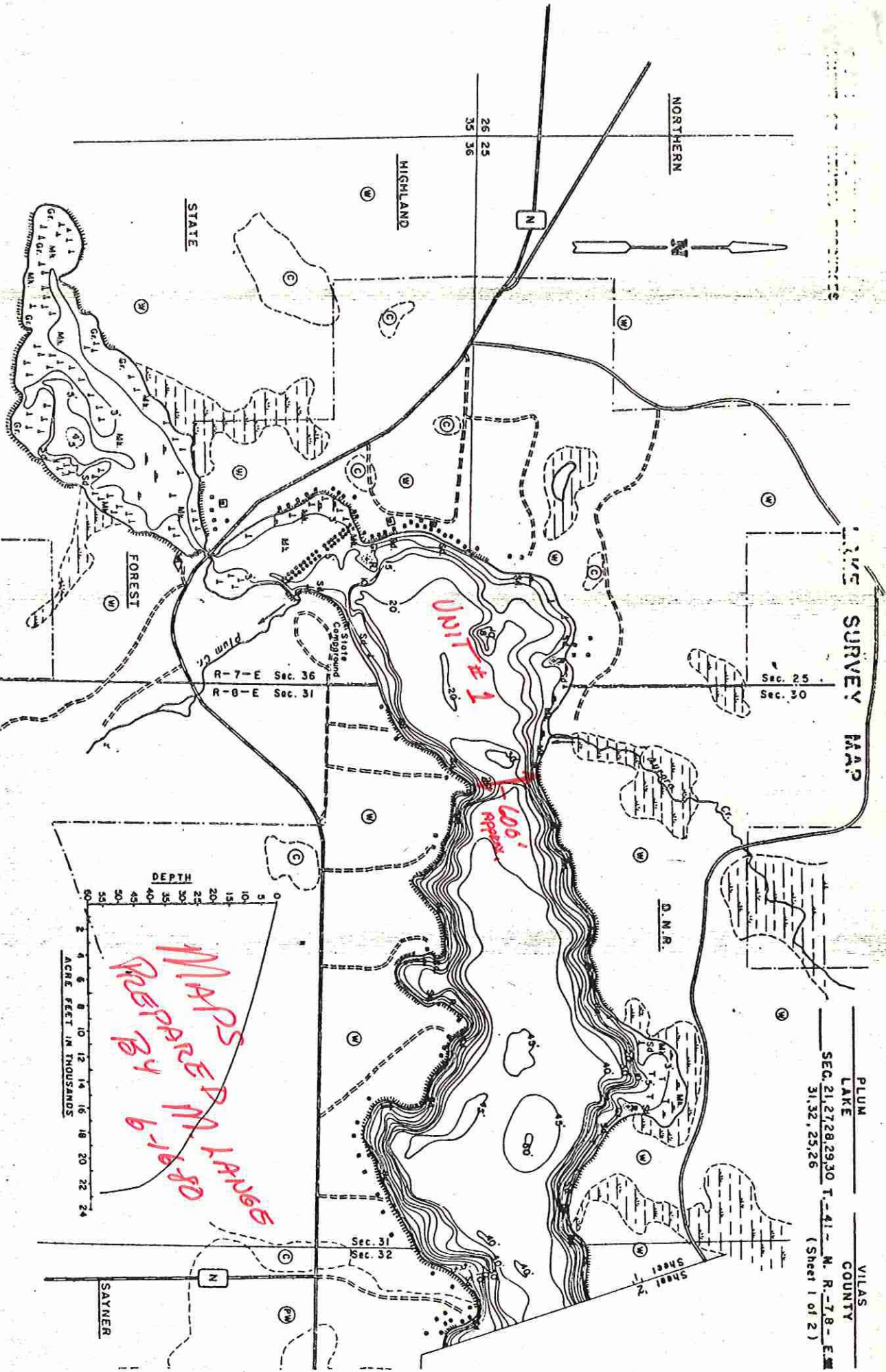

LAKE SURVEY MAP

PLUM LAKE
VILAS COUNTY
SEC. 21, 27, 28, 29, 30 T. 41 N. R. 7, 8 E. WK
31, 32, 25, 26 (Sheet 2 of 2)

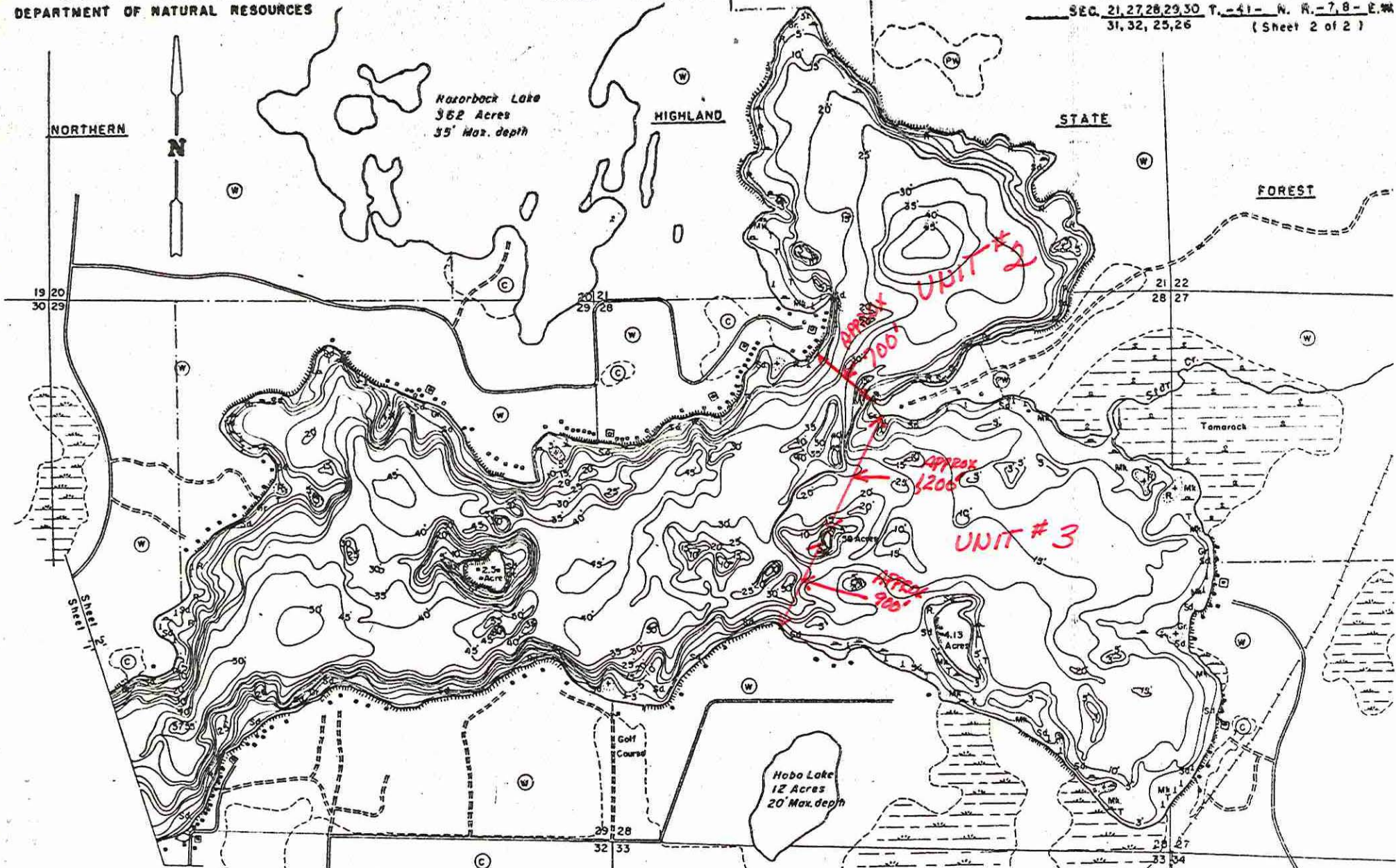

EQUIPMENT RECORDING SONAR MAPPED AUGUST 1974

- | TOPOGRAPHIC SYMBOLS | | LAKE BOTTOM SYMBOLS | |
|----------------------|-----------------------------|---------------------|-----------------------------|
| (B) Brush | Steep slope | P. Peat | B Boulders |
| (P) Partially wooded | --- Indefinite shoreline | Mk. Muck | ⊕ Stumps & Snags |
| (W) Wooded | --- Marsh | C. Clay | ⊗ Rock danger to navigation |
| (C) Cleared | --- Spring | M. Marl | Y Submergent vegetation |
| (P) Pastured | --- Intermittent stream | Sd. Sand | I Emergent vegetation |
| (A) Agricultural | --- Permanent inlet | Sl. Silt | ~ Floating vegetation |
| D.M. Bench Mark | --- Permanent outlet | Gr. Gravel | ⊕ Brush shelters |
| ■ Dwelling | --- Dam | R. Rubble | |
| □ Resort | --- D.N.R. State owned land | Bc. Bedrock | |
| ⊕ Camp | | | |

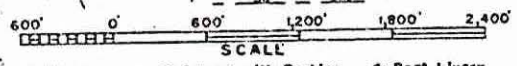

Access Access with Parking Boat Livery
 Drawn by: E. Eaton
 Field work by: J. Smith

SPECIES OF FISH	ABUNDANCE		
	Common	Occasional	Present
Walleye	X		
N. Pike	X		
Walleye	X		
L. M. Bass	X		
S. W. Bass	X		
Panfish	X		
Trout			
Cisco			X

WATER AREA 1,107.74 ACRES
 UNDER 3 FT. 10'
 OVER 20 FT. 48'
 MAX. DEPTH 57 FEET
 TOTAL ALK. 50 P.P.
 VOLUME 22,549.1 ACRES F
 MAIN SHORLINE 13.79 M
 ISLAND SHOPLINE .69 M