

January 9, 2015

David Winston
Wisconsin Department of Natural Resources
Geographic Names Council
101 S Webster Street
PO Box 7921
Madison, WI 53707-7921

Re: Geographic Name Proposal – Birch Creek, Parkland Township, Douglas County, Wisconsin

Dear Mr. Winston:

I have attached a Geographic Names Proposal on Form 2200-124 for the naming of a creek in Parkland Township, Douglas County, Wisconsin. The creek is currently unnamed and is an area of abundant birch trees and numerous birch trees line it's banks. Therefore, I am proposing that the creek be named Birch Creek.

The Birch Creek designation also follows the naming pattern of the adjacent creeks to the east and west which are designated Bear Creek and Bluff Creek, respectively. Designating this creek Birch Creek will be consistent with starting the names with the same first letter.

I have attached additional information to support the geographic name including the following:

- Minutes from the November 10, 2014 Parkland Township Board supporting the naming of the creek,
- A map with the creek highlighted,
- Printouts from the Google Earth measurement tool showing that both the north and south branches of the creek exceed 5 miles in length, and
- Two photos of the creek showing some of the Birch trees.

Please distribute this proposal to council members for consideration at the January 21 meeting. If you need any additional information, please do not hesitate to contact me.

Best Regards,



Lance R. Olson
6061 E County Road C
South Range, WI 54874
Phone: 218-340-3598
Email: lance_r_olson@hotmail.com

Notice: Personal information collected may be made available to requesters under Wisconsin's Open Records law (ss. 19.31-19.39, Wis. Stats.).

Instructions: See page 2 for naming guidelines. Send form and inquiries to the above address.

Geographic Feature Information

Description of Feature – Include size (acres), length (miles) or population, etc. Recommended Name of Feature
S.6 MILE LONG CREEK BIRCH CREEK

Other Names or Spellings in Use: By Whom: (Name and Address)
NONE

Reason for this Proposal – Identify Problem and Need (Attach supplementary sheet if necessary)
CREEK IS NOT NAMED. END: 46° 37' 22.67" N
 92° 01' 50.15" W
 HEAD: 46° 34' 53.20" N
 91° 57' 03.49" W

Origin and Significance of Recommended Name – Attach Supporting Documents (resolution, historical data, etc.)
NUMEROUS BIRCH TREES LINE THE BANKS OF CREEK.

Feature Location	DNR Use Only
County <u>DOUGLAS</u>	Lat. ____ ° ____ ' ____ " , Long. ____ ° ____ ' ____ "
Stream Heads: Sec. <u>01</u> , T <u>47</u> N, R <u>13</u> E/W	
Ends: Sec. <u>20</u> , T <u>48</u> N, R <u>13</u> E/W	
Lake, Village, etc. Secs. _____ , T _____ N, R _____ E / W	Lat. ____ ° ____ ' ____ " , Long. ____ ° ____ ' ____ "
Secs. _____ , T _____ N, R _____ E / W (or locate by landmarks and attach map)	USGS Quad. Name Index Number

Applicant Information

Name: LANCE OLSON Agency: _____ Telephone Number (include area code): 218-340-3598

Address: 6061 E COUNTY ROAD C City: SOUTH RANGE State: WI ZIP Code: 54874

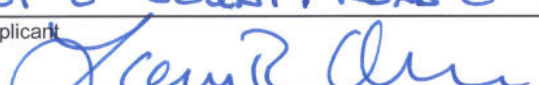
Signature of Applicant:  Date Signed: 2/25/2011

DNR Use Only – Map Search and Field Investigation

Name of Map or Other Reference	Date of Ref.	Name Given Feature
Person Contacted	Address	Occupation
Special Concerns		
Findings and Recommendation		
Signature of Investigator		Date Signed

History

The duties and functions of the State Geographic Board were transferred by Section 25(1)(A) of Chapter 75, Laws of 1967, to the Natural Resources Board. Subsequently the Natural Resources Board assigned the duties and functions to the Division of Resource Management and retained the State Chief Engineer, the State Geologist, the State Cartographer and a designee from the Department of Transportation, Division of Highways, as advisors as a Geographic Names Council.

Statutory Authority – Section 23.25, Wis. Stats.: Geographic Powers and Duties

- (1) The department shall:
 - (a) Determine the correct and most appropriate names of the lakes, streams, places and other geographic features in the state, and the spelling thereof;
 - (b) Pass upon and give names to lakes, streams, places and other geographic features in the state for which no single generally accepted name has been in use;
 - (c) In cooperation with county boards and with their approval, to change the names of lakes, streams, places and other geographic features, with the end in view of eliminating, as far as possible, duplication of names within the state;
 - (d) Prepare and publish an official state dictionary of geographic names and to publish the same, either as a completed whole or in parts when ready;
 - (e) Serve as the state representative of the U.S. geographic board and cooperate with the said board to the end that there shall be no conflicts between the state and federal designations of geographic features in the state.
- (2) Whenever the department has given a name to any lake, stream, place or other geographic feature within the state, or determined the correct spelling of any such name, it shall be used in all maps, reports and other publications thereafter issued by the state or any of its political subdivisions, and shall be deemed the official name of such geographic feature.
- (3) No person shall in any advertisement or publication attempt to modify local usage or name unnamed geographic features without first obtaining the approval of the department. In case of a violation of this subsection, the department may promptly announce its disapproval and thereafter adopt an official name for such feature.

Policy of the State of Wisconsin Geographic Names Council

It is the policy of the State of Wisconsin Geographic Names Council:

- (A) Not to name a geographic feature after any living person.
- (B) Names having a scientific derivation are not as a rule acceptable.
- (C) Names with historical significance or with Indian or French origin are usually appropriate, but care should be exercised that the Indian names are from tribes native to Wisconsin. They should not be too long nor difficult of pronunciation.
- (D) That newly acquired proper names for geographic features shall not be designated with " 's" or "s", indicating possession, following the name. For example: Mott Lake, rather than Mott's Lake or Motts Lake.
- (E) That only lakes 10 acres or more in size shall be considered by the Council for naming unless reason is evidenced for special consideration by the Council. For example: significant public use.
- (F) That only streams 5 miles or more in length shall be considered by the Council for naming unless reason is evidenced for special consideration by the Council. For example: trout stream.

The U.S. Board on geographic names has indicated the following guidelines with reference to the naming of geographic features:

- (A) That local usage be followed whenever possible.
- (B) That the specific name precede the generic name. For example: preference is given to Alice Lake rather than Lake Alice.
- (C) That whenever practicable the recommended names include single names only followed by the generic name. For example: preference is given to Meyer Lake rather than John Meyer Lake.
- (D) That hyphens be omitted in newly established names.
- (E) That descriptive words such as "Big", "Little", etc., be eliminated unless they are necessary for proper identification of the feature.

Town of Parkland
Town Board Meeting
November 10, 2014

The bill paying session was called to order at 6:30 p.m. It was off tape requiring no need for discussion, The November 10, 2014 Town Board meeting was called to order at 7:00 p.m. All recited the Pledge of Allegiance. The full Board was present.

The minutes from the October 13, 2014 Town Board meeting were reviewed. There were no questions or correction to the minutes. Dean made a motion to approve the September 8, 2014 minutes. Chad seconded the motion.

The Treasurer's report was reviewed. There were no questions or corrections to the Treasurer's report. Dean made a motion to approve the Treasurer's report. Chad seconded the motion.

The bills were in order. Chad made a motion to pay the bills. Dean seconded the motion.

The next Town Board meeting will be held December 8, 2014 at 7:00 p.m.

MAIL:

A copy of a letter that was sent to Steven Terhume, 5590 E City Limits Road, South Range, WI was received from the Douglas County Zoning Department. They are requesting Steven Terhume attendance at their hearing to be held November 19, 2014 for an after-the-fact use variance to allow Steven two access driveways on his property.

OLD BUSINESS:

There was no old business.

NEW BUSINESS:

Lorri Prendergast from the Parkland Community Club reported that Bob Granquist volunteered to help organize the new skating rink as far as the best location behind the hall and the plowing of the rink. The rink will be located behind the Town Hall near the road. Enbridge Energy has contacted Terri Nichols about grant money they would like to give the Town to help cover the cost for lights for the rink.

The Budget Hearing to approve the 2015 budget was set for November 18, 2014 at 7:00 p.m.

Lance Olson, 6061 County Road C, South Range, WI reported to the Town Board that he has a creek going through his property that is currently unnamed and he would like the approval of the Parkland Town Board to name it Birch Creek. Chad Sisko, Supervisor made a motion to ok the naming of the creek from the headlands up off of the Sorenson Road to where it connects up with Bluff Creek to the name of Birch Creek. Dean Granquist, Supervisor seconded the motion.

Marianne reported to the Board that the \$100.00 that is being charged each resident each year for the cost to maintain the recycling area was not enough and the Town is in the red by approximately \$6,000.00. A discussion about having curbside pickup was discuss but this is something that would possible have to be put on the ballot for the April 2015 election to see what the majority of the residents would want. It was suggested to increase the assessment by \$20.00 for 2015. Chad made a motion to increase the 2015 garbage assessment by \$20.00 to a total of \$120.00. Dean seconded the motion.

Lorri Prendergast representing the Parkland Fire Department reported to the Board that Keith Kessler has found one last round of radio grants. With this grant the Fire Chief is proposing to apply for \$26,545.00 worth of radios that they could get for \$9,143.88 and the Fire Department will pay for these radios out of money they had previously allocated for the DNR grant. This grant will give them three times the radios than they would have received from the DNR grant which is a savings of \$17,401.00. Dean made a motion to approve the HS Mutual Aid Radio purchase reprogramming/trucking upgrade for the Parkland Fire Department for the total cost for upgrades and new radios being \$26,545.00 of which \$9,143.88 the Town's fire Department will pay. Chad seconded the motion.

Justin reported that the owner of the two trailer parks located in the Town of Parkland has not paid the Town the tax money he collected from each trailer since 2012. It was also reported that this is a business and he should have been paying a license fee every year to operate the parks. Associated Appraisal has suggested that the Town contact a Town's Association Attorney to see what the Town can or should do to take care of this matter. Justin will contact the Town's Attorney.

Chad reported that the old boiler that heats the Town Hall during extreme cold weather has a leak. Stack Brothers have looked at the boiler and reported if it's just a section that needs repair it could cost anywhere from six to ten thousand dollars verses fifteen to Twenty thousand for a new system. He is also going to contact another furnace repair company to look at the boiler to get a second opinion on fixing the old boiler verses replacing it with a new one. Chad also reported the rented brush mower arrived today and due to the weather the employees needed to get the trucks and plows ready for the snowstorm so he was asked to start brushing but after only four hours of brushing the pump went. Ziegler will have to either fix it in the Town garage or return it to their facility for repairs.

With there being no further business Dean made a motion to adjourn the November 10 2014 Town Board Meeting. Chad seconded the motion.

Sincerely submitted,

Marianne Granquist
Clerk for the Town of Parkland

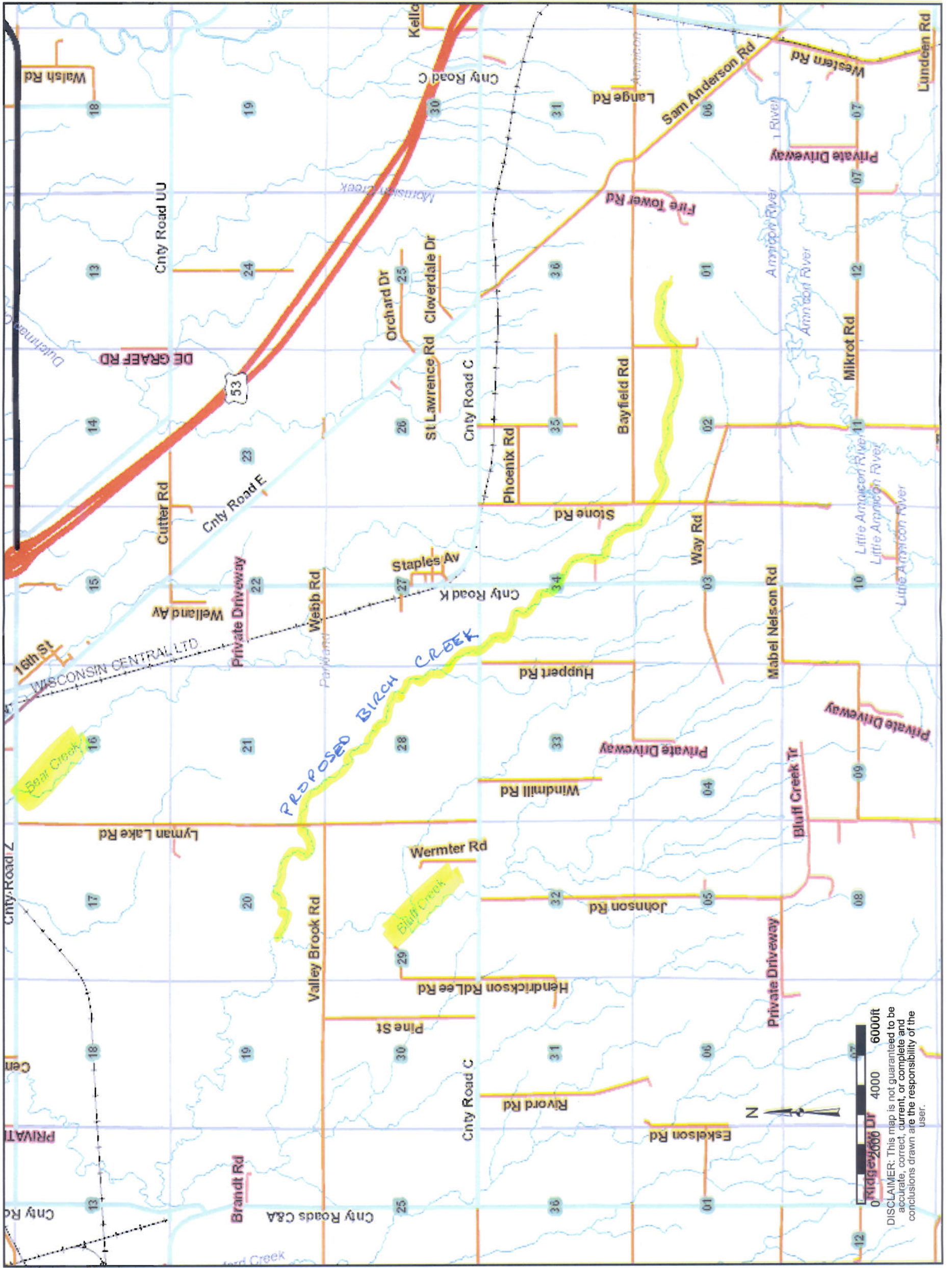

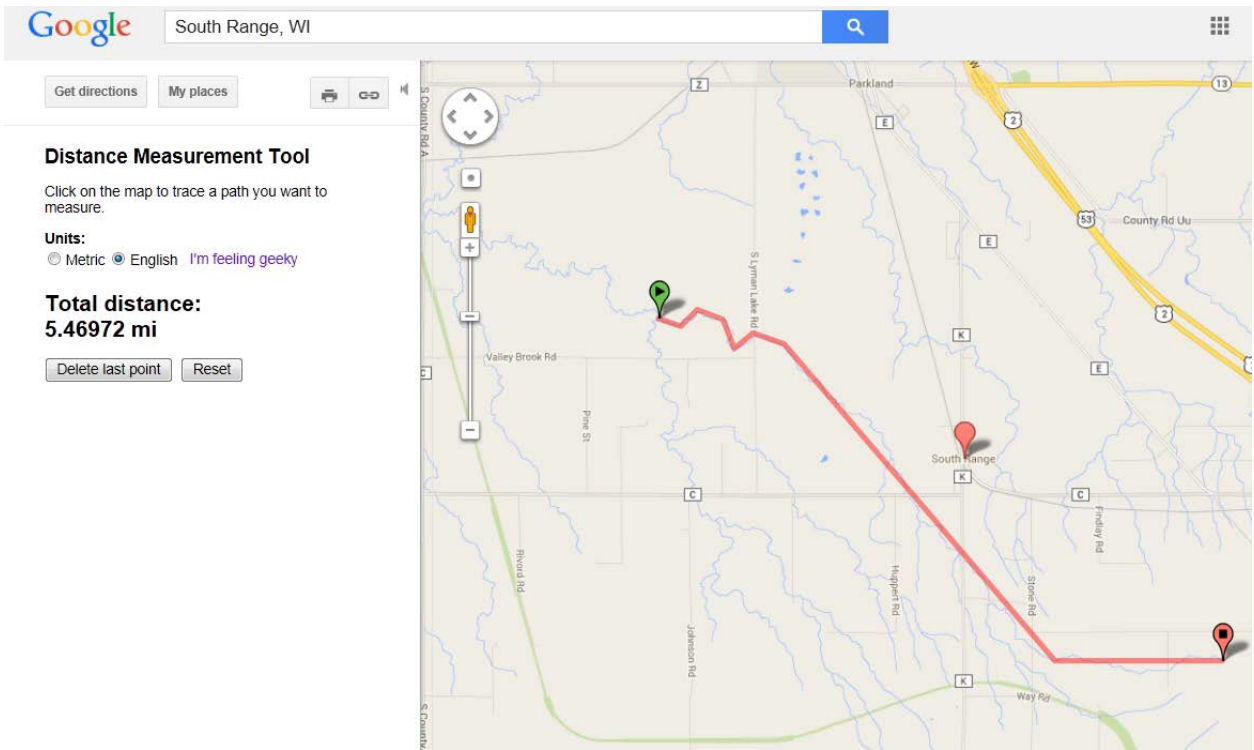

Proposed Birch Creek – North Tributary

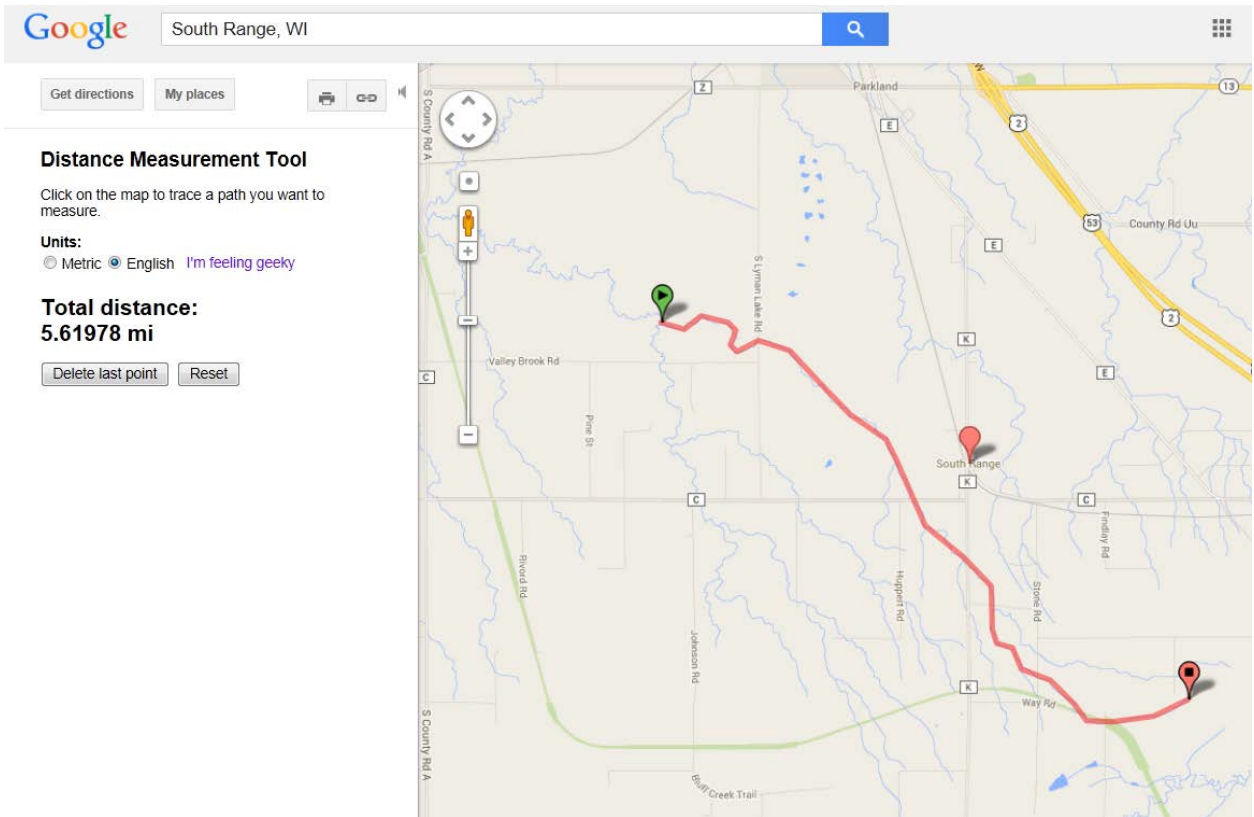

Proposed Birch Creek – South Branch



Birch Creek Shoreline – Photo 1



Birch Creek Shoreline – Photo 2