

Mercer Springs

FEB 16 2015

Geographic Name Proposal

Notice: Personal information collected may be made available to requesters under Wisconsin's Open Records law (ss. 19.31-19.39, Wis. Stats.).

Instructions: See page 2 for naming guidelines. Send form and inquiries to the above address.

Geographic Feature Information

Description of Feature – Include size (acres), length (miles) or population, etc. Recommended Name of Feature
1.41-acre spring pond *Mercer Spring(s)*

Other Names or Spellings in Use: By Whom: (Name and Address)
Mercer Lake Springs *1961 memo in DNR Lake File (Rhinelander)*
WBIC 1539300 *DNR waterbody identification code*
unnamed Lake 11-7 *Surface Water Resources of Oneida Co (1966)*

Reason for this Proposal – Identify Problem and Need (Attach supplementary sheet if necessary) *Significant Public Use*
DNR has stocked brook trout in this spring pond from 1950 to present, and unofficially referred to it as Mercer Springs.
Alternate name "Mercer Lake Springs" is confusing - contains "Lake" and "Spring".

Origin and Significance of Recommended Name – Attach Supporting Documents (resolution, historical data, etc.)
Named "Mercer Lake Springs" or "Mercer Springs" because it drains to Mercer Lake, Oneida Co.

Feature Location	DNR Use Only
County <i>Oneida</i>	Lat. ____ ° ____ ' ____", Long. ____ ° ____ ' ____"
Stream Heads: Sec. _____, T _____ N, R _____ E / W Ends: Sec. _____, T _____ N, R _____ E / W	Lat. ____ ° ____ ' ____", Long. ____ ° ____ ' ____"
Lake, Village, etc. Secs. <i>11</i> , T <i>39</i> N, R <i>05</i> <input checked="" type="radio"/> W Secs. _____, T _____ N, R _____ E / W (or locate by landmarks and attach map)	Lat. ____ ° ____ ' ____", Long. ____ ° ____ ' ____"
	USGS Quad. Name _____ Index Number _____

Applicant Information

Name <i>John Kubisiak</i>	Agency <i>DNR</i>	Telephone Number (include area code) <i>715-362-2158 8919</i>
Address <i>107 Sutliff Ave</i>	City <i>Rhinelander</i>	State <i>WI</i>
ZIP Code <i>54501</i>		
Signature of Applicant <i>John Kubisiak</i>		Date Signed <i>10-Feb-2015</i>

DNR Use Only – Map Search and Field Investigation		
Name of Map or Other Reference	Date of Ref.	Name Given Feature
Person Contacted	Address	Occupation
Special Concerns		
Findings and Recommendation		
Signature of Investigator		Date Signed



HABITAT MANAGEMENT PROJECT
MERCER SPRING
WISCONSIN DEPT. OF NATURAL RESOURCES



SURFACE WATER RESOURCES
OF
ONEIDA COUNTY

By

Lloyd M. Andrews

and

C. W. Threinen

Lake and Stream Classification Project

Project Assistants:
Joseph Michalek, Jr.
Jon A. Smith

Drafting by Robert F. Scheele

Edited by Edw. Schneberger

Wisconsin Conservation Department
Madison, Wisconsin
1966

Lake No.	S	T-N	R-E	Surface Acres	Maximum Depth (ft.)	Miles of Shoreline	Miles of Public Shoreline	S.D.F.	Percent Muck Littoral Zone	Water* Source	M.P.A. (ppm)	Conductance 77° F.	pH	Water Color **	Watershed Area (sq. mi.)	Adjoining Wetlands (acres)
13-11	13	39	4	1.1	19	.19	-		100	S	27	58	6.0	DB	.2	28
14-2	14	39	4	33.0	16	1.35	-	1.68	95	Spr.	32	34	7.2	LB	.2	65
22-16	22	39	4	17.3	21	.88	-	1.51	75	S	1	9	6.0	C	.8	45
24-15	24	39	4	5.2	18	.41	-		100	S	4	12	5.2	C	.1	35
25-4	25	39	4	.3	19	.08	-		100	S	6	23	5.0	DB	.2	22
25-6	25	39	4	.1	10	.07	-		100	S	3	16	5.0	MB	.1	15
25-13 b	25	39	4	3.3	9	.39	-		100	S	4	25	6.2	LB	.3	24
25-13 d	25	39	4	6.4	8	.5	-		100	Spr.	76	169	6.5	MB	.3	55
25-15	25	39	4	7.0	5	.44	-		100	Spr.	40	87	6.9	LB	1.0	160
6-4	6	39	5	1.4	9	.25	-		100	S	3	13	6.0	C	.4	12
9-7	9	39	5	1.7	31	.21	-		100	S	6	12	6.0	MB	.1	3
11-7	11	39	5	1.1	31	.16	-		100	S	7	14	5.8	LB	.3	2
11-15	11	39	5	.5	1	.11	.11		100	Spr.	37	93	6.8	LB	.3	12
12-4	12	39	5	2.3	14	.2	-		100	S	6	10	6.6	LB	.2	3
12-10	12	39	5	.4	7	.13	-		100	S	5	28	5.1	DB	.1	25
12-15	12	39	5	23.0	6	.93	-	1.38	100	D	43	106	6.6	LB	5.9	185

* Seepage - S Spring - Spr.
 Drained - Dr. Drainage - D
 ** Clear - C Dark Brown - DB
 Light Brown - LB Turbid - T
 Medium Brown - MB



Register of Waterbodies System

[Home](#) [Help](#) [File Manager](#)

Welcome to ROW

[Home](#) -> [View Waterbody](#)

General Information

ID 99195
 WBIC 1539300
 Type of WBIC CULTURAL
 Waterbody Official Name Un Spring
 Waterbody Official Size 1.41 ACRES
 River System WBIC 0
 Waterbody Type LAKE OR POND
 First Dwnstrm WBIC 1538900
 First Dwnstrm Name MERCER L
 LandLocked? N
 WBIC# Status CURRENT

Location (at Mouth)

Township 39
 Range 5
 Dir E
 Section 11
 Q Section SE
 QQ Section SW
 Latitude 45.877285
 Longitud -89.82598
 WTM Easting 533478.8
 WTM Northing 600496.0

Location (at Headwater)

Latitude 0.0
 Longitude 0.0
 WTM Easting 0.0
 WTM Northing 0.0

Location (at Centroid)

Latitude 0.0
 Longitude 0.0
 WTM Easting 0.0
 WTM Northing 0.0
 Hydro Feature? Y
 Out Of State? N
 NR107 Private? N
 Added to Hydro Date 08/01/2000
 Added to Hydro Version 1.0
 Stream Order 0
 Comments

Counties

Code	Name	Mouth within County
44	Oneida	Y

Regions

Code	Name
7	Northern Region

Watersheds

Code	Name
UW38	Upper Tomahawk River

Geographic Management Units

Code	Name
HW	HEADWATERS

Water Management Units

Code	Name
UW	Upper Wisconsin

Hydrologic Unit Codes

HUC Level4 Code
 07070001

[Show Map](#)

[Back to Search](#) | [Waterbody Location](#) | [Waterbody Details](#) | [Download](#) | [Assessment Units](#)

Wisconsin Conservation Department

INTRA-DEPARTMENT

MEMORANDUM

Madison

Station

Date September 8, 1961

TO: Arthur Oehmcke - Woodruff

FROM: Edw. Schneberger

SUBJECT: Mercer Lake Springs Defilement

Mr. Len Baer was in this office recently. He complained about a dump located right on the banks of the Mercer Lake Springs. He felt that this dump was contributing to the filling of the springs and pollution.

Since this is known as good trout water, would you please make the necessary inspection and take the necessary action to seek its correction. Please inform Mr. Baer of your findings and the results of the investigation when completed.

Edw. Schneberger
Edw. Schneberger

NOTED:

Oehmcke 9-14-61
Date

*Mercer Lake Springs
Oneida Co.*

Northeast Area Headquarters
Woodruff, Wisconsin
October 24, 1961

Mr. Len Baer
Tomahawk Paper Timber Office
Minocqua, Wisconsin

Dear Mr. Baer:

Sometime back, Mr. Schneberger requested we look into the town dump located on Mercer Lake Springs to determine the possibility of pollution and the subsequent filling of the spring area. I checked the Mercer Lake Springs and the town dump located nearby recently in an effort to determine whether or not pollution is taking place in those springs.

The dump is located on Land Commission land and is a town-operated disposal area. Around the west and the south sides of the dump the bottom soils have been plowed to prevent seepage as well as fire, which sometimes originates in a dump such as this, from spreading to the spring side timber. Material has been dumped at least 75 yards from the spring and there does not seem to be any runoff or seepage to amount to anything that may have a tendency to pollute the water at this time. The water is very clear and no material or debris was noted in the springs which might have been thrown or been blown from the dump area.

At present it is evident that the filling that is taking place is moving slowly away from the spring area instead of toward it. Therefore, I doubt whether there will be additional damage or increased pollution from future use of the disposal area if they continue to use it.

Yours very truly,
FISH MANAGEMENT DIVISION

L. E. Morehouse
District Fish Manager

LEM:fs

A. G. Gohmiche

Wisconsin Conservation Department

INTRA-DEPARTMENT

MEMORANDUM

Woodruff

Station

Date April 21, 1967

TO: Ralph Jones

FROM: Terry McKnight

SUBJECT: Mercer Springs, Oneida County (T. 39 N., R. 5 E., Sec. 11).

On April 11, 19 and 21, 1967, Mercer Springs in T. 39 N., R. 5 E., Sec. 11, was examined to obtain information for the proposed spring pond dredging project.

Mercer Springs is a complex of several spring ponds which cover an estimated area of about 1.8 acres. The largest pond (the northwest pond of the system) is about an acre in size. This pond and its direct outlet system have light brown water, while most of the remaining areas have dark brown, bog-stained waters. The largest pond has a maximum depth of 9 feet; the pond south of the largest pond has over 11 feet of water. On April 11, the large pond was free of ice, but several of the other ponds had thin layers of ice on their surfaces. This ice probably reflected less ground water (spring) action. All of the ponds were free of ice on April 19. The entire complex is surrounded by lowland with black spruce, sphagnum moss and some balsam fir.

Aquatic vegetation noted in the ponds included Canada waterweed (Elodea), yellow waterlilies and filamentous algae. The Elodea was abundant in shallow edge areas, and the waterlilies were developing in a few of the shallow areas.

On April 11, many empty insect cases were floating on the surface of the water. It appeared that a hatch of midge flies had just taken place. Back-swimmers (Notonectidae) were abundant in the beds of Elodea.

The "outlet" of the pond south of the largest pond was examined on April 11. The flow was estimated at 0.8 c.f.s. Much of this flow appeared to be runoff and snow melt (grasses and small bushes were growing in the "channel" and there was a lack of scouring).

On April 19, four minnow traps were baited with bread and set in the main pond. These nets were removed on April 21. The total catch of the nets was one sculpin, one brook stickleback, two mudminnows and one giant waterbug.

Reliable sources indicate that brook trout are present in the largest pond. Fish were seen surfacing on April 11 and 21 but could not positively be identified.

Bottom types are approximately 99% silt and 1% gravel. A few small clean gravel areas were noted in the main pond. Bottoms are too soft for stream shocking gear and accessibility is poor for the boom shocker.

Some fishing pressure is evident from the path and empty beer cans around the edge of the largest pond.

An old, partially-covered dump is near the north shore of the pond. Some clean-up of the area would improve aesthetics.

Water chemistry information from a sample taken on April 11 follows:

M.P.A.	37 p.p.m.
Cl	1.5 p.p.m.
C ₇₇	99
pH	6.8

The water temperature in the main pond was 47°F. on April 21 (air 58°F.).

On April 11 the entire outlet of the spring pond complex was examined. The outlet ends in Mercer Lake, about one-half mile downstream from its origin. The average width of the stream was about eight feet; the average depth was about 0.4 feet. Bottoms were 100% muck and silt until about 1/8 mile from the lake, where some limited sand and gravel areas are present. The flow was estimated at approximately 2 to 3 c.f.s. This stream is not navigable for boats or canoes, but can be navigated by fish for its entire length. The only fish seen in the stream were two darters and two minnows (probably dace). The possibility of undesirable fishes (such as suckers or northern pike) coming to Mercer Springs via the outlet stream exists. There are several areas along the stream where a fish barrier could be constructed. It is felt, however, that the barrier should not be constructed unless it is found that significant numbers of undesirable fish use the stream to move into the spring pond. If this happens, reclamation and installation of the barrier would seem desirable.

It is hoped that silt removal from the main pond (by dredging) will improve the habitat for trout. Some small gravel areas are already present and possibly are being kept clean by the discharge of ground water. If the areas of ground water seeping through gravel are enlarged, possibly they may serve as trout spawning areas.

Other wildlife uses noted were two black ducks and some old beaver cuttings. No fresh beaver activity was seen.

Information that would be desirable to obtain is: Midsummer temperatures and oxygen levels, year-around flow information on the outlet, and better sampling of the fish populations. If this information were to be obtained, however, the dredging project would be delayed by a year.

Terrence McKnight

TM:fs
cc: A. A. Oehmcke

NOTED:

Date

State of Wisconsin
DEPARTMENT OF NATURAL RESOURCES
Geographic Names Council
101 S. Webster Street
PO Box 7921
Madison WI 53707-7921



Rec From CLERK

Wisconsin Geographic Names Council

GEOGRAPHIC NAME PROPOSAL RECOMMENDATION

Proposed Geographic Name MERCER SPRINGS

This is to notify the Wisconsin Geographic Names Council that:

ONEIDA COUNTY LAND RECORDS COMMITTEE
(Name of government entity, organization, or individual) PER minutes
11/3/15

Recommends that the Wisconsin Geographic Names Council:

- Approve the Proposed Name**
 Reject the Proposed Name
 Render a Decision Without Our Recommendation

Comments (the following factors contributed to this recommendation; attach supporting documentation if appropriate):

MICHAEL Rompolt
(Name)

LAND INFORMATION DIRECTOR
(Title)

PO Box 400
(Address)

715-369-6179
(Telephone)

Rhineland, WI 54501
(City, State, ZIP Code)

lio@co.oneida.wi.us
(E-mail)

Michael Rompolt
(Signature)

11/9/15
(Date)

Return to: State of Wisconsin
DEPARTMENT OF NATURAL RESOURCES
Geographic Names Council
101 S. Webster Street
PO Box 7921
Madison WI 53707-7921
Telephone: (608) 266-3476
Fax: (608) 267-4549
E-mail: david.winston@wisconsin.gov

"The Island City"

TOWN OF MINOCQUA

MARK P. HARTZHEIM, Chairman
BRYAN P. JENNINGS, Supervisor
JOHN L. THOMPSON, Supervisor
SUSAN M. HEIL, Supervisor
WILLIAM J. FRIED, Supervisor

415 Menominee Street, Suite A
Minocqua, Wisconsin 54548
Phone: 715.356.5296
Fax: 715.356.1132
www.townofminocqua.org

ROBEN A. HAGGART, Clerk
LAURA R. MENDEZ, Treasurer
MARK A. PERTILE, Dir. of Public Works
DAVID J. JAEGER, Chief of Police
ANDREW J. PETROWSKI, Fire Chief

November 5, 2015

Department of Natural Resources
Geographic Names Council
Attn: David Winston
P.O. Box 7921
Madison, WI 53707-7921

Subject: Recommended naming of "Mercer Springs"

Dear Dave:

Enclosed is the recommendation from the Town of Minocqua to approve the proposed name for WBIC 1539300, "Mercer Springs".

Both the name "Mercer Lake Springs" and "Mercer Springs" are commonly in use locally; however, the WisDNR sign that has been on the property for many years reads "Mercer Springs". Many snowmobilers and walk-in anglers/hikers have viewed this sign over the years and adopting the name "Mercer Springs" will eliminate the need for the sign to be replaced.

I spoke with a long-time officer of the Minocqua Forest Riders Snowmobile Club, and he said the club would support naming the feature to match the existing sign on the property.

WisDNR will need to make some adjustments to its Fishery Area maps, since the current map title is "Mercer Lake Springs". This is probably why the County plat map currently lists the property as Mercer Lake Springs (see enclosure).

Also, the current WisDNR map needs to be revised to show the correct road name that the access to Mercer Springs comes off of, "Rolling Bear Trail" (see enclosure).

We would also request WisDNR to maintain the area around the property signage so the view of the sign is not obstructed by the growth of vegetation (see enclosure).

Please feel free to contact me with any questions or concerns. Thank you.

Sincerely,

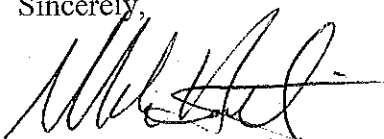

Mark Hartzheim, Chairman
Town of Minocqua

State of Wisconsin
DEPARTMENT OF NATURAL RESOURCES
Geographic Names Council
101 S. Webster Street
PO Box 7921
Madison WI 53707-7921



Wisconsin Geographic Names Council

GEOGRAPHIC NAME PROPOSAL RECOMMENDATION

Proposed Geographic Name Mercer Springs

This is to notify the Wisconsin Geographic Names Council that:

Town of Minocqua
(Name of government entity, organization, or individual)

Recommends that the Wisconsin Geographic Names Council:

Approve the Proposed Name

Reject the Proposed Name

Render a Decision Without Our Recommendation

Comments (the following factors contributed to this recommendation; attach supporting documentation if appropriate):

Mark Hartzheim
(Name)

Town Chairman
(Title)

415 Menominee St.
(Address)

715 356 5296
(Telephone)

Minocqua, WI 54548
(City, State, ZIP Code)

Chairman@townofminocqua.org
(E-mail)

[Signature]
(Signature)

11/5/15
(Date)

Return to: State of Wisconsin
DEPARTMENT OF NATURAL RESOURCES
Geographic Names Council
101 S. Webster Street
PO Box 7921
Madison WI 53707-7921
Telephone: (608) 266-3476
Fax: (608) 267-4549
E-mail: david.winston@wisconsin.gov

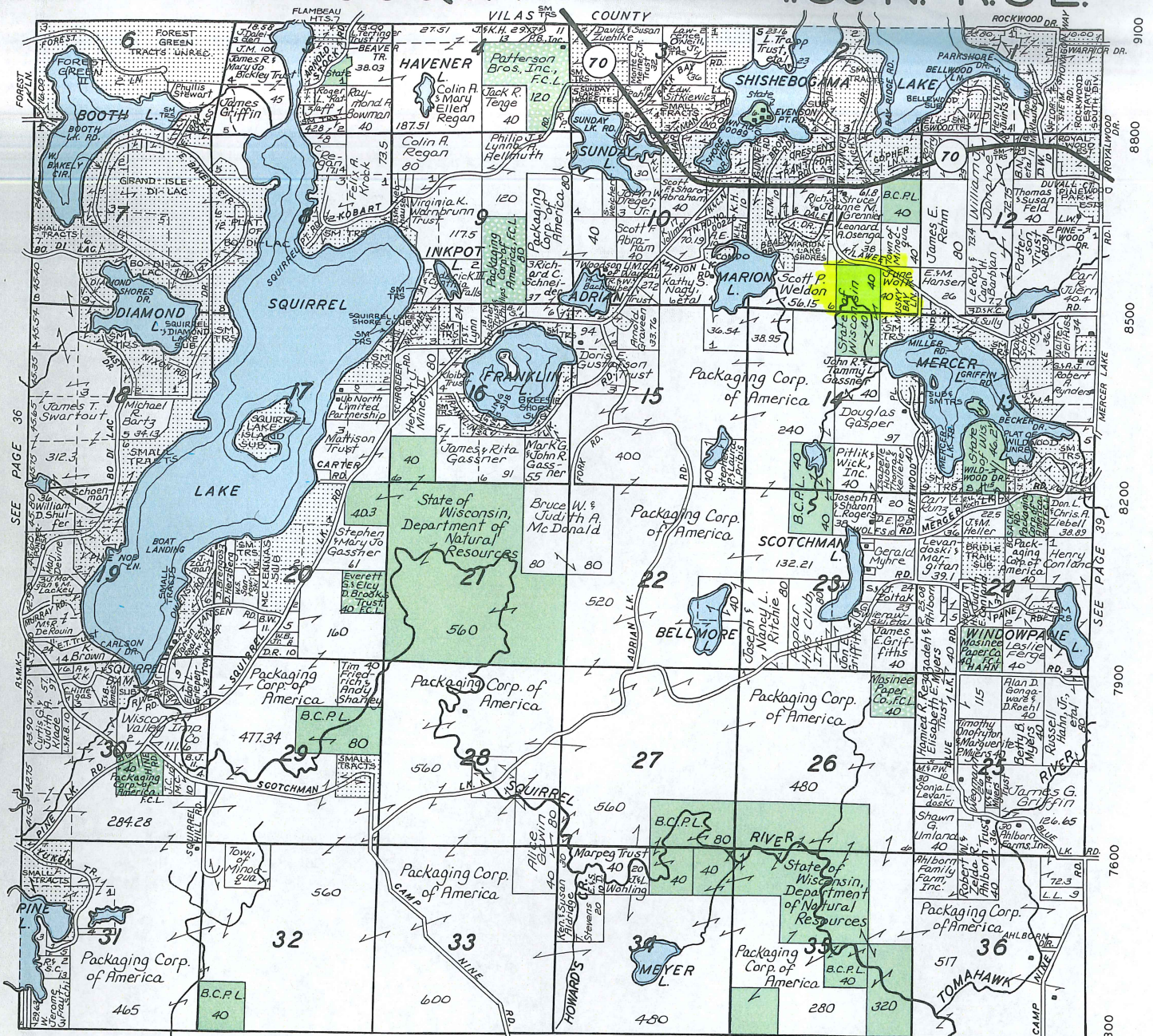

© 2000 Rockford Map Pubs., Inc. SEE PAGE 29
 12700 12400 12100 11800 11500 11200 Oneida County, Wis. 10900

River Valley State Bank

"the bank for all people"



MEMBER FDIC

At River Valley State Bank we realize the importance of credit in our community. We offer loans to accommodate your every need. From personal, business to real estate, our experienced Loan Officers are ready to work with you. We understand that everyone's needs are different. We are "The Bank for all People"

Stop by and see us . . .
 P.O. Box 1135 - 8590 Highway 51 North
 Minocqua, Wisconsin 54548
 (715) 358-3434 Fax: (715) 358-3435



WGNC Proposal: Mercer Springs



Legend

- Dams with FERC License
- Dams
- PLSS Township / Range
- PLSS Sections
- PLSS Quarter-Quarter
- Rivers and Streams

1: 16,000

0.5 0 0.25 0.5 Miles

NAD_1983_HARN_Wisconsin_TM
© Latitude Geographics Group Ltd.

DISCLAIMER: The information shown on these maps has been obtained from various sources, and are of varying age, reliability and resolution. These maps are not intended to be used for navigation, nor are these maps an authoritative source of information about legal land ownership or public access. No warranty, expressed or implied, is made regarding accuracy, applicability for a particular use, completeness, or legality of the information depicted on this map. For more information, see the DNR Legal Notices web page: <http://dnr.wi.gov/org/legal/>

Notes

#120
Unnamed Spring (1539300)
John Kubisiak; DNR Fisheries