

ORIGINAL



North American Hydro Holdings, Inc.

116 State Street, P.O. Box 167, Neshkoro, WI 54960 USA

Tel 920-293-4628 Fax 920-293-8087 Email nah@nahydro.com Web www.nahydro.com

December 15, 2011

The Secretary  
Federal Energy Regulatory Commission  
888 First Street, NE  
Washington, DC 20426

FILED  
SECRETARY OF THE  
COMMISSION  
2011 DEC 19 P 2:29  
FEDERAL ENERGY  
REGULATORY COMMISSION

**Re: Flambeau Lower Project, No. 2421, Flambeau Hydro LLC  
Article 410, Purple Loosestrife Inventory**

Dear Secretary:

On behalf of Flambeau Hydro, LLC, and in accordance with the Purple Loosestrife Monitoring Plan per license article named above, North American Hydro Holdings, Inc. submits the annual Purple Loosestrife Inventory for 2011 for the above named project. Copies of the inventory have been sent to the Wisconsin Department of Natural Resources and the US Fish & Wildlife Service.

If you have any questions regarding this submission, please contact Mr. Jereme Klassy at 920-293-4628 (ext. 22).

Sincerely,

**NORTH AMERICAN HYDRO HOLDINGS, INC.**

for Charles Alsberg  
Chief Executive Officer

CC: FERC – CRO

**Flambeau Lower Project Purple Loosestrife Inventory**  
**August 3, 2011**  
**FERC Project #2421 Article 410**

**Flambeau Hydro, LLC**  
**116 State St.**  
**Neshkoro, WI 54960**

*Purple Loosestrife*

On August 3, 2011, Flambeau Hydro, LLC (FHLLC) performed an inventory of purple loosestrife plants at the Flambeau Lower Project in Price County, Wisconsin. The method of inventory as approved and modified by Federal Energy Regulatory Commission (FERC) Order of June 18, 2003 was defined as follows:

While Purple Loosestrife is blooming in mid July to early August, the inventory should be conducted using a boat to survey the impoundment above the dam within the Project Boundary and on foot or by boat below the dam within the Project Boundary. County wetland maps may be used to determine other areas where Purple Loosestrife could be found on lands owned by FHLLC within the Project Boundary. Lands owned by FHLLC within the Project Boundary will be surveyed on foot. A pair of binoculars should be used to search for the purple flowered spikes of the plant. When plants are located, the person(s) inventorying should get close enough to make a positive identification without disturbing the plants or the immediate area around the plants as this could cause them to spread. A GPS receiver will be used to establish a GPS coordinate for the location of the plants. If it is not possible to get close enough to establish an accurate location, an approximate location will be established with reference to an established GPS coordinate. The plants should be inventoried by marking and numbering the location on a Project map along with notes approximating size of plants, stand area, percent cover, stem density, plant density, and location with reference to established GPS coordinates. Photos and/or videotape will be taken of the largest occurrences.

Example:

#1) 6' tall plants; 4' X 20'; 30% cover; 4 – 5 stems per plant; 4 plants; on shoreline N45° 56.183' W90° 26.748'; no photo

#2) 5' - 7' tall plants; 10' X 10'; 25% cover; 4 – 5 stems per plant; 10 plants; in marsh ~50 feet bearing 25° from N45° 56.256' W90° 26.710'; photo No. 1

The area to be inventoried shall be the shoreline of the impoundment to elevation 1468 feet NGVD and lands owned by FHLLC within the Project Boundary as indicated on the Project Map 1, dated November 1991, included in Exhibit G of Flambeau Paper Corp. Application for a Subsequent License for the Lower Hydroelectric Project FERC Project #2421.

#### General Observations:

The Flambeau Lower Project Boundary was divided into three different areas; *the impoundment* (from HWY 182 bridge in Park Falls to the dam), *FHLLC-owned property within the project boundary* (FHLLC owned property adjacent to the dam and powerhouse), and *the tailrace* (from the dam and powerhouse to the HWY 13 bridge).

*The tailrace* was surveyed by boat and no purple loosestrife plants were observed.

*The FHLLC-owned property within the project boundary* was surveyed on foot and no purple loosestrife plants were observed.

*The impoundment* was surveyed by boat and no purple loosestrife plants were observed.

If any purple loosestrife plants had been found during the inventory, a digital camera would have been used to document these occurrences and GPS coordinates for the location of the plants would have been recorded.

**Purple Loosestrife Survey**

**Project:** Flambeau Lower #2421

**Date:** August 3, 2011

**Crew:** NAH Personnel

**Datum:** WGS 84

**Page:** 1 of 1

Sighting #	GPS Point	Latitude	Longitude	Plant Height	Stand Area	Comments
						No occurrences of purple loosestrife were found within the project boundary in 2011.

# Flambeau Lower, Purple Loosestrife Location Map 2011

Park Falls WI, FERC #2421



- Legend**
- Delorme Atlas Index
  - County Boundaries
  - Railroads
  - Major Highways
  - Interstate
  - US Highway
  - State Highway
  - Local Roads
  - 24K Open Water
  - Cities and Villages
  - Village
  - City

Purple Loosestrife observed in 2011

Purple Loosestrife observed in previous years and not in 2011

Scale: 1:23,502

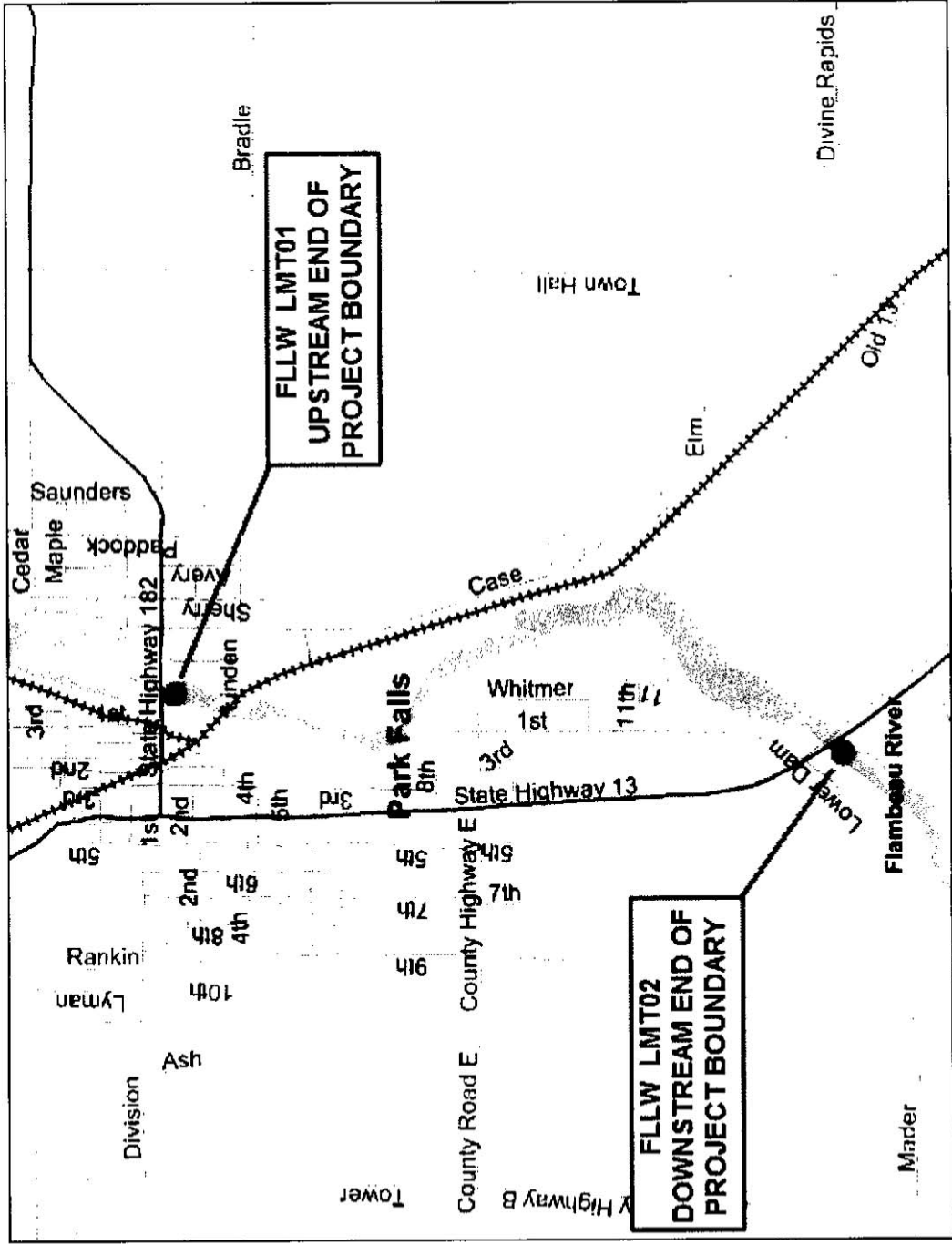

This map is a user generated static output from an internet mapping site and is for general reference only. Data layers that appear on this map may or may not be accurate, current, or otherwise reliable. THIS MAP IS NOT TO BE USED FOR NAVIGATION.



**North American Hydro Holdings, Inc.**

116 State Street, P.O. Box 167, Neshkoro, WI 54960 USA

Tel 920-293-4628 Fax 920-293-8087 Email nah@nahydro.com Web www.nahydro.com

October 25, 2011

Mr. Craig Roesler  
Water Quality Biologist, Upper Chippewa Basin  
Wisconsin Department of Natural Resources  
10220 State Hwy 27  
Hayward, WI 54843

Ms. Cheryl Laatsch  
Water Regulations and Zoning Specialist  
Wisconsin Department of Natural Resources  
PO Box 7921  
Madison, WI 53707-7921

Mr. Peter Fasbender  
Field Supervisor  
U.S. Fish and Wildlife Service  
2661 Scott Tower Drive  
New Franken, WI 54229

***Re: Flambeau Lower Project, No. 2421, Flambeau Hydro, LLC  
Article 410, Purple Loosetrife Inventory***

Dear Mr. Roesler, Ms. Laatsch, and Mr. Fasbender:

Attached is a copy of the Flambeau Hydro, LLC "Purple Loosetrife Inventory" for 2011. This annual report has been prepared to comply with the federal hydropower license of the project and article named above and is being filed with the Federal Energy Regulatory Commission.

If you have any questions regarding this submission, please contact Mr. Jereme Klassy at 920-293-4628 (ext. 22).

Sincerely,

***NORTH AMERICAN HYDRO HOLDINGS, INC.***

A handwritten signature in black ink, appearing to read "Charles", written over the company name.

for Charles Alsberg  
Chief Executive Officer