

Dave and Helen Peterson
 1719 S Deer LK Circle

C Clemons
 3/30/17

Dave and Helen Peterson

Rain Garden #1

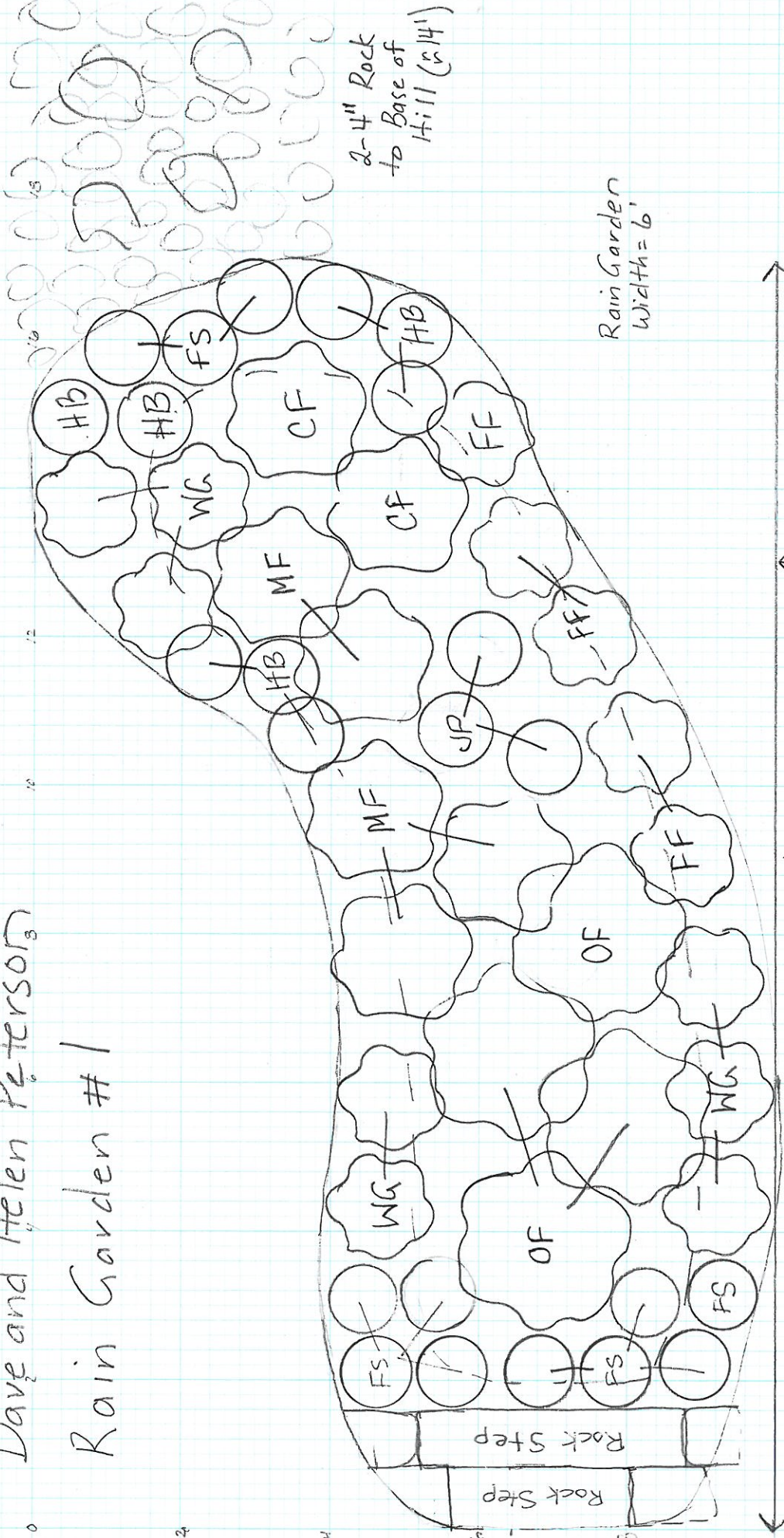

2-4" Rock to Base of Hill (214')

Rain Garden Width = 6'

17'

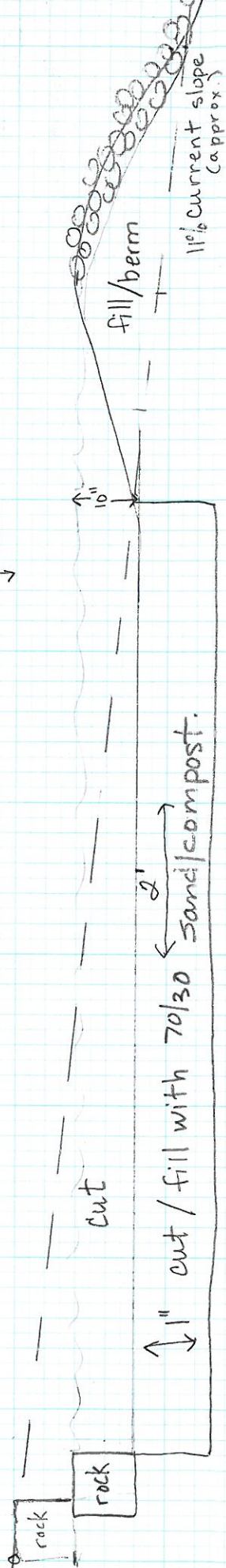

fill/berm

1" cut/fill with 70/30 sand/compost

11% Current slope (approx.)

Dave and Helen Peterson
Rain Garden #2

0 2 4 6 8 10 12 14 16 18

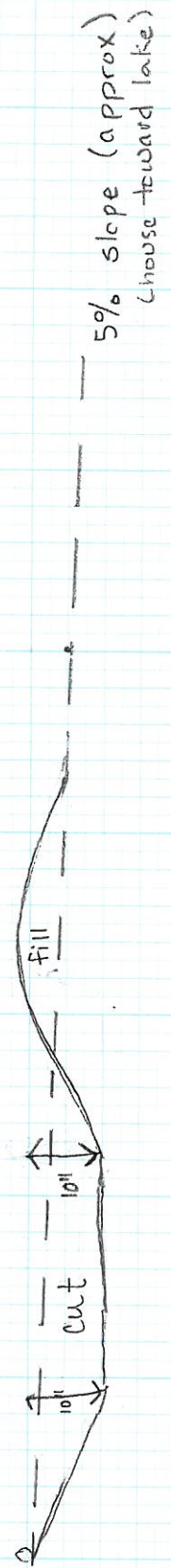
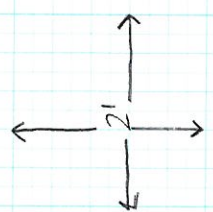
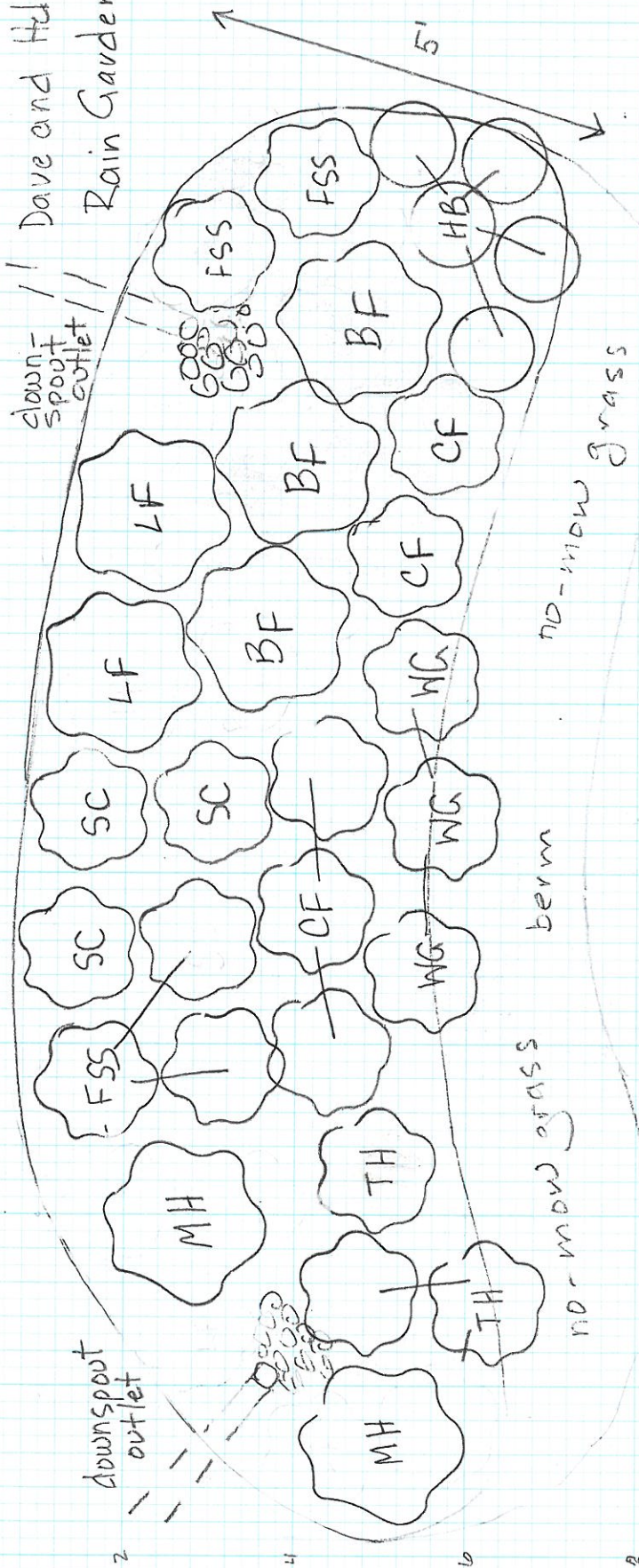

Rain Garden Plant List - Peterson

	Common Name	Scientific Name	Height	Bloom Time	Bloom Color	
Flowers						
JP	Jack in the pulpit	<i>Arisaema triphyllum</i>	18-30"	May to June	Purple/Green	
WG	Wild geranium	<i>Geranium maculatum</i>	18 inches	May to June	Pink	slope
FSS	False Solomon's seal	<i>Smilacina racemosa</i>	to 36 inches	May to July	White	
FF	Foamflower	<i>Tiarella cordifolia</i>	12 inches	May to June	White	slope
HB	Harebell	<i>Campanula rotundifolia</i>	16-24 inches	June to Sept.	Lavender	slope
SC	Sweet coneflower	<i>Rudbeckia subtomentosa</i>	36-48 inches	July to August	Yellow	part sun to sun
TH	Turtlehead	<i>Chelone glabra</i>	to 36 inches	July to Sept.	White	part sun to sun
CF	Cardinal flower	<i>Lobelia cardinalis</i>	to 36 inches	May to Sept.	Red	part sun to sun
BF	Blue flag iris	<i>Iris versicolor</i>	to 36 inches	June to July	Blue	part sun to sun
Ferns						
MF	Maidenhair fern	<i>Adiantum pedatum</i>	24 in	None	None	
CN	Cinnamon fern	<i>Osmundo cinnamomes</i>	36 in	None	None	
LF	Lady fern	<i>Athyrium filix-femina</i>	24 in	None	None	
OF	Ostrich fern	<i>Matteuccia struthiopteris</i>	24 in	None	None	
Sedges and Grasses						
FS	Fox sedge	<i>Carex vulpinoidea</i>	12 to 36 in	NA	NA	

Rain Garden Plant Quantities - Peterson

	Common Name	Scientific Name	Rain Garden #1			Rain Garden #2				
			Seedlings	2" Pots	3" Pots	4-6" Pots	Seedlings	2" Pots	3" Pots	4-6" Pots
Flowers										
JP	Jack in the pulpit	<i>Arisaema triphyllum</i>				3				
WG	Wild geranium	<i>Geranium maculatum</i>				8			3	
FSS	False Solomon's seal	<i>Smilacina racemosa</i>								5
FF	Foamflower	<i>Tiarella cordifolia</i>			5					
HB	Harebell	<i>Campanula rotundifolia</i>			8				5	
SC	Sweet coneflower	<i>Rudbeckia subtomentosa</i>							3	
TH	Turtlehead	<i>Chleone glabra</i>								3
CF	Cardinal flower	<i>Lobelia cardinalis</i>							5	
BF	Blue flag iris	<i>Iris versicolor</i>								3
Ferns										
MF	Maidenhair fern	<i>Adiantum pedatum</i>				5				2
CN	Cinnamon fern	<i>Osmundo cinnamomes</i>				2				
LF	Lady fern	<i>Athyrium filix-femina</i>								2
OF	Ostrich fern	<i>Matteuccia struthiopteris</i>				4				
Sedges and Grasses										
FS	Fox Sedge	<i>Carex vulpinoidea</i>	12							
			12		13	22			16	15

Plant 2" pots with 14" spacing with 12" spacing
 Plant 3 inch pots with 16" spacing
 Plant 6 inch pots with 18-24" spacing
 Pot sizes can be substituted with spacing indicated

Rain Garden Project Quantities

Peterson
1719 S Deer Lake Circle

	Materials	Quantity	Cost per unit	Total Cost
Rain Garden #1- 56 ft2 + 56 ft2 (slopes)				
	Seedlings	12		
	3" Pots	13		
	4-6" Pots	22		
	Wood mulch (3")	1 yard		
	70/30 sand compost	2.7 yards		
	Soil amendment			
	Rock for overflow (2-4")	1 yard		
depends on size	Rock for top steps	5'X8"highX4"steps		
	Filter fabric for overflow (4')	14 linear feet		
	Excavation			
repair	Shady grass seed			
Rain Garden #2- 85 ft2				
	Seedlings	0		
	3" Pots	16		
	4-6" Pots	15		
	Wood mulch (3")	.75 yard		
	Soil amendment			
	4" PVC downspout outlet	22 feet		
	downspout/PVC connectors	2		
	Rock at base (3/4-1 1/2")	3 ft3		
	Filter fabric for outflow	5 ft2		
	Erosion blanket	100 ft2		
	Excavation			
berm	No mow grass seed			

Silt fence below construction area