

Dane County Regional Planning Commission

217 S. Hamilton St., Suite 403, Madison, Wisconsin 53703-3238 Tel. 608/266-4137

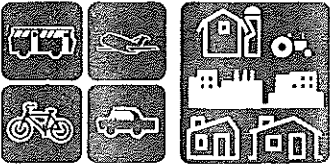

February 23, 1995

Roger Shores
Bureau of Water Resources Management
Wis. Dept. of Natural Resources
101 S. Webster
Madison, WI 53707

RE: Amendment to the Dane County Water Quality Plan, Revising
The Central Urban Service Area Boundary in the City of Fitchburg

Dear Roger:

Enclosed are supporting information and materials for an amendment to the *Dane County Water Quality Plan*. The amendment, which was requested by the City of Fitchburg, adds 9.65 acres to the Central Urban Service Area in order to provide sewer service to a proposed elementary school to be built by the Verona Area School District.

I am enclosing two copies of the following materials for your information and review: (1) the request and supporting information report from the City of Fitchburg (Proposed Central Urban Service Area Amendment for Verona Area School District Site, City of Fitchburg, January 1995); (2) public hearing notice; (3) Staff Analysis of the proposed amendment (dated 2/2/95); (4) minutes of the 2/9/95 RPC public hearing on the proposed amendment; and (5) Resolution RPC No. 732 adopting the amendment.

We are submitting this amendment for Department review and approval. As the proposed school is to be constructed as soon as possible, your assistance in expediting the review would be very helpful. If you have any questions or need additional information, please do not hesitate to contact me.

Sincerely,

William N. Lane, Director
Environmental Resources Planning

WNL:lel

Enclosures

cc: Tom Hovel, City of Fitchburg
James Nemke, Chief Engineer and Director, MMSD

cc w/enc.: Steve Fix, DNR So. Dist.

RPC



George E. Meyer
Secretary

State of Wisconsin \ DEPARTMENT OF NATURAL RESOURCES

101 South Webster Street
P.O. Box 7921
Madison, Wisconsin 53707-7921
TELEPHONE 608-266-2621
TELEFAX 608-267-3579
TDD 608-267-6897

April 18, 1995

Mr. William N. Lane, Director
Environmental Resources Planning
Dane County Regional Planning Commission
217 South Hamilton Street, Room 403
Madison, WI 53707

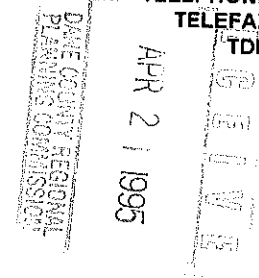

SUBJECT: City of Fitchburg sewer service area amendment.

Dear Mr. Lane:

We have reviewed the City of Fitchburg's sewer service area amendment for the proposed Verona Area School District - elementary school and we approve their request. The 9.65 acre amendment is part of a greater site already within the central urban service area and it has no significant environmentally sensitive features. Please see the attached map.

The Dane County Planning Commission's approving resolution (No. 732) includes a condition stipulating that the City's stormwater management requirements emphasize water infiltration.

The approval of this revision does not constitute approval of any of the following:

- private sewage systems pursuant to Chapter ILHR 83,
- sewer extension pursuant to Chapter NR 110, (WI Admin. Code),
- authority to alter the bed or banks of any navigable waterway (Chapter 30, WI Stats.), or
- certification for any wetland alteration (Section 401, Federal Water Pollution Control Act, and NR 103, 299, WI Admin. Code).

Those approvals must be obtained separately from the respective agencies.

Any person aggrieved by this approval has the right to appeal the decision. Wisconsin Statutes and Administrative Code establish time periods within which requests to

review Department decisions must be filed. For judicial review of a decision pursuant to s. 227.52 and 227.53, Wis. Stats., a petition for review must be filed within 30 days after service of the decision. The respondent in an action for judicial review is the Department of Natural Resources. This notice is provided pursuant to s. 227.48(20), Wis. Stats.



Sincerely,

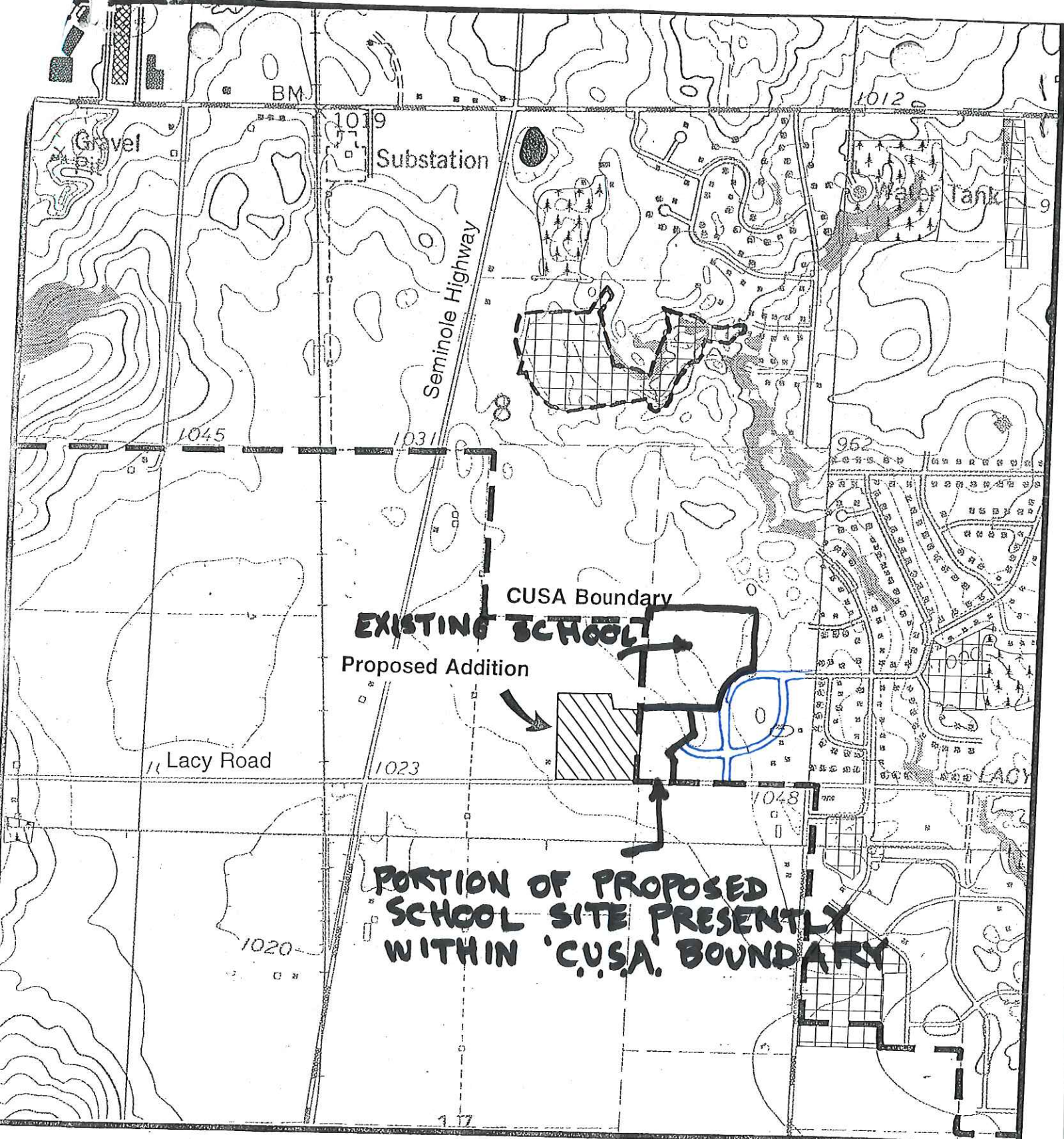

Charles R. Ledin, Section Chief
Planning and Policy Section
Bureau of Water Resources Management

c: Douglas Morrisette, Mayor, City of Fitchburg
Madison Metropolitan Sewerage District
Steven Fix, SDH

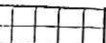
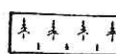
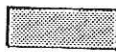

FITCHBURG CUSA AMENDMENT

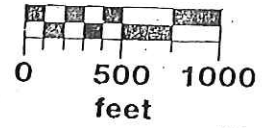
-  Urban service area boundary
-  Isolated resource feature
-  Existing parks and greenways
-  Woodlands
-  Steep slopes (>12%)



1/95