

Resolution RPC No. 732

**AMENDING THE DANE COUNTY REGIONAL DEVELOPMENT GUIDE,  
FARMLAND PRESERVATION AND WATER QUALITY PLANS TO REVISE  
THE CENTRAL URBAN SERVICE AREA BOUNDARY  
IN THE CITY OF FITCHBURG**

WHEREAS, the Dane County Regional Planning Commission has adopted, amended and reaffirmed a Regional Development Guide, Farmland Preservation Plan and Water Quality Plan; and

WHEREAS, said plans delineate urban service areas and environmental corridors as amended through December 1994; and

WHEREAS, the City of Fitchburg has proposed amending the Fitchburg portion of the Central Urban Service Area boundary in Section 8, T.6N.,R.9E.; and

WHEREAS, the City has submitted adequate planning and supporting information to satisfy requirements for urban service area amendments;

WHEREAS, evaluation of the plans and supporting information indicates that the requested amendment, as indicated on the attached map, would be consistent with the criteria and policies of adopted regional plans;

NOW, THEREFORE, BE IT RESOLVED in accordance with §66.945(9), Wis. Stats., and Sec. 208 of Public Law 92-500, the Dane County Regional Planning Commission amends the Dane County Regional Development Guide, Farmland Preservation and Water Quality Plans by revising the Central Urban Service Area boundary in the City of Fitchburg as depicted on the attached map, with the recommendation that the City of Fitchburg seek to emphasize infiltration and protect groundwater recharge associated with site development and stormwater management.



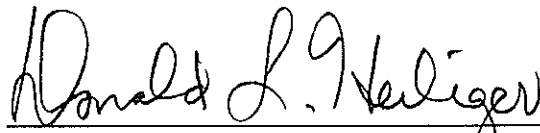

February 9, 1995

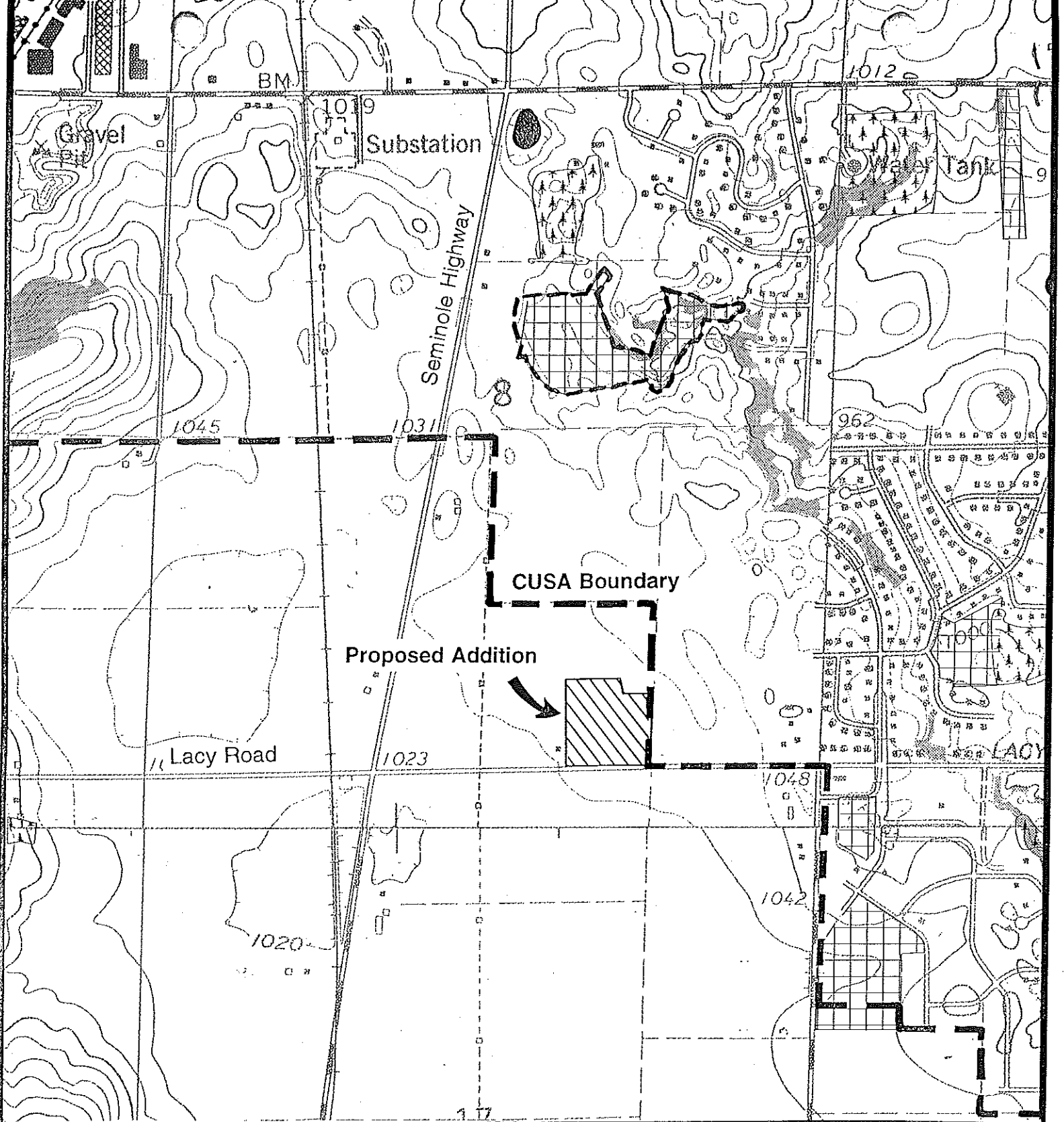
Date Adopted

  
Donald L. Heiliger, Secretary

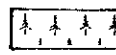

# FITCHBURG CUSA AMENDMENT

-  Urban service area boundary
-  Isolated resource feature
-  Existing parks and greenways
-  Woodlands
-  Steep slopes (>12%)

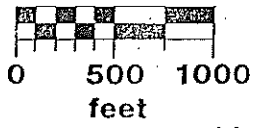

1/95