

# Appendix A. Trout Stream Classification Checklist (revised 2/2016)

(This completed checklist should accompany any trout stream classification changes. Check the items as appropriate and attach comments if desired.)

Stream name: Creek 34-10  
(if stream is known by another name please list both names with the more common name first)

County: Monroe/Jackson WBIC: 1703300

Define the portion of the stream to be classified. Please provide both a written description and the coordinate locations of the upstream and downstream beginning and end points.

Creek 34-10 is a 0.55 mile tributary to Wyman Creek that originates in Sec. 03, T19NR2W, Monroe Co. The Class II trout water flows from the origin generally northwest for 0.55 miles across the Monroe/Jackson County line and ends at the upper reach of Wyman Lake in Sec. 34, T20NR2W, Jackson Co.

This written description should reference permanent, unambiguous landmarks that would allow a person unfamiliar with the area to locate the points (e.g., dams, road crossings, stream confluences, county lines, section lines, township lines)

Please provide coordinate locations in one of three formats:

Longitude/Latitude (Degrees, Minutes, Seconds): 89° 41' 28.7" W , 44° 55' 14.0" N

Longitude/Latitude (Decimal Degrees): -89.691332, 44.920576

WTM91 (easting and northing in meters): 544361, 494173

Upstream point coordinates: 44.15799, -90.60530

Downstream point coordinates: 44.16479, -90.60901

Classification proposed Class II

Fish survey (including relative abundance, length distribution, and age structure) and habitat survey completed on water to be classified. Survey on file at Black River Falls (office location)

Fish team supervisor and district fisheries supervisor have approved the classification.  
Date 09/05/2018 (Hujik) 09/19/2018 (Benike)

Fish Biologist has consulted with the following staff in their office or district

Permit Drafter Name 1,2 Date 09/05&06/2018 Concerns No

Water Resource Specialist Name 3 Date 09/05/2018 Concerns No

Water Management Specialist Name 4 Date 09/06/2018 Concerns No

Drinking and Groundwater staff Name 5 Date 09/16/2018 Concerns No

X Public notice published in local newspaper or other media. Date 09/13,19,20,26/2018

X Notice sent to all clerks of the county, town, city, or village in which the stream is located.  
Date 09/06/2018

Trout Stream Classification Checklist (revised 8/2013) - Continued

X Notice sent to legislators in the affected districts. Date 09/06/2018

X Notice sent to chairpersons of legislative committees with jurisdiction for natural resources issues. Date 09/06/2018

IP No hearing requested 30 days after public notice.

IP Hearing requested, held, and classification recommended. Date \_\_\_\_\_

Signed: David C. Heitler Date: 09/26/18  
Fisheries Biologist

Approved: Her Benille Date: 9-25-18  
Fish Team Supervisor

Robert H. Hagle Date: 9-25-18  
District Fisheries Supervisor

- 1 - Jason Gazdecki, Stormwater Specialist
- 2 - Stacey Carlson, Water Management Specialist
- 3 - Camille Bruhn
- 4 - David Hon
- 5 - Adam Freihoefer



# Creek 34-10 Location, Jackson and Monroe Counties.

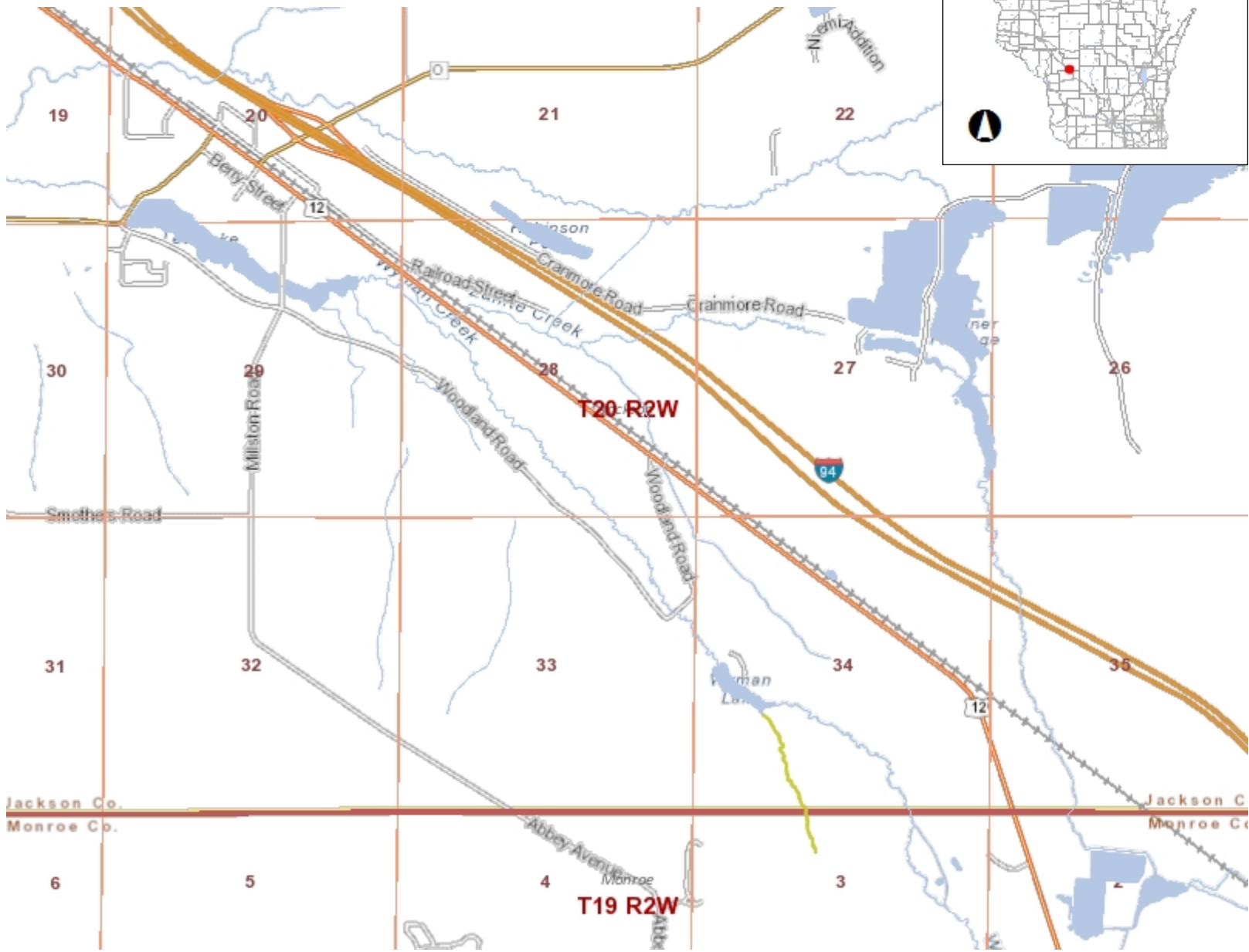

- Legend**
- 24K Hydrography Streams and Rivers
  - 24K Hydrography Lakes and Open Water
  - Township
  - Section
  - Quarter-Quarter
  - County Boundary
  - Cities, Towns & Villages
    - City
    - Village
    - Civil Town
  - Municipality
  - State Boundaries
  - County Boundaries
  - Major Roads
    - Interstate Highway
    - State Highway
    - US Highway
  - County and Local Roads
    - County HWY
    - Local Road
  - + Railroads
  - Tribal Lands
  - Rivers and Streams
  - Intermittent Streams
  - Lakes and Open water

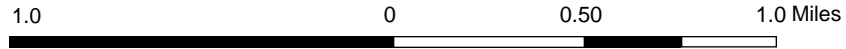

NAD\_1983\_HARN\_Wisconsin\_TM

1: 31,680

DISCLAIMER: The information shown on these maps has been obtained from various sources, and are of varying age, reliability and resolution. These maps are not intended to be used for navigation, nor are these maps an authoritative source of information about legal land ownership or public access. No warranty, expressed or implied, is made regarding accuracy, applicability for a particular use, completeness, or legality of the information depicted on this map. For more information, see the DNR Legal Notices web page: <http://dnr.wi.gov/legal/>

**Notes**

Stream Length 0.55 miles. Currently unclassified. Proposed classification - Class II

**Public Notice – Creek 34-10, Jackson and Monroe County, WI**  
**Date**

Pursuant to NR 1.02(7)(c), Wis. Adm. Code, the Department of Natural Resources gives public notice of the classification of the entire length, 0.55 miles, of Creek 34-10, in Monroe and Jackson County as a Class II Trout water.

Creek 34-10 is a 0.55 mile tributary of Wyman Creek that originates in Sec. 3, T19NR2W, Monroe County, and flows generally northwest to its mouth at Wyman Lake in Sec. 34, T20NR2W, Jackson County.

This classification is based upon a survey which indicates this portion of stream contains a population of brook trout made up of one or more age groups, above the age of one year, in sufficient numbers to indicate substantial survival from one year to the next, and has some natural reproduction occurring; however, stocking is necessary to fully utilize the available trout habitat and sustain the fishery.

The Department shall waive any hearing requirement on this classification unless a written request for hearing is received within 30 days after publication of this public notice. Requests should be sent to Daniel C. Hatleli, Fish Biologist, 910 Highway 54 East, Black River Falls, WI 54615.

WBIC # 1703300

Creek 34-10 Brook Trout Length Frequency, 2018.

