



September 2, 2014

DNR File No. DC-0161

Mr. Kamran Mesbah, Deputy Director
Capital Area Regional Planning Commission
City County Building, Room 362
210 Martin Luther King Jr. Blvd.
Madison, WI 53703

Subject: Amendment to the *Dane County Water Quality Plan*, Revising the Waunakee Urban Service Area and Environmental Corridors Boundaries in the Town of Westport, and Revising the Central Urban Service Area and Environmental Corridors Boundaries in the Town of Westport

Dear Mr. Mesbah:

We have completed our review of the subject amendment request that was submitted to the Department on August 14, 2014 by the Capital Area Regional Planning Commission. The Department hereby approves this amendment request which adds 15.6 acres to the Waunakee Urban Service Area (Site A) and 10 acres to the Central Urban Service Area (Sites B and C), as described below (See Maps 1a and 1b).

Site A, to be added to the Waunakee Urban Service Area is located at 5841 Mill Road in the Town of Westport. This site contains one single family home. The 15.6 acre addition consists of 8.4 acres of existing development, 7.2 acres of environmental corridors and no developable acres. This amendment corrects the boundaries for the service area since the home is currently served by the Madison Metropolitan Sewerage District (MMSD).

Site B, located on Reynolds Avenue in the Town of Westport, also corrects a boundary issue for an existing home served by MMSD. The 8.5 acre site contains an existing home on 1.1 acres, 0.5 acres in existing right-of-way, and 6.9 acres are proposed for inclusion in environmental corridors. This parcel will be added to the Central Urban Service Area.

Site C, also on Reynolds Avenue in the Town of Westport, will be added to the Central Urban Service Area. This parcel of 1.5 vacant acres was purchased by the owner of an adjacent lot, which was already within the Central Urban Service Area. The proposed addition will add 1.3 acres to environmental corridors and includes 0.2 developable acres. Should construction occur on this lot along the shore of Lake Mendota, the Department urges the local municipality to be diligent in enforcing all state administrative code and local ordinances for erosion control. The municipality issuing the building permit is encouraged to take all steps necessary to protect the water quality of Lake Mendota.

These amendments were requested by the Town of Westport in January 2014, a public hearing was held on May 8, 2014, and the amendment was adopted by the Capital Area Regional Planning Commission per Resolution No. 2014-7 on May 8, 2014.

This amendment becomes a part of the Dane County Water Quality Management Plan and will be forwarded to the US Environmental Protection Agency to meet the requirements of the Clean Water Act of 1987 (Public Law 92-500 as amended by Public Law 95-217), and outlined in the federal regulations 40 CFR, Part 35.

This review is an equivalent analysis action under s. NR 150.20 (2) (a) 3, Wis. Adm. Code. By means of this review, the Department has complied with ch. NR 150, Wis. Adm. Code, and with s. 1.11, Stats.

The approval of this sewer service area amendment does not constitute approval of any other local, state, or federal permit that may be required for sewer construction or associated land development activities.

If you believe that you have a right to challenge this decision, you should know that the Wisconsin statutes and administrative rules establish time periods within which requests to review Department decisions must be filed. For judicial review of a decision pursuant to sections 227.52 and 227.53, Wis. Stats., you have 30 days after the decision is mailed, or otherwise served by the Department, to file your petition with the appropriate circuit court and serve the petition on the Department. Such a petition for judicial review must name the Department of Natural Resources as the respondent.

To request a contested case hearing pursuant to section 227.42, Wis. Stats., you have 30 days after the decision is mailed, or otherwise served by the Department, to serve a petition for hearing on the Secretary of the Department of Natural Resources. All requests for contested case hearings must be made in accordance with section NR 2.05(5), Wis. Adm. Code, and served on the Secretary in accordance with section NR 2.03, Wis. Adm. Code. The filing of a request for a contested case hearing does not extend the 30 day period for filing a petition for judicial review.

Sincerely,



Thomas J. Mugan, P.E., Chief
Wastewater Section
Bureau of Water Quality





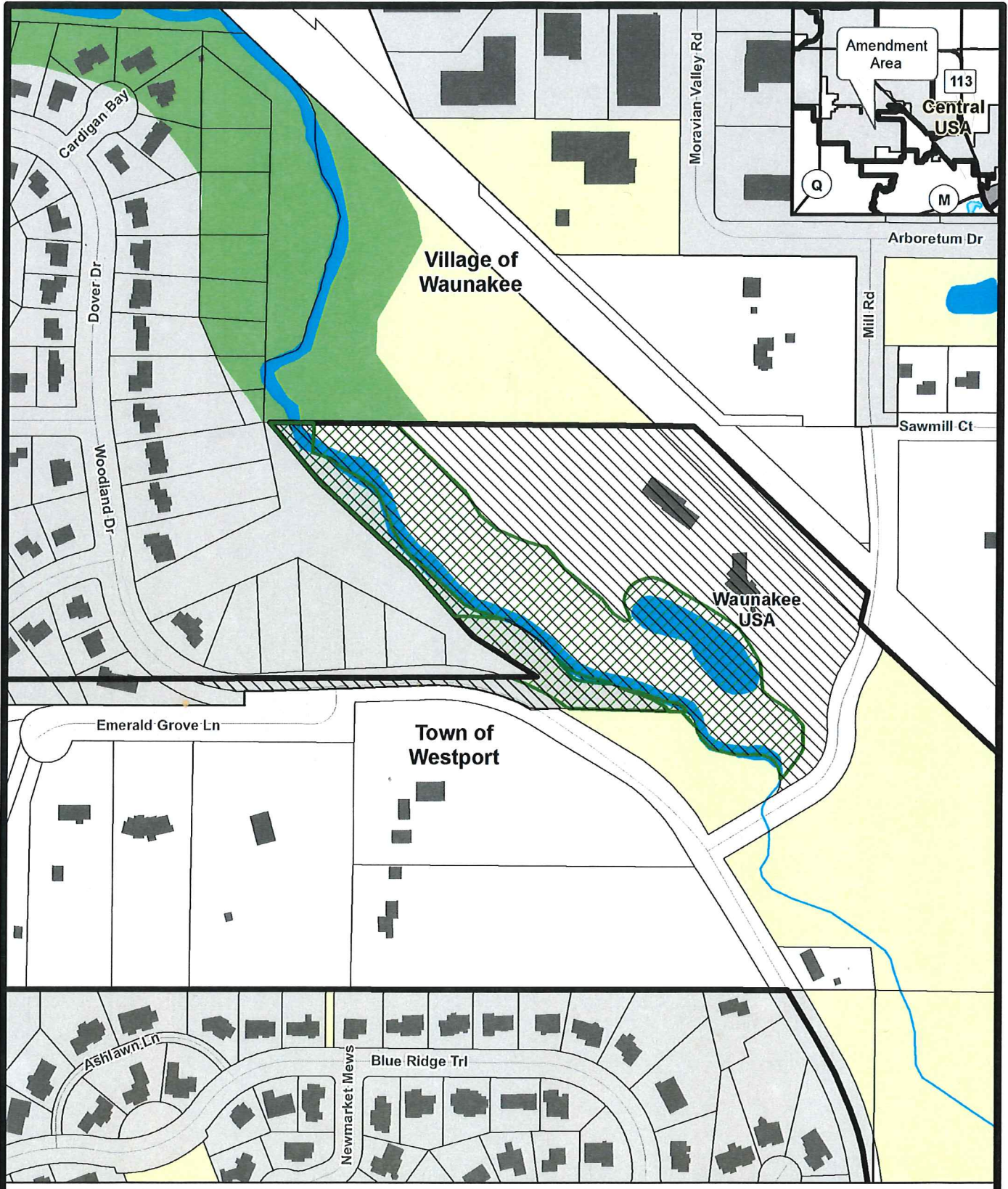

cc:

John Van Dinter, Chair, Town of Westport, 5387 Mary Lake Rd, Waunakee, WI 53597
Tom Wilson, Attorney/Administrator, Town of Westport, 5387 Mary Lake Rd, Waunakee, WI 53597
John Laubmeier, President, Village of Waunakee, 500 W. Main St, Waunakee, WI 53597
Todd Schmidt, Administrator, Village of Waunakee, 500 W. Main St, Waunakee, WI 53597
Greg Searle - WDNR – SCR – Fitchburg
Michael Sorge – WDNR – SCR – Fitchburg
Lisa Helmuth – WDNR – WQ/3
Fran Keally–WDNR - WQ/3



Map 1a Westport - 5841 Mill Rd

Amendment to the Waunakee Urban Service Area and Environmental Corridors in the Town of Westport

-  Service Area to be added (15.6 acres)
-  Proposed Environmental Corridor (6.3 acres)
-  Public Land
-  Existing Environmental Corridor
-  Incorporated Area
-  Existing Urban Service Area Boundary
-  Proposed Urban Service Area Boundary

30 Jan. 2014

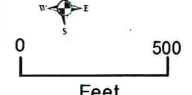



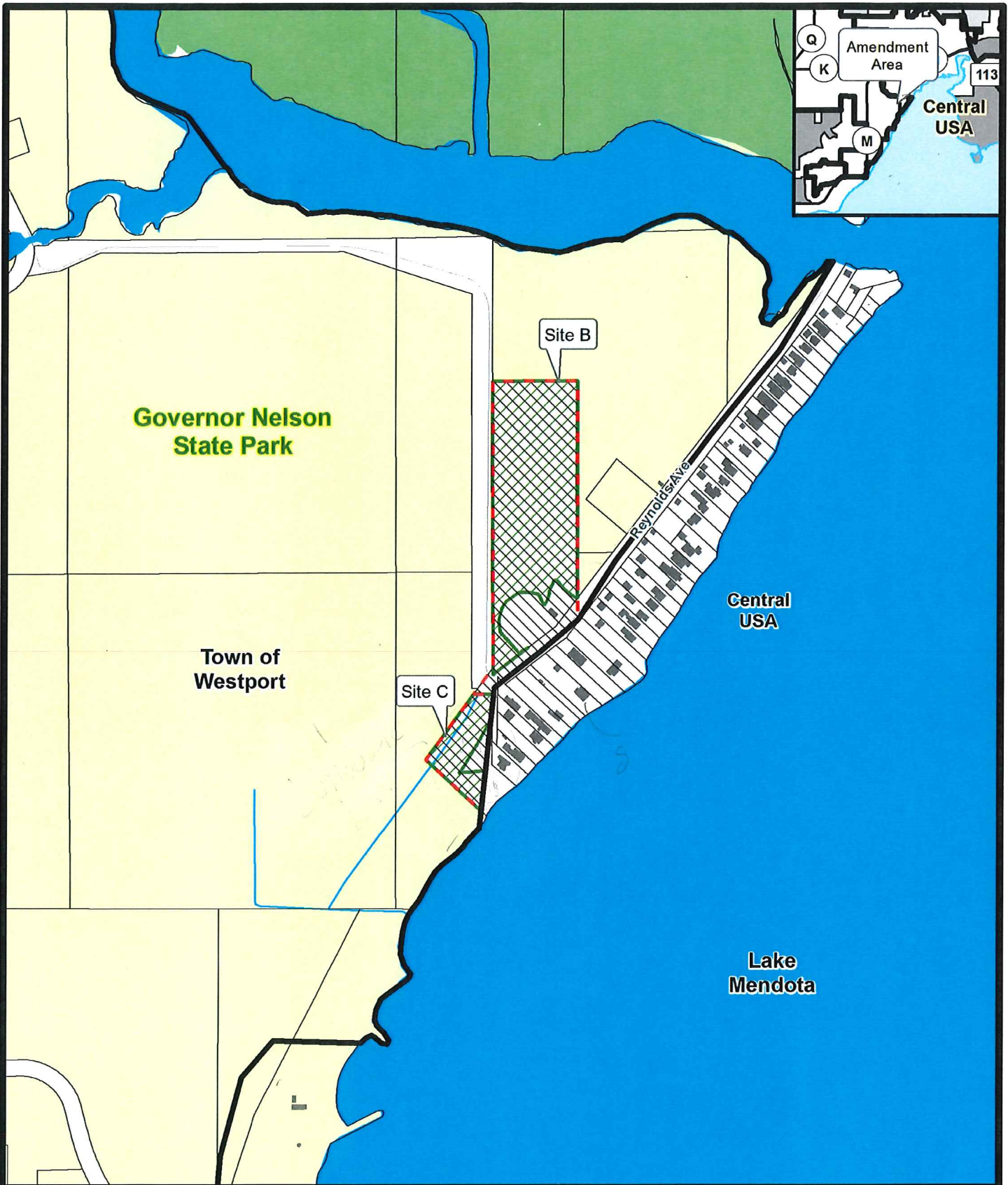



Prepared by staff of the CARPC.



Map 1b Westport - Reynolds Ave

**Amendment to the Central Urban
Service Area and Environmental
Corridors in the Town of Westport**

-  Service Area to be added (10.0 acres)
-  Proposed Environmental Corridor (8.2 acres)
-  Public Land
-  Existing Environmental Corridor
-  Incorporated Area
-  Existing Urban Service Area Boundary
-  Proposed Urban Service Area Boundary

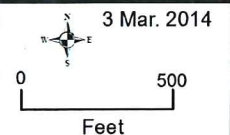

Prepared by staff
of the CARPC.