

Resolution CARPC No. 2014-13

Amending the *Dane County Land Use and Transportation Plan* and *Dane County Water Quality Plan* by Revising the Central Urban Service Area and Environmental Corridors in the City of Madison and the Town of Middleton

WHEREAS, the Capital Area Regional Planning Commission has adopted, amended and reaffirmed the *Dane County Land Use and Transportation Plan* and *Water Quality Plan*; and

WHEREAS, said plans delineate urban service areas and environmental corridors as amended through September 2014; and

WHEREAS, the City of Madison has requested an addition to the Central Urban Service Area; and has based the request on the *2003 City of Madison and Town of Middleton Cooperative Plan* and;

WHEREAS, a staff analysis of the proposed amendment has been prepared, which indicates that the amendment is generally consistent with adopted regional plans and policies.

NOW, THEREFORE, BE IT RESOLVED that in accordance with §66.0309, Wis. Stats., and Sec. 208 of Public Law 92-500, the Capital Area Regional Planning Commission amends the *Dane County Land Use and Transportation Plan* and recommends the amendment of the *Dane County Water Quality Plan* by revising the Central Urban Service Area boundary and environmental corridors, as shown on the attached map.

Adoption of this amendment is based on the land use and urban service plans submitted in support of this amendment, and conditioned on the City of Madison pursuing the following:

1. Submit a detailed stormwater management plan for CARPC and DCL&WCD staff review and approval prior to land disturbing activities in the amendment area. The stormwater management plan for the amendment area should include the following:

- a. Install erosion and sediment control practices prior to other land disturbing activities. Protect infiltration practices from compaction and sedimentation during land disturbing activities.
- b. Control peak rates of runoff for the 1, 2, 10, and 100-year 24-hour design storms to no greater than "pre-development" levels in accordance with existing ordinances.
- c. Provide water quality control (based on at least 80% sediment control) for the amendment area in accordance with existing ordinances.
- d. Maintain the post development stay-on volume at 90% of the pre-development stay-on volume in the portion of the amendment area in the Badger Mill Creek watershed.
- e. Maintain the post development stay-on volume at 100% of the pre-development stay-on volume for the one-year average annual rainfall period, as defined by WDNR for the portion of the amendment area that is a closed basin.

f. Provide an emergency outlet from the closed basin for large storm events. The discharge rate of the full watershed draining to the existing depression area cannot exceed a discharge of 18 cubic feet per second (cfs), the remaining capacity of the existing 21-inch storm sewer.

g. Maintain pre-development groundwater recharge rates from the Wisconsin Geological and Natural History Survey's 2009 report, Groundwater Recharge in Dane County, Wisconsin, Estimated by a GIS-Based Water-Balance Model (9 to 10 in./yr. for this amendment area) or by a site specific analysis.



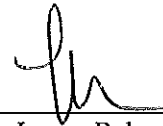

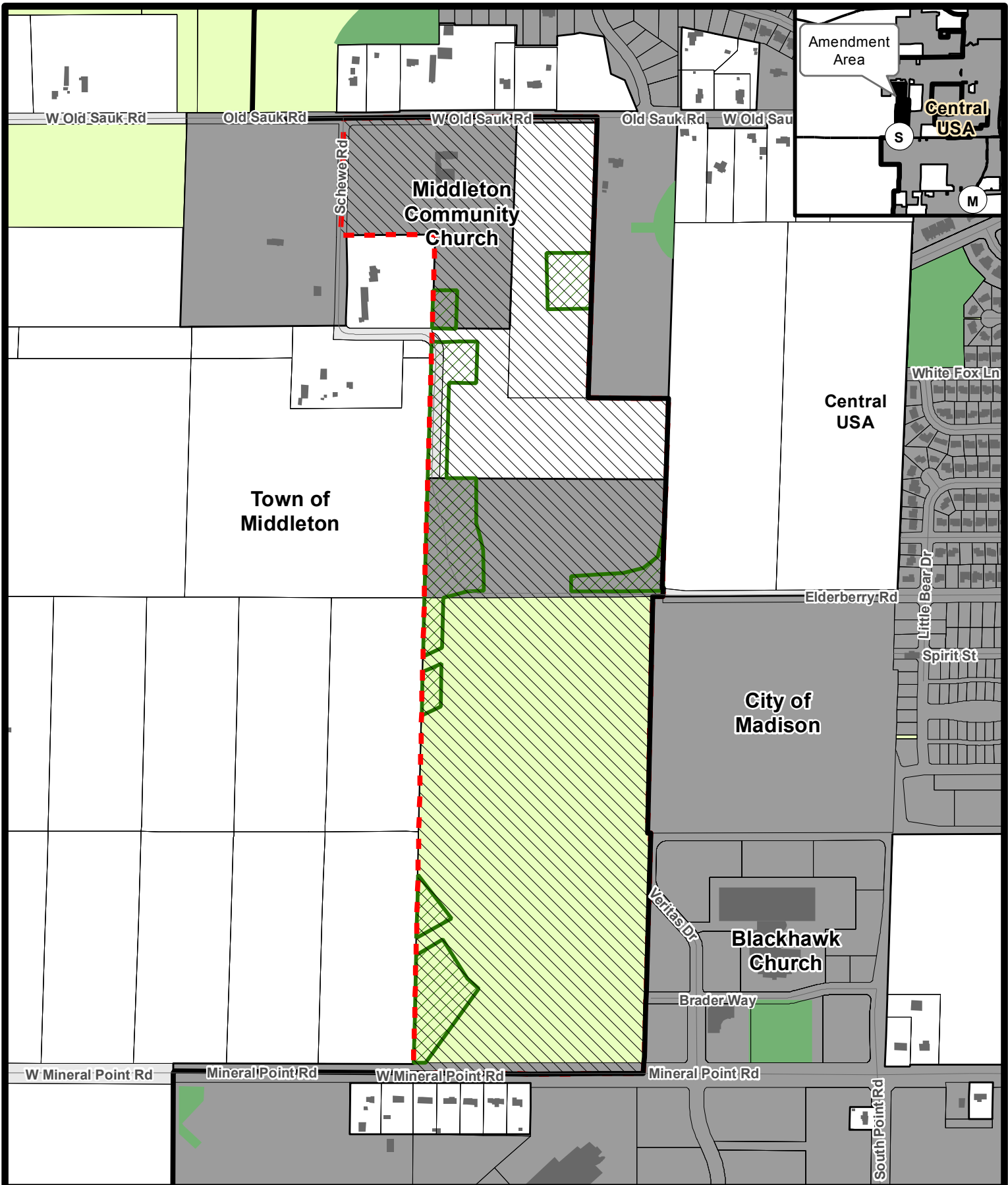

September 11, 2014
Date Adopted

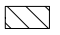

Larry Palm, Chairperson



Map 1 Elderberry
 Amendment to the Central Urban
 Service Area and Environmental
 Corridors in the City of Madison
 and Town of Middleton

-  Service Area to be added (149.3 acres)
-  Proposed Environmental Corridor (16.2 acres)
-  Public Land
-  Existing Environmental Corridor
-  Incorporated Area
-  Existing Urban Service Area Boundary
-  Proposed Urban Service Area Boundary

16 Apr. 2014

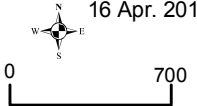

0 700
 Feet

Prepared by staff
 of the CARPC.