

Vicki Pruess
1725 Tanglewood Trail
Long Lake

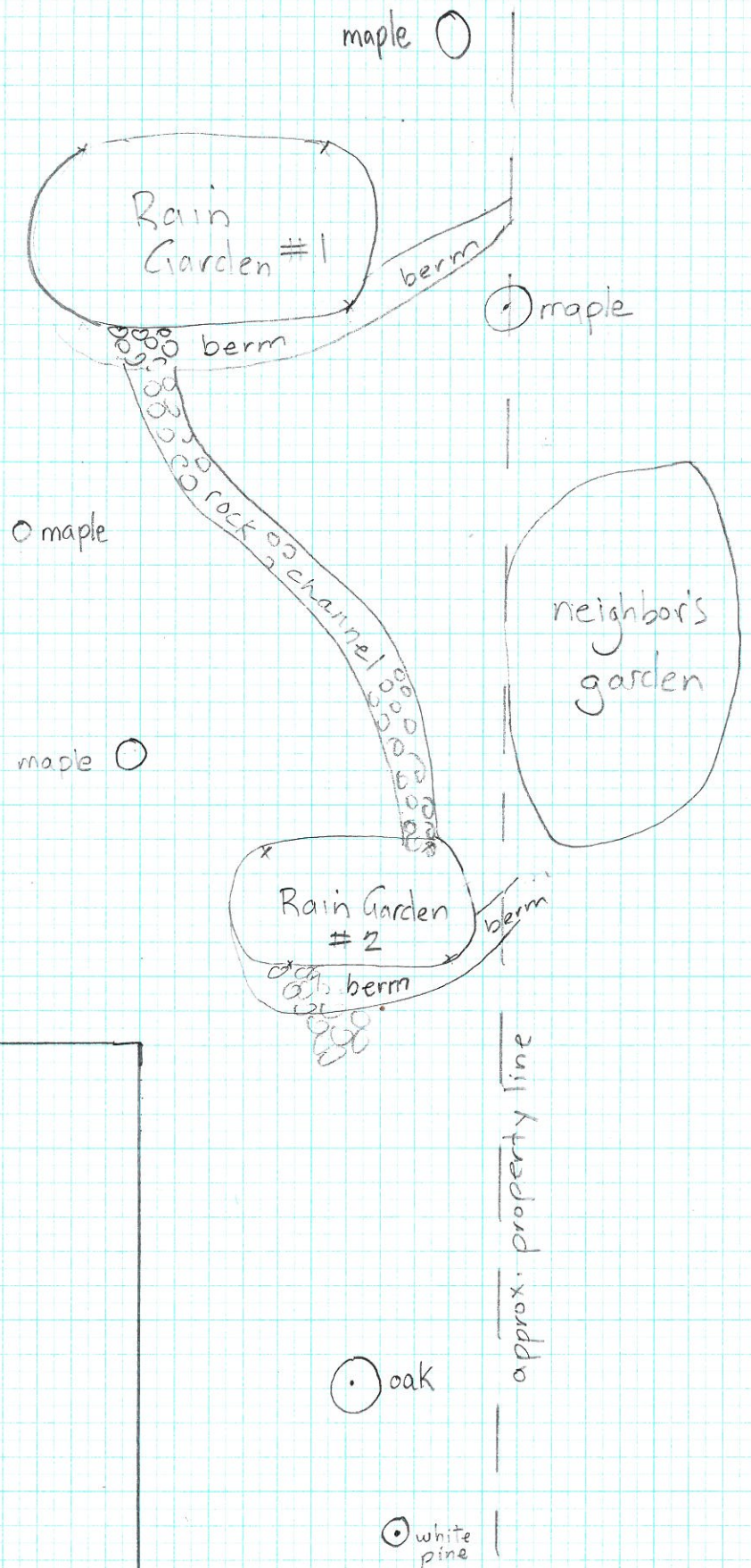

maple ○

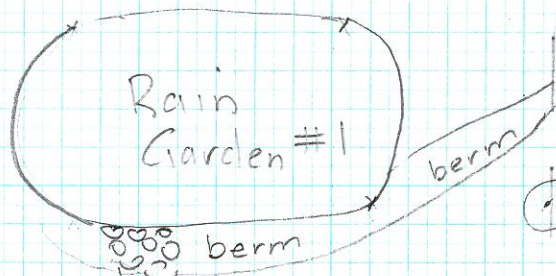

○ maple

○ maple

maple ○

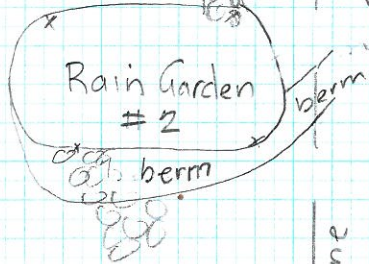

approx. property line

○ oak

○ white pine

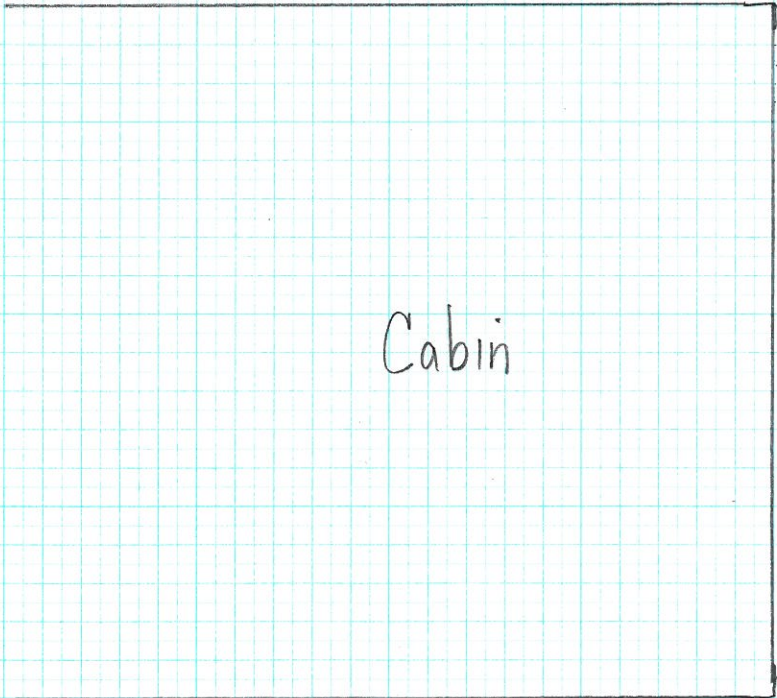

Vicki Pruess
1725
Tanglewood Tr

Rain Garden #1

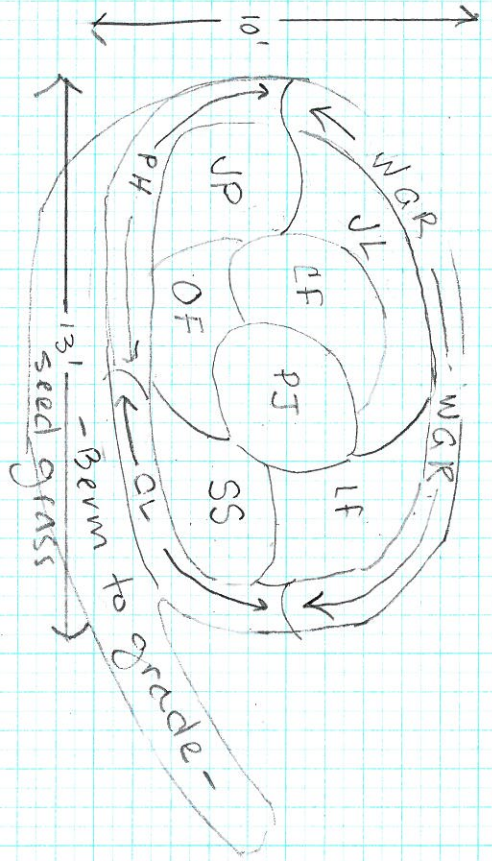

Rain Garden #2

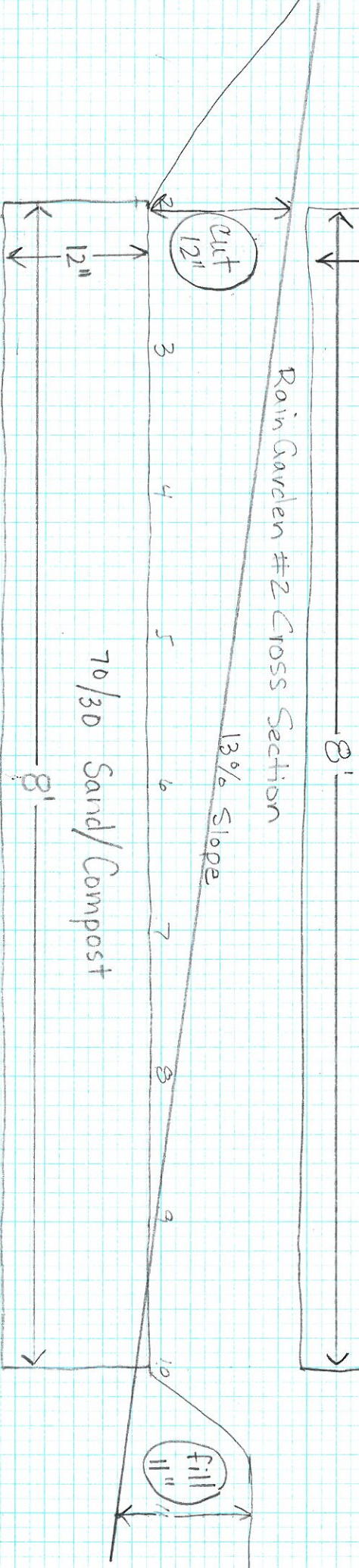
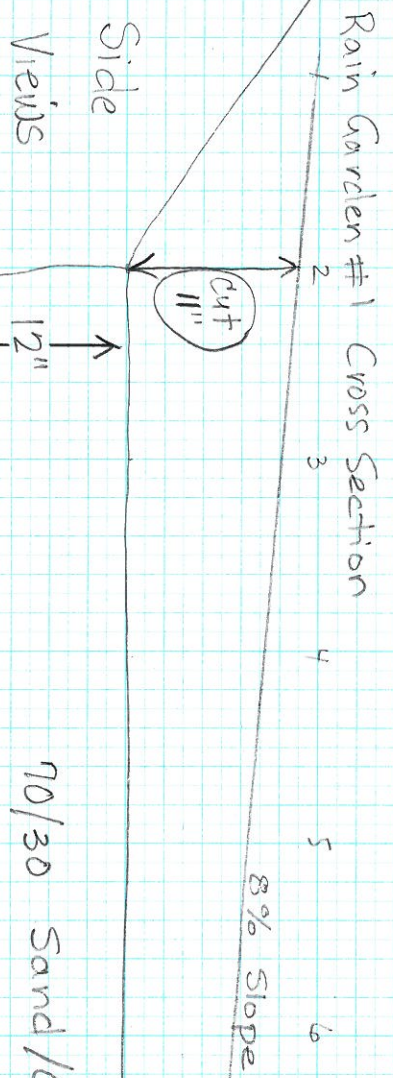
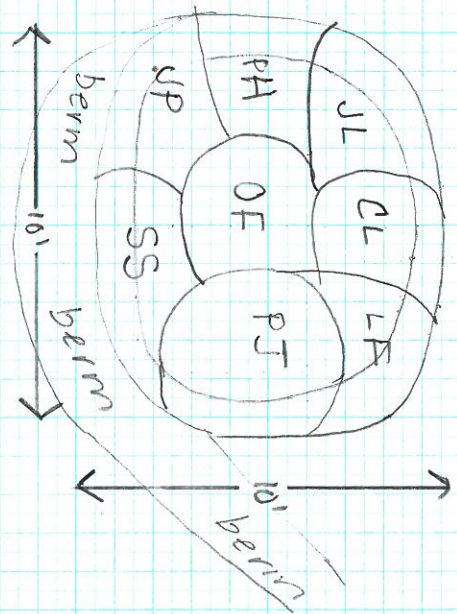

Rain Garden Plant List - Pruess

	Common Name	Scientific Name	Height	Bloom Time	Bloom Color
Flowers					
WGR	Wild ginger	<i>Asarum canadense</i>	4 to 8 in	May to June	Red
CL	Columbine	<i>Aquilegia canadensis</i>	8 to 24 in	May to June	Pink
SS	False solomon's seal	<i>Smilacina racemosa</i>	36 inches	May to July	White
PJ	Purple Joe Pyeweed	<i>Eupatorium purpureum</i>	24 to 36 in	July to Sept	Purple
JL	Jacob's ladder	<i>Polemonium reptans</i>	18 inches	May to June	Blue
PH	Woodland Phlox	<i>Phlox divaricata</i>	12 to 18 in	June to July	Blue
JP	Jack-in-the-pulpit	<i>Arisaema triphyllum</i>	18 to 30 in	May to June	Green
Ferns					
CF	Cinnamon fern	<i>Osmundo cinnamomes</i>	24 to 36 in	None	None
LF	Lady fern	<i>Athyrium filix-femina</i>	24 to 36 in	None	None
OF	Ostrich fern	<i>Matteuccia struthiopteris</i>	24 to 36 in	None	None
Sedges and Grasses					
CS	Sprengles Sedge	<i>Carex sprengelii</i>	to 18 in	NA	NA
PN	Pennsylvania sedge	<i>Carex pensyvanica</i>	6 to 18 in	NA	NA
Shrubs					
BH	Dwarf bush honeysuckle	<i>Diervilla lonicera</i>	4 feet	June to August	Yellow

Rain Garden Plant Quantities - Pruess

			RG#1, 88 ft2, slopes 42 ft2 RG#2, 64 ft2, 36 ft2 slopes					
	Common Name	Scientific Name	2" Pots	4" Pots	ferns	2" Pots	4" Pots	ferns
Flowers								
WGR	Wild ginger	<i>Asarum canadense</i>		10				
CL	Columbine	<i>Aquilegia canadensis</i>	6			6		
SS	False solomon's seal	<i>Smilacina racemosa</i>		6			5	
PJ	Purple Joe Pyeweed	<i>Eupatorium purpureum</i>	8			14		
JL	Jacob's ladder	<i>Polemonium reptans</i>	8			7		
PH	Woodland Phlox	<i>Phlox divaricata</i>	8			6		
JP	Jack-in-the-pulpit	<i>Arisaema triphyllum</i>		6			6	
Ferns								
CF	Cinnamon fern	<i>Osmundo cinnamomes</i>			4			4
LF	Lady fern	<i>Athyrium filix-femina</i>			5			
OF	Ostrich fern	<i>Matteuccia struthiopteris</i>			4			4
Sedges and Grasses								
CS	Sprengles Sedge	<i>Carex sprengeii</i>						
PN	Pennsylvania sedge	<i>Carex pensylvanica</i>						
Shrubs								
BH	Dwarf bush honeysuckle	<i>Diervilla lonicera</i>						
			30	22	13	33	11	8

Plant 2" with 14" spacing

Plant 4 inch pots with 18" spacing

Plant ferns with 24" spacing

Pot sizes can be substituted with spacing indicated

Project Quantities

Pruess
1725 Tanglewood Trail

	Materials	Quantity	Cost per unit	Total Cost
RG#1, 88 ft2, slopes 42 ft2 = 130 ft2				
	2" Pots	30		
	4" Pots	22		
	Ferns	13		
	1 Gal Shrubs	0		
	Wood mulch (4") (yd)	1.6		
	70/30 Sand/compost (yd)	3.25		
	compost delivery	1		
	Soil amendment	1		
	Erosion blanket and staples	200 ft2		
	Silt fence	1		
	Shady grass seed	1		
RG#2, 64 ft2, 36 ft2 slopes				
	2" Pots	33		
	4" Pots	11		
	Ferns	8		
	1 Gal Shrubs	0		
	Wood mulch (4") (yd)	1		
	70/30 Sand/compost (yd)	2.4		
	compost delivery	1		
	Soil amendment	1		
	Erosion blanket and staples	200 ft2		
	Silt fence	1		
	Shady grass seed	1		
Rock channel 3.0' X 40' X 0.5'	2-4" rock	2.25 yards		
	filter fabric (8 ounce)	130 ft2		