

**Notice:** Application is hereby made to the Wisconsin Department of Natural Resources, Bureau of Watershed Management for grant assistance consistent with s. 281.66, Wis. Stats., and Chapter NR 155, Wis. Adm. Code. Collection of this information is authorized under the authority of s. 281.66, Wis. Stats. The information contained in this form will be used for program budget analysis and project evaluation in the Urban Nonpoint Source Water Pollution Abatement and Storm Water Management Grant Program. Personally identifiable information collected will be used for program administration and may be made available to requesters as required under Wisconsin's Open Records Law [ss. 19.31 - 19.39, Wis. Stats.]. *Unless otherwise noted, all citations refer to Wisconsin Administrative Code.*

**Instructions:** Complete all sections as applicable.

**Applicant Information**

Governmental Unit Applying: (name & type) (example: Madison, Town of)

**Kimberly, Village Of**

Name of Authorized Representative (First, Last) <b>Rick Hermus</b>			Name of Governmental Contact Person (First, Last) (if different) <b>Rick Hermus</b>		
Title <b>Village Administrator</b>			Title <b>Village Administrator</b>		
Area Code + Telephone Number <b>920-788-7500</b>			Area Code + Telephone Number <b>920-788-7500</b>		
Area Code + Fax Number <b>920-788-9723</b>			Area Code + Fax Number <b>920-788-9723</b>		
E-Mail Address <b>rhermus@vokimberly.org</b>			E-Mail Address <b>rhermus@vokimberly.org</b>		
Mailing Address - Street or Route <b>515 West Kimberly Avenue</b>			Mailing Address - Street or Route <b>515 West Kimberly Avenue</b>		
City <b>Kimberly</b>	State <b>WI</b>	Zip Code <b>54136</b>	City <b>Kimberly</b>	State <b>WI</b>	Zip Code <b>54136</b>

Consulting Firm Name (if applicable)

**McMahon Associates, Inc.**

Consulting Contact Person Name

**Brad Werner, P.E.**

Title

**Project Manager**

Area Code + Telephone Number

**920-751-4200**

Area Code + Fax Number

**920-751-4284**

E-Mail Address

**bwerner@mcmgrp.com**

Mailing Address - Street or Route

**1445 McMahon Drive**

City

**Neenah**

State

**WI**

Zip Code

**54956**

**DNR Use Only**

**Project Information**

**A. Project Name**

**Sunset Park Regional Detention Pond**

UNPS&SW Grant Project Name  
**Sunset Park Regional Detention Pond**

**Project Information (continued)**

**B. Location of Project Area**

County: **Outagamie**

Minor Civil Division (city, town, village, example: Wrightstown, Village of)	Town (N)	Range (E/W)	Section	Quarter	Quarter/ Quarter	Latitude (N)	Longitude (W)
<b>Kimberly, Village of</b>	<b>21</b>	<b>18E</b>	<b>29</b>	<b>NE</b>	<b>NW</b>	<b>44°16'24"</b>	<b>80°20'51"</b>

Method for Determining Latitude & Longitude (check one)

- GPS  
 DNR WebView or Surface Water Data Viewer  
 Other (specify):

**C. Project Summary and Description**

The proposed project is an urban wet detention pond retrofit to assist the Village of Kimberly in achieving NR 216 requirements of 20 and 40% TSS removal by the years 2008 and 2013. As part of the Village's Storm Water Mangement Plant, a total of eleven BMP's were analyzed to determine the most cost effective approach to achieving the NR 216 requirements in addition to street sweeping. The Sunset Park Pond was determined to be the most cost effective BMP for the Village and was also selected by the public as the most desired. The proposed project is a stream enlargement and is located within a wooded ravine. The Sunset Park Pond will provide TSS and phosphorus removal prior to discharge into the Fox River, a 303 (d) listed waterway. In addition, the proposed pond will provide a controlled access point to provide sediment removal prior to discharge into the Fox River. The pond is proposed to enhance the park and will be constructed to provide prairie grasses and additional wetlands in the Village of Kimberly. The Village involved Chapter 30, wildlife and fisheries staff early in the process to solicit their concerns and input to the project. Upon completion it is anticipated the pond will serve as an attractive educational amenity for the Village residents and visitors, as well as its primary job to improve water quality in the Fox River.

**D. Watershed & Waterbody (see Attachment A)**

Watershed Name <b>Plum and Kankapot Creek</b>	Watershed Code <b>LF03</b>	Primary Waterbody <b>Fox River</b>
--	-------------------------------	---------------------------------------

*Note: If the project is in more than one watershed, submit a separate application for each watershed, unless this application is for a high-efficiency street sweeper.*

Yes No

**E. Pro-rating for Existing versus New Development**

- Project will serve existing development only. If no, provide attachments and the following:  
 Percentage of design volume from existing development. (change default % if necessary)

**F. Request for Funding of Land Acquisition or Easements**

- Requesting funding for either land acquisition or purchase of easements as part of this application to support a structural urban best management practice (BMP). If yes, attach the property acquisition proposal, as defined in **Attachment G**, to the completed application form.

**G. Request for Retroactive Funding for Design**

UNPS&SW Program Construction Grant Application

CY 2008 Funding

Form 8700-299 (R 1/07)

Page 3 of 22

UNPS&SW Grant Project Name

Sunset Park Regional Detention Pond

**Project Information (continued)**

Requesting reimbursement for design costs that have been or will be incurred before issuance of the grant. See Instructions for required design approval process.

**H. Request for Funding Force Account Work**

Requesting reimbursement for technical services to be performed by governmental unit staff (force account).

**I. Endangered and Threatened Resources, Historic Properties and Wetlands**

Check "Yes" for any of the following the governmental unit knows to occur where the project disturbs land:

1. There are endangered or threatened resources, as identified in s. 29.604, Wis. Stats., and ch. NR 27 in the project area.

2. There are archaeological sites, historical structures, burial sites, or other historic places identified in s. 44.45, Wis. Stats., in the project area.

3. There are wetlands in the project area that are governed by water quality standard provisions of ch. NR 103 and for which mitigating measures should be taken to minimize the impacts.

**J. Environmental Contamination**

The applicant is aware that there is environmental contamination of the soil and/or groundwater or potential for contamination in the project area.

**K. Alternative Funding Possibility**

This applicant requests that the DNR also submit a copy of this application to the Clean Water Fund loan program.

UNPS&SW Grant Project Name  
**Sunset Park Regional Detention Pond**

**Part II. Screening Requirements**

Yes No **A. Map**  
  An 8.5" x 11" topographic map from USGS or the DNR viewers shoring the project area is attached.

**B. Best Management Practices (BMPs) For Which Funding Is Requested** (check all that apply)

- Detention Basin
- Wetland Basin
- Filtration Practice
- Infiltration Practice
- Property Acquisition – Fee Title
- Property Acquisition – Easement
- Accelerated or High-efficiency Street Sweeper
- Shoreline Habitat Restoration for Developed Areas
- Streambank/Shoreline Protection:
  - Rip-Rapping
  - Shaping and Seeding
  - Other Streambank/Shoreline Protection (including Bio-engineering) - specify below
- Other (specify):

(see **Attachment D** for additional BMP information)

**C. Filters**

*Note: The governmental unit must be able to answer "Yes" or "N/A" (Not Applicable), to each of the following to be eligible for a grant.*

- Yes No
- 1. Project is in an urban area as identified in **Attachment B**.
  - 2. Project will be completed within 24 months of the start of the grant period.
  - 3. Staff and contractors designated to work on this project have adequate training, knowledge, and experience to implement the proposed project.
  - 4. Staff or contractual services, in addition to those funded by this grant, will be provided if needed.
  - 5. Best management practices constructed under this grant will not work at cross-purposes to (are consistent with) non-agricultural performance standards under ch. NR 151. (see **Attachment E**)
  - 6. The local DNR Regional Nonpoint Source Coordinator (see **Attachment C**) has been contacted about this project.

Name of the Regional Nonpoint Source Coordinator Contacted	Date Contacted	Subject of Contact
<b>Richard Sachs</b>	<b>04/09/07</b>	<b>Sunset Pond / Permits / Public Support</b>

- 7. Construction Ordinance  
 Local regulations and/or intergovernmental agreements are in place, or will be developed prior to the end of the project period, to administer and enforce construction erosion controls in the governmental unit consistent with the non-agricultural performance standards in s. NR 151.11.
- 8. Post-Construction Ordinance  
 Local regulations and/or intergovernmental agreements are in place, or will be developed prior to the end of the project period, to administer and enforce post construction runoff from areas of new development and re-development in the governmental unit consistent with the non-agricultural performance standards in s. NR 151.12.

UNPS&SW Program Construction Grant Application

CY 2008 Funding

Form 8700-299 (R 1/07)

Page 5 of 22

UNPS&SW Grant Project Name  
**Sunset Park Regional Detention Pond**

**Part II: Screening Requirements (continued)**

Yes    No    NA

9. If this is an application to construct ponds in navigable streams or in wetlands, the necessary waterway or wetland permit (chs. 30 or 281, Wis. Stats.) has been received. If yes, give the docket number and date of issuance.

Docket Number	Date of Issuance
0239 L.F.	03/14/07
0240 L.F.	
0241 L.F.	
0242 L.F.	
0307 L.F.	

10. a. The grant application is for a local governmental unit having jurisdiction over the project area.
- b. The grant application is for a local governmental unit **not** having jurisdiction over the project area and both of the following conditions are met:
- The applicant is required to obtain a permit under subchapter I of ch. NR 216.
  - Inter-governmental agreements are in place, or will be put in place prior to the end of the project period, to assure urban best management practices included on the grant are installed and maintained (see **Attachment J**).

*Note: A governmental unit is considered to have jurisdiction over the project area if it has control over the construction or long-term maintenance.*

11. If the applicant is the University of Wisconsin Board of Regents, the project is for practices, techniques or measures to control storm water discharges on a University of Wisconsin System campus located in a municipality that meets both of the following criteria:
- is required to obtain a municipal storm water permit under ch. NR 216 and
  - is located either in a priority watershed or lake area identified under s. 281.65, Wis. Stats., or in an area of concern as identified by the International Joint Commission under the Great Lakes Water Quality Agreement.

**If the governmental unit answered "No" to any of the items in Question C above, stop here. This project is ineligible.**

**UNPS&SW Program Construction Grant Application**

**CY 2008 Funding**

Form 8700-299 (R 1/07)

Page 22 of 22

UNPS&SW Grant Project Name  
**Sunset Park Regional Detention Pond**

**Part II. Minimum Qualifications**

**Question 1. Fiscal Accountability**

**A. Timeline and Source of Staff**

For each applicable milestone listed below, fill in the appropriate data:

Milestone	Target Completion Date (month/year)	Source of Staff
Completion of design	08/2007	McMahon Associates / Village Staff
Obtaining required permits	07/2007	McMahon Associates / Village Staff / WDNR
Landowner contacts	N/A	
Bidding	01/2008	McMahon Associates / Village Staff
DNR approvals	02/2008	McMahon Associates / Village Staff / WDNR
Contract signing	03/2008	Village Staff / WDNR
BMP construction	07/2009	McMahon Associates / Village Staff / Contractor
Site inspection and certification	09/2009	McMahon Associates
Project evaluation	10/2009	McMahon Associates / Village Staff
Purchase street sweeper	N/A	
Other (specify)		

**B. Adequate Financial Budget**

Provide the following information for the project. The state share may not exceed 50% of eligible costs. The grant amount is capped at \$150,000 for the installation of eligible BMPs and \$50,000 for property acquisition.

**FINANCIAL BUDGET TABLE**

A	B	C
Project Activity for Which DNR Funding is Requested	Estimated Total Cost (\$)	Amount from Column B Eligible for DNR Cost Sharing (\$)
<b>Construction Components</b>		
Clearing & Grubbing (estimated at \$8k - \$10k per acre)	30,000	30,000
Box Culvert	40,000	40,000
Pond Excavation & Associated Work	201,900	201,900
42 Inch CMP	7,500	7,500
Medium Rip Rap	25,000	25,000
Erosion Control	18,650	18,650
Dewatering	1,000	1,000
Dust Control	1,000	1,000
Temporary Diversion Channel	32,040	32,040
Wetland & Prairie Grass	11,700	11,700
Trail	22,500	22,500
1. Construction Subtotal	\$391,290	\$441,290
2. Design	60,000	60,000
3. Storm Sewer Reroute	24,000	24,000
4. Structure Removal	0	0
5. Subtotal [add rows 1-4]	\$475,290	\$525,290
6. Property Acquisition: Fee, Title & Easement		

**UNPS&SW Program Construction Grant Application  
CY 2008 Funding**

Form 8700-299 (R 1/07)

Page 1 of 22

UNPS&SW Grant Project Name  
**Sunset Park Regional Detention Pond**

**Part II: Minimum Qualifications (continued)**

<b>7. Grand Total (add rows 5 &amp; 6)</b>	<b>\$475,290</b>	<b>\$525,290</b>
--	------------------	------------------

UNPS&SW Grant Project Name  
**Sunset Park Regional Detention Pond**

**Part II: Minimum Qualifications (continued)**

**Cost-Sharing Worksheet**

**Eligible Costs:**

Multiply the eligible costs (column C) by the percent for proration (if applicable) and the applicable cost-share rate. Enter the result in the column on the right.

	Prorate %	Cost-Share %	
8. Construction/Design	100%	50%	\$ 262,645
9. Property Acquisition	100%	50%	\$ 0
<b>Cap Test:</b>			
10. Construction/Design: Lesser of (8) or \$150,000			\$ 150,000
11. Property Acquisition: Lesser of (9) or \$50,000			\$ 0
12. Maximum State Share [(10)+(11)]			\$ 150,000
<b>State &amp; Local Share:</b>			
13. Requested State-Share Amount (Requested Grant Amount)			\$ 150,000
14. Local-Share Amount [Grand Total (7), column B less (13)]			\$ 325,290

Local-Share Source(s):

**The Village of Kimberly will fund this project through their Storm Water Utility.**

Method(s) Used to Calculate Cost Estimates:

**Estimates of probable cost were calculated from similar projects constructed in Northeast Wisconsin with quantities generated from the 90% complete design plans.**

**C. Cost-Effectiveness**

1. Tangible Benefits

a. Primary Benefit:

List the pollutants to be controlled by the project.

**The primary pollutants to be controlled by this project are TSS (Total Suspended Solids) and Phosphorus. These pollutants will be reduced prior to discharge into the Fox River by collecting all water from the developed upstream drainage basin.**

b. Secondary Benefits:

Select the following secondary benefits which will be achieved by implementing this project. (check all that apply)

- Fish and wildlife habitat enhancement
- Enhancements to recreation
- Public safety
- Economical operation, economical maintenance and enhanced life expectancy of the BMP
- Other (specify):

**The project will substantially reduce severe soil erosion in the project area which is currently negatively impacting the project area and also depositing large amounts of sediment at the discharge point to the Fox River.**

2. Cost-Effectiveness

Explain why the proposed project is cost-effective considering the environmental benefit(s) and cost of the project.



UNPS&SW Grant Project Name  
**Sunset Park Regional Detention Pond**

**Part II - Minimum Qualifications (continued)**

The Sunset Park Pond was proven to be the most cost-effective detention pond identified in the Village's Storm Water Management Plan. The detention pond will be designed in accordance with DNR Conservation Practice Standard 1001 and achieve a 52% reduction in TSS. Wet detention is also considered a cost effective method to control suspended solids and attached pollutants. The project will improve the current erosion problem in the project area including the stream immediately downstream and upstream of the pond. The pond has also received unanimous community support.

Yes No 3. Alternatives

a. There is more than one way to achieve the benefits checked above. If no, go to part b.

1) If **yes**, complete the following table with information for the alternative governmental unit have chosen and one or two other alternatives. Note that the table requires information about the cost and pollutant load/potential reductions.

Alternatives Analysis				
	A Alternative	B Cost	C Effectiveness	D
		Estimated Amount	Estimated % of Pollutant Load Reduction	(B ÷ C) Cost-Effectiveness
1	Sunset Park Pond Memorial Park Pond Stora Enso Pond Courtland Court Pond	\$ 1,600,000	40 %	4,000,000
2	Memorial Park Pond Stora Enso Pond Courtland Court Pond Business Park Pond, Option 1 Kimberly Avenue Pond Crane Engineering Pond	\$ 1,800,000	40 %	4,500,000
3	Memorial Park Pond Stora Enso Pond Courtland Court Pond Business Park Pond, Option 2	\$ 1,900,000	43 %	4,418,605

2) If the governmental unit is not choosing the alternative with the lowest ratio of cost to pollutant load/potential reductions, explain why it was not chosen in terms of any of the following: feasibility; secondary benefits potential; or other mitigating factors.

N/A

b. If the answer to part 3.a. was **no**, explain why there is no other reasonable alternative to achieve the reduction in pollutant loading/potential or the secondary benefits checked above.

UNPS&SW Program Construction Grant Application

CY 2008 Funding

Form 8700-299 (R 1/07)

UNPS&SW Grant Project Name <b>Sunset Park Regional Detention Pond</b>
--

**Part II. Minimum Qualifications (continued)**

Pre- and post-project evaluation measures used to ensure success in meeting project goals.

**A. Modeling & Measures of Change**

The applicant must agree to provide a description of the modeled results or changes in pollution potential in the final project report. The project evaluation strategy will be based on comparing pre- and post-project changes in modeled pollutant loading to water resources or will be based on the quantity of units managed.

Check all that apply in the table below.

	Priority for Developed Urban Area	Units of Measure	Recommended Measurement Method
<input checked="" type="checkbox"/>	20-40% Reduction in TSS	Pounds TSS reduced % TSS reduction	SLAMM, P-8
<input type="checkbox"/>	Infiltration	% Pre-development stay-on volume Cubic feet stay-on volume	Recarga, SLAMM, P-8
<input type="checkbox"/>	Peak flow discharge	Change in cubic feet per second	TR-55 or equivalent
<input type="checkbox"/>	Protective areas	Feet of bank protected	count
<input type="checkbox"/>	Fueling & maintenance areas	Oily sheen presence	visual assessment
<input type="checkbox"/>	Streambank	Tons of bank erosion reduced Feet of bank protected	NRCS bank erosion formula count
<input type="checkbox"/>	Other (specify)		

Yes No **B. Monitoring** (not eligible for cost sharing at this time)

- The project evaluation strategy will provide pre- and post-project information from water quality monitoring. If yes, check all that apply below.
- The project will evaluate the physical habitat, fisheries, biological, or chemical conditions, including temperature and coliform bacteria.
- A one-page summary of the monitoring strategy is attached.

**C. Additional Monitoring**

- The applicant is willing to participate with the Department to do monitoring in the project area should cost sharing become available.

**Question 3. Evidence of Local Support**

The level of local support that currently exists for the proposed project.

Yes No **A. Government**

1. a. The local-share funds for the construction/installation expenses are already included specifically in an adopted budget.
- b. The local-share funds for the construction/installation expenses are or will be included in a proposed budget.
2. The governmental unit has already conducted public information activities within the project area for this practice.

If yes, provide details regarding the nature of the opportunity for public reaction the governmental unit provided and indicate the general public support or non-support for the project that was indicated.

(See attached summary.)

**B. Landowners**

1. The governmental unit:
- a. already owns, or holds an easement for, the land on which the project is to be installed.
- b. is submitting with the application a list of landowners, occupants, or tenants that occupy the property and information indicating each party's willingness to sell or ease the necessary parcel.

UNPS&SW Grant Project Name  
Sunset Park Regional Detention Pond

Part II. Minimum Qualifications (continued)

2. Evidence is attached of **citizen** (non-governmental) support for the project (such as letters from the neighborhood association, a civic group or an environmental organization).

Question 4. Basin Priorities (check one)

- A. Clean Water Act s. 303(d) List of Impaired Waters**  
Project with water quality goals directly dealing with a waterbody (lake or stream) on the latest Clean Water Act (CWA) s. 303(d) List of impaired waters, where the cause of the water quality impairment is nonpoint source pollution, and the project will reduce the type of nonpoint source pollutants for which the water is listed.
- B. Outstanding and Exceptional Resource Waters**  
Waterbody is included in s. NR 102.10 (Outstanding Resource Waters) and/or s. NR 102.11 (Exceptional Resource Waters).
- C. NPS Rankings**  
Project is located in a large-scale watershed, a small-scale watershed, lake watershed, or other area ranked high or medium on the NPS Rankings List, where the goals of the project are directly associated with the reason for the ranking on the NPS Rankings List.
- D. Amendment of the NPS Rankings List Using State of the Basin Reports**  
Project is located within a watershed ranked low or not ranked on the NPS Rankings List, but information in a DNR State of the Basin report indicates a need to amend the NPS Rankings List because the stream or stream segment or lake is being affected by nonpoint sources of pollution.
- E. Amendment of the NPS Rankings List Using Other Data Sources**  
Project is located within a watershed ranked low or not ranked on the NPS Rankings List, but adequate data exists to request a ranking of high or medium for a waterbody that is being affected by nonpoint sources of pollution.
- F. Sources of Information for Areas Not Included in State of the Basin Reports**  
For some border waters, there is no State of the Basin report (i.e., along the Mississippi River or the Great Lakes). For these situations, another governmental document, accepted by the Regional NPS Coordinator, can be used to classify the resource as having a significant nonpoint source pollution impairment.
- G. Not Included in Other Categories Above**

UNPS&SW Grant Project Name <b>Sunset Park Regional Detention Pond</b>
--

**Part III. Competitive Elements**

**Question 5. Water Quality Needs**

The water quality category which best identifies the water quality goals for the project directly deals with: (check one)

*Note: For border waters where a State of the Basin Report does not exist, another governmental document acceptable to the Regional Nonpoint Source Coordinator may be used to identify the water quality need.*

**Surface Water Considerations**

- A. 303(d) Listed Waterbody**  
A waterbody (lake or stream) on the latest Clean Water Act (CWA) s. 303(d) List of impaired waters, where the cause of the water quality impairment is nonpoint source pollution, and the project will reduce the type of nonpoint source pollutants for which the water is listed.
- B. Not Fully Meeting Uses**  
A waterbody (lake or stream) identified in a DNR State of the Basin report as not meeting or partially meeting designated uses due to nonpoint sources, but is not on the 303(d) List.
- C. Threatened Waterbody**  
A waterbody (lake or stream) viewed as "threatened" by nonpoint sources in a DNR State of the Basin report.
- D. Outstanding or Exceptional Resource Waters**  
Prevention of degradation due to nonpoint sources of outstanding or exceptional resource waters or high quality, recreationally significant waters, but not including waters listed as "threatened."
- E. Surface Water Quality**  
Prevention of surface water quality degradation due to nonpoint sources. Waters in this category are neither high quality, recreationally significant waters nor "threatened" waters.

**Groundwater Considerations\***

- F. Exceeds Groundwater Enforcement Standard**  
Groundwater within the project area where representative information indicates that stormwater pollutants in groundwater exceed the Enforcement Standard (ES).
- G. Groundwater Quality (see Attachment H)**  
The project area is within a geological area defined in Attachment H as susceptible to groundwater contamination.
- H. Exceeds Groundwater Preventive Action Limit**  
Groundwater within the project area where representative information indicates that stormwater pollutants in groundwater exceed Preventative Action Limits (PAL).

\*Consult the Regional Drinking Water and Groundwater Specialist or the County Extension office.

**Bonus Points (see Attachment F):**

Yes No

- Water quality goals relate to the control of nonpoint source contaminants in public drinking water supplies.
  - 1. If yes, and the source of drinking water affected by the project area is groundwater, the project protects:
    - a. One wellhead
    - OR
    - b. More than one wellhead
  - 2. If yes, and the source of drinking water affected by the project area is surface water, check the source water assessment area in which the project is located:
 

<input type="checkbox"/> Pike River & Creek	<input type="checkbox"/> Twin Rivers
<input type="checkbox"/> Root River	<input type="checkbox"/> Kewaunee & Ahnapee
<input type="checkbox"/> Oak Creek	<input type="checkbox"/> Menominee River
<input type="checkbox"/> Milwaukee River	<input type="checkbox"/> Fish Creek
<input type="checkbox"/> Sauk Creek	<input type="checkbox"/> St. Louis & Nemadji River
<input type="checkbox"/> Sheboygan & Onion Rivers	<input type="checkbox"/> Lake Winnebago
<input type="checkbox"/> Manitowoc River	

UNPS&SW Grant Project Name  
**Sunset Park Regional Detention Pond**

**Part III - Competitive Elements (continued)**

**Question 6: Extent of Pollutant Control**

Yes No **A. NR 151 Performance Standard for Total Suspended Solids**  
  This project focuses on controlling total suspended solids (TSS) in urban runoff that enters waters of the state. Only check "Yes" if the area is covered by an NR 216 permit.

**B. Other Water Resources Management Priority**  
 The proposed project addresses a water resources management priority other than the NR 151 performance standard in part A above.  
 If yes, describe the priority and how the project addresses this priority.  
**This project will address stream bank erosion. Currently this section of stream proposed is suffering severe erosion problems. Construction of the pond will eliminate these severe problems through incorporation into the pond and restabilization of eroding slopes adjacent to the pond. The stream channels directly upstream and downstream of the pond will also be stabilized. The impact of current erosion can be seen in the photograph of the soil plume on Page\_\_.**

**C. Planning Data & Source Targeting**  
 The applicant has quantitative planning information that ranks pollution sources from highest to lowest in severity and the proposed project will manage a pollution source contained in the top 50% of the ranked list. If yes, provide:

- a. Description of planning data  
**SLAMM modeling for the Village of Kimberly.**
- b. Name of document(s)  
**Village of Kimberly Storm Water Management Plan**
- c. Date(s) published  
**Draft form awaiting final submittal to DNR.**
- d. Pertinent page numbers  
**N/A**
- e. A copy of non-state document(s) is available: (check all that apply)
  - At this website: http://
  - Attached to this application form.
  - Contact this person: Name: **Steve Rosenbeck** Phone: **920-751-4200**

**Question 7: Consistency with Resource Management Plans & Supporting Regulations**

Yes No **A. Consistency with Resource Management Plans**  
  The project implements a water quality recommendation from a locally approved resource management plan.  
 Summarize the water quality recommendation. Cite the name and date(s) of publication of the document.  
**This project is the most critical and highest priority ranking in the Village's Storm Water Management Plan as it provides 52% TSS removal covering of the Village.**

**B. Supporting Regulations**  
 The project is located within an area which has:

- 1. One or more regulations that implement the non-agricultural performance standards for developed urban areas under s. NR 151.13.
- 2. Other regulations designed to reduce the impact on water quality from new development, other than construction site erosion control or a storm water ordinance.  
 Describe in relation to the goals of the project.

**UNPS&SW Program Construction Grant Application**

**CY 2008 Funding**

Form 8700-299 (R 1/07)

Page 14 of 22

UNPS&SW Grant Project Name

**Sunset Park Regional Detention Pond**

**Part III. Competitive Elements (continued)**

**Question 8. Use of Additional Funding**

Yes    No    NA

   A. The project is for construction or design and the state share is below the \$150,000 cap.

   B. The project includes property acquisition and the state share is below the \$50,000 cap.

   C. Funding requested is below the 50% cost-share rate.

**Question 9. City of Racine**

Yes    No

   This is an application from the City of Racine for a project that is necessary for the city to comply with state storm water permitting requirements.

UNPS&SW Grant Project Name  
Sunset Park Regional Detention Pond

#### Part IV. Eligibility for Multipliers

Completion of this part of the application is optional. However, an applicant can increase the final project score by qualifying for a project multiplier.

##### Local Implementation Program

- | Yes                                 | No                       | NA                                  |  |
|-------------------------------------|--------------------------|-------------------------------------|--|
| <input checked="" type="checkbox"/> | <input type="checkbox"/> |                                     | A. The governmental unit is implementing a pollution prevention information and education program targeted for property owners and other residents.  |
| <input type="checkbox"/>            | <input type="checkbox"/> | <input checked="" type="checkbox"/> | B. The governmental unit is implementing a nutrient management plan for municipally owned properties of at least five acres of pervious area where nutrients are applied.  |
| <input checked="" type="checkbox"/> | <input type="checkbox"/> |                                     | C. The governmental unit is implementing a tracking of storm water permitting activity (construction and post-construction) in the governmental unit and can make summary information available to the DNR upon request. |

#### Optional Additional Information

Carefully review the answers to all of the questions above. Is there additional information that will add to the understanding of this project? If so, describe here.

#### Applicant Certification

An Authorized Representative must sign and date the application form prior to submittal to the DNR. All four copies must include signatures of the Authorized Representative.

I certify that, to the best of my knowledge, the information contained in this application and attachments is correct and true.

Signature of Authorized Representative

Date Signed



4/16/07

**Rick Hermus** Village Administrator

*[name and title]*

Telephone Number 920-788-7500

Fax Number 920-788-9723

E-Mail Address rhermus@vokimberly.org

Mailing Address 515 West Kimberly Avenue Kimberly WI 54136

To be considered for funding, provide the following for each application submitted:

- One copy of the completed application form (DNR Form 8700-299 (R 1/07) with original signature in blue ink;
- Three additional copies of the completed, signed application form;
- One electronic copy of the completed application form on CD or diskette.

All application materials must be postmarked by midnight **April 16, 2007**.

Mail to: Department of Natural Resources  
Attn: Kathy Thompson, WT/2  
P.O. Box 7921  
Madison, WI 53707-7921



A. Map

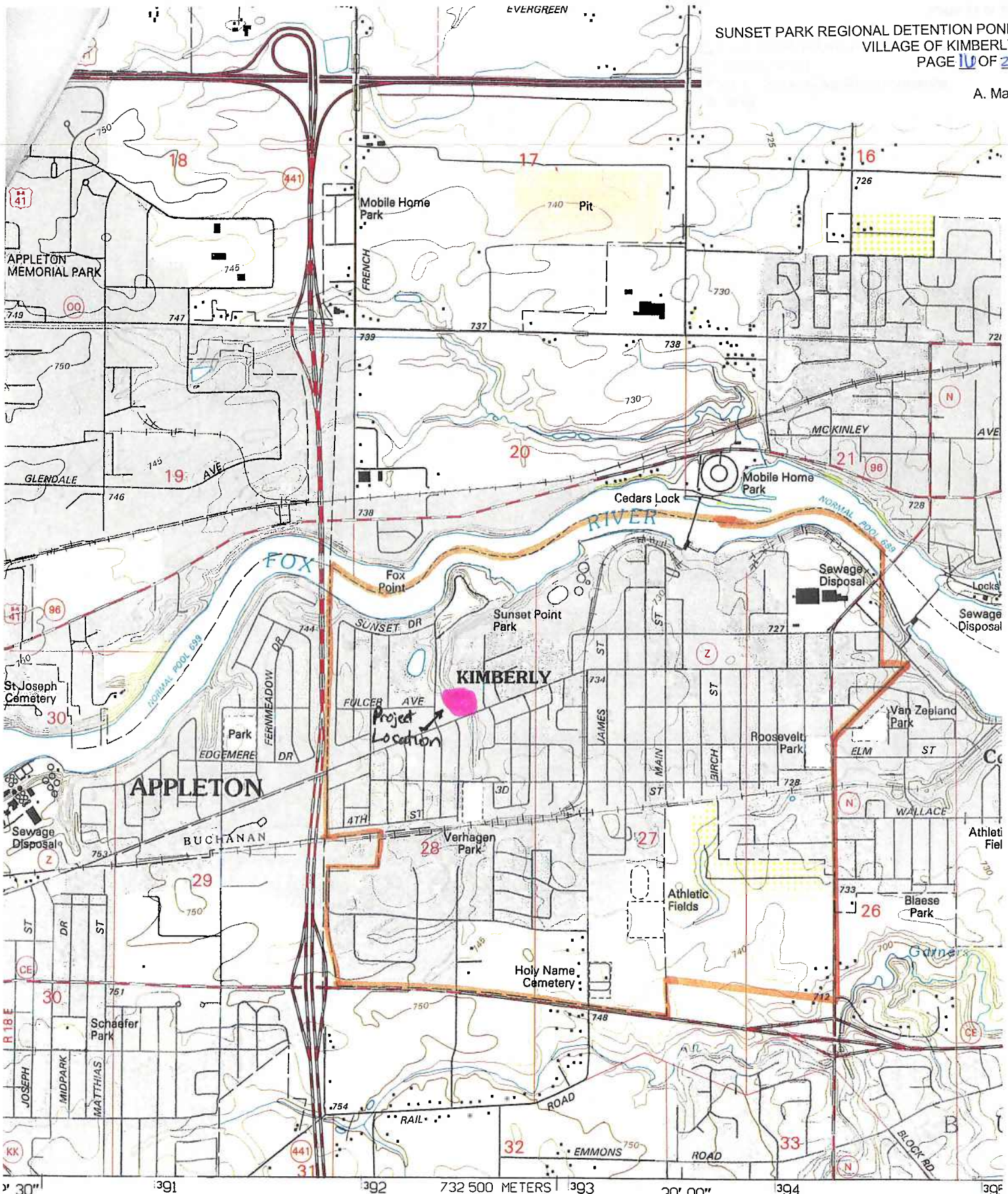

Produced by the United States Geological Survey

Compiled from imagery dated 1973. Revised from imagery dated 1992. PLSS and survey control current as of 1974. Contours and elevations current as of 1973. Map edited 1995

North American Datum of 1983 (NAD 83). Projection and scale 1000-meter ticks: Universal Transverse Mercator, zone 16  
 500-meter ticks: Wisconsin Coordinate System of 1983 (central zone)

North American Datum of 1927 (NAD 27) is shown by dashed corner ticks. The values of the shift between NAD 83 and NAD 27 at 7.5-minute intersections are obtainable from National Geodetic

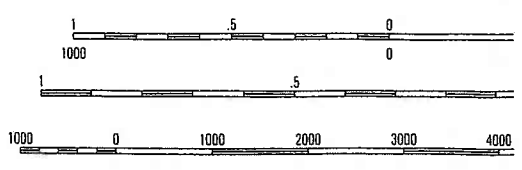
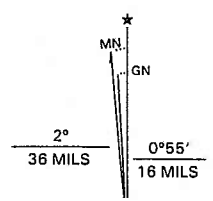

SCALE



Question 3. Evidence of Local Support

- A.2. The governmental unit has already conducted public information activities within the project area for this practice.

The Village of Kimberly has conducted information sessions with key community groups to determine if public support exists for this project. The process began with discussion of a potential detention pond options available in the Village at public meetings. These meetings educated the Village Board and the public on the requirements on NR 216 and the potential projects the Village may need to undertake to meet the requirements of the 20/40% TSS removal requirement. Two local newspapers provide press coverage of the local meeting and have printed articles on these public meeting discussions. Public support for this project was further demonstrated when the Village presented this same information to the key community groups. At the conclusion the groups were asked to rank the ponds shown on the plan in their order of preference. The Sunset Park Pond was the first choice of all groups as shown in the following table.

Question 3. Evidence of Local Support  
 A.2. The governmental unit has already conducted public information activities within the project area for this practice.

Storm Water Detention Pond Ranking Matrix

Cost/ Pound	Pond Location	Ranking											Net Ranking		
		Engineer	Village Board	Village Staff	Fire Fighters	Citizens	Business Leaders	Street Crew	KRA Board	High School	Composite Ranking				
\$18.40	Sunset Pont	1	1	1	1	1	1	1	1	1	1	1	1	9	1
\$18.90	Cortland Court	2	2	2	3	2	2	3	3	2	2	3	2	21	2
\$19.60	Business Park #1	3	4	8	8	6	5	5	4	5	5	4	5	48	4
\$23.40	Business Park #2	4	8	9	5	7	3	4	2	8	4	2	8	50	5
\$29.70	Memorial Park	5	3	11	2	3	4	2	5	3	2	5	3	38	3
\$30.10	Valley Cast	6	10	7	6	4	7	6	6	9	6	6	9	61	7
\$36.90	Crane Pond	7	11	10	11	9	8	9	7	12	9	7	12	84	11
\$38.80	Stora Enso	8	6	4	9	5	6	7	8	7	7	8	7	60	6
\$54.90	Kimberly Avenue	9	9	6	7	8	11	8	9	6	8	9	6	73	9
\$58.30	Park Villas	10	5	3	4	10	9	10	10	10	10	10	10	71	8
\$77.80	Imery's	11	7	5	10	11	10	11	11	4	11	11	4	80	10
\$95.70	Washington St.	12	12	12	12	12	12	12	12	11	12	12	11	107	12

<RA = Kimberly Recreation Association



...in the 1000 Islands Conservancy Area of the Lower Fox River.

1000 Beaulieu Court      Kaukauna, WI 54130  
920-766-4733 • Fax 920-766-6321  
E-mail: thousandisland@new.rr.com

April 11, 2007

Mr. Rick Hermus  
Village of Kimberly  
515 West Kimberly Avenue  
Kimberly, WI 54136

Re:    Village of Kimberly  
      Sunset Park Pond

Dear Rick:

As a representative of the 1000 Island Nature Center I am writing this letter in support of the Sunset Pond project. In March 2006, the Village of Kimberly educated me on the new storm water regulations enacted by the Wisconsin Department of Natural Resources (DNR) and the permit requirements the Village of Kimberly is required to comply with between now and 2013.

The Village's options to meet the requirements of the regulations were presented which included several potential detention pond sites. I remain committed that the Sunset Park Pond is the best and most desired location for a detention pond. I understand that every community contributes pollutant storm water to the Fox River and I fully support the enhancement of this important natural resource.

I fully support this project as it benefits us as well as the greater Fox River community we are a part of.

Sincerely,

A handwritten signature in black ink that reads "Lee W. Hammen". The signature is written in a cursive style with a long, sweeping underline.

Lee W. Hammen  
Naturalist/Administrator

# KIMBERLY AREA SCHOOL DISTRICT

3. Evidence of Local Support

Mel E. Lightner, Ph.D.  
Superintendent

Robert S. Mayfield  
Assistant Superintendent

Gary M. Kvasnica  
Director of Business Services

Denise Weyenberg  
Director of Human Resources



217 EAST KIMBERLY AVENUE  
KIMBERLY WISCONSIN 54136

(920) 788-7900  
FAX (920) 788-7919

[www.kimberly.k12.wi.us](http://www.kimberly.k12.wi.us)

April 12, 2007

Mr. Rick Hermus  
Village of Kimberly  
515 West Kimberly Avenue  
Kimberly, WI 54136

Re: Village of Kimberly  
Sunset Park Pond

Dear Rick:

The Kimberly Area School District is writing this letter in support of the Sunset Pond project for the Village of Kimberly. In March, 2006, the Village of Kimberly educated the Kimberly High School Earth Science Class on the new storm water regulations enacted by the Wisconsin Department of Natural Resources (DNR) and the permit requirements the Village of Kimberly is required to comply with between now and 2013.

The Village's options to meet the requirements of the regulations were presented which included several potential detention pond sites. The Class and I remain committed that the Sunset Park Pond is the best and most desired location for a detention pond. I understand that every community contributes pollutant storm water to the Fox River and I fully support the enhancement of this important natural resource.

I fully support this project as it benefits the Kimberly Area School District as well as the greater community we are a part of.

Sincerely,

A handwritten signature in black ink, appearing to read "Mel Lightner".

Mel Lightner, Ph.D.  
Superintendent of Schools

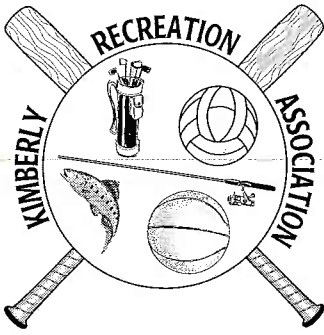

# Kimberly Recreation Association

515 W. Kimberly Avenue, Kimberly, WI 54136

---

April 11, 2007

Mr. Rick Hermus  
Village of Kimberly  
515 West Kimberly Avenue  
Kimberly, WI 54136

Re: Village of Kimberly  
Sunset Park Pond

Dear Rick:

The Kimberly Recreation Association is writing this letter in support of the Sunset Pond project. On March 12, 2006, the Village of Kimberly educated the KRA Board of Directors on the new storm water regulations enacted by the Wisconsin Department of Natural Resources (DNR) and the permit requirements the Village of Kimberly is required to comply with between now and 2013.

The Village's options to meet the requirements of the regulations were presented which included several potential detention pond sites. The KRA Board Members individually and collectively ranked the Sunset Park Pond as the best and most desired location for a detention pond. We understand that our organization contributes pollutant storm water to the Fox River and fully support the enhancement of this important natural resource.

We fully support this project as it benefits us as well as the community we are a part of.

Sincerely,

Bill Kroner  
KRA President



P.O. Box 26 - Kimberly, WI 54136 • Phone: 788-9804

April 11, 2007

Mr. Rick Hermus  
Village of Kimberly  
515 West Kimberly Avenue  
Kimberly, WI 54136

Re: Village of Kimberly  
Sunset Park Pond

Dear Rick:

I am writing on behalf of the Kimberly Area Businessmen in support of the Sunset Pond project. On March 1, 2006, the Village of Kimberly educated the business community on the new storm water regulations enacted by the Wisconsin Department of Natural Resources (DNR) and the permit requirements the Village of Kimberly is required to comply with between now and 2013.

The Village's options to meet the requirements of the regulations were presented which included several potential detention pond sites. The business leaders ranked the Sunset Park Pond as the best and most desired location for a detention pond. As business leaders, we understand that our organizations contribute pollutant storm water to the Fox River and fully support the enhancement of this important natural resource. It is very difficult to find suitable sites for storm water detention within developed and established areas. We are fortunate to have the Sunset Park Pond location available. Locating the Pond at the Sunset Park site not only aids the Village in complying with the new regulations, but also will enhance the natural beauty of this magnificent park.

We fully support this project as it benefits us as well as the community we are a part of.

Sincerely,

A handwritten signature in black ink that reads "Al Lamers". The signature is written in a cursive style with a large, stylized initial "A".

Al Lamers  
President  
Lamers Realty Inc.

