

Notice: Application is hereby made to the Wisconsin Department of Natural Resources, Bureau of Watershed Management for grant assistance consistent with s. 281.66, Wis. Stats., and Chapter NR 155, Wis. Adm. Code. Collection of this information is authorized under the authority of s. 281.66, Wis. Stats. The information contained in this form will be used for program budget analysis and project evaluation in the Urban Nonpoint Source Water Pollution Abatement and Storm Water Management Grant Program. Personally identifiable information collected will be used for program administration and may be made available to requesters as required under Wisconsin's Open Records Law [ss. 19.31 - 19.39, Wis. Stats.]. *Unless otherwise noted, all citations refer to Wisconsin Administrative Code.*

Instructions: Complete all sections as applicable.

Applicant Information

Governmental Unit Applying: (name & type) (example: Madison, Town of)

Little Chute, Village of

Name of Authorized Representative (First, Last) Charles P. Kell			Name of Governmental Contact Person (First, Last) (if different) Roy Van Gheem, PE		
Title Village Administrator			Title Director of Public Works		
Area Code + Telephone Number (920) 788-7380			Area Code + Telephone Number (920) 788-7395		
Area Code + Fax Number (920) 788-7394			Area Code + Fax Number (920) 788-7820		
E-Mail Address chuck@littlechutewi.org			E-Mail Address roy@littlechutepw.org		
Mailing Address - Street or Route 108 W. Main Street			Mailing Address - Street or Route 1940 Buchanan Road		
City Little Chute	State WI	Zip Code 54140	City Little Chute	State WI	Zip Code 54140

Consulting Firm Name (if applicable)

McMahon Associates, Inc.

Consulting Contact Person Name

Nick Vande Hey, PE

Title

Project Engineer

Area Code + Telephone Number

(920) 751-4200

Area Code + Fax Number

(920) 751-4284

E-Mail Address

nvandehey@mcmgrp.com

Mailing Address - Street or Route

1445 McMahon Drive, PO Box 1025

City

Neenah

State

WI

Zip Code

54957

DNR Use Only

Project Information

A. Project Name

Ebben Pond

This document was drafted by the Department of Natural Resources.

UNPS&SW Grant Project Name
Ebben Pond

Project Information (continued)

B. Location of Project Area

County: Outagamie

Minor Civil Division (city, town, village, example: Wrightstown, Village of)	Town (N)	Range (E/W)	Section	Quarter	Quarter/ Quarter	Latitude (N)	Longitude (W)
Village of Little Chute	21	18 E	10	SW	SW, SE	44 18' 9"	88 18' 25"
Village of Little Chute	21	18 E	15	NW	All	44 17' 55"	88 18' 31"
Village of Little Chute	21	18 E	16	NE	NE, SE	44 17' 29"	88 18' 40"

Method for Determining Latitude & Longitude (check one)

- GPS
 DNR WebView or Surface Water Data Viewer
 Other (specify):

C. Project Summary and Description

The Village of Little Chute desires to construct the Ebben Pond. The proposed Ebben Pond is a wet extended detention pond. The proposed Ebben Pond is to be located north of Evergreen Drive, west of Buchanan Road, and east of CTH 'N'. The purpose of the Ebben Pond project is to reduce non-point source pollution prior to discharge into the Village's municipal separate storm sewer system (MS4) and ultimately Apple Creek. The project will also assist the Village with future NR 216 / WPDES Municipal Permit compliance and NR 151.13 requirements.

Specific water quality goals for Ebben Pond and it's 146 acre drainage area include an > 80% reduction in total suspended solids, 60% reduction in phosphorus, and 70% reduction in lead. The pollutant reduction goals are achievable based upon SLAMM modeling and Wet Detention Basin (Code 1001). The 146 acre watershed includes commercial, industrial, institutional, USH '41' freeway, CTH 'N' arterial highway, and residential source areas.

Apple Creek is a 303(d) listed water body that is impaired by non-point source pollution, particularly sediment and phosphorus. The Nonpoint Source Control Plan for the Duck, Apple and Ashwaubenon Creeks Priority Watershed Project (PUBL WT-493-97) recommends a reduction in sediment and phosphorus reaching Apple Creek. The plan also recommends public education and construction site erosion control ordinances.

The Village plans to use the Ebben Pond project as an opportunity to educate property owners about non-point source pollution and its impacts on Apple Creek water quality. The Village hopes to modify human behavior, improve watershed stewardship, and raise overall public awareness about non-point source pollution impacts. Public education is anticipated to further reduce non-point source pollution and phosphorus loads discharged into Apple Creek as compared to merely constructing the Ebben Pond.

The Ebben Pond watershed contains several stormwater hotspots including a gas station, parking lots, loading / unloading areas, freeways, and highways. These hot spots provide additional justification for the Ebben Pond.

The Village of Little Chute recently purchased the Ebben Pond property. The Village plans to own, operate and maintain the Ebben Pond after the construction project is complete.

D. Watershed & Waterbody (see Attachment A)

Watershed Name Apple & Ashwaubenon Creeks	Watershed Code LF02-113	Primary Waterbody Apple Creek
---	-----------------------------------	---

Note: If the project is in more than one watershed, submit a separate application for each watershed, unless this application is for a high-efficiency street sweeper.

Yes No

E. Pro-rating for Existing versus New Development

- Project will serve existing development only. If no, provide attachments and the following:

Percentage of design volume from existing development. (change default % if necessary)

UNPS&SW Grant Project Name Ebben Pond

Project Information (continued)

- F. Request for Funding of Land Acquisition or Easements**
- Requesting funding for either land acquisition or purchase of easements as part of this application to support a structural urban best management practice (BMP). If yes, attach the property acquisition proposal, as defined in **Attachment G**, to the completed application form.
- G. Request for Retroactive Funding for Design**
- Requesting reimbursement for design costs that have been or will be incurred before issuance of the grant. See Instructions for required design approval process.
- H. Request for Funding Force Account Work**
- Requesting reimbursement for technical services to be performed by governmental unit staff (force account).
- I. Endangered and Threatened Resources, Historic Properties and Wetlands**
- Check "Yes" for any of the following the governmental unit knows to occur where the project disturbs land:
1. There are endangered or threatened resources, as identified in s. 29.604, Wis. Stats., and ch. NR 27 in the project area.
2. There are archaeological sites, historical structures, burial sites, or other historic places identified in s. 44.45, Wis. Stats., in the project area.
3. There are wetlands in the project area that are governed by water quality standard provisions of ch. NR 103 and for which mitigating measures should be taken to minimize the impacts.
- J. Environmental Contamination**
- The applicant is aware that there is environmental contamination of the soil and/or groundwater or potential for contamination in the project area.
- K. Alternative Funding Possibility**
- This applicant requests that the DNR also submit a copy of this application to the Clean Water Fund loan program.

UNPS&SW Grant Project Name
Ebben Pond

Part I. Screening Requirements

Yes **No** **A. Map**
 An 8.5" x 11" topographic map from USGS or the DNR viewers shoring the project area is attached.

B. Best Management Practices (BMPs) For Which Funding Is Requested (check all that apply)

- Detention Basin
- Wetland Basin
- Filtration Practice
- Infiltration Practice
- Property Acquisition – Fee Title
- Property Acquisition – Easement
- Accelerated or High-efficiency Street Sweeper
- Shoreline Habitat Restoration for Developed Areas
- Streambank/Shoreline Protection:
 - Rip-Rapping
 - Shaping and Seeding
 - Other Streambank/Shoreline Protection (including Bio-engineering) - specify below
- Other (specify):

(see Attachment D for additional BMP information)

C. Filters

Note: The governmental unit must be able to answer "Yes" or "N/A" (Not Applicable), to each of the following to be eligible for a grant.

- Yes** **No**
1. Project is in an urban area as identified in Attachment B.
 2. Project will be completed within 24 months of the start of the grant period.
 3. Staff and contractors designated to work on this project have adequate training, knowledge, and experience to implement the proposed project.
 4. Staff or contractual services, in addition to those funded by this grant, will be provided if needed.
 5. Best management practices constructed under this grant will not work at cross-purposes to (are consistent with) non-agricultural performance standards under ch. NR 151. (see Attachment E)
 6. The local DNR Regional Nonpoint Source Coordinator (see Attachment C) has been contacted about this project.

Name of the Regional Nonpoint Source Coordinator Contacted	Date Contacted	Subject of Contact
Richard Sachs & John Young	Feb 21, 2007	Overview, EHA, Land Acquisition

7. Construction Ordinance
 Local regulations and/or intergovernmental agreements are in place, or will be developed prior to the end of the project period, to administer and enforce construction erosion controls in the governmental unit consistent with the non-agricultural performance standards in s. NR 151.11.
8. Post-Construction Ordinance
 Local regulations and/or intergovernmental agreements are in place, or will be developed prior to the end of the project period, to administer and enforce post construction runoff from areas of new development and re-development in the governmental unit consistent with the non-agricultural performance standards in s. NR 151.12.

**UNPS&SW Program Construction Grant Application
CY 2008 Funding**

Form 8700-299 (R 1/07)

Page 5 of 37

UNPS&SW Grant Project Name
Ebben Pond

Part I. Screening Requirements (continued)

- | Yes | No | NA | | | |
|--|---|-------------------------------------|--|--|---|
| <input checked="" type="checkbox"/> | <input type="checkbox"/> | <input type="checkbox"/> | <p>9. If this is an application to construct ponds in navigable streams or in wetlands, the necessary waterway or wetland permit (chs. 30 or 281, Wis. Stats.) has been received. If yes, give the docket number and date of issuance.</p> <table border="1" style="width: 100%; border-collapse: collapse;"> <tr> <td style="width: 60%;">Docket Number
IP-NE-2005-45-0307LF to 0312LF</td> <td style="width: 40%;">Date of Issuance
Sept. 28, 2006</td> </tr> </table> | Docket Number
IP-NE-2005-45-0307LF to 0312LF | Date of Issuance
Sept. 28, 2006 |
| Docket Number
IP-NE-2005-45-0307LF to 0312LF | Date of Issuance
Sept. 28, 2006 | | | | |
| <input checked="" type="checkbox"/> | <input type="checkbox"/> | <input type="checkbox"/> | <p>10. a. The grant application is for a local governmental unit having jurisdiction over the project area.</p> <p><input type="checkbox"/> b. The grant application is for a local governmental unit not having jurisdiction over the project area and <u>both</u> of the following conditions are met:</p> <ul style="list-style-type: none"> • The applicant is required to obtain a permit under subchapter I of ch. NR 216. • Inter-governmental agreements are in place, or will be put in place prior to the end of the project period, to assure urban best management practices included on the grant are installed and maintained (see Attachment J). <p><i>Note: A governmental unit is considered to have jurisdiction over the project area if it has control over the construction or long-term maintenance.</i></p> | | |
| <input type="checkbox"/> | <input type="checkbox"/> | <input checked="" type="checkbox"/> | <p>11. If the applicant is the University of Wisconsin Board of Regents, the project is for practices, techniques or measures to control storm water discharges on a University of Wisconsin System campus located in a municipality that meets <u>both</u> of the following criteria:</p> <ul style="list-style-type: none"> • is required to obtain a municipal storm water permit under ch. NR 216 <u>and</u> • is located either in a priority watershed or lake area identified under s. 281.65, Wis. Stats., or in an area of concern as identified by the International Joint Commission under the Great Lakes Water Quality Agreement. | | |

If the governmental unit answered "No" to any of the items in Question C above, stop here. This project is ineligible.

UNPS&SW Grant Project Name
 Ebben Pond

Part II. Minimum Qualifications

Question 1. Fiscal Accountability

A. Timeline and Source of Staff

For each applicable milestone listed below, fill in the appropriate data:

Milestone	Target Completion Date (month/year)	Source of Staff
Completion of design	6/08	Consultant
Obtaining required permits	9/08	Consultant, Village Staff, DNR
Landowner contacts	3/08	Village Staff & Consultant
Bidding	1/09	Consultant & Village Staff
DNR approvals	12/08	DNR, Consultant, Village Staff
Contract signing	3/09	Contractor, Village Staff, & Consultant
BMP construction	6-10/09	Contractor
Site inspection and certification	10/09	Consultant, Village Staff, & Contractor
Project evaluation	11/09	Consultant, Village Staff
Purchase street sweeper		
Other (specify)		

B. Adequate Financial Budget

Provide the following information for the project. The state share may not exceed 50% of eligible costs. The grant amount is capped at \$150,000 for the installation of eligible BMPs and \$50,000 for property acquisition.

FINANCIAL BUDGET TABLE

A	B	C
Project Activity for Which <u>DNR Funding</u> is Requested	Estimated Total Cost (\$)	Amount from Column B Eligible for DNR Cost Sharing (\$)
Construction Components:		
Unclassified Excavation (65,596 CY)	177,109	177,109
Remove Poor Soils and Replace with Clay Liner (2,710 SY)	10,569	10,569
36" RCP, Class III (67 LF)	4,958	4,958
Outlet Structure, anti-seep collar, 36" end section	8,050	8,050
Heavy & medium rip-rap (465 CY)	13,020	13,020
Tracking pad & ditch checks (1 LS)	1,750	1,750
Silt fence (7,240 LF)	9,412	9,412
Temporary diversion ditch & culvert (1 LS)	5,040	5,040
Temporary stabilization (1 LS)	19,125	19,125
Permanent grass planting (16.3 AC)	37,490	37,490
Mesic & wet to wet-mesic prairie planting (3.4 AC)	10,880	10,880
Erosion mat WDOT Class I, Type B (16,456 SY)	19,747	19,747
Erosion mat WDOT Class III, Type C (1,086 SY)	5,213	5,213
Shallow marsh planting (0.7 AC)	4,200	4,200
Bidding, Construction Management, Inspection, Certification	24,800	24,800
1. Construction Subtotal	\$351,363	\$351,363
2. Design	19,600	19,600
3. Storm Sewer Reroute		
4. Structure Removal		
5. Subtotal [add rows 1-4]	\$370,963	\$370,963
6. Property Acquisition: Fee Title & Easement	118,390	118,390
7. Grand Total [add rows 5 & 6]	\$489,353	\$489,353

UNPS&SW Grant Project Name
Ebben Pond

Part II. Minimum Qualifications (continued)

Cost-Sharing Worksheet

Eligible Costs:

Multiply the eligible costs (column C) by the percent for proration (if applicable) and the applicable cost-share rate. Enter the result in the column on the right.

	Prorate %	Cost-Share %	
8. Construction/Design	87%	50%	\$ 161,369
9. Property Acquisition	87%	50%	\$ 51,500
Cap Test:			
10. Construction/Design: Lesser of (8) or \$150,000			\$ 150,000
11. Property Acquisition: Lesser of (9) or \$50,000			\$ 50,000
12. Maximum State Share [(10)+(11)]			\$ 200,000
State & Local Share:			
13. Requested State-Share Amount (Requested Grant Amount)			\$ 200,000
14. Local-Share Amount [Grand Total (7), column B less (13)]			\$ 289,353

Local-Share Source(s):

Local funds will be included in 2007, 2008, and 2009 Village Budget. Local funds will be from Village of Little Chute Storm Water Utility dedicated revenue sources and general obligation bonds.

Method(s) Used to Calculate Cost Estimates:

Unit quantities are based on the Ebben Pond design plans. Unit costs are based on similarly sized local projects that have been publically bid, awarded to the lowest responsible bidder, and constructed within the past few years. Costs were adjusted for inflation and material cost increases. Disposal sites were discussed with local contractors and Village Staff to better determine excavation unit prices.

C. Cost-Effectiveness

1. Tangible Benefits

a. Primary Benefit:

List the pollutants to be controlled by the project.

Project will reduce total suspended solids (> 80%), phosphorus (60%), and heavy metal (lead 70%) loads to Apple Creek for the 146 acre watershed.

b. Secondary Benefits:

Select the following secondary benefits which will be achieved by implementing this project. (check all that apply)

- Fish and wildlife habitat enhancement
- Enhancements to recreation
- Public safety
- Economical operation, economical maintenance and enhanced life expectancy of the BMP
- Other (specify): Visual aesthetics, wetland restoration

2. Cost-Effectiveness

Explain why the proposed project is cost-effective considering the environmental benefit(s) and cost of the project.

Wet ponds are widely accepted and cost-effective BMPs that control TSS and TP. Infiltration BMPs are not feasible due to clay soils. Excavation costs are reduced since the disposal site is located directly adjacent to the proposed Ebben Pond. The pond property and disposal site were purchased by the Village in 2002 with the intent of constructing a wet pond and working toward NR 216 Municipal Permit compliance. The Village purchased the property for \$18,450 per acre. Since 2002, land costs have increased significantly in the area. As such, the low excavation and land costs greatly improve the cost effectiveness of the Ebben Pond project when compared to the BMP alternatives and amount of non-point source pollutant load reduction achieved within the watershed.

UNPS&SW Grant Project Name
Ebben Pond

Part II. Minimum Qualifications (continued)

Yes No 3. Alternatives

a. There is more than one way to achieve the benefits checked above. If no, go to part b.

1) If yes, complete the following table with information for the alternative governmental unit have chosen and one or two other alternatives. Note that the table requires information about the cost and pollutant load/potential reductions.

Alternatives Analysis				
	A Alternative	B Cost	C Effectiveness	D (B ÷ C) Cost-Effectiveness
		Estimated Amount	Estimated % of Pollutant Load Reduction	
1	Ebben Wet Pond	\$ 489,353	85 %	575,709
2	Biofiltration	\$ 725,000	84 %	863,095
3	Proprietary Devices	\$ 765,000	14 %	5,464,286

2) If the governmental unit is not choosing the alternative with the lowest ratio of cost to pollutant load/potential reductions, explain why it was not chosen in terms of any of the following: feasibility; secondary benefits potential; or other mitigating factors.

The most cost effective alternative (Ebben Pond) was selected.

b. If the answer to part 3.a. was no, explain why there is no other reasonable alternative to achieve the reduction in pollutant loading/potential or the secondary benefits checked above.

Question 2. Project Evaluation Strategy

Pre- and post-project evaluation measures used to ensure success in meeting project goals.

A. Modeling & Measures of Change

The applicant must agree to provide a description of the modeled results or changes in pollution potential in the final project report. The project evaluation strategy will be based on comparing pre- and post-project changes in modeled pollutant loading to water resources or will be based on the quantity of units managed.

Check all that apply in the table below.

	Priority for Developed Urban Area	Units of Measure	Recommended Measurement Method
<input checked="" type="checkbox"/>	20-40% Reduction in TSS	Pounds TSS reduced % TSS reduction	SLAMM, P-8
<input type="checkbox"/>	Infiltration	% Pre-development stay-on volume Cubic feet stay-on volume	Recarga, SLAMM, P-8
<input checked="" type="checkbox"/>	Peak flow discharge	Change in cubic feet per second	TR-55 or equivalent
<input type="checkbox"/>	Protective areas	Feet of bank protected	count
<input type="checkbox"/>	Fueling & maintenance areas	Oily sheen presence	visual assessment
<input type="checkbox"/>	Streambank	Tons of bank erosion reduced Feet of bank protected	NRCS bank erosion formula count

UNPS&SW Grant Project Name
Ebben Pond

Part II. Minimum Qualifications (continued)

Other (specify) _____

- Yes No **B. Monitoring** (not eligible for cost sharing at this time)
- The project evaluation strategy will provide pre- and post-project information from water quality monitoring. If yes, check all that apply below.
- The project will evaluate the physical habitat, fisheries, biological, or chemical conditions, including temperature and coliform bacteria.
- A one-page summary of the monitoring strategy is attached.
- C. Additional Monitoring**
- The applicant is willing to participate with the Department to do monitoring in the project area should cost sharing become available.

Question 3. Evidence of Local Support

The level of local support that currently exists for the proposed project.

- Yes No **A. Government**
1. a. The local-share funds for the construction/installation expenses are already included specifically in an adopted budget.
- b. The local-share funds for the construction/installation expenses are or will be included in a proposed budget.
2. The governmental unit has already conducted public information activities within the project area for this practice.

If yes, provide details regarding the nature of the opportunity for public reaction the governmental unit provided and indicate the general public support or non-support for the project that was indicated.

The Village Board passed a resolution that supports the Ebben Pond project and UNPS&SW Grant Application. The Board Meeting was noticed in the local newspaper and the public was invited to participate. The Village informed property owners that the Ebben Pond project will reduce non-point source pollution discharging to Apple Creek from the 146 acre watershed. Several letters of support were obtained from property owners. Also, the Village held several informational meetings within the past 5 years to discuss storm water management on the Village's north side. The Ebben Pond was discussed during several of these meetings.

- B. Landowners**
1. The governmental unit:
- a. already owns, or holds an easement for, the land on which the project is to be installed.
- b. is submitting with the application a list of landowners, occupants, or tenants that occupy the property and information indicating each party's willingness to sell or ease the necessary parcel.
2. Evidence is attached of **citizen** (non-governmental) support for the project (such as letters from the neighborhood association, a civic group or an environmental organization).

Question 4. Basin Priorities (check one)

- A. Clean Water Act s. 303(d) List of Impaired Waters**
Project with water quality goals directly dealing with a waterbody (lake or stream) on the latest Clean Water Act (CWA) s. 303(d) List of impaired waters, where the cause of the water quality impairment is nonpoint source pollution, and the project will reduce the type of nonpoint source pollutants for which the water is listed.
- B. Outstanding and Exceptional Resource Waters**
Waterbody is included in s. NR 102.10 (Outstanding Resource Waters) and/or s. NR 102.11 (Exceptional Resource Waters).
- C. NPS Rankings**
Project is located in a large-scale watershed, a small-scale watershed, lake watershed, or other area ranked high or medium on the NPS Rankings List, where the goals of the project are directly associated with the reason for the ranking on the NPS Rankings List.

UNPS&SW Grant Project Name
Ebben Pond

Part II. Minimum Qualifications (continued)

- D. Amendment of the NPS Rankings List Using State of the Basin Reports**
Project is located within a watershed ranked low or not ranked on the NPS Rankings List, but information in a DNR State of the Basin report indicates a need to amend the NPS Rankings List because the stream or stream segment or lake is being affected by nonpoint sources of pollution.
- E. Amendment of the NPS Rankings List Using Other Data Sources**
Project is located within a watershed ranked low or not ranked on the NPS Rankings List, but adequate data exists to request a ranking of high or medium for a waterbody that is being affected by nonpoint sources of pollution.
- F. Sources of Information for Areas Not Included in State of the Basin Reports**
For some border waters, there is no State of the Basin report (i.e., along the Mississippi River or the Great Lakes). For these situations, another governmental document, accepted by the Regional NPS Coordinator, can be used to classify the resource as having a significant nonpoint source pollution impairment.
- G. Not Included in Other Categories Above**

UNPS&SW Grant Project Name
Ebben Pond

Part III. Competitive Elements

Question 5. Water Quality Needs

The water quality category which best identifies the water quality goals for the project directly deals with: (check one)

Note: For border waters where a State of the Basin Report does not exist, another governmental document acceptable to the Regional Nonpoint Source Coordinator may be used to identify the water quality need.

Surface Water Considerations

- A. 303(d) Listed Waterbody**
A waterbody (lake or stream) on the latest Clean Water Act (CWA) s. 303(d) List of impaired waters, where the cause of the water quality impairment is nonpoint source pollution, and the project will reduce the type of nonpoint source pollutants for which the water is listed.
- B. Not Fully Meeting Uses**
A waterbody (lake or stream) identified in a DNR State of the Basin report as not meeting or partially meeting designated uses due to nonpoint sources, but is not on the 303(d) List.
- C. Threatened Waterbody**
A waterbody (lake or stream) viewed as "threatened" by nonpoint sources in a DNR State of the Basin report.
- D. Outstanding or Exceptional Resource Waters**
Prevention of degradation due to nonpoint sources of outstanding or exceptional resource waters or high quality, recreationally significant waters, but not including waters listed as "threatened."
- E. Surface Water Quality**
Prevention of surface water quality degradation due to nonpoint sources. Waters in this category are neither high quality, recreationally significant waters nor "threatened" waters.

Groundwater Considerations*

- F. Exceeds Groundwater Enforcement Standard**
Groundwater within the project area where representative information indicates that stormwater pollutants in groundwater exceed the Enforcement Standard (ES).
- G. Groundwater Quality (see Attachment H)**
The project area is within a geological area defined in Attachment H as susceptible to groundwater contamination.
- H. Exceeds Groundwater Preventive Action Limit**
Groundwater within the project area where representative information indicates that stormwater pollutants in groundwater exceed Preventive Action Limits (PAL).

*Consult the Regional Drinking Water and Groundwater Specialist or the County Extension office.

Bonus Points (see Attachment F):

Yes No

- Water quality goals relate to the control of nonpoint source contaminants in public drinking water supplies.
 - 1. If yes, and the source of drinking water affected by the project area is groundwater, the project protects:
 - a. One wellhead
 - OR
 - b. More than one wellhead
 - 2. If yes, and the source of drinking water affected by the project area is surface water, check the source water assessment area in which the project is located:

<input type="checkbox"/> Pike River & Creek	<input type="checkbox"/> Twin Rivers
<input type="checkbox"/> Root River	<input type="checkbox"/> Kewaunee & Ahnapee
<input type="checkbox"/> Oak Creek	<input type="checkbox"/> Menominee River
<input type="checkbox"/> Milwaukee River	<input type="checkbox"/> Fish Creek
<input type="checkbox"/> Sauk Creek	<input type="checkbox"/> St. Louis & Nemadji River
<input type="checkbox"/> Sheboygan & Onion Rivers	<input type="checkbox"/> Lake Winnebago
<input type="checkbox"/> Manitowoc River	

UNPS&SW Grant Project Name

Ebben Pond

Part III. Competitive Elements (continued)**Question 6. Extent of Pollutant Control**Yes No **A. NR 151 Performance Standard for Total Suspended Solids**

This project focuses on controlling total suspended solids (TSS) in urban runoff that enters waters of the state. Only check "Yes" if the area is covered by an NR 216 permit.

B. Other Water Resources Management Priority

The proposed project addresses a water resources management priority other than the NR 151 performance standard in part A above.

If yes, describe the priority and how the project addresses this priority.

The Nonpoint Source Control Plan for the Duck, Apple and Ashwaubenon Creeks Priority Watershed Project (PUBL WT-493-97) recommends a reduction in sediment, phosphorus and heavy metals for Apple Creek. The plan also recommends public education, wet detention pond retrofits, 2-year peak flow control, wetland restoration, and fish & wildlife habitat enhancement. Currently the Ebben Pond site is an agricultural field that is located directly adjacent to a low quality stream corridor. The Ebben Pond project will include public education, control of phosphorus and heavy metal loads, 2-year peak flow control for existing development (reduce flows to a "meadow" land use condition), create wetlands in the pond and along the stream corridor, enhance fish & wildlife habitat along the stream corridor, and improve the overall quality of the stream corridor & buffer.

 C. Planning Data & Source Targeting

The applicant has quantitative planning information that ranks pollution sources from highest to lowest in severity and the proposed project will manage a pollution source contained in the top 50% of the ranked list. If yes, provide:

a. Description of planning data

b. Name of document(s)

c. Date(s) published

d. Pertinent page numbers

e. A copy of non-state document(s) is available: (check all that apply)

 At this website: http:// Attached to this application form. Contact this person: Name: _____

Phone: _____

Question 7. Consistency with Resource Management Plans & Supporting RegulationsYes No **A. Consistency with Resource Management Plans**

The project implements a water quality recommendation from a locally approved resource management plan.

Summarize the water quality recommendation. Cite the name and date(s) of publication of the document.

2002 Storm Water Management Plan for Apple Creek & Paradise Valley Watersheds recommends 2-year peak flow control and 80% TSS reduction. This project reduces TSS, phosphorus, and heavy metals from the 146 acre drainage area prior to discharge into Apple Creek.

B. Supporting Regulations

The project is located within an area which has:

1. One or more regulations that implement the non-agricultural performance standards for developed urban areas under s. NR 151.13.

2. Other regulations designed to reduce the impact on water quality from new development, other than construction site erosion control or a storm water ordinance.

Describe in relation to the goals of the project.

UNPS&SW Grant Project Name
Ebben Pond

Part III. Competitive Elements (continued)

Section 8-3 of the Village Ordinance provides for compost, grass clipping, and leaf collection and Section 7-1 provides for proper management of pet waste. These regulations help reduce phosphorus and nutrient loads prior to discharge into Apple Creek.

The Shoreland-Wetland Zoning Ordinance (Chapter 19A) restricts new development within wetland and shoreland areas. The ordinance preserves shoreland buffers and wetlands which filter or store sediments and nutrients prior to discharge into Apple Creek.

These regulations provide additional non-point source pollution control which is in excess of that provided by the Ebben Pond. Reductions in non-point source pollution that are associated with public education, good municipal housekeeping, and natural resource protection (i.e. shoreland buffers, wetlands, etc.) are difficult to quantify and can not be modeled in SLAMM. In the end, these regulations are anticipated to further reduce non-point source pollution and phosphorus discharged into Apple Creek.

Question 8. Use of Additional Funding

Yes No NA

- A. The project is for construction or design and the state share is below the \$150,000 cap.
- B. The project includes property acquisition and the state share is below the \$50,000 cap.
- C. Funding requested is below the 50% cost-share rate.

Question 9. City of Racine

Yes No

- This is an application from the City of Racine for a project that is necessary for the city to comply with state storm water permitting requirements.

UNPS&SW Program Construction Grant Application

CY 2008 Funding

Form 8700-299 (R 1/07)

UNPS&SW Grant Project Name
Ebben Pond

Part IV. Eligibility for Multipliers

Completion of this part of the application is optional. However, an applicant can increase the final project score by qualifying for a project multiplier.

Local Implementation Program

Yes No NA

- A. The governmental unit is implementing a pollution prevention information and education program targeted for property owners and other residents.
- B. The governmental unit is implementing a nutrient management plan for municipally owned properties of at least five acres of pervious area where nutrients are applied.
- C. The governmental unit is implementing a tracking of storm water permitting activity (construction and post-construction) in the governmental unit and can make summary information available to the DNR upon request.

Optional Additional Information

Carefully review the answers to all of the questions above. Is there additional information that will add to the understanding of this project? If so, describe here.

Project Information. Item E: The Ebben Pond project does not require prorating for flood control. The pond size would be the same in order to achieve the water quality and peak discharge goals in accordance with NR 151 regulations and Wet Detention Basin (Code 1001) guidance.

Applicant Certification

An Authorized Representative must sign and date the application form prior to submittal to the DNR. All four copies must include signatures of the Authorized Representative.

I certify that, to the best of my knowledge, the information contained in this application and attachments is correct and true.

Signature of Authorized Representative 	Date Signed 4/10/07
---	------------------------

Charles P. Kell Village Administrator

[name and title]

Telephone Number (920) 788-7380

Fax Number (920) 788-7394

E-Mail Address chuck@littlechutewi.org

Mailing Address 108 W. Main Street Little Chute WI 54140

To be considered for funding, provide the following for each application submitted:

- One copy of the completed application form (DNR Form 8700-299 (R 1/07) with original signature in blue ink;
- Three additional copies of the completed, signed application form;
- One electronic copy of the completed application form on CD or diskette.

All application materials must be postmarked by midnight April 16, 2007.

Mail to: Department of Natural Resources
Attn: Kathy Thompson, WT/2
P.O. Box 7921
Madison, WI 53707-7921

EBBEN POND
VILLAGE OF LITTLE CHUTE
PAGE 15 OF 37

NORTH

EBBEN POND

PROJECT
BOUNDARY

05H'41'

APPLE &
ASHWAUBENON

CREEKS
(LFOZ-113)

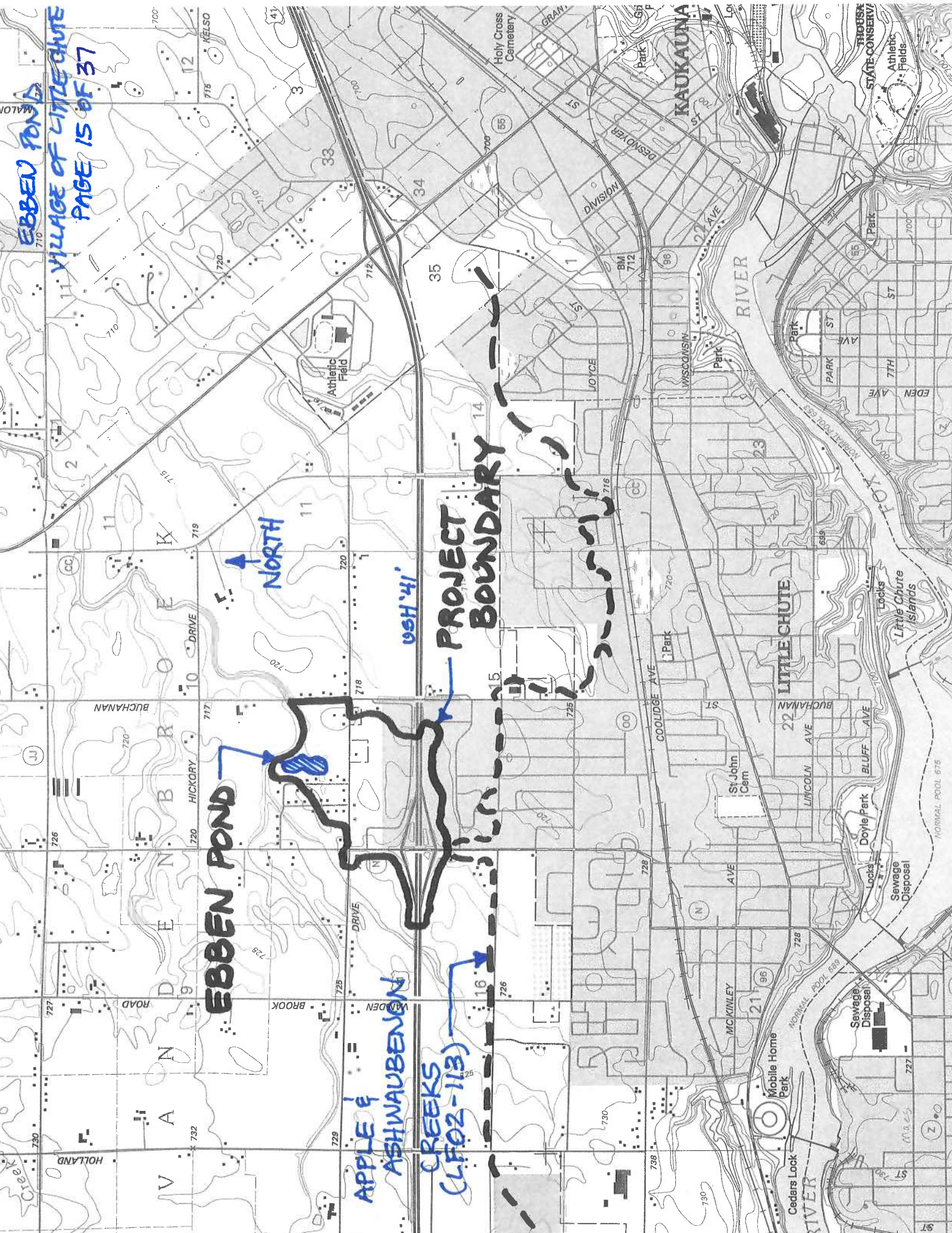

McMAHON ASSOCIATES

ENGINEERS | ARCHITECTS | SURVEYORS | PROJECT MANAGERS

2-year, 24-hour design storm: 2.5 inches

Existing Land Use Condition	Area (acres)	HSG	Imperv. (%)	Runoff Curve Number	Table 2-1 Runoff Depth (in)	Runoff Volume (ac-ft)
Commercial Strip	29.78	C	92	96	2.06	5.113
Light Industrial	2.03	C	80	93	1.79	0.303
Freeway	31.17	C	51	86	1.25	3.247
County Highway	3.66	C	82	94	1.87	0.570
Miscellaneous Institutional	1.81	C	64	89	1.46	0.220
Low Density Residential	7.55	C	20	79	0.84	0.529
Medium Density Residential	22.42	C	38	83	1.06	1.980
Open Space Undeveloped	17.08	C	5	75	0.65	0.925
Agriculture	30.08	C	5	79	0.84	2.106
Total:	145.58		42	84.9		14.993

Future Land Use Condition	Area (acres)	HSG	Imperv. (%)	Runoff Curve Number	Table 2-1 Runoff Depth (in)	Runoff Volume (ac-ft)
Commercial Strip	47.14	C	92	96	2.06	8.092
Light Industrial	2.03	C	80	93	1.79	0.303
Freeway	31.17	C	51	86	1.25	3.247
County Highway	3.66	C	82	94	1.87	0.570
Miscellaneous Institutional	1.81	C	64	89	1.46	0.220
Low Density Residential	7.55	C	20	79	0.84	0.529
Medium Density Residential	41.62	C	38	83	1.06	3.676
Park	10.60	C	14	77	0.74	0.654
Total:	145.58		57	87.8		17.290

Cost Share Rate: 87%

PROPERTY ACQUISITION PROPOSAL

County Map: See attached aerial photograph depicting parcel number.

Plat Map: See attached map from the Outagamie County Plat Book.

Project Map: See attached aerial photograph depicting parcel number.

Parcel Number: 260421306

Property Owner: Village of Little Chute

Property Address: Evergreen Drive, Village of Little Chute, WI 54140

Location: East of Arts Way, north of Evergreen Drive, west of Buchanan Road
(SW Quarter of Section 10, T21N, R18E, Village of Little Chute)

The proposed Ebben Pond is a wet extended detention pond. The proposed Ebben Pond is to be located north of Evergreen Drive, west of Buchanan Road, and east of CTH 'N'. The purpose of the Ebben Pond project is to reduce non-point source pollution prior to discharge into the Village's municipal separate storm sewer system (MS4) and ultimately Apple Creek. The project will also assist the Village with future NR 216 / WPDES Municipal Permit compliance and NR 151.13 requirements.

The Village of Little Chute purchased the Ebben Pond property in 2002 (37.94 acre parcel) with the intent of constructing a wet pond and working toward NR 216 Municipal Permit compliance. The Village purchased the property for \$18,450 per acre. As such, the Village is requesting grant funds for an acquisition that was made before the runoff management grant is issued.

The Village is not sure if the land valuation meets NR 155.25(3)(b). The valuation will be evaluated if the Village is awarded the grant.

Of the 37.94 acres, only 6.2 acres are needed for the referenced Ebben Pond project. The estimated cost of the 6.2 acre land acquisition is \$118,390 which includes the cost of ensuring the land valuation meets NR155.25(3)(b).

No relocation plans will be needed in accordance with chapter Commerce 202.

The Village of Little Chute plans to own, operate and maintain the Ebben Pond after the construction project is complete.

© Farm & Home Publishers, Ltd. See Page 52 For Additional Names.

OUTAGAMIE COUNTY, WISCONSIN



FREEDOM TWP. PAGE 14

(Landowners)

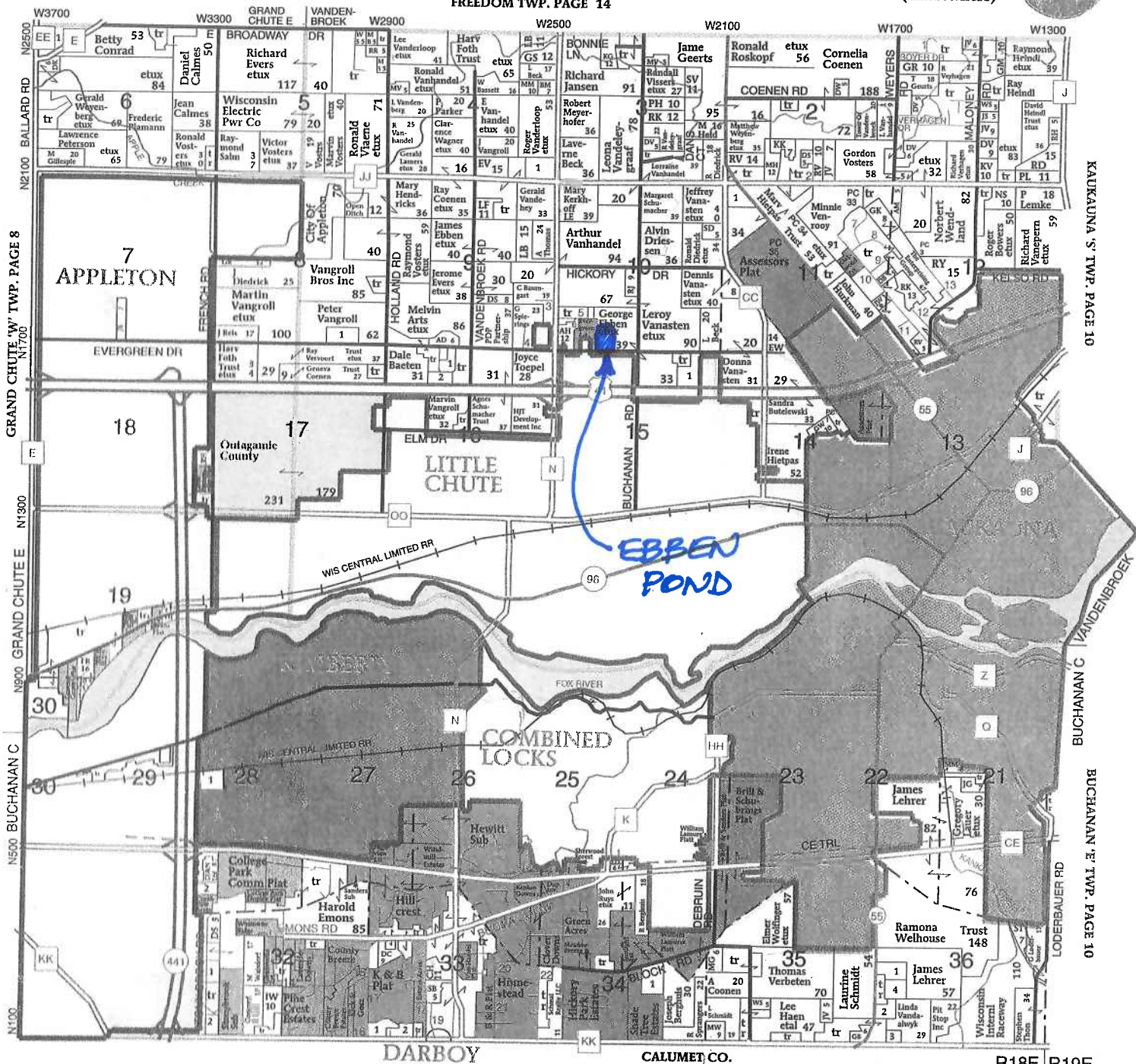

BECHARD GROUP INC

17 Park Place
 17 Park Place
 Appleton, WI 54914
 920-738-7100 www.bechardgroup.com

REAL ESTATE INVESTMENTS • DEVELOPMENT

- 1 RUSTIC WOODS
- 2 SLEEPY HOLLOW CT
- 3 KAREN DR
- 4 CARDINAL LN
- 5 MAPLE DR
- 6 IRENE ST
- 7 VEN ROOY CT
- 8 CHRISTINE CT
- 9 OAK LEAF CT
- 10 EMERY LN
- 11 WOLLER DR
- 12 VAN COP DR
- 13 DALE CT
- 14 PINE CREST BLVD
- 15 FARMSTEAD DR
- 16 KAMES AVE
- 17 MAIN ST
- 18 GATES LN
- 19 ROGERS LN
- 20 CANDLELITE WAY
- 21 HANK DR
- 22 HOPPENS-BERGEN
- 23 MARION AVE

1453084
Document Number

STATE BAR OF WISCONSIN FORM 2 - 1998
WARRANTY DEED

This Deed, made between **George J. Ebben and Rosamond M. Ebben, husband and wife, Grantors, and The Village of Little Chute, Grantee,** for a valuable consideration, conveys and warrants to Grantee the following described real estate in **Outagamie County, State of Wisconsin:**

Grantor, for a valuable consideration, conveys and warrants to Grantee the following described real estate in **Outagamie County, State of Wisconsin:**

$\$2,100 / \$3 \text{ PER } \$1,000 = \$700,000$
PURCHASE PRICE
 $\$700,000 / 37.94 \text{ AC.} = \$18,450 / \text{AC}$

TRANSFER
\$ 2100.00
FEE

**OUTAGAMIE COUNTY
RECEIVED FOR RECORD**

FEB 12 2002

AT 1 O'CLOCK AM P.M.
JANICE FLENZ
REGISTER OF DEEDS

pd
11.00

THIS SPACE RESERVED FOR RECORDING DATA

NAME AND RETURN ADDRESS
Charles D. Koehler
800 North Lynddale Drive
Appleton, WI 54914
ENVELOPE

20-0-0207-00-2
PARCEL IDENTIFICATION NUMBER (PIN)

This is not homestead property.

The East 4 feet of Lots Eighteen (18), Nineteen (19), Twenty (20), Twenty-one (21), Twenty-two (22), Twenty-three (23) and Twenty-four (24), **FIRST ADDITION TO EVERGREEN ESTATES, Town of Vandebrook, Outagamie County, Wisconsin.**

AND
The Southeast 1/4 of the Southwest 1/4 of Section 10, Township 21 North, Range 18 East, Town of Vandebrook, Outagamie County, Wisconsin, less and excepting the following:

- A) Lands conveyed by Warranty Deed in Jacket 529, Image 8, as Document No. 738069;
- B) Lands conveyed by Warranty Deed in Jacket 1567, Image 26, as Document No. 766402;
- C) Lands conveyed by Warranty Deed in Jacket 5349, Image 36, as Document No. 862085.

Exceptions to warranties: Except for easements, restrictions and covenants of record.

Dated this 1st day of February, 2002.

* George J. Ebben

* Rosamond M. Ebben

AUTHENTICATION

Signature(s) George J. Ebben and Rosamond M. Ebben
authenticated this 1st day of February, 2002.

ACKNOWLEDGMENT

STATE OF WISCONSIN)
OUTAGAMIE COUNTY) ss.
Personally came before me this _____ day of January, 2002 the above named **George J. Ebben and Rosamond M. Ebben** to me known to be the person(s) who executed the foregoing instrument and acknowledge the same.

TITLE: MEMBER STATE BAR OF WISCONSIN
(If not, _____
authorized by §706.06, Wis. Stats.)

THIS INSTRUMENT WAS DRAFTED BY
Charles D. Koehler
800 North Lynddale Drive
Appleton, WI 54914

Notary Public, State of Wisconsin
My Commission is permanent. (If not, state expiration date: _____, _____)

(Signatures may be authenticated or acknowledged. Both are not necessary.)

*Names of persons signing in any capacity should be typed or printed below their signatures

**2006 Property Record
Outagamie County, Wisconsin**

Property information is valid as of 02-21-2007 at 1:00AM

Current Year Values not finalized until after Board of Review.

Years marked with * have delinquent taxes.

2005 2006 2007

Owner

VILLAGE OF LITTLE CHUTE
108 W MAIN ST
LITTLE CHUTE, WI 541400000

Co-Owner:

Property Information

Parcel ID: 260421306
Document No: 001453084
School District: KAUKAUNA SCHOOL
Vocational District: FOX VALLEY TECH

Property Description

SE SW LESS W168.9FT OF E539.06FT OF S177.67FT & E4FT OF LOTS18 THRU 24 FIRST ADDN TO EVERGREEN ESTATES LESS S140FT OF E160FT & LESS CSM 5034 SEC10 T21N R18E 37.94AC M/L (WAS PRT #200 020700)

Property Address: EVERGREEN DR
Municipality: VILLAGE OF LITTLE CHUTE

Tax Information

Installment Due Date	
Installment	Amount
1	\$0.00
2	\$0.00
3	\$0.00
4	\$0.00

Base Tax: 0.00
Special Assessment: 0.00
Lottery Credit: (0.00)
Net Tax Due: 0.00
Amount Paid: (0.00)
Current Balance Due: 0.00
Interest: 0.00
Total Due: \$0.00

Most Recent Tax Year: Click on "Tax Bill" button below for payment instructions shown on the installment stubs.
Prior Tax Years: Total due is effective through the last day of this month and payable to the Outagamie County Treasurer.

Land Valuation

Land Class Code	Acreeage	Land Value	Improvements	Total
X4	37.940	0.00	0.00	0.00
	37.940	\$0.00	\$0.00	\$0.00

Total Acres: 37.940
Assessment Ratio: 0.9490
Fair Market Value: \$0.00

[Tax Bill](#)



You must have the free *Adobe Acrobat Reader* installed on your computer to view the tax bill.

LAYERS

- All Layers
- PLSS Monuments (Linked)
- County Address Labels
- US Highways
- State Highways
- County Highways
- Town Roads
- City and Village Roads
- Ramps
- Railroads
- Parcel Lines
- Display Lines
- Delinquent Tax Parcels
- Depression Contours
- Intermediate Contours
- Index Contours
- Lakes and Rivers
- Navigable Streams
- 300 ft. Navigable Stream
- Wetland DNR
- Soils
- 3 Mile Airport Radius
- Airport HLZO
- Sections
- Complete Parcel Number
- Plot Boundary
- DNR Required Well Casing
- School Districts
- County Zoning
- Airport Zoning
- Floodplain
- Police Districts
- Fire Districts
- Wards2000
- Cities
- Villages
- Towns
- Aerial Photos 2005
- Outagamie County

Active Layer: Other Counties

Active Tool: Pan

Scale: 100%

Time: 10:50 AM

Access to, and use of, this web service is subject to the terms and conditions of the [Disclaimer](#) and all applicable laws and regulations, including laws and regulations governing copyrights and trademarks.

VILLAGE OF LITTLE CHUTE

RESOLUTION NO. 7, SERIES OF 2007

**RESOLUTION APPROVING AN URBAN NON-POINT SOURCE & STORM WATER
CONSTRUCTION GRANT APPLICATION (Ebben Pond)**

WHEREAS, the Village of Little Chute recently received its NR 216 Municipal Storm Water Discharge Permit from the Wisconsin Department of Natural Resources; and

WHEREAS, the NR 216 Municipal Storm Water Discharge Permit requires a 20% total suspended solids (TSS) reduction by March 10, 2008 and 40% TSS reduction by March 10, 2013 within the Village's urbanized areas; and

WHEREAS, the Village desires to work toward NR 216 Municipal Permit compliance and improve surface water quality within Apple Creek by constructing the Ebben Pond; and

WHEREAS, the purpose of the Ebben Pond is to reduce total suspended solids, phosphorus, and other urban non-point source pollution from a 153-acre watershed prior to discharge into Apple Creek; and

WHEREAS, the Ebben Pond will assist both property owners located within the Ebben Pond's 153-acre watershed and the Village with NR 216 compliance.

NOW THEREFORE BE IT RESOLVED, that the Board of Trustees of the Village of Little Chute hereby supports submittal of an application for an Urban Non-Point Source & Storm Water (UNPS&SW) Construction Grant for the Ebben Pond project.

Introduced, approved and adopted: March 7, 2007.

VILLAGE OF LITTLE CHUTE

By: Charles Fischer
Charles Fischer, Village President

Attest: Vicki Schneider
Vicki Schneider, Village Clerk

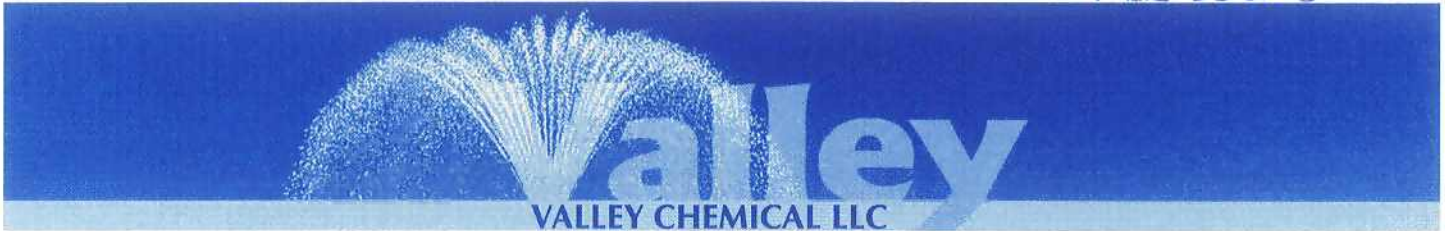

Aquatics Training • Chemicals • Service • Equipment

March 31, 2007

Mr. Roy Van Gheem
Director of Public Works, PE
Village of Little Chute
1940 Buchanan Street
Little Chute, WI 54140

Dear Mr. Van Gheem,

Valley Chemical LLC does support the Village of Little Chute's desire to construct the proposed Ebben Pond and the Village's desire to apply for an UNPS&SW Construction grant for the project.

The purpose of the project is to reduce the total suspended solids, phosphorus, and other non-point source pollution generated within the Ebben Pond watershed prior to discharge into the Apple Creek. Apple Creek is a 303(d) listed water body which is impaired by non-point source pollution.

We support the DNR grant application since the construction project will enhance water quality within Apple Creek, assist property owners and businesses with future NR 151 / NR 216 Municipal Permit compliance and assist the Village of Little Chute with future NR 151 / NR 216 Municipal Permit compliance.

Regards,

Ken Walther
President
Valley Chemical LLC

600 Randolph Drive
Appleton, WI 54913

March 31, 2007

Mr. Roy Van Gheem
Director of Public Works, PE
Village of Little Chute
1940 Buchanan Street
Little Chute, WI 54140

Dear Mr. Van Gheem,

Walther Enterprises LLC does support the Village of Little Chute's desire to construct the proposed Ebben Pond and the Village's desire to apply for an UNPS&SW Construction grant for the project.

The purpose of the project is to reduce the total suspended solids, phosphorus, and other non-point source pollution generated within the Ebben Pond watershed prior to discharge into the Apple Creek. Apple Creek is a 303(d) listed water body which is impaired by non-point source pollution.

We support the DNR grant application since the construction project will enhance water quality within Apple Creek, assist property owners and businesses with future NR 151 / NR 216 Municipal Permit compliance and assist the Village of Little Chute with future NR 151 / NR 216 Municipal Permit compliance.

Regards,



Ken Walther
President
Walther Enterprises LLC

400 Randolph Drive
Appleton, WI 54915

Mr. Roy Van Gheem
Director of Public Works, P.E.
Village of Little Chute
1940 Buchanan Street
Little Chute, WI 54140

Dear Mr. Van Gheem:

B & H Investments supports the Village of Little Chute's desire to construct the proposed Ebben Pond and the Village's desire to apply for an UNPS&SW Construction grant for the project.

The purpose of the project is to reduce total suspended solids, phosphorus, and other non-point source pollution generated within the Ebben Pond watershed prior to discharge into Apple Creek. Apple Creek is a 303(d) listed water body which is impaired by non-point source pollution.

We support the DNR grant application since the construction project will enhance water quality within Apple Creek., assist property owners and businesses with future NR 151 / NR 216 Construction Site Permit compliance, and assist the Village of Little Chute with future NR 151 / NR 216 Municipal Permit compliance.

Sincerely,

A handwritten signature in purple ink, appearing to read "J. Beckman".

B & H Investments

Le Roy Van Asten
W2246 Evergreen Dr.
Kaukauna, WI 54130

March 5, 2006

Mr. Roy Van Gheem
Director of Public Works, P.E.
Village of Little Chute
1940 Buchanan Street
Little Chute, WI 54140

Dear Mr. Van Gheem:

I, Le Roy Van Asten, support the Village of Little Chute's desire to construct the proposed Ebben Pond and the Village's desire to apply for an UNPS&SW Construction grant for the project.

The purpose of the project is to reduce total suspended solids, phosphorus, and other non-point source pollution generated within the Ebben Pond watershed prior to discharge into Apple Creek. Apple Creek is a 303(d) listed water body which is impaired by non-point source pollution.

I support the DNR grant application since the construction project will enhance water quality within Apple Creek., assist property owners and businesses with future NR 151 / NR 216 Construction Site Permit compliance, and assist the Village of Little Chute with future NR 151 / NR 216 Municipal Permit compliance.

Sincerely,

A handwritten signature in cursive script that reads "Le Roy Van Asten". The signature is written in black ink and is positioned below the word "Sincerely,".

512 Randolph Drive
Appleton, Wisconsin 54913

Mr. Roy Van Gheem
Director of Public Works, P.E.
Village of Little Chute
1940 Buchanan Street
Little Chute, WI 54140

Dear Mr. Van Gheem:

I support the Village of Little Chute's desire to construct the proposed Ebben Pond and the Village's desire to apply for an UNPS&SW Construction grant for the project.

The purpose of the project is to reduce total suspended solids, phosphorus, and other non-point source pollution generated within the Ebben Pond watershed prior to discharge into Apple Creek. Apple Creek is a 303(d) listed water body which is impaired by non-point source pollution.

We support the DNR grant application since the construction project will enhance water quality within Apple Creek, assist property owners and businesses with future NR 151 / NR 216 Construction Site Permit compliance, and assist the Village of Little Chute with future NR 151 / NR 216 Municipal Permit compliance.

Sincerely,

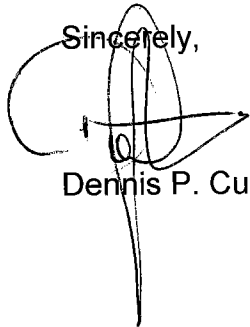
A handwritten signature in black ink, appearing to read "Dennis P. Curtin". The signature is stylized with a large loop on the left side and a horizontal stroke across the middle.

Dennis P. Curtin

MOORE PROPERTY MANAGEMENT, LLC

3083 Westfield Ridge
Neenah, WI 54956
920-725-9071

March 30, 2007

Mr. Roy Van Gheem
Director of Public Works, P.E.
Village of Little Chute
1940 Buchanan Street
Little Chute, WI 54140

Dear Mr. Van Gheem:

Moore Property Management LLC supports the Village of Little Chute's desire to construct the proposed Ebben Pond and the Village's desire to apply for an UNPS&SW Construction grant for the project.

We understand that the purpose of the project is to reduce total suspended solids, phosphorus, and other non-point source pollution generated within the Ebben Pond watershed prior to discharge into Apple Creek. We are concerned that Apple Creek is a 303(d) listed water body which is impaired by non-point source pollution.

We also support the DNR grant application since the construction project will enhance water quality within Apple Creek, assist property owners and businesses with future NR 151/ NR 216 Construction Site Permit compliance, and assist the Village of Little Chute with future NR 151/ NR 216 Municipal Permit compliance.

Sincerely wish for success with this project,

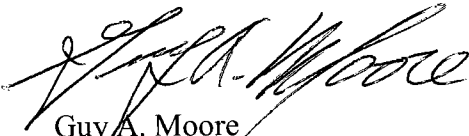

Guy A. Moore

Moore Property Management, LLC

W1660 Mariah Drive
Kaukauna, WI 54130

Mr. Roy Van Gheem
Director of Public Works, P.E.
Village of Little Chute
1940 Buchanan Street
Little Chute, WI 54140

Dear Mr. Van Gheem:

We, Robert L. and Debra J. Valentine, support the Village of Little Chute's desire to construct the proposed Ebben Pond and the Village's desire to apply for an UNPS&SW Construction grant for the project.

The purpose of the project is to reduce total suspended solids, phosphorus, and other non-point source pollution generated within the Ebben Pond watershed prior to discharge into Apple Creek. Apple Creek is a 303(d) listed water body which is impaired by non-point source pollution.

We support the DNR grant application since the construction project will enhance water quality within Apple Creek., assist property owners and businesses with future NR 151 / NR 216 Construction Site Permit compliance, and assist the Village of Little Chute with future NR 151 / NR 216 Municipal Permit compliance.

Sincerely,

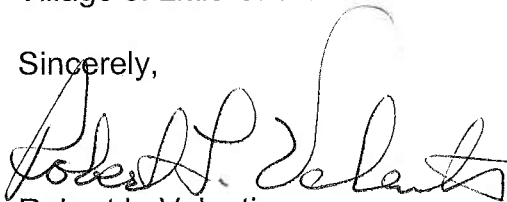
Robert L. Valentine

Debra J. Valentine

P. O. Box 825
Elm Grove, WI 53122

Mr. Roy Van Gheem
Director of Public Works, P.E.
Village of Little Chute
1940 Buchanan Street
Little Chute, WI 54140

Dear Mr. Van Gheem:

RRR-Appleton LLC supports the Village of Little Chute's desire to construct the proposed Ebben Pond and the Village's desire to apply for an UNPS&SW Construction grant for the project.

The purpose of the project is to reduce total suspended solids, phosphorus, and other non-point source pollution generated within the Ebben Pond watershed prior to discharge into Apple Creek. Apple Creek is a 303(d) listed water body which is impaired by non-point source pollution.

We support the DNR grant application since the construction project will enhance water quality within Apple Creek., assist property owners and businesses with future NR 151 / NR 216 Construction Site Permit compliance, and assist the Village of Little Chute with future NR 151 / NR 216 Municipal Permit compliance.

Sincerely,

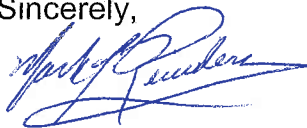
A handwritten signature in blue ink, appearing to read "Apple of Rueders", written over a horizontal line.

RRR-Appleton LLC

709 Depot Street
Little Chute, WI 54140

Mr. Roy Van Gheem
Director of Public Works, P.E.
Village of Little Chute
1940 Buchanan Street
Little Chute, WI 54140

Dear Mr. Van Gheem:

VanAsten Heating & Sheet Metal supports the Village of Little Chute's desire to construct the proposed Ebben Pond and the Village's desire to apply for an UNPS&SW Construction grant for the project.

The purpose of the project is to reduce total suspended solids, phosphorus, and other non-point source pollution generated within the Ebben Pond watershed prior to discharge into Apple Creek. Apple Creek is a 303(d) listed water body which is impaired by non-point source pollution.

We support the DNR grant application since the construction project will enhance water quality within Apple Creek., assist property owners and businesses with future NR 151 / NR 216 Construction Site Permit compliance, and assist the Village of Little Chute with future NR 151 / NR 216 Municipal Permit compliance.

Sincerely,

VanAsten Heating & Sheet Metal

VanAsten Heating & Sheet Metal

709 Depot Street
Little Chute, WI 54140

Mr. Roy Van Gheem
Director of Public Works, P.E.
Village of Little Chute
1940 Buchanan Street
Little Chute, WI 54140

Dear Mr. Van Gheem:

We, Floyd and Irene VanAsten, support the Village of Little Chute's desire to construct the proposed Ebben Pond and the Village's desire to apply for an UNPS&SW Construction grant for the project.

The purpose of the project is to reduce total suspended solids, phosphorus, and other non-point source pollution generated within the Ebben Pond watershed prior to discharge into Apple Creek. Apple Creek is a 303(d) listed water body which is impaired by non-point source pollution.

We support the DNR grant application since the construction project will enhance water quality within Apple Creek., assist property owners and businesses with future NR 151 / NR 216 Construction Site Permit compliance, and assist the Village of Little Chute with future NR 151 / NR 216 Municipal Permit compliance.

Sincerely,

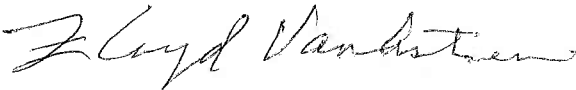

Floyd VanAsten

Irene VanAsten

195 Plank Road
Kaukauna, WI 54130

March 29, 2007

Mr. Roy Van Gheem
Director of Public Works, P.E.
Village of Little Chute
1940 Buchanan Street
Little Chute, WI 54140

Dear Mr. Van Gheem:

I, Gerald G. Vandynhoven, support the Village of Little Chute's desire to construct the proposed Ebben Pond and the Village's desire to apply for an UNPS&SW Construction grant for the project.

The purpose of the project is to reduce total suspended solids, phosphorus, and other non-point source pollution generated within the Ebben Pond watershed prior to discharge into Apple Creek. Apple Creek is a 303(d) listed water body which is impaired by non-point source pollution.

We support the DNR grant application since the construction project will enhance water quality within Apple Creek., assist property owners and businesses with future NR 151 / NR 216 Construction Site Permit compliance, and assist the Village of Little Chute with future NR 151 / NR 216 Municipal Permit compliance.

Sincerely,



Gerald G. Vandynhoven

108 W. Main Street
Little Chute, WI 54140

Mr. Roy Van Gheem
Director of Public Works, P.E.
Village of Little Chute
1940 Buchanan Street
Little Chute, WI 54140

Dear Mr. Van Gheem:

The Village of Little Chute Planning Commission supports the Village of Little Chute's desire to construct the proposed Ebben Pond and the Village's desire to apply for an UNPS&SW Construction grant for the project.

The purpose of the project is to reduce total suspended solids, phosphorus, and other non-point source pollution generated within the Ebben Pond watershed prior to discharge into Apple Creek. Apple Creek is a 303(d) listed water body which is impaired by non-point source pollution.

We support the DNR grant application since the construction project will enhance water quality within Apple Creek., assist property owners and businesses with future NR 151 / NR 216 Construction Site Permit compliance, and assist the Village of Little Chute with future NR 151 / NR 216 Municipal Permit compliance.

Sincerely,



Charles Fischer
Planning Commission Chairman

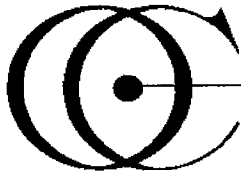

OUTAGAMIE COUNTY

HIGHWAY DEPARTMENT

1313 HOLLAND ROAD APPLETON, WISCONSIN 54911-8947
PHONE: (920) 832-5673 OFFICE FAX: (920) 832-2032 SHOP FAX: (920) 788-1967
Visit our website at www.co.outagamie.wi.us

EBBEN POND
VILLAGE OF LITTLE CHUTE
PAGE 35 OF 37

March 9, 2007

Mr. Roy Van Gheem
Director of Public Works, P.E.
Village of Little Chute
1940 Buchanan Street
Little Chute, WI 54140

Dear Mr. Van Gheem,

The Outagamie County Highway Department supports the Village of Little Chute's desire to construct the proposed Ebben Pond and the Village's desire to apply for an UNPS&SW Construction grant for the project.

The purpose of the project is to reduce total suspended solids, phosphorus, and other non-point source pollution generated within the Ebben Pond watershed prior to discharge into Apple Creek. Apple Creek is a 303(d) listed water body which is impaired by non-point source pollution.

We support the DNR grant application since the construction project will enhance water quality within Apple Creek, assist property owners and businesses with future NR 151/ NR 216 Construction Site Permit compliance, and assist the Village of Little Chute with future NR 151/ NR 216 Municipal Permit compliance.

Sincerely,

OUTAGAMIE COUNTY HIGHWAY DEPARTMENT

Alvin J. Geurts, P.E.
Highway Commissioner

AJG/crr



Midwest Contract Operations
March 21, 2007

625 E. Evergreen Drive
Kaukauna, WI 54130

Mr. Roy Van Gheem
Director of Public Works, P.E.
Village of Little Chute
1940 Buchanan Street
Little Chute, WI 54140

Dear Mr. Van Gheem:

MCO supports the Village of Little Chute's desire to construct the proposed Ebben Pond and the Village's desire to apply for an UNPS&SW Construction grant for the project.

The purpose of the project is to reduce total suspended solids, phosphorus, and other non-point source pollution generated within the Ebben Pond watershed prior to discharge into Apple Creek. Apple Creek is a 303(d) listed water body which is impaired by non-point source pollution.

We support the DNR grant application since the construction project will enhance water quality within Apple Creek., assist property owners and businesses with future NR 151 / NR 216 Construction Site Permit compliance, and assist the Village of Little Chute with future NR 151 / NR 216 Municipal Permit compliance.

Sincerely,

A handwritten signature in black ink that reads "Jerry Verstegen". The signature is written in a cursive, flowing style.

Jerry Verstegen
Facilities Manager

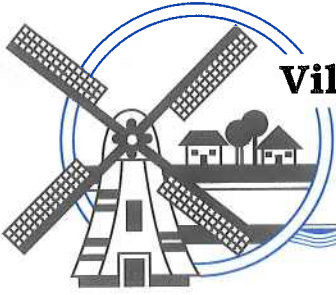

Village of

Little Chute

108 W. Main Street
Little Chute, WI 54140

Mr. Roy Van Gheem
Director of Public Works, P.E.
Village of Little Chute
1940 Buchanan Street
Little Chute, WI 54140

Dear Mr. Van Gheem:

The Water Commission of the Village of Little Chute supports the Village of Little Chute's desire to construct the proposed Ebben Pond and the Village's desire to apply for an UNPS&SW Construction grant for the project.

The purpose of the project is to reduce total suspended solids, phosphorus, and other non-point source pollution generated within the Ebben Pond watershed prior to discharge into Apple Creek. Apple Creek is a 303(d) listed water body which is impaired by non-point source pollution.

We support the DNR grant application since the construction project will enhance water quality within Apple Creek., assist property owners and businesses with future NR 151 / NR 216 Construction Site Permit compliance, and assist the Village of Little Chute with future NR 151 / NR 216 Municipal Permit compliance.

Sincerely,

A handwritten signature in black ink that reads "Kevin Coffey". The signature is fluid and cursive, with the first name being particularly prominent.

Kevin Coffey
Chairperson, Water Commission